

MODEL 5105

RECORD OF CHANGE
8 & 9

PARTS LIST

MINIMUM SPEED 400 RPM • MAXIMUM SPEED 940 RPM
FOR ANY DEVIATION FROM THE ABOVE CONSULT THE
FACTORY

DANGER

AIR FROM THIS COMPRESSOR
MUST NOT BE USED FOR FOOD
PROCESSING OR BREATHING
WITHOUT ADEQUATE FILTERING.

AIR COMPRESSOR

THE CODE NUMBER, AS
STAMPED IN THE RAISED
BOSS ON THE BAYONET
OIL GAUGE SIDE OF THE
CRANKCASE, MUST BE
GIVEN WHEN ORDERING
REPAIR PARTS.

NOTICE:

DO NOT OPERATE THIS
COMPRESSOR WITHOUT AN
OSHA APPROVED TOTALLY
ENCLOSED BELT GUARD
OR ANY OTHER REQUIRED
SAFETY EQUIPMENT.

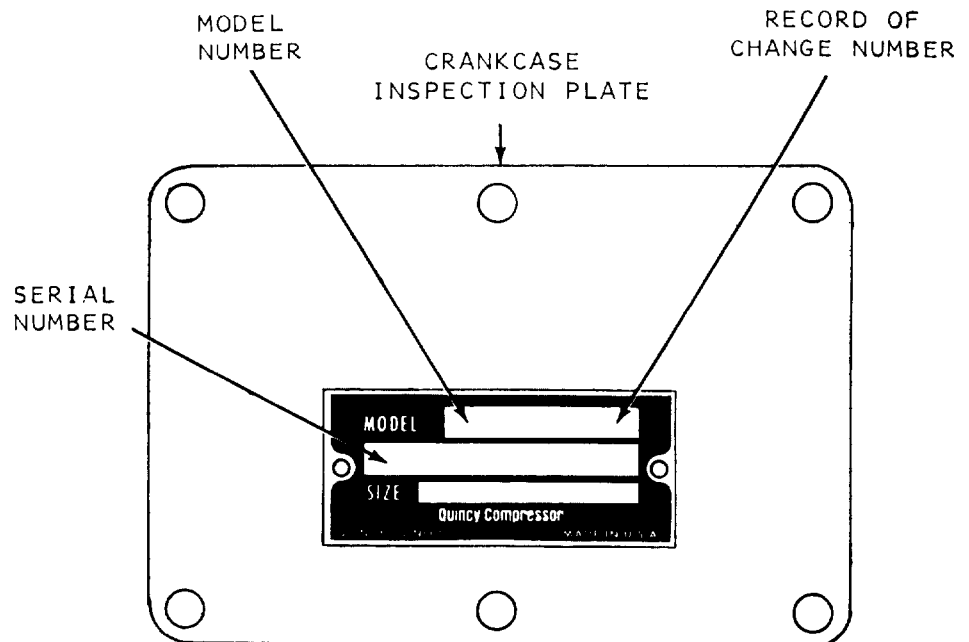

PROMPT SERVICE CAN BE RENDERED ON REPAIR PARTS ORDERS IF THE
FOLLOWING INFORMATION IS ALSO GIVEN:

1. STATE THE EXACT PART NUMBER NEEDED. DO NOT ORDER BY INDEX NUMBERS, AS INDEX NUMBERS ARE REPEATED THROUGHOUT THIS MANUAL, AND IF USED FOR ORDERING REPAIR PARTS, WILL NECESSITATE TIME CONSUMING CORRESPONDENCE.
2. STATE EXACT QUANTITY NEEDED.
3. STATE PREFERRED TYPE OF TRANSPORTATION.

ALL REPAIR PARTS ORDERS WILL BE INVOICED F.O.B. QUINCY, ILLINOIS,
AT PRICES IN EFFECT AT TIME OF DELIVERY.

Colt Industries



Quincy Compressor
Division

217 Maine Street
Quincy, Illinois 62301

A division of the Colt In
Operating Corp

50298-009

HEAD GROUP

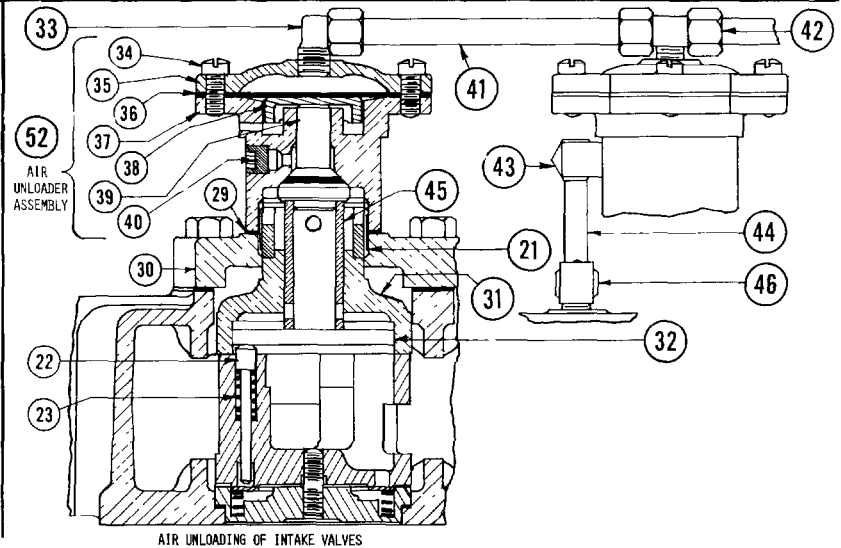
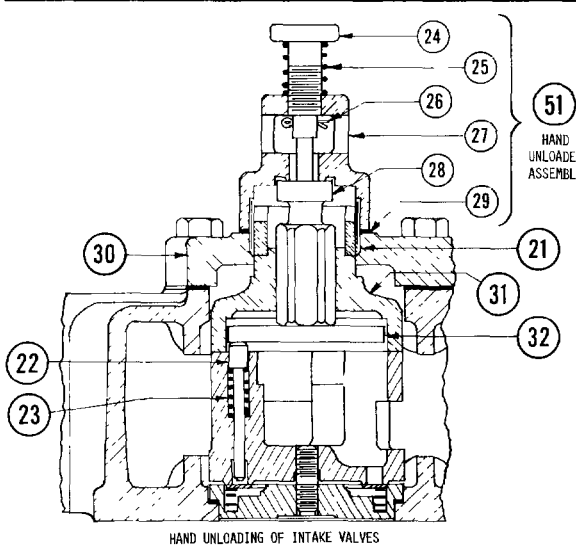
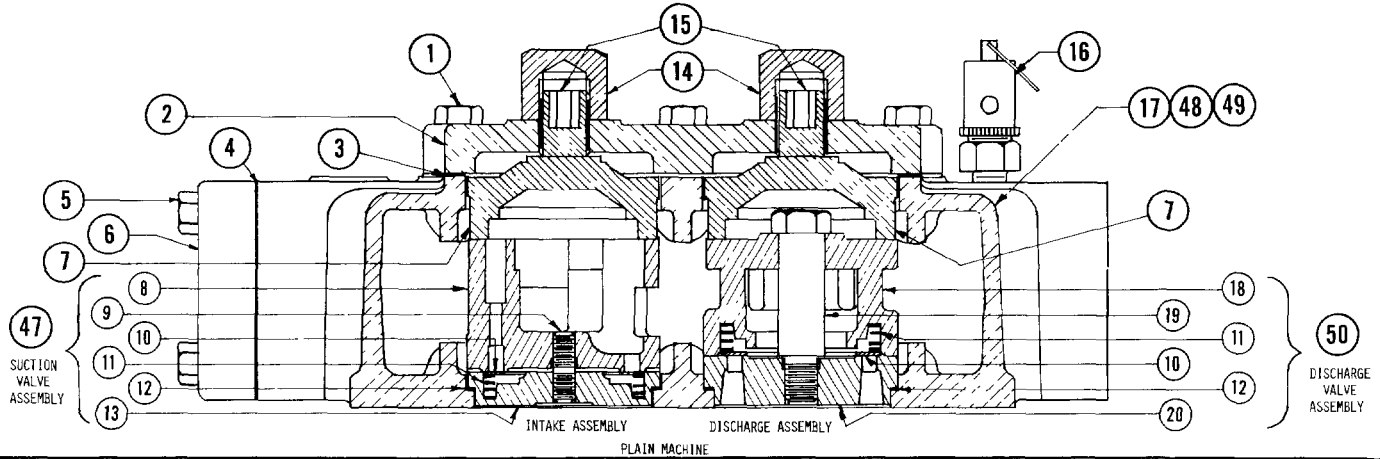

INDEX NUMBER	PART NUMBER	DESCRIPTION	QUANTITY REQUIRED FOR ONE MACHINE				
			PLAIN	LOADLESS	VD PILOT	DUAL CONTROL	HAND
1	7480	SCREW - 7/16" NC X 1-3/8" HEX HEAD CAP	40	40	40	40	40
2	6666	PLATE - HIGH PRESSURE INTAKE OR DISCHARGE VALVE COVER	4	2	2	2	2
	7384	PLATE - LOW PRESSURE INTAKE OR DISCHARGE VALVE COVER	4	2	2	2	2
3	2025	GASKET - HIGH PRESSURE INTAKE OR DISCHARGE VALVE COVER PLATE	4	4	4	4	4
	7398	GASKET - LOW PRESSURE INTAKE OR DISCHARGE VALVE COVER PLATE	4	4	4	4	4
4	5828	GASKET - INTAKE FLANGE NOTE: NOT INCLUDED IN COMPLETE HEAD ASSEMBLY.	2	2	2	2	2
5	4247	SCREW - 7/16" NC X 1-1/2" HEX HEAD CAP NOTE: NOT INCLUDED IN COMPLETE HEAD ASSEMBLY.	8	8	8	8	8
6	5858	FLANGE - INTAKE NOTE: NOT INCLUDED IN COMPLETE HEAD ASSEMBLY.	2	2	2	2	2
7	6668	SPACER - VALVE RETAINER	12	8	8	8	8
8	2015	SEAT - INTAKE VALVE	6	6	6	6	6
9	1849	STUD - INTAKE VALVE ASSEMBLY	6	6	6	6	6
10	2036	VALVE - INTAKE OR DISCHARGE	12	12	12	12	12

HEAD GROUP - CONTINUED

INDEX NUMBER	PART NUMBER	DESCRIPTION	QUANTITY REQUIRED FOR ONE MACHINE				
			PLAIN	LOADLESS	VD PILOT	DUAL CONTROL	HAND
11	6909	SPRING - INTAKE OR DISCHARGE VALVE	12	12	12	12	12
12	2024	GASKET - INTAKE OR DISCHARGE VALVE	12	12	12	12	12
13	6671	BUMPER - INTAKE VALVE	6	6	6	6	6
14	2623	NUT - LOCK	12	8	8	8	8
15	5916	SCREW - VALVE ASSEMBLY HOLDDOWN	12	8	8	8	8
16	2961-100	VALVE - 1/4" NPT SAFETY (SET 100 PSI)	2	2	2	2	2
17	7382	HEAD** - BARE LEFT CYLINDER BANK	1	1	1	1	1
	7383	HEAD** - BARE RIGHT CYLINDER BANK	1	1	1	1	1
18	6670	BUMPER - DISCHARGE VALVE	6	6	6	6	6
19	5731	STUD - DISCHARGE VALVE ASSEMBLY	6	6	6	6	6
20	5812	SEAT - DISCHARGE VALVE	6	6	6	6	6
21	3008	SCREW - VALVE ASSEMBLY HOLDDOWN	-	4	4	4	4
22	1857	PIN - VALVE KICKOFF	-	12	12	12	12
23	6910	SPRING - VALVE KICKOFF PIN	-	12	12	12	12
24	2906	SCREW - HAND UNLOADER	-	-	-	-	4
25	1882	SPRING - HAND UNLOADER	-	-	-	-	4
26	2741	PIN - COTTER	-	-	-	-	4
27	1602	BODY - HAND UNLOADER	-	-	-	-	4
28	6913X	PLUNGER - HAND UNLOADER	-	-	-	-	4
29	1556	GASKET - UNLOADER BODY	-	4	4	4	4
30	6908	PLATE - HIGH PRESSURE INTAKE COVER	-	2	2	2	2
	7385	PLATE - LOW PRESSURE INTAKE COVER	-	2	2	2	2
	2719	PLUG - LOW PRESSURE INTAKE COVER	-	-	-	-	2
		PLATE 1/4" NPT COUNTERSUNK HEAD PIPE	-	-	-	-	4
31	6911	SPACER - VALVE RETAINER	-	4	4	4	4
32	5729	PLATFORM - UNLOADER	-	4	4	4	4
33	1642	ELBOW - 1/8" NPT X 1/4" COPPER TUBE	-	2	2	2	-
34	7499	SCREW - 1/4" NC X 3/4" HEX HEAD SEMS	-	24	24	24	-
35	1818B	COVER - DIAPHRAGM UNLOADER	-	4	4	4	-
36	1855	DIAPHRAGM - UNLOADER	-	4	4	4	-
37	7483	BODY - UNLOADER	-	4	4	4	-
38	5910	CAP - UNLOADER PISTON	-	4	4	4	-
39	7532X	PISTON - UNLOADER	-	-	-	-	-
		NOTE: INDIVIDUAL "O" RINGS FOR THIS ASSEMBLY ARE NOT AVAILABLE SEPARATELY.	-	4	4	4	-
40	2755S	PLUG - 1/8" NPT SOCKET HEAD PIPE	-	-	-	-	-
		NOTE: USED IN LOW PRESSURE UNLOADER BODY ONLY.	-	2	2	2	-
41	2586	TUBE - 1/4" X 10" COPPER	-	2	2	2	-
42	1665	TEE - 1/8" NPT X 1/4" COPPER TUBE X 1/4" COPPER TUBE	-	2	2	2	-
43	2709	ELBOW - 1/8" NPT X 5/16" COPPER TUBE	-	2	2	2	-
44	5950	TUBE - 5/16" X 12" COPPER	-	2	2	2	-
45	6912	PIN - UNLOADER	-	4	4	4	-
46	2706	CONNECTOR - 1/4" NPT X 5/16" COPPER TUBE	-	2	2	2	-
		<u>ASSEMBLIES</u>					
47	6671X	VALVE ASSEMBLY - INTAKE	6	2	2	2	2
	6671XU	VALVE ASSEMBLY - UNLOADER TYPE INTAKE	-	4	4	4	4
48	7382L BX3P	HEAD ASSEMBLY** - PLAIN TYPE LEFT CYLINDER BANK	1	-	-	-	-
	7382L BX3L	HEAD ASSEMBLY** - LOADLESS, V.D. PILOT OR DUAL CONTROL TYPE LEFT CYLINDER BANK	-	1	1	1	-
	7382L BX3P	HEAD ASSEMBLY** - HAND UNLOADER TYPE LEFT CYLINDER BANK	-	-	-	-	1
49	7383R BX3P	HEAD ASSEMBLY** - PLAIN TYPE RIGHT CYLINDER BANK	1	-	-	-	-
	7383R BX3L	HEAD ASSEMBLY** - LOADLESS, V.D. PILOT OR DUAL CONTROL TYPE RIGHT CYLINDER BANK	-	1	1	1	-
	7383R BX3H	HEAD ASSEMBLY** - HAND UNLOADER TYPE RIGHT CYLINDER BANK	-	-	-	-	1
50	6670X	VALVE ASSEMBLY - DISCHARGE	6	6	6	6	6
51	1602X	UNLOADER ASSEMBLY - HAND	-	-	-	-	4
52	7483X	UNLOADER ASSEMBLY - AIR	-	4	4	4	-

**THE LEFT CYLINDER BANK AND RIGHT CYLINDER BANKS ARE DESIGNATED FROM A POSITION FACING THE BEARING CARRIER.

CRANKCASE & RUNNING GEAR GROUP

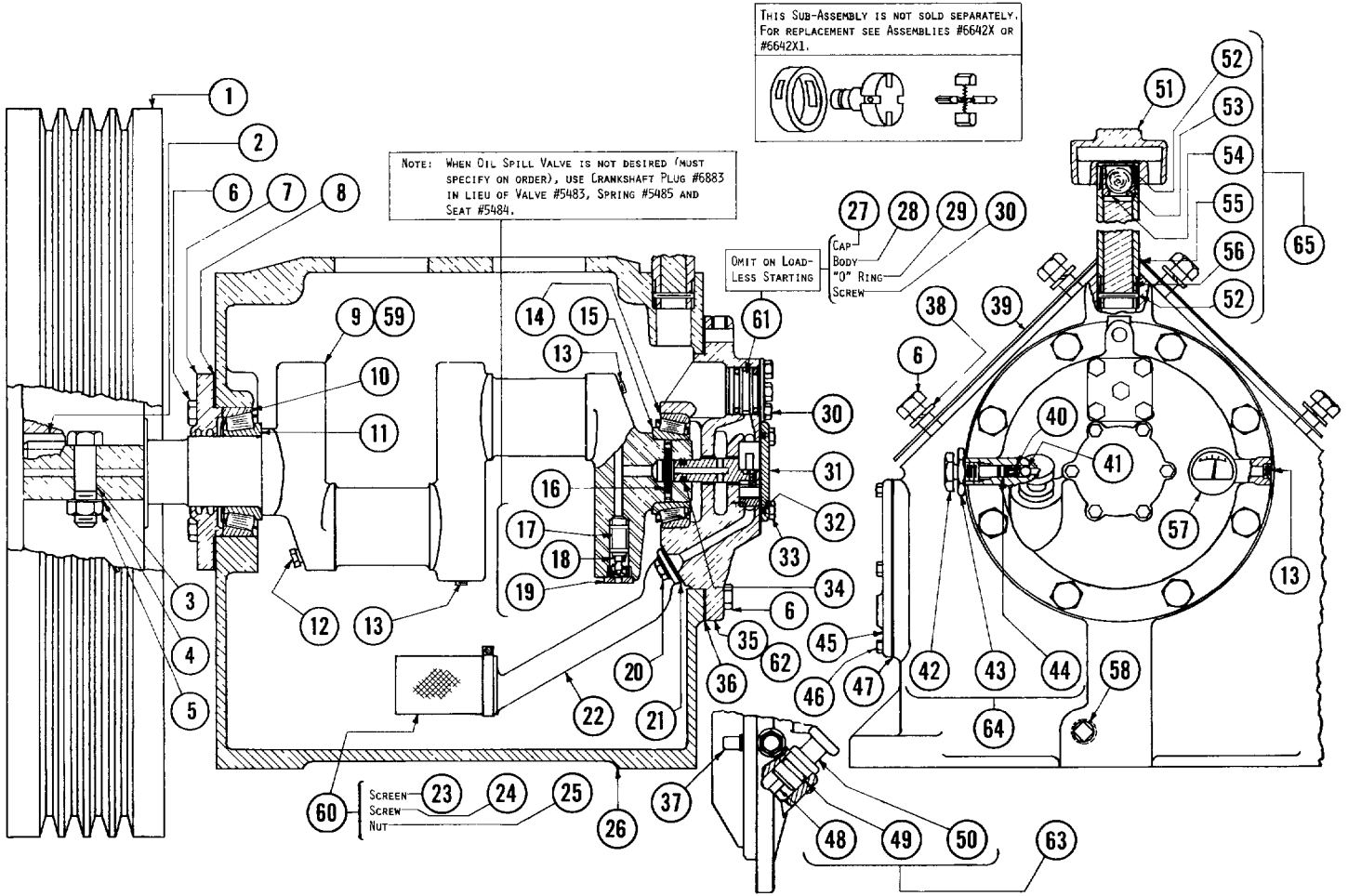

INDEX NUMBER	PART NUMBER	DESCRIPTION	QUANTITY REQUIRED
1	8299	PULLEY - 23-1/2" O.D., 4 GROOVE, "B" SECTION, 2" BORE, COUNTERCLOCKWISE COMPRESSOR	1
	8307	PULLEY - 23-1/2" O.D., 4 GROOVE, "B" SECTION, 2" BORE CLOCKWISE COMPRESSOR	::
2	2851	KEY - PULLEY	1
3	4260	BOLT - 5/8" NF X 3" HEX HEAD CAP PULLEY HUB CLAMP	2
4	3592	WASHER - 5/8" PLAIN	2
5	1883	NUT - 5/8" NF SQUARE HEAD	2
6	1707	SCREW - 1/2" NC X 1-1/4" HEX HEAD CAP	28
7	6643	PLATE - BEARING ADJUSTMENT	1
8	1498	SHIM - .005" THICK STEEL BEARING ADJUSTMENT PLATE	::
	1498B	SHIM - .007" THICK STEEL BEARING ADJUSTMENT PLATE	::
	1498C	SHIM - .020" THICK STEEL BEARING ADJUSTMENT PLATE	::
9	6641-1	CRANKSHAFT - BARE NOTE: NOT SOLD SEPARATELY, SEE CRANKSHAFT ASSEMBLIES #6641-1X OR #6641-1X1.	-
10	4357	CUP - PULLEY SIDE TIMKEN BEARING	1
11	6651	CONE - PULLEY SIDE TIMKEN BEARING	1
12	5486	ORIFICE - CRANKSHAFT	1
13	2755S	PLUG - 1/8" NPT SOCKET HEAD PIPE	3
14	3720	CUP - OPPOSITE PULLEY SIDE TIMKEN BEARING	1
15	6652	CONE - OPPOSITE PULLEY SIDE TIMKEN BEARING	1
16	6650	PIN - OIL PUMP ROTOR DRIVE	1
17	5483	VALVE - SPILL	1

CRANKCASE & RUNNING GEAR GROUP - CONTINUED

INDEX NUMBER	PART NUMBER	DESCRIPTION	QUANTITY REQUIRED
18	5485	SPRING - SPILL VALVE	1
19	5484	SEAT - SPILL VALVE	1
20	6907	SCREW - OIL INTAKE BRACKET MOUNTING	2
21	6679	GASKET - OIL INTAKE BRACKET	1
22	8109	BRACKET - OIL INTAKE	1
23	5470	SCREEN - OIL INTAKE	1
24	1022	SCREW - #10-32 X 5/8" ROUND HEAD	1
25	5496	NUT - #10-32 SQUARE	1
26	6640	CRANKCASE - BARE	1
27	6289	CAP - HYDRAULIC UNLOADER COVER	1
28	6327	BODY - HYDRAULIC UNLOADER OPENING CLOSURE ASSEMBLY	1
29	6286	"O" RING - HYDRAULIC UNLOADER OPENING CLOSURE ASSEMBLY	2
30	2138	SCREW - 1/4" NC X 1/2" HEX HEAD CAP	5
31	6269	PLATE - OIL PUMP COVER	1
32	6270	"O" RING - OIL PUMP COVER PLATE	1
33	3951	SCREW - 1/4" NC X 5/8" HEX HEAD CAP	6
34	2323	"O" RING - OIL PUMP ROTOR	1
35	6642	CARRIER - OPPOSITE PULLEY SIDE BEARING NOTE: <u>NOT SOLD SEPARATELY, SEE BEARING CARRIER ASSEMBLIES #6642X OR 6642X1.</u>	-
36	5494	GASKET - BEARING CARRIER	1
37	7514	DEFLECTOR - OIL BY-PASS	1
38	3186	WASHER - 1/2" LOCK	16
39	5827	GASKET - CYLINDER TO CRANKCASE	2
40	1160	SPRING - OIL PRESSURE ADJUSTMENT SCREW	1
41	1281	BALL - OIL PRESSURE ADJUSTMENT	1
42	5489	SCREW - OIL PRESSURE ADJUSTMENT	1
43	5490	NUT - OIL PRESSURE ADJUSTMENT SCREW LOCK	1
44	5491	"O" RING - OIL PRESSURE ADJUSTMENT SCREW	1
45	6645	PLATE - HANDHOLE	2
46	1990	SCREW - 3/8" NC X 3/4" HEX HEAD CAP	20
47	6678	GASKET - HANDHOLE PLATE	2
48	6727	ROD - BAYONET OIL LEVEL GAUGE NOTE: <u>NOT SOLD SEPARATELY, SEE ASSEMBLY #6727X.</u>	-
49	6755	"O" RING - BAYONET OIL LEVEL GAUGE	1
50	6726	KNOB - BAYONET OIL LEVEL GAUGE NOTE: <u>NOT SOLD SEPARATELY, SEE ASSEMBLY #6727X.</u>	-
51	6936	CAP - BREATHER	1
52	6903	PIN - 1/8" X 1-1/8" ROLL NOTE: <u>NOT SOLD SEPARATELY, SEE ASSEMBLY #5518X1.</u>	-
53	5783	BALL - BREATHER NOTE: <u>NOT SOLD SEPARATELY, SEE ASSEMBLY #5518X1.</u>	-
54	6864	SEAT - BREATHER VALVE NOTE: <u>NOT SOLD SEPARATELY, SEE ASSEMBLY #5518X1.</u>	-
55	5518	NIPPLE - PIPE NOTE: <u>NOT SOLD SEPARATELY, SEE ASSEMBLY #5518X1.</u>	-
56	6865	FILTER - BREATHER VALVE NOTE: <u>NOT SOLD SEPARATELY, SEE ASSEMBLY #5518X1.</u>	-
57	1386	GAUGE - OIL PRESSURE	1
58	2057	PLUG - 1/2" NPT SQUARE HEAD OIL DRAIN	1
		<u>ASSEMBLIES</u>	
59	6641-1X	CRANKSHAFT ASSEMBLY NOTE: <u>INCLUDES SPILL VALVE, ORIFICE, PLUGS AND OIL PUMP ROTOR DRIVE PINS.</u>	**
	6641-1X1	CRANKSHAFT ASSEMBLY NOTE: <u>INCLUDES SPILL VALVE, ORIFICE, PLUGS, OIL PUMP ROTOR DRIVE PINS AND TIMKEN BEARING CONES.</u>	**
60	5470X	SCREEN ASSEMBLY - OIL INTAKE	1
61	6289X	CLOSURE ASSEMBLY - HYDRAULIC UNLOADER OPENING	**
62	6642X	CARRIER ASSEMBLY - BEARING NOTE: <u>INCLUDES COMPLETE OIL PUMP ASSEMBLY AND TIMKEN BEARING CUP, BUT LESS OIL PRESSURE GAUGE AND BAYONET OIL LEVEL GAUGE.</u>	**
	6642X1	CARRIER ASSEMBLY - BEARING NOTE: <u>INCLUDES COMPLETE OIL PUMP ASSEMBLY, TIMKEN BEARING CUP AND BAYONET OIL LEVEL GAUGE, BUT LESS OIL PRESSURE GAUGE.</u>	**
63	6727X	GAUGE ASSEMBLY - BAYONET OIL LEVEL	1
64	5489X	SCREW ASSEMBLY - OIL PRESSURE ADJUSTMENT	1
65	5518X1	VALVE ASSEMBLY - BREATHER	1
NOT SHOWN	7435	GASKET SET - COMPLETE COMPRESSOR OVERHAUL	1

*ASTERISK INDICATES THAT PARTS CAN BE USED IN THE CATEGORY INDICATED, BUT MUST BE ORDERED AS EACH INDIVIDUAL SITUATION REQUIRES.

CYLINDER, PISTON & ROD GROUP

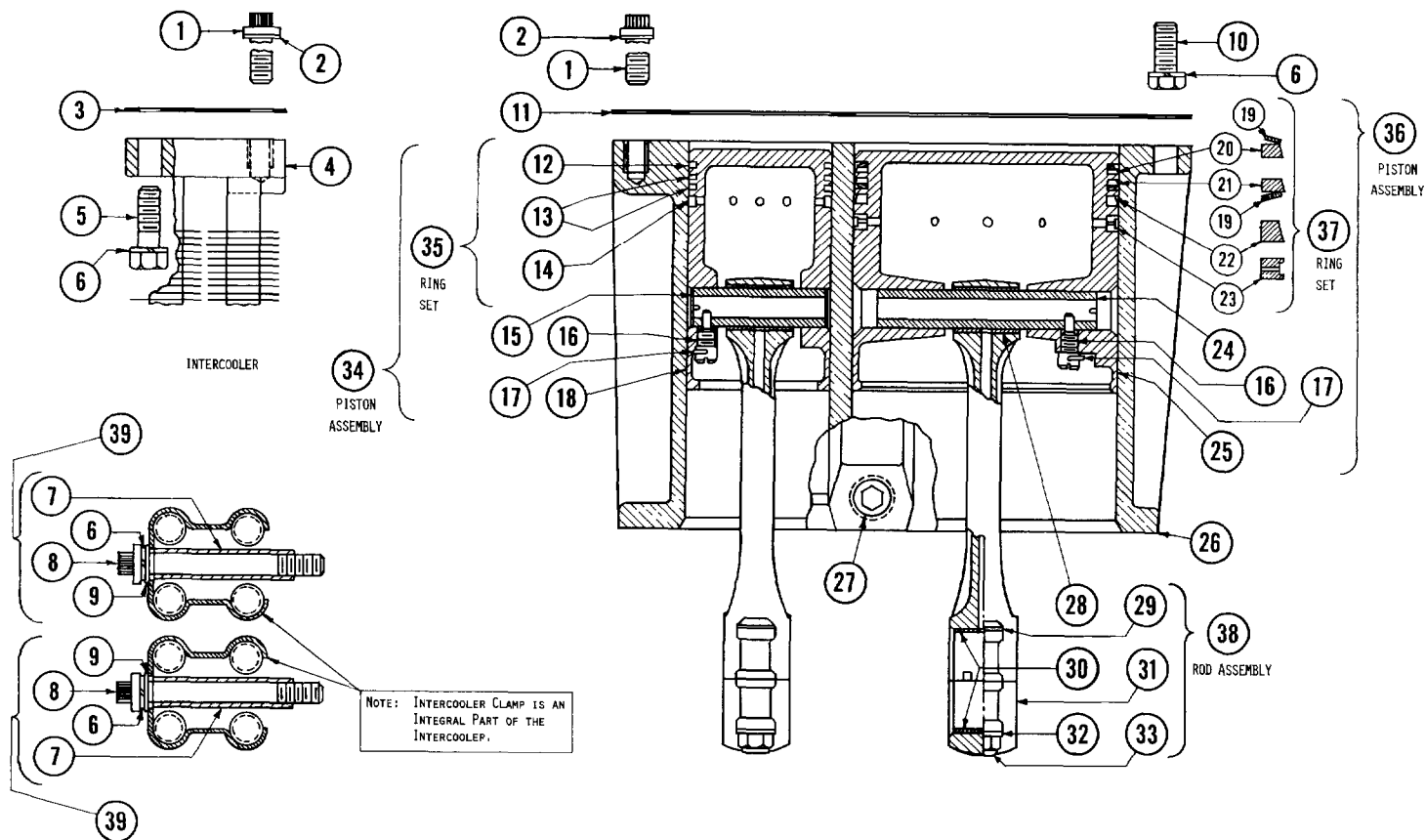

INDEX NUMBER	PART NUMBER	DESCRIPTION	QUANTITY REQUIRED
1	5863	SCREW - 1/2" NC X 1-1/2" HEX HEAD CAP	14
2	1478	WASHER - 1/2" COPPER	14
3	5860	GASKET - INTERCOOLER	2
4	6658	INTERCOOLER - AIRCOOLED	1
5	2763	SCREW - 1/2" NC X 1-3/4" HEX HEAD CAP	4
6	3186	WASHER - 1/2" LOCK	26
7	6959	SLEEVE - INTERCOOLER CLAMP	2
8	6960	SCREW - 1/2" NC X 4" "COUNTER-BOR" HEAD CAP	2
9	2769	WASHER - 1/2" FLAT	2
10	4832	SCREW - 1/2" NC X 1-1/2" HEX HEAD CAP	20
11	7403	GASKET - CYLINDER TO HEAD	
		NOTE: FOR COMPLETE HEAD GASKETS, 2 EA. #7403 HEAD GASKETS AND 2 EA. #5860 INTERCOOLER GASKETS ARE REQUIRED.	
12	5849	RING - STANDARD TOP COMPRESSION	2
13	6997	RING - STANDARD 2ND AND 3RD COMPRESSION	4
14	5850	RING - STANDARD OIL CONTROL	2
15	5856	PIN - STANDARD HIGH PRESSURE PISTON	2
16	1384	SCREW - PISTON PIN LOCK	4
17	1298	PIN - PISTON PIN LOCK SCREW COTTER	4
18	5846	PISTON - STANDARD HIGH PRESSURE	2
	5846OV10	PISTON - .010" OVERSIZE HIGH PRESSURE	::
	5846OV20	PISTON - .020" OVERSIZE HIGH PRESSURE	::

CYLINDER PISTON & ROD GROUP - CONTINUED

INDEX NUMBER	PART NUMBER	DESCRIPTION	QUANTITY REQUIRED
19	6994	SPRING - SIDE SEALER RING	4
20	6992	RING - SIDE SEALER COMPRESSION	2
21	6993	RING - SIDE SEALER VACUUM	2
22	5847	RING - COMPRESSION	2
23	5848	RING - OIL CONTROL	2
24	2031	PIN - LOW PRESSURE PISTON	2
25	5845	PISTON - STANDARD LOW PRESSURE	2
	5845OV10	PISTON - .010" OVERSIZE LOW PRESSURE	::
	5845OV20	PISTON - .020" OVERSIZE LOW PRESSURE	::
26	7395	CYLINDER - BARE	2
27	4729	PLUG - 3/8" SOCKET HEAD PIPE	2
28	6443SR	BUSHING - PISTON PIN	4
29	1344	BOLT - CONNECTING ROD	8
30	6656PR	INSERTS - PAIR OF STANDARD	4
	6656PRUS	INSERTS - PAIR OF .010" UNDERSIZE	::
31	6655	ROD - CONNECTING	-
		NOTE: NOT SOLD SEPARATELY, SEE ASSEMBLY #6655X.	-
32	1319	WASHER - CONNECTING ROD BOLT	8
33	3201	NUT - 7/16" NF ELASTIC STOP	8
		<u>ASSEMBLIES</u>	
34	5846X1	PISTON ASSEMBLY - STANDARD HIGH PRESSURE	2
	5846XOV10	PISTON ASSEMBLY - .010" OVERSIZE HIGH PRESSURE	::
	5846XOV20	PISTON ASSEMBLY - .020" OVERSIZE HIGH PRESSURE	::
35	6996	RING SET - STANDARD HIGH PRESSURE	2
	5788OV10	RING SET - .010" OVERSIZE HIGH PRESSURE	::
	5788OV20	RING SET - .020" OVERSIZE HIGH PRESSURE	::
36	5845XS1	PISTON ASSEMBLY - STANDARD LOW PRESSURE	2
	5845XOV10	PISTON ASSEMBLY - .010" OVERSIZE LOW PRESSURE	::
	5845XOV20	PISTON ASSEMBLY - .020" OVERSIZE LOW PRESSURE	::
37	7527	RING SET - STANDARD LOW PRESSURE	2
	5787OV10	RING SET - .010" OVERSIZE LOW PRESSURE	::
	5787OV20	RING SET - .020" OVERSIZE LOW PRESSURE	::
38	6655X	ROD ASSEMBLY - CONNECTING	4
39	6959X	SLEEVE ASSEMBLY - INTERCOOLER	2

*ASTERISK INDICATES THAT PARTS CAN BE USED IN THE CATEGORY INDICATED, BUT MUST BE ORDERED AS EACH INDIVIDUAL SITUATION REQUIRES.

DO NOT ORDER BY INDEX NUMBERS, INDEX NUMBERS ARE REPEATED THROUGHOUT THIS MANUAL, AND IF USED FOR ORDERING REPAIR PARTS, WILL NECESSITATE TIME CONSUMING CORRESPONDENCE.

OPTIONAL SIDE SEALER RING ASSEMBLIES

APPLIES TO MODEL 5105 HIGH PRESSURE PISTONS
RECORD OF CHANGE 9 ONLY

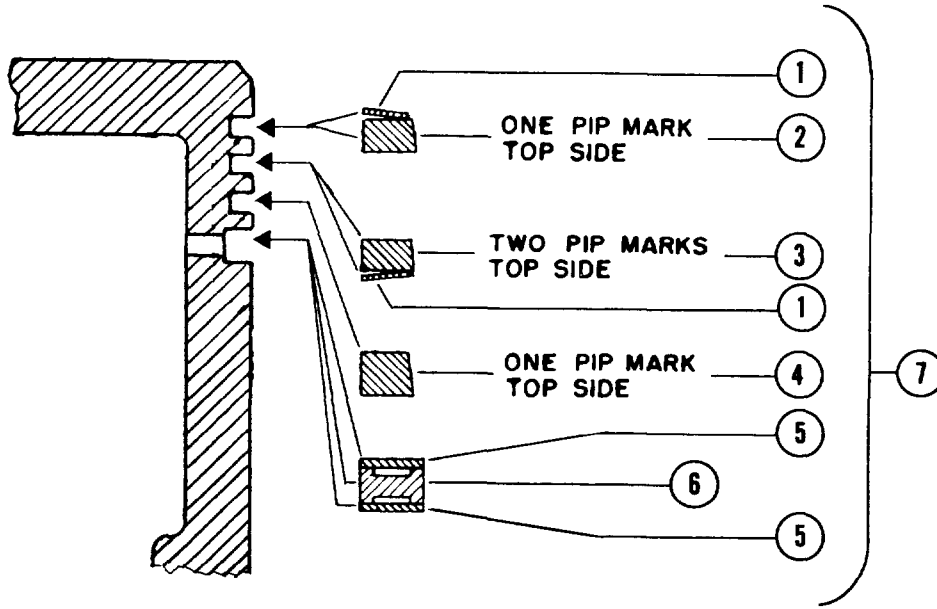

INDEX NUMBER	PART NUMBER	DESCRIPTION	QUANTITY REQUIRED
1	7968	SPRING - HIGH PRESSURE PISTON SIDE SEALER RING	4
2	7963	RING - HIGH PRESSURE PISTON SIDE SEALER COMPRESSION	2
3	7965	RING - HIGH PRESSURE PISTON SIDE SEALER COMPRESSION	2
4	6997	RING - HIGH PRESSURE PISTON COMPRESSION	2
5	7964	RAIL - HIGH PRESSURE PISTON OIL CONTROL	4
6	7966	EXPANDER - HIGH PRESSURE PISTON OIL CONTROL RAIL	2
<u>ASSEMBLIES</u>			
7	8168	RING SET - HIGH PRESSURE PISTON SIDE SEALER	2
NOT SHOWN	8746	PISTON ASSEMBLY - HIGH PRESSURE NOTE: <u>NOT AVAILABLE IN OVERSIZES.</u>	2
		NOTE: <u>INCLUDES #5846 PISTON, 5856 PISTON PIN, 1298 COTTER KEY, 1384 LOCK SCREW AND 6452 SIDE SEALER RING SET.</u> <u>NOT AVAILABLE IN OVERSIZES.</u>	2

MANIFOLD GROUP

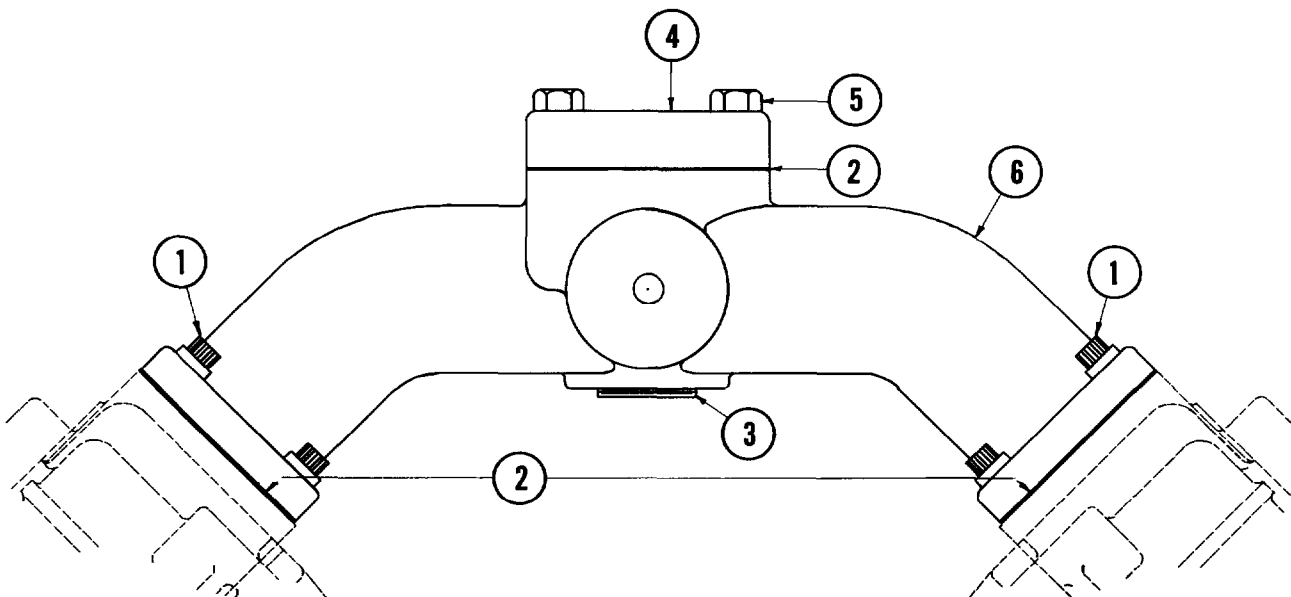

MANIFOLD GROUP - CONTINUED

INDEX NUMBER	PART NUMBER	DESCRIPTION	QUANTITY REQUIRED
1	6872	SCREW - 7/16" NC X 1-1/4" "COUNTER-BOR" HEAD CAP	8
2	5828	GASKET - MANIFOLD TO HEAD	3
3	2757	PLUG - 1-1/4" COUNTERSUNK HEAD PIPE	1
4	5858	FLANGE - BASIC COMPRESSOR OUTLET	1
	6977	FLANGE - TANK MOUNTED COMPRESSOR OUTLET	**
5	4247	SCREW - 7/16" NC X 1-1/2" HEX HEAD CAP	4
6	6664	MANIFOLD - DISCHARGE	1

**ASTERISK INDICATES THAT PARTS CAN BE USED IN THE CATEGORY INDICATED, BUT MUST BE ORDERED AS EACH INDIVIDUAL SITUATION REQUIRES.

SHROUD ASSEMBLY

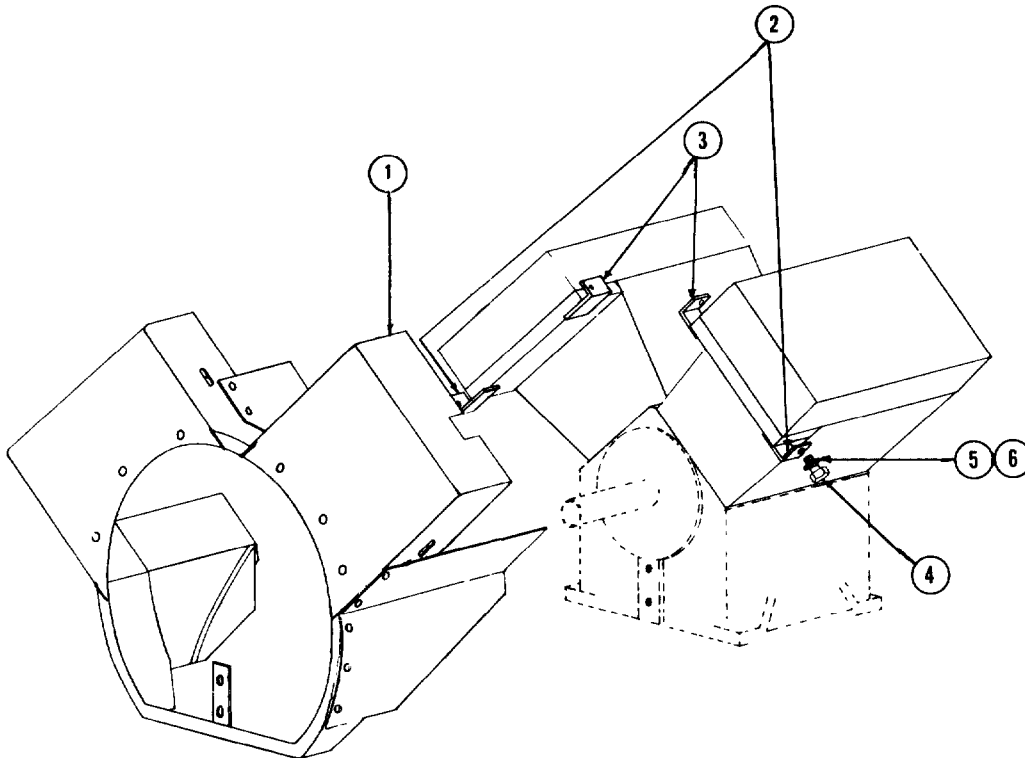

INDEX NUMBER	PART NUMBER	DESCRIPTION	QUANTITY REQUIRED
1	7524X	SHROUD ASSEMBLY - COMPLETE NOTE: <u>INCLUDES MOUNTING BRACKETS, BOLTS AND WASHERS.</u> <u>NOT SOLD BY INDIVIDUAL PIECES!</u>	1
2	7442	BRACKET - OUTER MOUNTING	2
3	7441	BRACKET - INNER MOUNTING	2
4	2138	SCREW - 1/4" NC X 1/2" HEX HEAD CAP	4
5	2139	WASHER - 1/4" LOCK	4
6	2733	WASHER - 1/4" PLAIN	4

CONTROL GROUP

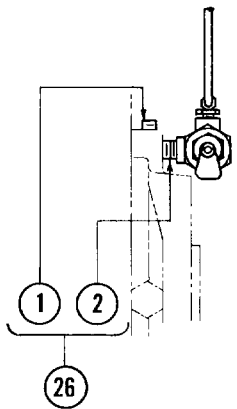

WITH V.D. PILOT ONLY
(FOR CONTINUOUS RUNNING)

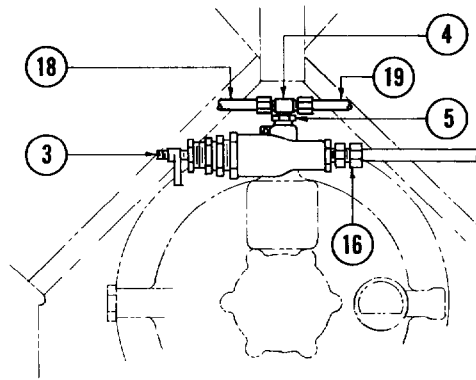

WITH HYDRAULIC UNLOADER ONLY
(LOADLESS STARTING)

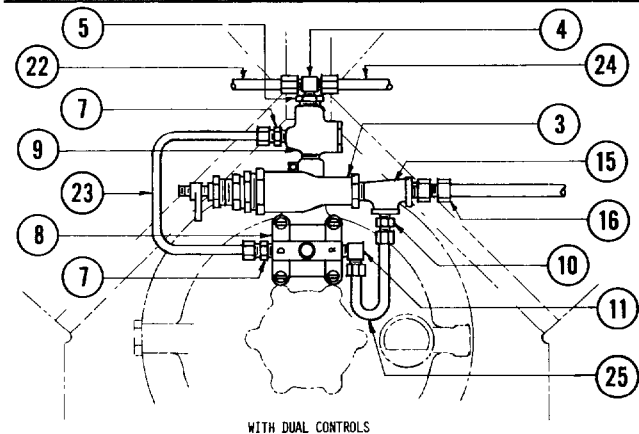
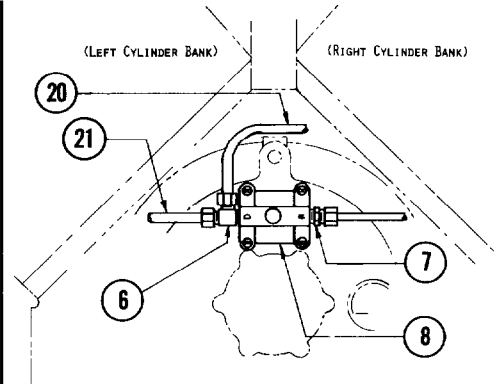

WITH DUAL CONTROLS

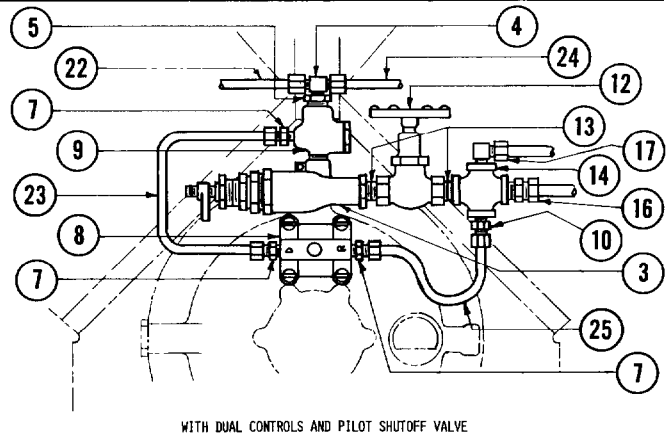

WITH DUAL CONTROLS AND PILOT SHUTOFF VALVE

INDEX NUMBER	PART NUMBER	DESCRIPTION	QUANTITY REQUIRED FOR ONE MACHINE			
			LOADLESS	CONTINUOUS RUNNING	DUAL CONTROL LESS SHUTOFF VALVE	DUAL CONTROL WITH SHUTOFF VALVE
1	3080	SCREW - 3/8" NF X 1/2" SOCKET HEAD SET	-	1	1	1
2	6317	STUD - V.D. PILOT MOUNTING	-	1	1	1
3	----	PILOT ASSEMBLY - V.D. NOTE: SEE V.D. PILOT BREAKDOWN IN THIS PARTS LIST.	-	1	1	1
4	1665	TEE - 1/8" NPT X 1/4" TUBE X 1/4" TUBE	-	1	1	1
5	4516	BUSHING - 1/4" NPT X 1/8" NPT REDUCING	-	1	1	1
6	3324	TEE - 1/8" NPT X 1/4" TUBE X 1/4" TUBE	1	-	-	-
7	1643	CONNECTOR - 1/8" NPT X 1/4" TUBE STRAIGHT	1	-	2	3
8	----	UNLOADER ASSEMBLY - HYDRAULIC NOTE: SEE HYDRAULIC UNLOADER ASSEM- BLY BREAKDOWN IN THIS PARTS LIST.	1	-	1	1

CONTROL GROUP - CONTINUED

INDEX NUMBER	PART NUMBER	DESCRIPTION	QUANTITY REQUIRED FOR ONE MACHINE			
			LOADLESS	CONTINUOUS RUNNING	DUAL CONTROL LESS SHUTOFF VALVE	DUAL CONTROL WITH SHUTOFF VALVE
9	6194X	VALVE - DUAL CONTROL CHECK	-	-	1	1
10	2704	CONNECTOR - 1/4" NPT X 1/4" TUBE STRAIGHT	-	-	1	1
11	1642	CONNECTOR - 1/8" NPT X 1/4" TUBE ELBOW	-	-	1	-
12	6200	VALVE - 1/4" NPT SHUTOFF	-	-	-	1
13	2177	NIPPLE - 1/4" NPT CLOSE	-	-	-	2
14	4805	CROSS - 1/4" NPT	-	-	-	1
15	3003	TEE - 1/4" NPT SERVICE	-	-	1	-
16	2616	CONNECTOR - 1/4" NPT X 3/8" TUBE STRAIGHT	-	1	1	1
17	2708	CONNECTOR - 1/4" NPT X 1/4" TUBE ELBOW	-	-	-	1
18	1921	TUBE - 1/4" X 24" PILOT TEE TO LEFT CYLINDER BANK UNLOADER	-	1	-	-
19	2860	TUBE - 1/4" X 25" PILOT TEE TO RIGHT CYLINDER BANK UNLOADER	-	1	-	-
20	2866	TUBE - 1/4" X 28" UNLOADER TEE TO RIGHT CYLINDER BANK UNLOADER	1	-	-	-
21	1868	TUBE - 1/4" X 26" UNLOADER TEE TO LEFT CYLINDER BANK UNLOADER	1	-	-	-
22	2505	TUBE - 1/4" X 22" CHECK VALVE TEE TO LEFT CYLINDER BANK UNLOADER	-	-	1	1
23	2870	TUBE - 1/4" X 10" CHECK VALVE TO HYDRAULIC UNLOADER	-	-	1	1
24	1663	TUBE - 1/4" X 23" CHECK VALVE TEE TO RIGHT CYLINDER BANK UNLOADER	-	-	1	1
25	2923	TUBE - 1/4" X 8" HYDRAULIC UNLOADER TO PILOT (RECEIVER) TEE OR CROSS	-	-	1	1
26	6317X	STUD ASSEMBLY - V.D. PILOT MOUNTING	-	1	1	1

V.D. PILOT PRESSURE RANGES

PART NUMBER 6168X1			PART NUMBER 6168X2			PART NUMBER 6168X3			PART NUMBER 6168X4			PART NUMBER 6168X5		
SPRING #3435 (Color-Red)*			SPRING #3078 (Color-Light Yellow)*			SPRING #3030 (Color-Light Green)*			SPRING #5097 (Not Colored)			SPRING #6492 (Color-Light Blue)*		
Unload	Min. Lbs. Dif.	Max. Lbs. Dif.	Unload	Min. Lbs. Dif.	Max. Lbs. Dif.	Unload	Min. Lbs. Dif.	Max. Lbs. Dif.	Unload	Min. Lbs. Dif.	Max. Lbs. Dif.	Unload	Min. Lbs. Dif.	Max. Lbs. Dif.
25	2.5	3.0	50	4.0	9.5	100	6	13	200	15	37	SET 135 PSI - 150 PSI ONLY		
30	3.0	4.5	60	4.5	11.5	110	7	14	225	16	39			
35	3.5	6.0	70	5.5	13.5	120	7	16	250	17	42			
40	3.5	7.0	80	6.0	15.0	130	7	17	275	18	45			
45	4.0	8.5	90	7.0	17.0	140	8	18	300	20	50			
50	4.5	10.0	100	7.5	19.0	150	8	20	325	21	54			
			110	8.0	21.0	175	9	24	350	22	57			
			120	8.5	23.0	200	10	27	375	24	60			
						225	11	31	400	25	65			
						250	12	35	425	26	69			
									450	27	72			
									500	30	80			

*To avoid confusion, please note springs are colored to designate pressure range.

V.D. PILOT ASSEMBLY

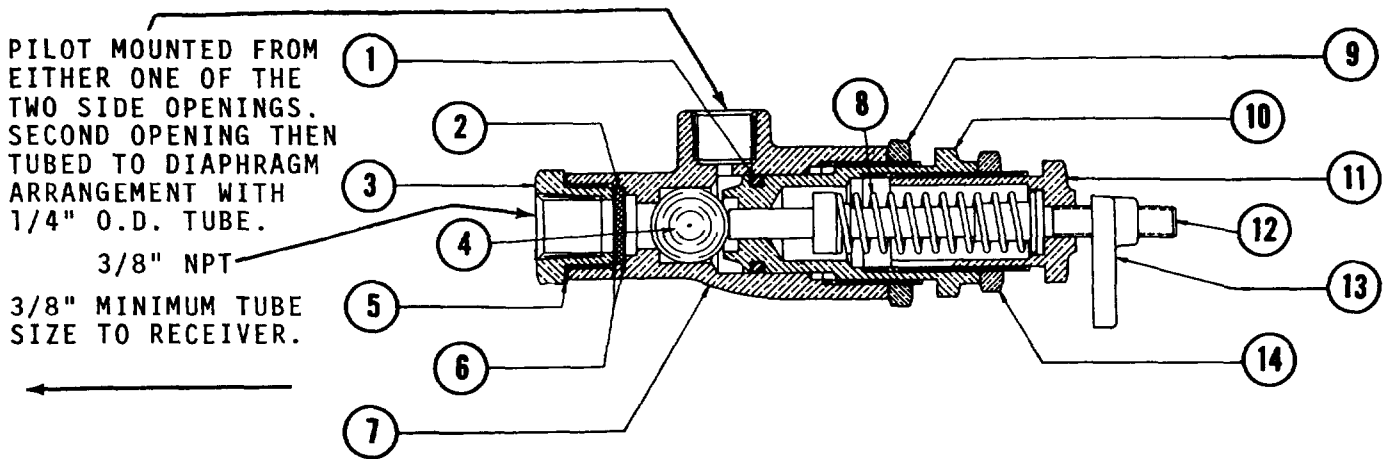

INDEX NUMBER	PART NUMBER	DESCRIPTION	QUANTITY REQUIRED
1	2327	"O" RING - DIFFERENTIAL ADJUSTING SCREW	1
2	5883	FELT - FILTER	1
3	5917	CAP - AIR INLET	1
4	6175	BALL	1
5	6480	GASKET - AIR INLET CAP	1
6	5884	SCREEN - FILTER	2
7	6168	BODY - V.D. PILOT	-
8	3435	SPRING - ADJUSTMENT NOTE: <u>COLORED RED.</u>	::
	3078	SPRING - ADJUSTMENT NOTE: <u>COLORED LIGHT YELLOW.</u>	::
	3030	SPRING - ADJUSTMENT NOTE: <u>COLORED LIGHT GREEN.</u>	::
	5097	SPRING - ADJUSTMENT NOTE: <u>NATURAL FINISH, NOT COLORED.</u>	::
	6492	SPRING - ADJUSTMENT NOTE: <u>COLORED LIGHT BLUE.</u>	::
9	6170	NUT - DIFFERENTIAL SCREW LOCK	1
10	6169	SCREW - DIFFERENTIAL ADJUSTING NOTE: <u>USED WITH 6168X3, 6168X4 & 6168X5 ASSEMBLIES.</u>	::
	6169A	SCREW - DIFFERENTIAL ADJUSTING NOTE: <u>USED WITH 6168X1 & 6168X2 ASSEMBLIES.</u>	::
11	6171	SCREW - PRESSURE ADJUSTING	1
12	6173	ROD - TRIGGER	1
13	6174	NUT - TRIGGER ROD WING	1
14	6172	NUT - PRESSURE ADJUSTING SCREW LOCK	1
<u>ASSEMBLIES</u>			
NOT SHOWN	6168X1	PILOT ASSEMBLY - VARIABLE DIFFERENTIAL (SET 30-40 PSI)	::
NOT SHOWN	6168X1NS	PILOT ASSEMBLY - VARIABLE DIFFERENTIAL (SETTING CAPABILITY: <u>22 PSI MINIMUM CUT-IN PRESSURE, 50 PSI MAXIMUM CUT-OUT PRESSURE.</u>) SEE TABLE FOR V.D. PILOT PRESSURE RANGES.	::
NOT SHOWN	6168X2	PILOT ASSEMBLY - VARIABLE DIFFERENTIAL (SET 70-80 PSI)	::
NOT SHOWN	6168X21	PILOT ASSEMBLY - VARIABLE DIFFERENTIAL (SET 80-90 PSI)	::
NOT SHOWN	6168X22	PILOT ASSEMBLY - VARIABLE DIFFERENTIAL (SET 90-100 PSI)	::
NOT SHOWN	6168X23	PILOT ASSEMBLY - VARIABLE DIFFERENTIAL (SET 100-110 PSI)	::
NOT SHOWN	6168X2NS	PILOT ASSEMBLY - VARIABLE DIFFERENTIAL (SETTING CAPABILITY: <u>40.5 PSI MINIMUM CUT-IN PRESSURE, 120 PSI MAXIMUM CUT-OUT PRESSURE.</u>) SEE TABLE FOR V.D. PILOT PRESSURE RANGES.	::
NOT SHOWN	6168X3	PILOT ASSEMBLY - VARIABLE DIFFERENTIAL (SET 130-140 PSI)	::
NOT SHOWN	6168X31	PILOT ASSEMBLY - VARIABLE DIFFERENTIAL (SET 150-165 PSI)	::
NOT SHOWN	6168X32	PILOT ASSEMBLY - VARIABLE DIFFERENTIAL (SET 165-175 PSI)	::
NOT SHOWN	6168X33	PILOT ASSEMBLY - VARIABLE DIFFERENTIAL (SET 225-250 PSI)	::
NOT SHOWN	6168X3NS	PILOT ASSEMBLY - VARIABLE DIFFERENTIAL (SETTING CAPABILITY: <u>87 PSI MINIMUM CUT-IN PRESSURE, 250 PSI MAXIMUM CUT-OUT PRESSURE.</u>) SEE TABLE FOR V.D. PILOT PRESSURE RANGES.	::
NOT SHOWN	6168X4NS	PILOT ASSEMBLY - VARIABLE DIFFERENTIAL (SETTING CAPABILITY: <u>163 PSI MINIMUM CUT-IN PRESSURE, 500 PSI MAXIMUM CUT-OUT PRESSURE.</u>) SEE TABLE FOR V.D. PILOT PRESSURE RANGES.	::
NOT SHOWN	6168X5	PILOT ASSEMBLY - VARIABLE DIFFERENTIAL (SET 135-150 PSI)	::
NOT SHOWN	6243	KIT - V.D. PILOT REPAIR	::

*ASTERISK INDICATES THAT PARTS CAN BE USED IN THE CATEGORY INDICATED, BUT MUST BE ORDERED AS EACH INDIVIDUAL SITUATION REQUIRES.

HYDRAULIC UNLOADER ASSEMBLY

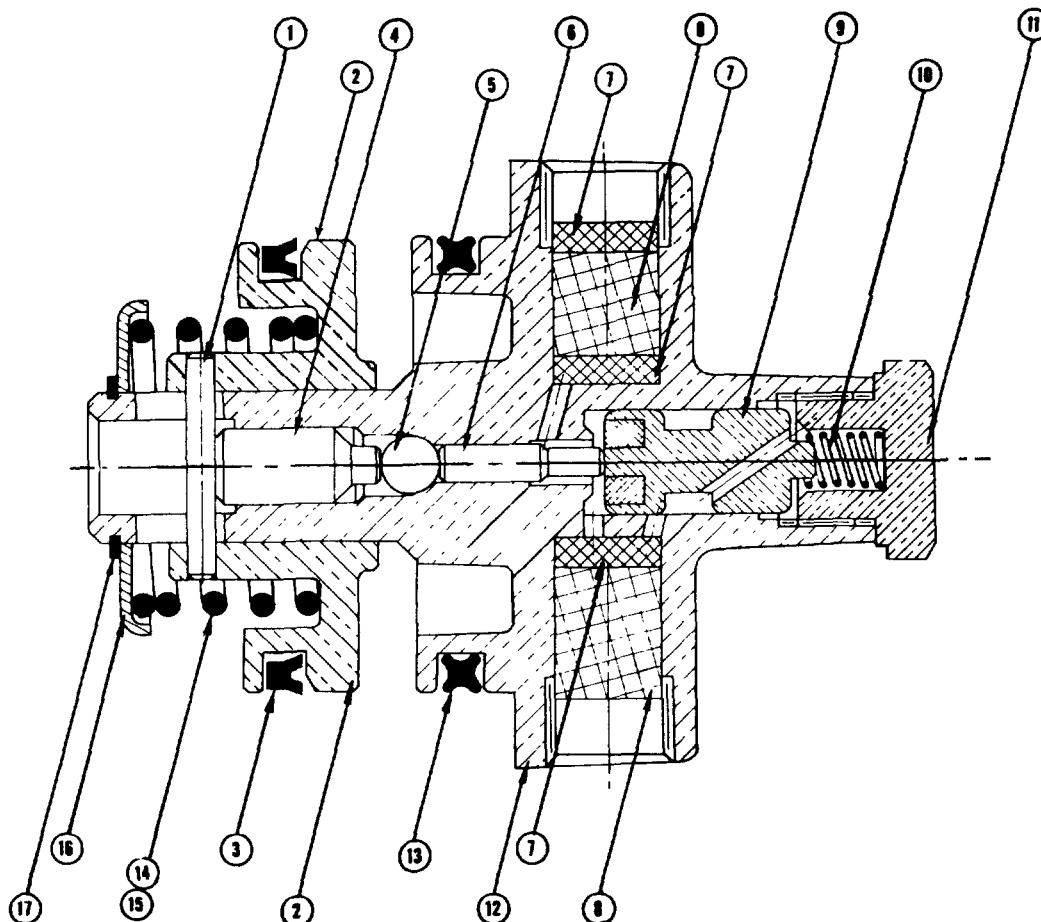

INDEX NUMBER	PART NUMBER	DESCRIPTION	QUANTITY REQUIRED
1	6284	PIN - ROLL	1
2	6279	PISTON	1
3	7958	"V" RING	1
4	7690	PISTON	1
5	5453	BALL	1
6	6281	ROD - PUSH	1
7	6097	SCREEN	3
8	6283	FELT	2
9	1985	VALVE - OUTER	1
10	1884	SPRING	1
11	3437	CAP	1
12	7460	BODY	1
		NOTE: <u>NOT SOLD SEPARATELY.</u>	-
13	6286	QUAD RING	2
14	2326	SPRING	*
		NOTE: <u>USE ONLY FOR AIR PRESSURES UP TO AND INCLUDING 200 PSIG.</u>	*
15	6598	SPRING	*
		NOTE: <u>USE ONLY FOR AIR PRESSURES ABOVE 200 PSIG.</u>	*
16	6304	RETAINER - SPRING	1
17	6285	RING - RETAINING	1
		<u>ASSEMBLIES</u>	
NOT SHOWN	8063	KIT - HYDRAULIC UNLOADER REPAIR	*
NOT SHOWN	7970X	HYDRAULIC UNLOADER ASSEMBLY	*
		NOTE: <u>USE FOR AIR PRESSURES UP TO AND INCLUDING 200 PSIG.</u>	*
NOT SHOWN	7970X1	HYDRAULIC UNLOADER ASSEMBLY	*
		NOTE: <u>USE FOR AIR PRESSURES IN EXCESS OF 200 PSIG. OIL PRESSURE MUST BE INCREASED TO 20 PSIG WHEN COMPRESSOR IS PUMPING IN EXCESS OF 200 PSIG AIR PRESSURE.</u>	*

*ASTERISK INDICATES THAT PARTS CAN BE USED IN THE CATEGORY INDICATED, BUT MUST BE ORDERED AS EACH INDIVIDUAL SITUATION REQUIRES.

DUAL CONTROL CHECK VALVE ASSEMBLY

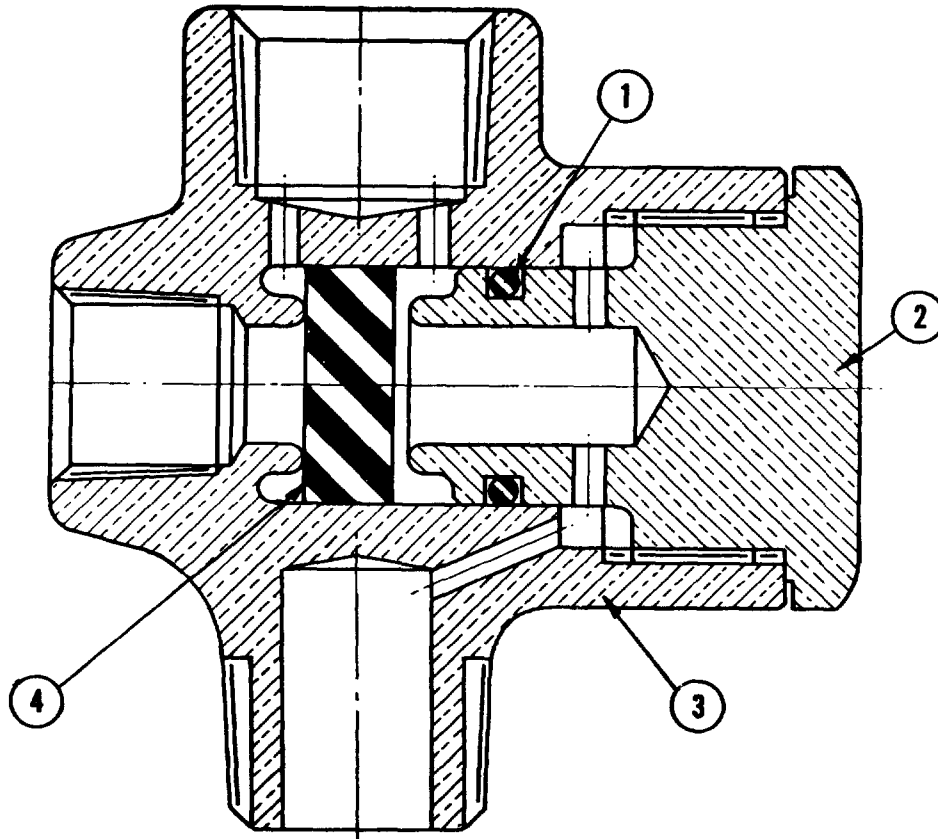

INDEX NUMBER	PART NUMBER	DESCRIPTION	QUANTITY REQUIRED
1	6197	"O" RING - CAP	1
2	6195	SEAT - DUAL CONTROL CHECK VALVE	1
3	6194	BODY - DUAL CONTROL CHECK VALVE	-
4	6196	DISC - DUAL CONTROL CHECK VALVE	1
		<u>ASSEMBLIES</u>	
NOT SHOWN	6194X	VALVE ASSEMBLY - DUAL CONTROL CHECK	1

NUMERICAL PARTS INDEX

PART NUMBER	APPEARS ON		PART NUMBER	APPEARS ON		PART NUMBER	APPEARS ON		PART NUMBER	APPEARS ON	
	PAGE NO.	INDEX NO.		PAGE NO.	INDEX NO.		PAGE NO.	INDEX NO.		PAGE NO.	INDEX NO.
1022	5	24	3186	5	38	6097	13	7	6670	3	18
1160	5	40		6	6	6168	12	7	6670X	3	50
1281	5	41	3201	7	33	6168X1	12	**	6671	3	13
1298	6	17	3324	10	6	6168X1NS	12	**	6671X	3	47
1319	7	32	3435	12	8	6168X2	12	**	6671XU	3	47
1344	7	29	3437	13	11	6168X21	12	**	6678	5	47
1384	6	16	3592	4	4	6168X22	12	**	6679	5	21
1386	5	57	3720	4	14	6168X23	12	**	6726	5	50
1478	6	2	3951	5	33	6168X2NS	12	**	6727	5	48
1498	4	8	4247	2	5	6168X3	12	**	6727X	5	63
1498B	4	8		9	5	6168X31	12	**	6755	5	49
1498C	4	8	4260	4	3	6168X32	12	**	6864	5	54
1556	3	29	4357	4	10	6168X33	12	**	6865	5	56
1602	3	27	4516	10	5	6168X3NS	12	**	6872	9	1
1602X	3	51	4729	7	27	6168X4NS	12	**	6903	5	52
1642	3	33	4805	11	14	6168X5	12	**	6907	5	20
	11	11	4832	6	10	6169	12	10	6908	3	30
1643	10	7	5097	12	8	6169A	12	10	6909	3	11
1663	11	24	5453	13	5	6170	12	9	6910	3	23
1665	3	42	5470	5	23	6171	12	11	6911	3	31
	10	4	5470X	5	60	6172	12	14	6912	3	45
1707	4	6	5483	4	17	6173	12	12	6913X	3	28
1818B	3	35	5484	5	19	6174	12	13	6936	5	51
1849	2	9	5485	5	18	6175	12	4	6959	6	7
1855	3	36	5486	4	12	6194	14	3	6959X	7	39
1857	3	22	5489	5	42	6194X	11	9	6960	6	8
1868	11	21	5489X	5	64		14	**	6977	9	4
1882	3	25	5490	5	43	6195	14	2	6992	7	20
1883	4	5	5491	5	44	6196	14	4	6993	7	21
1884	13	10	5494	5	36	6197	14	1	6994	7	19
1921	11	18	5496	5	25	6200	11	12	6996	7	35
1985	13	9	5518	5	55	6243	12	**	6997	6	13
1990	5	46	5518X1	5	65	6269	5	31		8	4
2015	2	8	5729	3	32	6270	5	32	7382	3	17
2024	3	12	5731	3	19	6279	13	2	7382LBX3H	3	48
2025	2	3	5783	5	53	6281	13	6	7382LBX3L	3	48
2031	7	24	5787OV19	7	37	6283	13	8	7382LBX3P	3	48
2036	2	10	5787OV20	7	37	6284	13	1	7383	3	17
2057	5	58	5788OV10	7	35	6285	13	17	7383RBX3H	3	49
2138	5	30	5788OV20	7	35	6286	5	29	7383RBX3L	3	49
2177	11	13	5812	3	20		13	13	7383RBX3P	3	49
2323	5	34	5827	5	39	6289	5	27	7384	2	2
2326	13	14	5828	2	4	6289X	5	61	7385	3	30
2327	12	1		9	2	6304	13	16	7395	7	26
2505	11	22	5845	7	25	6317	10	2	7398	2	3
2586	3	41	5845OV10	7	25	6317X	11	26	7403	6	11
2616	11	16	5845OV20	7	25	6327	5	28	7435	5	**
2623	3	14	5845XS1	7	36	6443SR	7	28	7460	13	12
2704	11	10	5845XOV10	7	36	6480	12	5	7480	2	1
2706	3	46	5845XOV20	7	36	6492	12	8	7483	3	37
2708	11	17	5846	6	18	6598	13	15	7483X	3	52
2709	3	43	5846OV10	6	18	6640	5	26	7499	3	34
2719	3	30	5846OV20	6	18	6641-1	4	9	7514	5	37
2741	3	26	5846X1	7	34	6641-1X	5	59	7527	7	37
2755S	3	40	5846XOV10	7	34	6641-1X1	5	59	7532X	3	39
	4	13	5846XOV20	7	34	6642	5	35	7690	13	4
2757	9	3	5847	7	22	6642X	5	62	7958	13	3
2763	6	5	5848	7	23	6642X1	5	62	7963	8	2
2769	6	9	5849	6	12	6643	4	7	7964	8	5
2851	4	2	5850	6	14	6645	5	45	7965	8	3
2860	11	19	5856	6	15	6650	4	16	7966	8	6
2866	11	20	5858	2	6	6651	4	11	7968	8	1
2870	11	23		9	4	6652	4	15	7970X	13	**
2906	3	24	5860	6	3	6655	7	31	7970X1	13	**
2923	11	25	5863	6	1	6655X	7	38	8063	13	**
2961-100	3	16	5883	12	2	6656PR	7	30	8109	5	22
3003	11	15	5884	12	6	6656PRUS	7	30	8168	8	7
3008	3	21	5910	3	38	6658	6	4	8299	4	1
3030	12	8	5916	3	15	6664	9	6	8307	4	1
3078	12	8	5917	12	3	6666	2	2	8746	8	**
3080	10	1	5950	3	44	6668	2	7			

*ASTERISK INDICATES THE PART NUMBER SHOWN IS NOT ILLUSTRATED ON THE PAGE INDICATED.

NATIONWIDE SALES/SERVICE

Quincy service is always near. There are more than 135 Authorized Quincy Compressor Service Depots located throughout the United States and Canada. They stock genuine Quincy replacement parts and accessories for a wide range of Quincy compressor models. Service specialists are factory trained and experienced in the compressor field. Quincy service will help keep you in business. Call for Authorized Quincy Compressor Service.

Sales Offices: Albuquerque • Atlanta • Baltimore • Birmingham • Boston • Buffalo • Charlotte • Chicago • Cincinnati • Dallas • Denver • Detroit • Houston • Kansas City • Los Angeles • Milwaukee • Minneapolis • New Orleans • New York • Philadelphia • Portland • St. Louis • San Francisco



Colt Industries



**Quincy Compressor
Division**

217 Maine Street
Quincy, Illinois 62301

A division of the Colt Industries
Operating Corp