

GARDNER-DENVER®

13-9-553
1st Edition

"ECQ"

**ELECTRA-SAVER II® STATIONARY
BASE-MOUNTED COMPRESSORS**

MODELS

ECQQND, ECQSND - 125 HP
ECQQOD, ECQSOD - 150 HP

PARTS LIST

**COOPER**

Gardner-Denver
Industrial Machinery

TABLE OF CONTENTS

GROUP NAME	Models
	ECQ_ND
	ECQ_OD
Thirteen Character Model Designations	Page 2
Introduction.....	Page 3
Ordering Instructions.....	Page 3
Bare Compressor.....	Page 4 & 5
Inlet Valve.....	Page 6
Air Filter Group.....	Page 7
Oil Reservoir Group	Page 8
Separator Housing Group	Pages 9 & 10
Discharge Piping.....	Page 11
Oil Return Line.....	Page 12
Compressor Base Group.....	Page 13
Cooler Group	Pages 14 & 15
Water Cooled Piping.....	Pages 16 thru 19
Control Piping	Pages 20 & 21
Minimum Pressure Valve	Page 22
Filter Assy. (Stat/Fil).....	Page 23
Enclosure	Pages 24 thru 27
Vent Fan Group.....	Page 28
Motor Mounting Parts.....	Page 29
Motor Selectives	Page 30
Decal Location	Page 31
Controller Assembly.....	Pages 32 & 33
Repair Kits	Pages 34 & 35

**MODELS ECQ_ND & ECQ_OD 125/150 HP Air/Water-Cooled Base-Mounted Units
Electra-Saver II® Compressors – Matrix/Menu**

Notice to Customer -- To find the construction options for your compressor unit, FILL IN THE BALANCE OF LETTERS OR NUMBERS FROM YOUR UNIT NAMEPLATE. . .

E	C	Q			D		9						
1	2	3	4	5	6	7	8	9	10	11	12	13	

Column Number:
Follow the line down and over from each space thus filled in to find the appropriate construction with which your machine is equipped. The number "9" in any column space indicates "NOT APPLICABLE." The number "8" in any column space indicates special design -- Refer to Factory Order Ticket.

COLUMNS 1 & 2 - ELECTRA-SAVER II® Family -- Single Stage

COLUMN 3 - AIR END

COLUMN 4 - CONSTRUCTION

- Q. Air-Cooled - Base Mounted (Std)
- S. Water-Cooled - Base Mounted (Std)

COLUMN 5 - HORSEPOWER

- N. 125 HP
- O. 150 HP

COLUMN 6 - ENGINEERING SPECIFICATION

COLUMN 7 - PRESSURE & HZ

- A. 100 PSIG - 60 HZ
- B. 125 PSIG - 60 HZ
- C. 150 PSIG - 60 HZ

COLUMN 8 - SKIP - ENTER A "9" IN THIS COLUMN

COLUMN 9 - CONTROL BOX STARTER (Per HP/Voltage)/NEMA

- | | | |
|-------------------------|-------------------------|-----------------------|
| A. 125 HP - 200V - N 12 | G. 150 HP - 460V - N 12 | M. 150 HP - 200V - N4 |
| B. 125 HP - 230V - N 12 | H. 150 HP - 575V - N 12 | N. 150 HP - 230V - N4 |
| C. 125 HP - 460V - N 12 | I. 125 HP - 200V - N4 | O. 150 HP - 460V - N4 |
| D. 125 HP - 575V - N 12 | J. 125 HP - 230V - N4 | P. 150 HP - 575V - N4 |
| E. 150 HP - 200V - N 12 | K. 125 HP - 460V - N4 | |
| F. 150 HP - 230V - N 12 | L. 125 HP - 575V - N4 | |

COLUMN 10 - ENCLOSURE

- A. NO ENCLOSURE (AIR/WATER COOLED)
- B. AIR COOLED ONLY (W/ENCLOSURE)
- C. WATER COOLED - 200V OR AIR COOLED W/REM COOLER
- D. WATER COOLED - 230V OR AIR COOLED W/REM COOLER
- E. WATER COOLED - 460V OR AIR COOLED W/REM COOLER
- F. WATER COOLED - 575V OR AIR COOLED W/REM COOLER

COLUMN 11 - OIL COOLERS - AIR & WATER

- | | | | |
|---------------------------------|-------------------------------|----------------------------|----------------------------------|
| AIR COOLED - W/AFTERCOOLER | | WATER COOLED - FRESH WATER | |
| A. WITH STD CLR - 60 HZ | G. WITHOUT AFTERCOOLER | H. WITH AFTERCOOLER | I. WITHOUT AFT - WITH TEMP. REG. |
| B. WITH SEACOAST COOLER - 60 HZ | J. WITH AFT - WITH TEMP. REG. | | |

COLUMN 12 - COOLER ELECTRICS

- | | | | |
|-----------------|-----------|--------------|-----------------------------|
| AIR COOLED | | WATER COOLED | |
| A. 200V - 60 HZ | J. NEMA 1 | K. NEMA 4 | L. LESS WATER SHUTOFF VALVE |
| B. 230V - 60 HZ | | | |
| C. 460V - 60 HZ | | | |
| D. 575V - 60 HZ | | | |

COLUMN 13 - COMPRESSOR DRIVE MOTOR

- | | | | |
|-----------------|-----------------|--------------------------------|---------------------------------|
| ODP (STD. EFF.) | | TEFC (STD. EFF.) | |
| A. 200V - 60 HZ | I. 200V - 60 HZ | J. 230V - 60 HZ | K. 460V - 60 HZ |
| B. 230V - 60 HZ | L. 575V - 60 HZ | | |
| C. 460V - 60 HZ | | | |
| D. 575V - 60 HZ | | | |
| ODP (HI-EFF.) | | TEFC (HI-EFF.) | |
| E. 200V - 60 HZ | M. 200V - 60 HZ | N. 230V - 60 HZ | O. 460V - 60 HZ |
| F. 230V - 60 HZ | P. 575V - 60 HZ | Q. LESS MOTOR 404 & 405 Frames | R. LESS MOTOR 444 to 449 Frames |
| G. 460V - 60 HZ | | | |
| H. 575V - 60 HZ | | | |

INTRODUCTION

CONTENTS:

This Parts List Manual contains repair parts for all models in the Electra-Saver[®] Stationary Screw Compressor line shown on the cover.

Following is a list of comments to guide you in the selection of pages that are applicable to your particular unit.

MODEL DESIGNATIONS:

The new thirteen digit Model Designations will reflect the optional or selective types of construction available on these units, however, if an "8" appears in any column, the original order and subsequent machine ticket must always be referred to when ordering repair parts for that option (see Ordering Instructions below).

Early model designations DO NOT reflect the optional or selective types of construction available on these units. The original order and subsequent machine ticket must always be referred to when ordering repair parts (see Ordering Instruction Page).

The following are offered as a guide in showing the various types of construction:

- Air Cooled (With Radiator Module) vs. Water Cooled (With Heat Exchanger).

- With or without Aftercooler for both Air-Cooled and Water-Cooled Units.
- "Fresh Water" or "Salt Water" Service with Water-Cooled Units.
- Pressure ratings (100, 125 or 150 PSIG) - these differences are reflected in the selection offered for Gear Kits and Pressure Relief Valves.

Above items are covered in this Parts List Manual. Additional items NOT covered are as follows:

Motors, Motor Starters, Overload Heaters, and various electrical components. There is a wide selection of these items available in all of the constructions listed above. All repair orders for these items must be referred to the factory.

QUALITY OF PARTS:

Numerous mounting components, such as piping, tubing, fasteners, minor electrical parts and wiring, etc., may be purchased from your local supply source. However, it is emphasized that **IT IS THE RESPONSIBILITY OF THE CUSTOMER** when purchasing repair parts locally to use only parts that are of **EQUAL** or better quality than those used in the original construction.

INSTRUCTIONS FOR ORDERING REPAIR PARTS

When ordering parts, specify Compressor **MODEL**, Method of Cooling, **HORSEPOWER** and **SERIAL NUMBER** (see nameplate on unit). Serial Number is also stamped on top of the cylinder flange to the right of the inlet housing.

All orders for Parts should be placed with the nearest Sales and Service Office.

Where NOT specified, quantity of parts required per compressor or unit is one (1); where more than one is required per unit, quantity is indicated in parenthesis. **SPECIFY EXACTLY THE NUMBER OF PARTS REQUIRED.**

DO NOT ORDER BY SETS OR GROUPS.

To determine the Right Hand and Left Hand side of an Electra-Saver[®] compressor, stand at the motor end and look toward the compressor. Right Hand and Left Hand are indicated in parenthesis following part name, i.e. (RH) & (LH).

PARTS RETURNED

All claims must be made within five days after receipt of goods. If order has been filled correctly, we cannot allow

the return of the goods without our consent and then only on a basis of a charge for service and rehandling plus transportation charges.

Transportation charges must be prepaid. If it is necessary to return a part to the factory for duplication or inspection, do not fail to do the following:

1. Write the nearest Sales and Service Office a letter advising what material you wish to return and why.
2. After receiving permission to return the item or items, obtain from the Sales and Service Office the correct forms filled out by that office for the proper return of material.
3. Place a tag in the package showing your name and address.
4. Tag each article in the box or package stating what and how many are returned.
5. Always give the serial number of the machine from which the parts were removed or the invoice number on which the parts were originally shipped.

All parts returned for credit should be handled in the same manner as that for duplication or inspection.

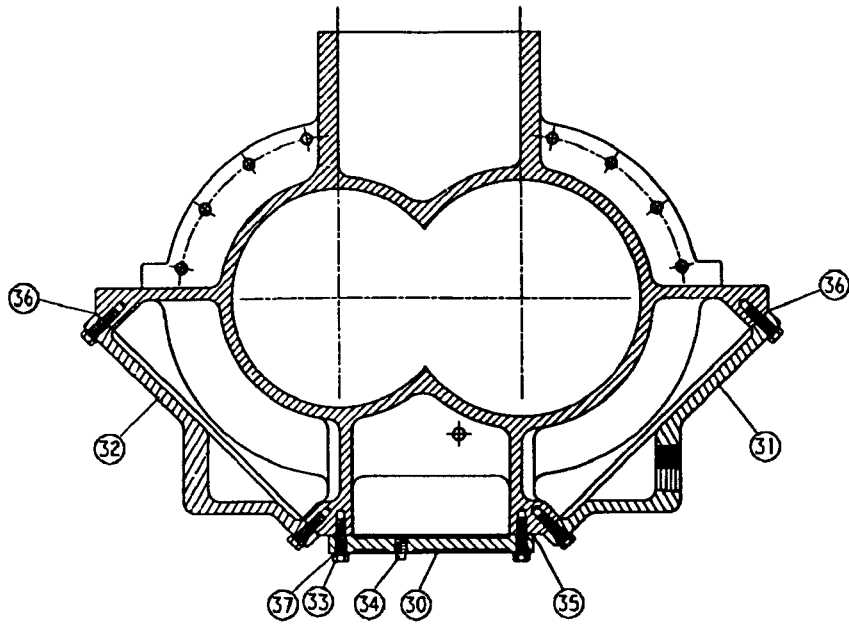

218SSQ810

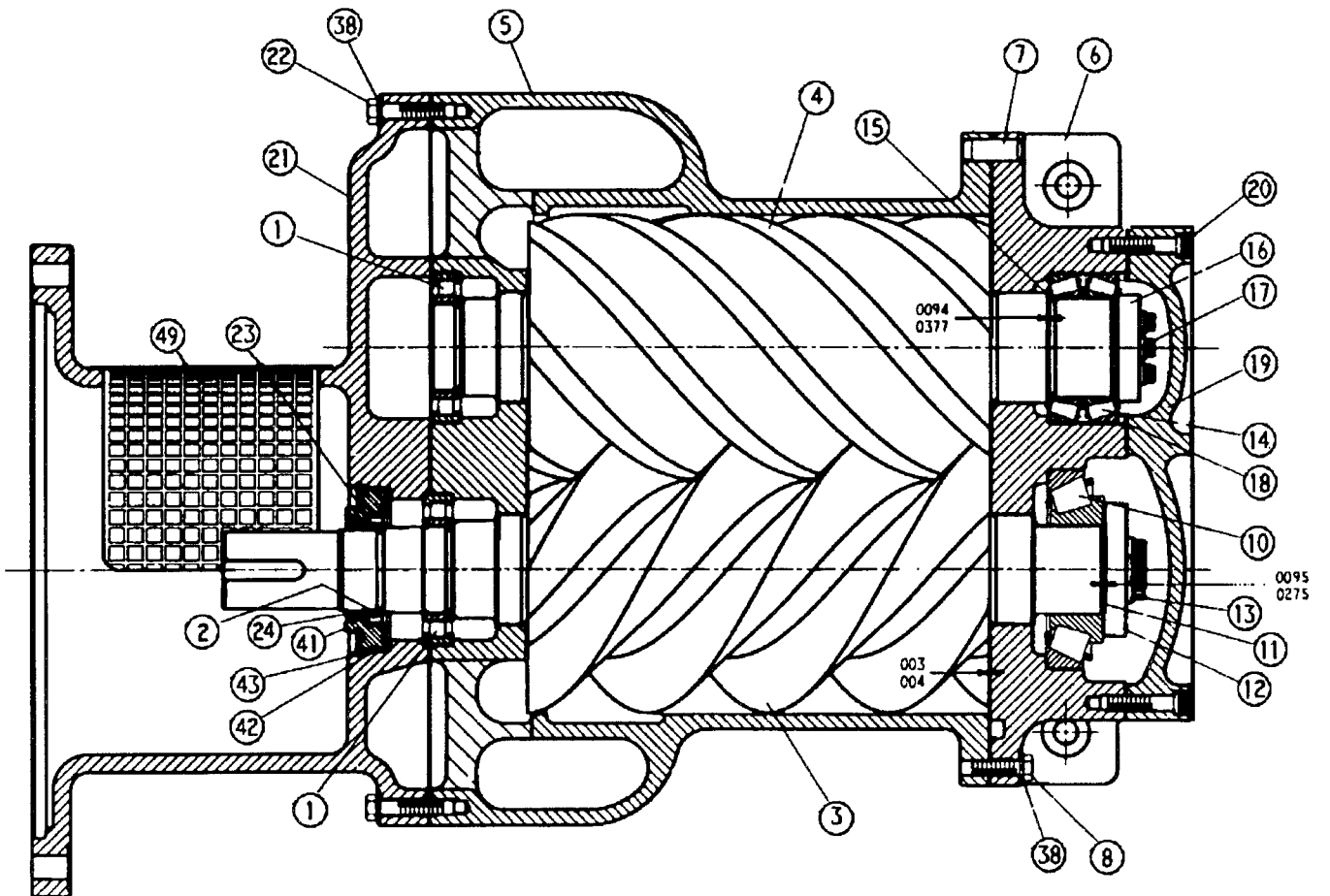

Order by Part Number and Description. Reference Numbers are for your convenience only.

Ref. No.	Name of Part	Qty.	125 HP-7A 150 HP-7B	150 HP-7A	125 HP-7B & 7C 150 HP-7C
	BARE COMPRESSOR		Part No. SSQMBB01	Part No. SSQMBB02	Part No. SSQMBB04
1	BEARING-ROLLER.....	2	12BA126	12BA126	12BA126
2	SLEEVE-WEAR.....	1	80M28	80M28	80M28
3	ROTOR.....	1	212SSQ010	210SSQ010	214SSQ010
4	ROTOR.....	1	213SSQ010	211SSQ010	215SSQ010
5	CYLINDER.....	1	211SSQ002	210SSQ002	212SSQ002
6	HOUSING-BEARING.....	1	214SSQ006	214SSQ006	214SSQ006
7	PIN-DOWELL.....	1	62M112	62M112	62M112
8	SCREW-HEX CAP.....	22	655EE070	655EE070	655EE070
9	GASKET-ELIMINATOR.....	10000	25BC256	25BC256	25BC256
10	BEARING-ROLLER.....	1	12BA138	12BA138	12BA138
11	SHIM SET-SHAFT.....	1	77C36	77C36	77C36
12	PLATE-BEARING RETAINER.....	1	202SSQ253	202SSQ253	202SSQ253
13	SCREW-12 PT CAP.....	3	75LM125N	75LM125N	75LM125N
14	BEARING-ROLLER.....	1	12BA78	12BA78	12BA78
15	SHIM.....	2	77H50015	77H50015	77H50015
15	SHIM.....	3	77H50002	77H50002	77H50002
15	SHIM.....	3	77H50003	77H50003	77H50003
15	SHIM.....	3	77H50005	77H50005	77H50005
16	PLATE-BEARING RETAINER.....	1	201SSU253	201SSU253	201SSU253
17	SCREW-12 PT CAP.....	3	2009630N	2009630N	2009630N
18	SPRING-WAVE.....	1	78W49	78W49	78W49
19	PLATE-BEARING COVER.....	1	208SSQ315	208SSQ315	208SSQ315
20	SCREW-12 PT CAP.....	22	75P78	75P78	75P78
21	ADAPTOR.....	1	203SSQ170	203SSQ170	203SSQ170
22	SCREW-HEX CAP.....	22	655EE090	655EE090	655EE090
23	SEAL-OIL.....	1	60DD571	60DD571	60DD571
24	SEAL-OIL.....	1	60DD562	60DD562	60DD562
30	COVER.....	1	203SSQ225	203SSQ225	203SSQ225
31	COVER.....	1	204SSQ225	204SSQ225	204SSQ225
32	COVER.....	1	205SSQ225	205SSQ225	205SSQ225
33	SCREW-HEX CAP.....	46	655ED050	655ED050	655ED050
34	PLUG-SQHD PIPE.....	1	64AA6	64AA6	64AA6
35	GASKET.....	1	214SSQ715N	214SSQ715N	214SSQ715N
36	GASKET.....	2	215SSQ715N	215SSQ715N	215SSQ715N
37	WASHER-LOCK.....	46	95B3	95B3	95B3
38	WASHER-LOCK.....	44	95B5	95B5	95B5
40	HOUSING-SEAL.....	1	206SSQ362	206SSQ362	206SSQ362
41	O-RING.....	1	25BC378	25BC378	25BC378
42	RING-RETAINER.....	1	74D55	74D55	74D55
--	GUARD-COUPLING.....	1	200SSQ339	200SSQ339	200SSQ339
--	SCREW-FLANGED.....	4	75LM150	75LM150	75LM150

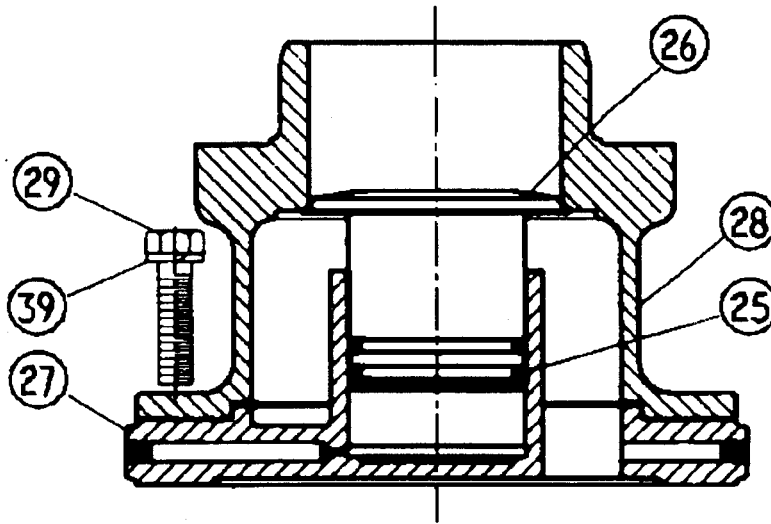

INLET VALVE

DET. NO.	NAME OF PART	QTY	PART NO.
25	PACKING-RING.....	2	60DD561
26	PISTON-INLET VALVE.....	1	200SSQ043
27	HOUSING-INLET	1	202SSQ041
28	SEAT.....	1	201SSQ256
29	SCREW-HEX CAP.....	8	655EG120
39	WASHER-LOCK.....	8	95B8

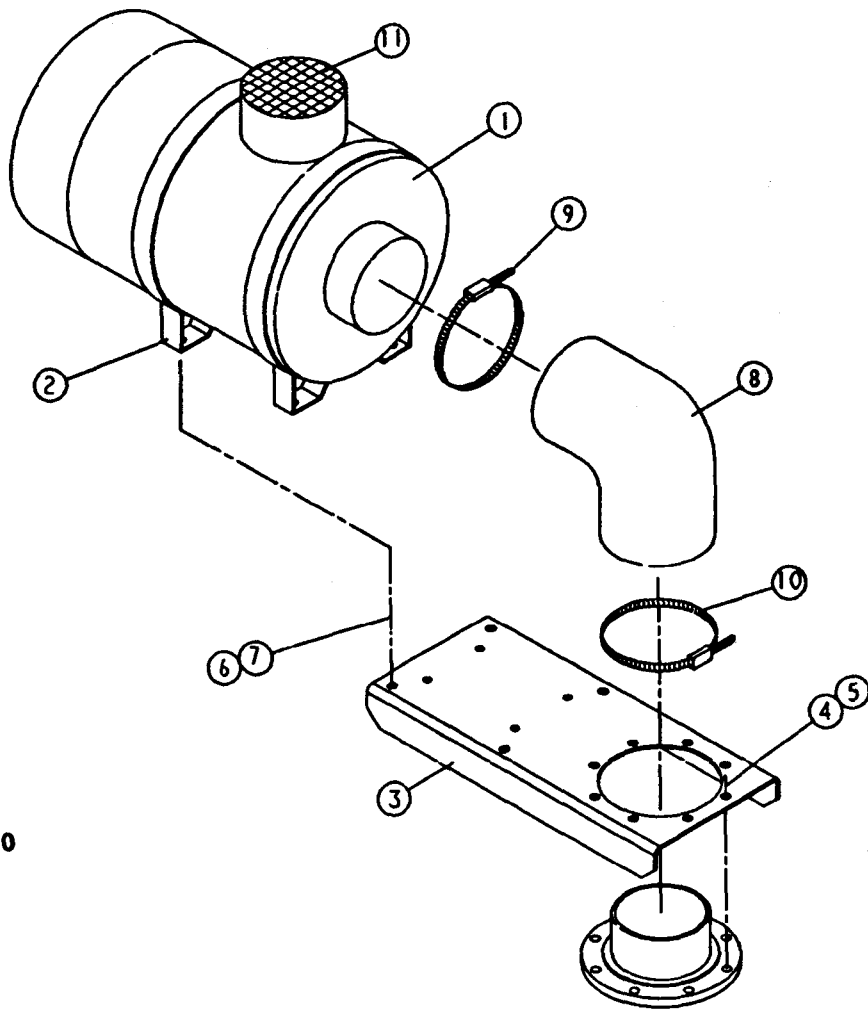

279ECM810

DET. NO.	NAME OF PART	QTY	PART NO.
1	FILTER-AIR	1	5L8
2	BAND-MOUNTING	2	2010066
3	BRACKET-FILTER	1	203EAQ389
4	SCREW-HEX HD	4	655EE040
5	WASHER-LOCK	4	95B5
6	SCREW-FLANGED	4	75K48
7	NUT-FLANGED	4	50AW5
8	HOSE-MOLDED	1	29Z96
9	CLAMP-HOSE	1	2009499
10	CLAMP-HOSE	1	29B46
11	CAP-SCREEN ASM	1	5L9
--	ELEMENT-AIR FILTER	1	2010509

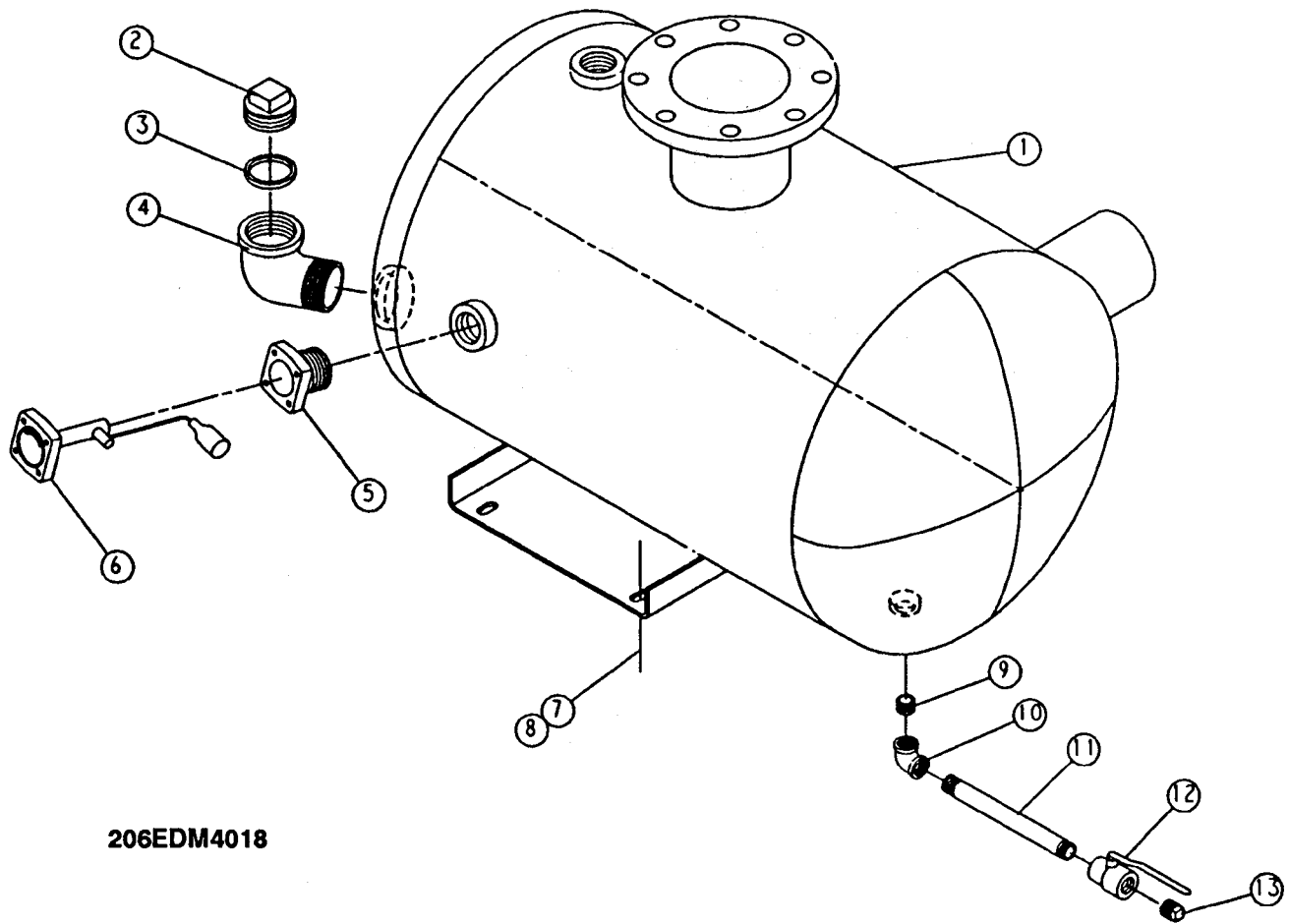

206EDM4018

OIL RESERVOIR

DET. NO.	NAME OF PART	QTY	PART NO.
1	RESERVOIR-OIL.....	1	200EDM037
2	COVER-FILTER.....	1	200SPF156
3	O-RING.....	1	25AH5
4	ELBOW.....	1	200LSF262
5	ADAPTOR-GAUGE.....	1	200EDE058
6	GAUGE-FLOAT.....	1	200ECM303
7	SCREW-FLANGED.....	4	75LM135
8	NUT-FLANGED.....	4	50AW35
9	NIPPLE-PIPE.....	1	63F1G
10	ELBOW-PIPE.....	1	64C4G
11	NIPPLE-PIPE.....	1	63F15G
12	VALVE-BALL.....	1	90AR360
13	PLUG-SQHD PIPE.....	1	64AA7
--	GASKET-FLOAT GAUGE.....	1	54C204

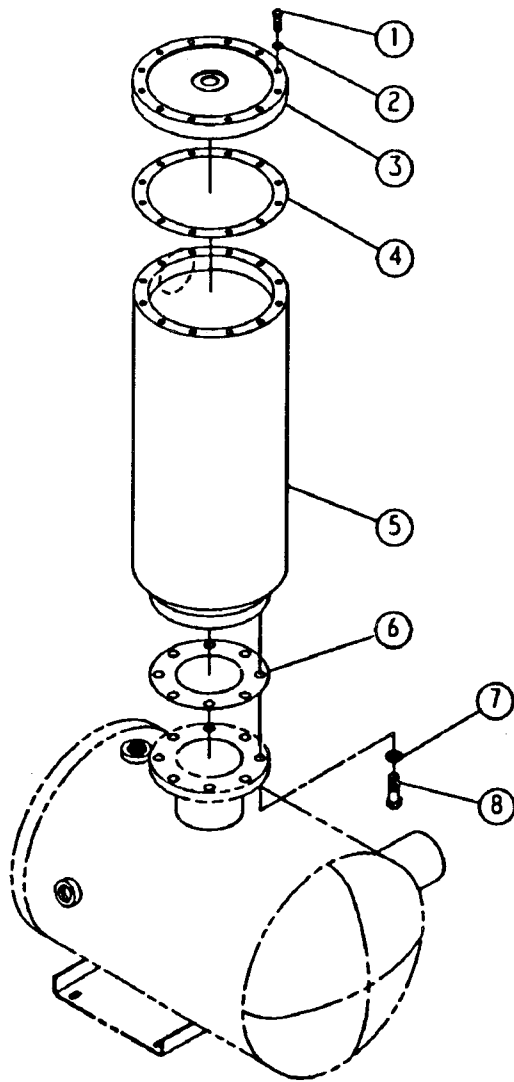

209EDM810

SEPARATOR HOUSING

DET. NO.	NAME OF PART	QTY	PART NO.
1	SCREW-HEX HD	12	655EE090
2	WASHER-LOCK	12	95B5
3	COVER.....	1	200EDM225
4	GASKET.....	1	200EDM715N
5	HOUSING.....	1	200EDM405
6	GASKET.....	1	25C807N
7	WASHER-LOCK	8	95B8
8	SCREW-HEX HD	8	655EG080

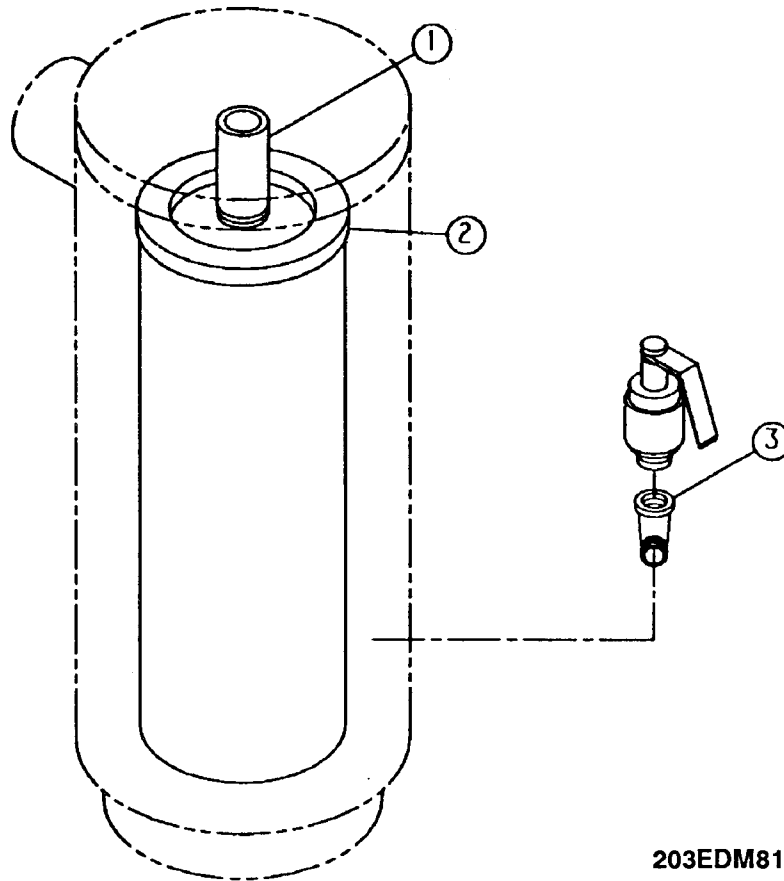

203EDM810

SEPARATOR GROUP

DET. NO.	NAME OF PART	QTY	PART NO.
1	NIPPLE-PIPE	1	201EDM392
2	OIL SEPARATOR.....	1	55B44
3	ELBOW-PIPE ST	1	64D8G
-	RELIEF VALVE.....	1	
	100 PSI.....		90AR510
	125 PSI.....		90AR532
	150 PSI.....		90AR649

SEPARATOR REPAIR KIT - 202EDP6013 (55B44 OIL SEPARATOR & 200EDM715N GASKET)

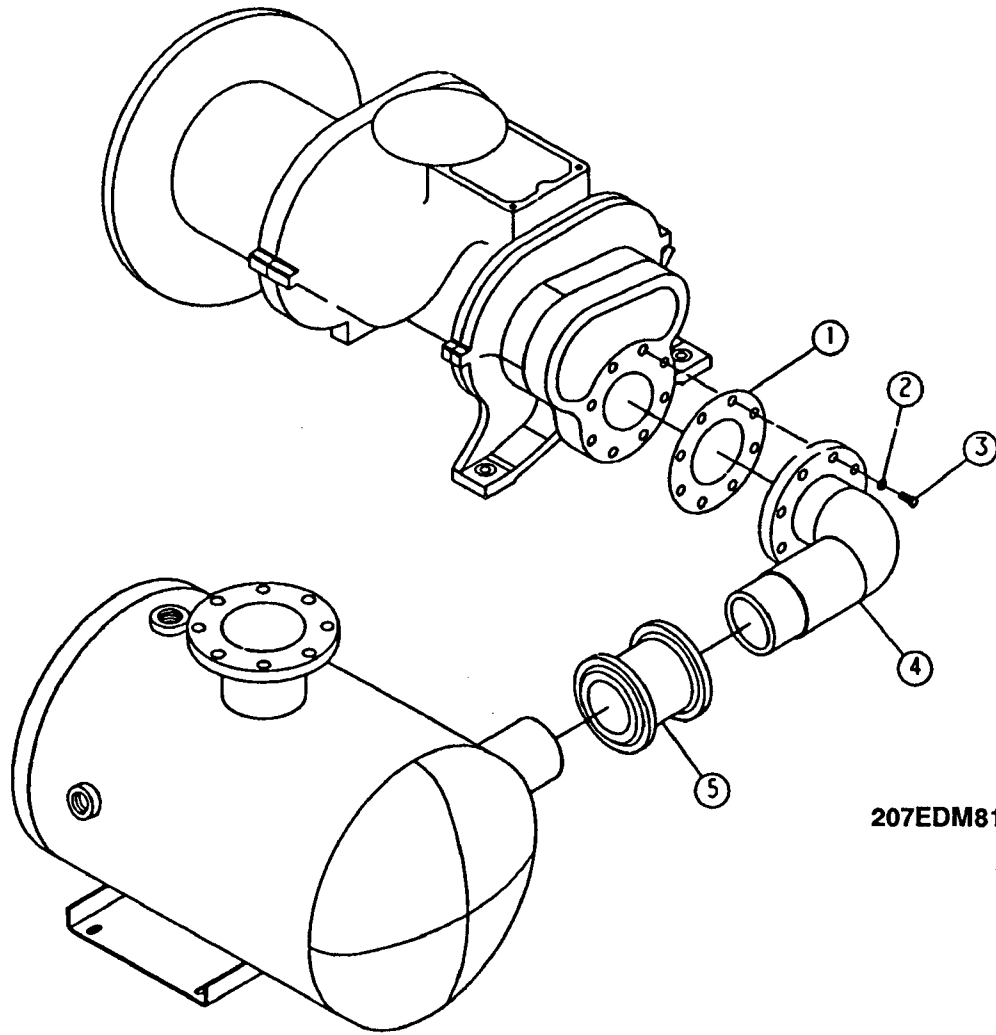

207EDM810

COMPRESSOR DISCHARGE PIPING

DET. NO.	NAME OF PART	QTY	PART NO.
1	GASKET RING.....	1	25C603N
2	WASHER-LOCK.....	8	95B7
3	SCREW-HEX HD.....	8	655EF080
4	MANIFOLD.....	1	200EDM286
5	COUPLING-FLEX.....	1	64EB329
--	GASKET, FLEX COUPLING.....	2	2109776

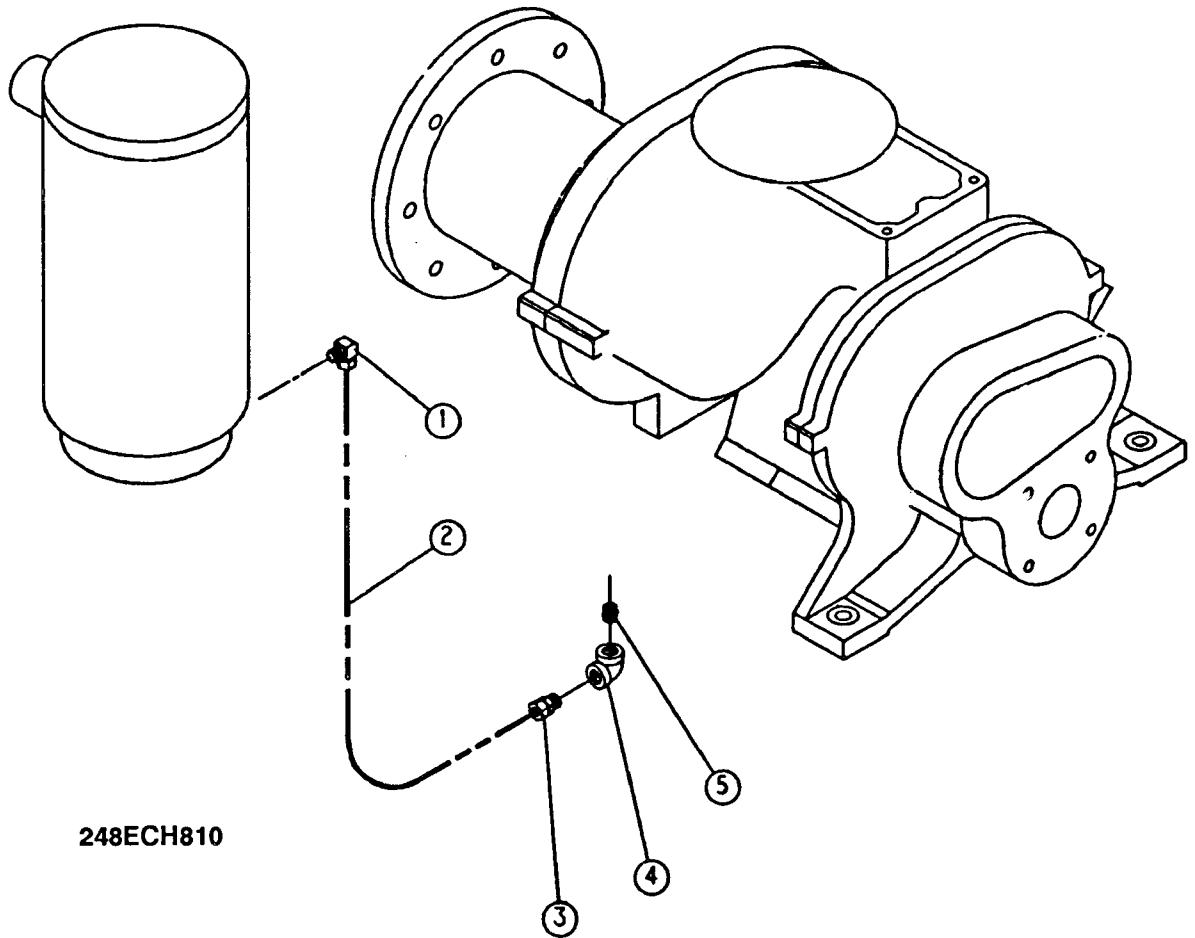

248ECH810

OIL RETURN LINE

DET. NO.	NAME OF PART	QTY	PART NO.
1	ELBOW-TUBE	1	86E60
2	TUBE.....	10 FT.	85K3
3	CONNECTOR-TUBE	1	86E4
4	ELBOW-PIPE.....	1	64C3G
5	NIPPLE-PIPE	1	63C1G

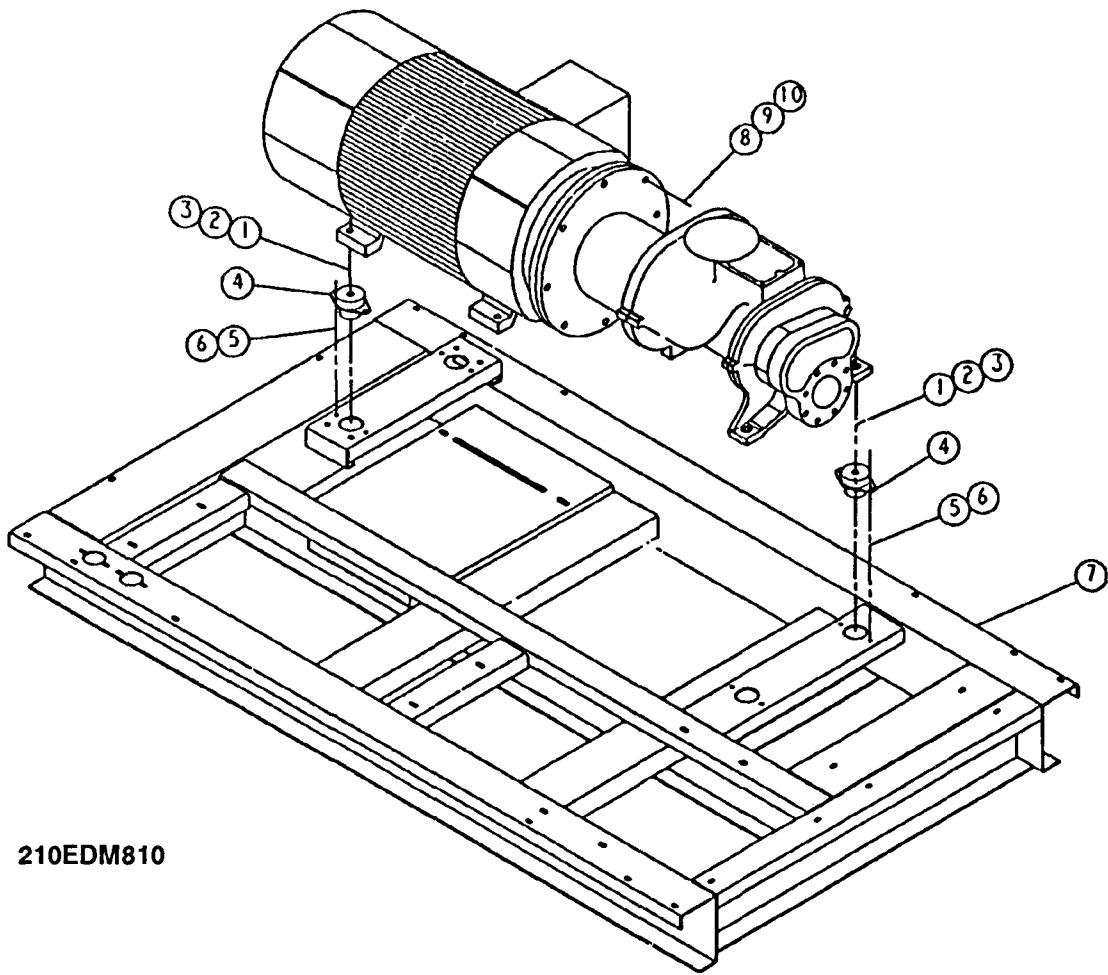

210EDM810

BASE AND MOUNTING

DET. NO.	NAME OF PART	QTY	PART NO.
1	SCREW-HEX CAP	4	655EF200
2	WASHER-LOCK.....	4	95B7
3	NUT-HEX	4	50B7
4	ISOLATOR-VIB	4	49C48
5	SCREW-FLANGED.....	8	75LM135
6	NUT-FLANGED.....	8	50AW35
7	BASE.....	1	206EAQ285
8	NUT-HEX	8	50B8
9	WASHER-LOCK.....	8	95B8
10	SCREW-HEX HD	8	655EG140
*	KEY-SQ.....	1	35B243
*	COUPLING-FLEX (51L59/51L62) - See Pages 29 & 35.....	1	*

* NOT SHOWN

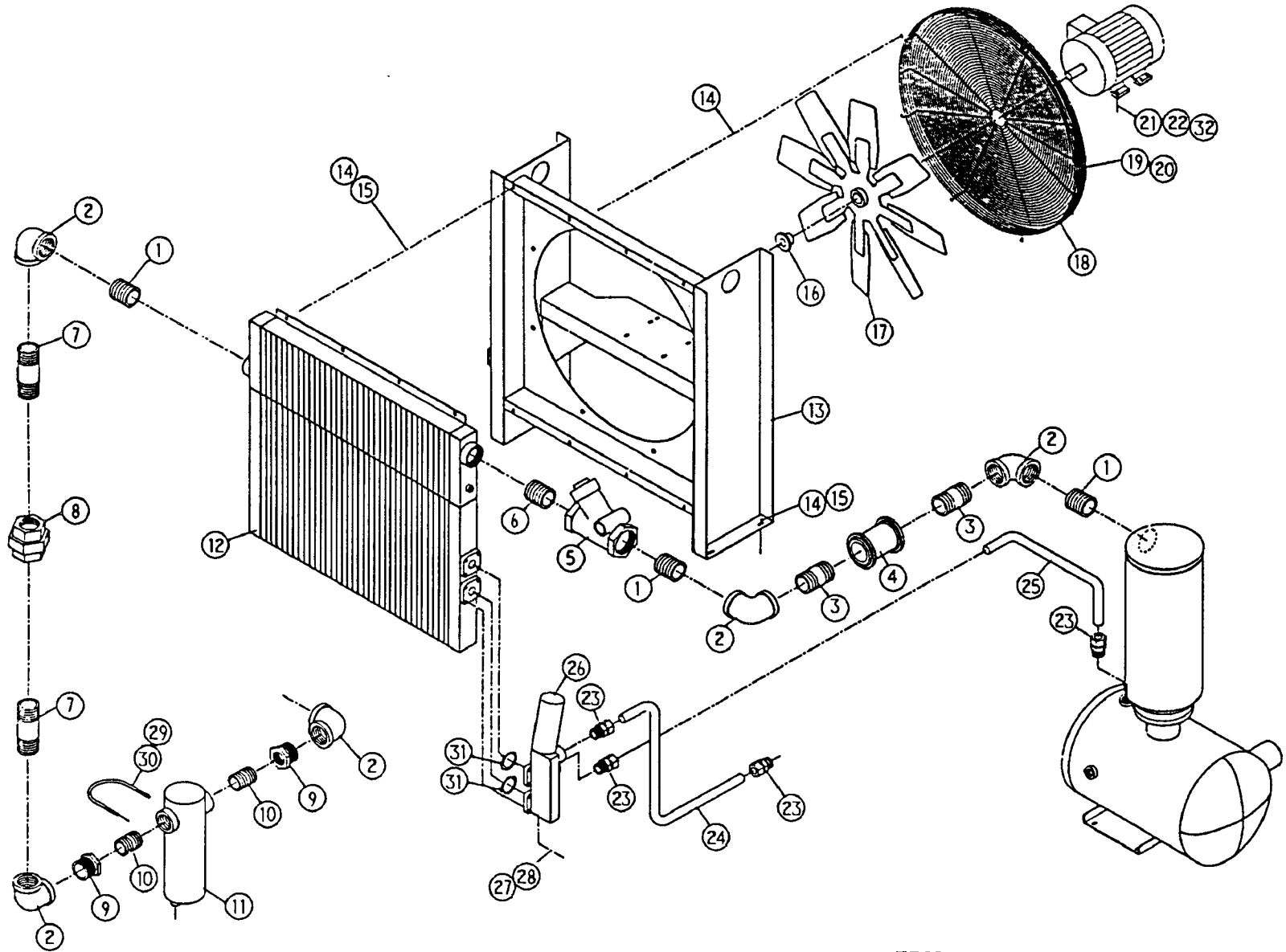

205EDM810

COOLER GROUP

DET. NO.	NAME OF PART	QTY	PART NO.
1	NIPPLE-PIPE.....	3	63P1G
2	ELBOW-PIPE	5	64C10G
3	NIPPLE-PIPE.....	2	63AJ48X44G
4	COUPLING-FLEX.....	1	64EB328
5	VALVE-M/PRESS & CHECK..	1	200EDM527
6	PIPE NIPPLE.....	1	63P10G
7	NIPPLE-PIPE.....	2	63P17G
8	UNION-STRAIGHT.....	1	64Z21
9	BUSHING-PIPE.....	2	64E33
10	NIPPLE-PIPE.....	2	63M3G
11	SEPARATOR-MOISTURE.....	1	83C92
12	COOLER-OIL	1	200EDM201
13	SUPPORT.....	1	200EDM165
14	SCREW-FLANGED	20	75LM51
15	NUT-FLANGED	12	50AW5
16	BUSHING-HUB.....	1	22G2

DET. NO.	NAME OF PART	QTY	PART NO.
17	FAN.....	1	200EAQ701
18	GUARD-FAN.....	1	200EDM393
19	SCREW-FLANGED.....	4	75LM50
20	NUT-FLANGED.....	4	50AW4
21	SCREW-FLANGED.....	4	75LM78
22	NUT-FLANGED.....	4	50AW5
23	CONNECTOR-TUBE	4	86N105
24	TUBE-FORMED	1	203ECQ857
25	TUBE-FORMED.....	1	200EDM857
26	ASM-STAT/FILTER	1	200EDM2045
27	SCREW-HEX HD	8	655EE060
28	WASHER-LOCK.....	8	95B5
29	U-BOLT	1	15U75
30	NUT-FLANGED.....	2	50AW35
31	O-RING	2	25BC387
32	WASHER-PLAIN	4	95W15
--	GASKET, FLEX COUPLING...	2	2109775

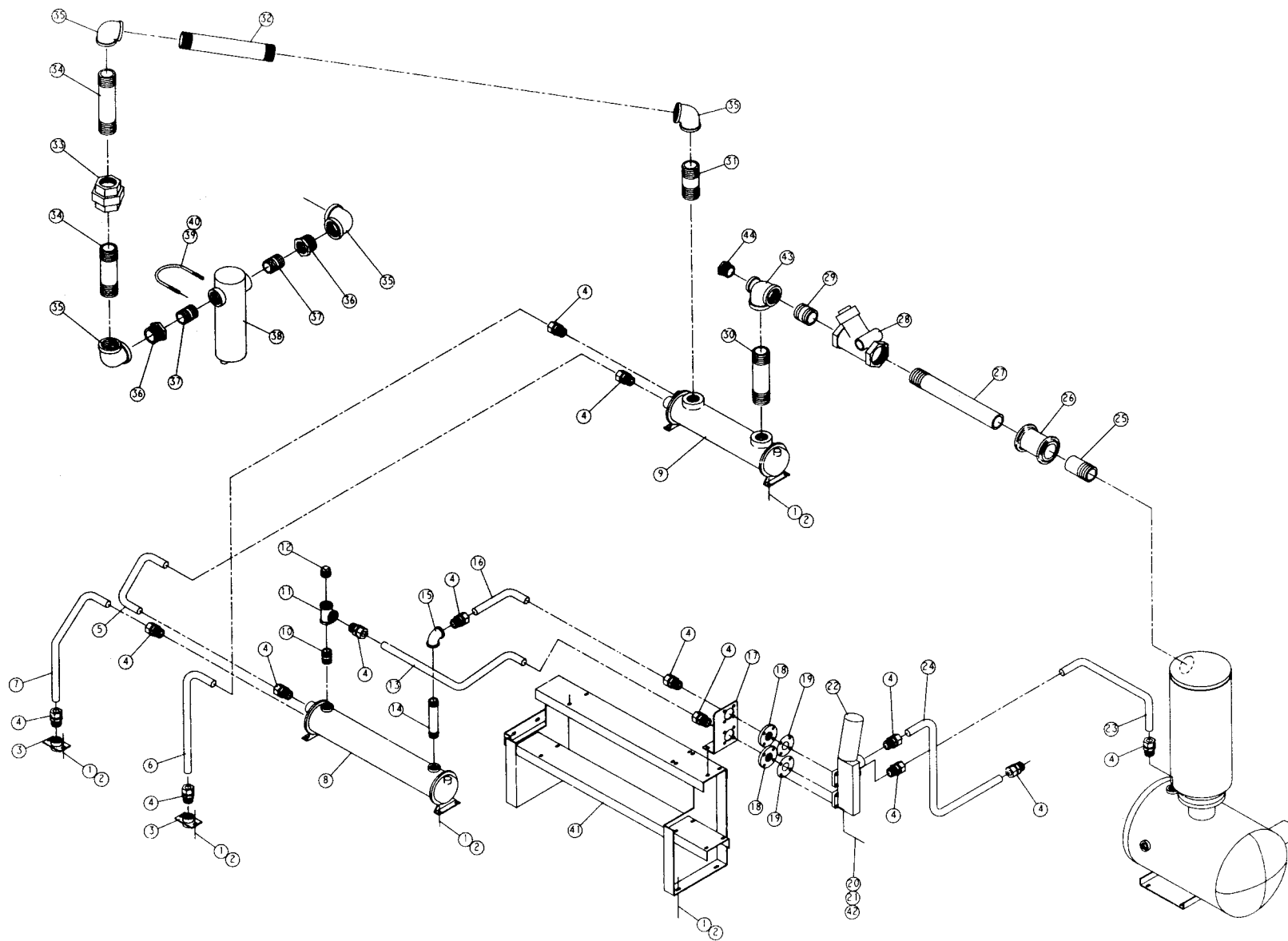

211EDM810

WATER COOLED PIPING WITH AFTERCOOLER

DET. NO.	NAME OF PART	QTY	PART NO.	DET. NO.	NAME OF PART	QTY	PART NO.
1	SCREW-FLANGED	18	75LM51	25	NIPPLE-PIPE.....	1	63AJ48X50G
2	NUT-FLANGED.....	18	50AW5	26	COUPLING-FLEX.....	1	64EB328
3	MANIFOLD-WATER.....	2	200EDM072	27	NIPPLE-PIPE.....	1	63AJ48X200G
4	CONNECTOR-TUBE	14	86N105	28	VALVE-M/PRESS & CHECK..	1	200EDM527
5	TUBE-FORMED	1	206EDM857	29	NIPPLE-PIPE.....	1	63P1G
6	TUBE-FORMED	1	207EDM857	30	NIPPLE-PIPE.....	1	63N48X134G
7	TUBE-FORMED	1	209EDM857	31	NIPPLE-PIPE.....	1	63P15G
8	HEAT EXCHANGER	1	200EDM349	32	NIPPLE-PIPE.....	1	63N48X200G
9	AFTERCOOLER.....	1	200EDM292	33	UNION-STRAIGHT.....	1	64Z21
10	NIPPLE-PIPE	1	63K20G	34	NIPPLE-PIPE.....	2	63P17G
11	TEE-PIPE	1	64G11G	35	ELBOW-PIPE	4	64C10G
12	PLUG-SQHD PIPE.....	1	64A8	36	BUSHING-PIPE.....	2	64E33
13	TUBE-FORMED	1	204EDM857	37	NIPPLE-PIPE.....	2	63M3G
14	NIPPLE-PIPE	1	63K10G	38	SEPARATOR-MOISTURE.....	1	83C92
15	ELBOW-PIPE.....	1	64C8G	39	U-BOLT	1	15U75
16	TUBE-FORMED	1	205EDM857	40	NUT-FLANGED	2	50AW35
17	BRACKET (FORMED)	1	200EDM142	41	SUPPORT	1	201EDM165
18	FLANGE-THREADED	2	64DC3	42	NUT-HEX.....	8	50B5
19	O-RING	2	25BC387	44	BUSHING-PIPE.....	1	64E60
20	SCREW-HEX HD	8	655EE060	45	TEE-PIPE.....	1	8503783
21	WASHER-LOCK.....	8	95B5	--	GASKET, FLEX CPLG.....	2	2104775
22	ASM-STAT/FILTER	1	200EDM2045		WATER VALVES (OPTIONAL)		
23	TUBE-FORMED	1	202EDM857		WATER TEMP. REGULATOR		90AR326
24	TUBE-FORMED	1	204ECQ857		WATER SOLENOID VALVE - N1		90AC118
					WATER SOLENOID VALVE - N4		90AC103

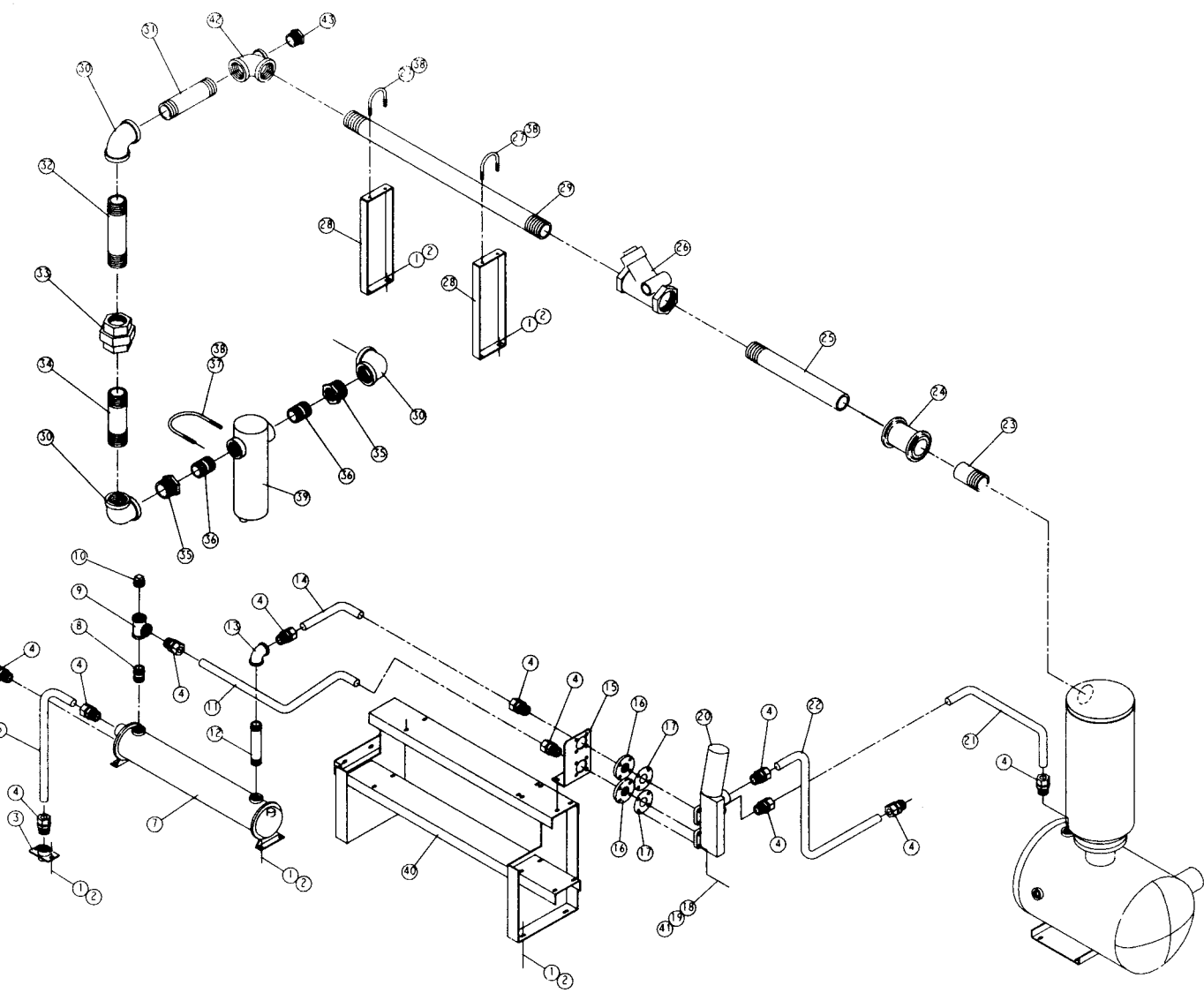

208EDM810

WATER COOLED PIPING (NO AFTERCOOLER)

DET. NO.	NAME OF PART	QTY	PART NO.	DET. NO.	NAME OF PART	QTY	PART NO.
1	SCREW-FLANGED	18	75LM51	25	NIPPLE-PIPE.....	1	63AJ48X200G
2	NUT-FLANGED.....	18	50AW5	26	VALVE-M/PRESS & CHECK..	1	200EDM527
3	MANIFOLD-WATER.....	2	200EDM072	27	U-BOLT	2	15U87
4	CONNECTOR-TUBE	12	86N105	28	BRACKET-PIPE.....	2	200EDM108
5	TUBE-FORMED	1	206EDM857	29	NIPPLE-PIPE.....	1	63N48X430G
6	TUBE-FORMED	1	207EDM857	30	ELBOW-PIPE	3	63C10G
7	HEAT EXCHANGER.....	1	200EDM349	31	NIPPLE-PIPE.....	1	63P21G
8	NIPPLE-PIPE	1	63K20G	32	NIPPLE-PIPE.....	1	63P25G
9	TEE-PIPE	1	64G11G	33	UNION-STRAIGHT.....	1	64Z21
10	PLUG-SQHD PIPE.....	1	64A8	34	NIPPLE-PIPE.....	1	63P20G
11	TUBE-FORMED	1	204EDM857	35	BUSHING-PIPE.....	2	64E33
12	NIPPLE-PIPE	1	63K10G	36	NIPPLE-PIPE.....	2	63M3G
13	ELBOW-PIPE	1	64C8G	37	U-BOLT	1	15U75
14	TUBE-FORMED	1	205EDM857	38	NUT-FLANGED	6	50AW35
15	BRACKET (FORMED)	2	200EDM142	39	SEPARATOR-MOISTURE.....	1	83C92
16	FLANGE-THREADED	2	64DC3	40	SUPPORT	1	201EDM165
17	O-RING	2	25BC387	41	NUT-HEX.....	8	50B5
18	SCREW-HEX HD	8	655EE060	42	TEE-PIPE.....	1	8503783
19	WASHER-LOCK.....	8	95B5	43	BUSHING-PIPE.....	1	64E60
20	ASM-STAT/FILTER	1	200EDM2045	--	GASKET-HEX CPLG.....	2	2109775
21	TUBE-FORMED	1	202EDM857		WATER VALVES (OPTIONAL)		
22	TUBE-FORMED	1	204ECQ857		WATER TEMP. REGULATOR		90AR326
23	NIPPLE-PIPE	1	63AJ48X50G		WATER SOLENOID VALVE - N1		90AC118
24	COUPLING-FLEX	1	64EB328		WATER SOLENOID VALVE - N4		90AC103

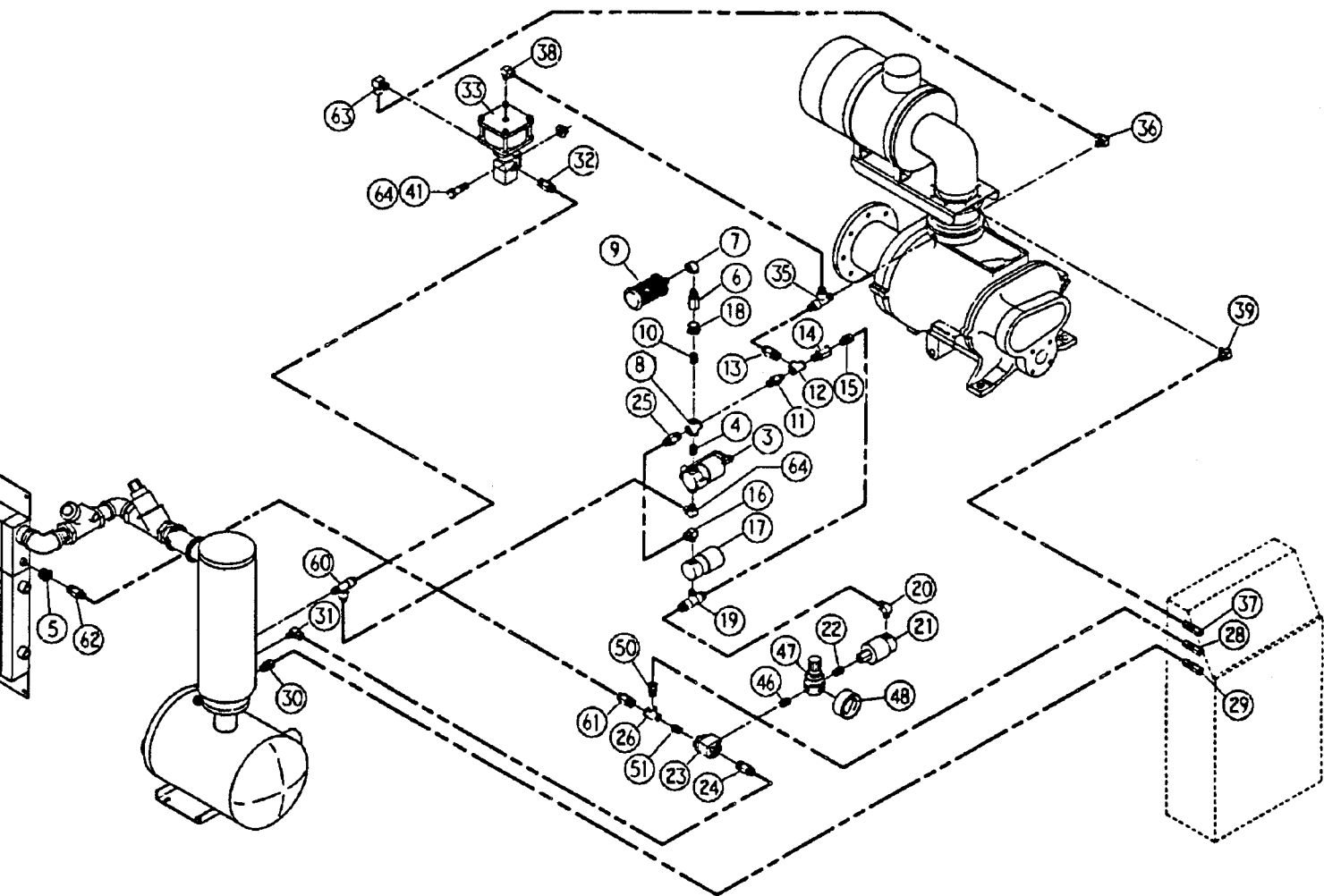

287ECM810

DET. NO.	NAME OF PART	QTY	PART NO.
1	CONNECTOR-TUBE.....	1	86E9
2	ELBOW-TUBE.....	1	86E60
3	VALVE-SOLENOID.....	1	91B70
4	NIPPLE-PIPE.....	1	63D1G
5	BUSHING-PIPE.....	1	64E2
6	ORIFICE.....	1	200ECM814
7	ELBOW-PIPE.....	1	64C4G
8	CROSS-PIPE.....	1	64K1G
9	MUFFLER.....	1	43E6
10	NIPPLE-PIPE.....	1	63D1G
11	VALVE-CHECK.....	1	90AR261
12	TEE-PIPE.....	1	64G3G
13	CONNECTOR-TUBE.....	1	86E9
14	ORIFICE.....	1	2011768
15	CONNECTOR-TUBE.....	1	86E4
16	ELBOW-TUBE.....	1	86E60
17	VALVE, SOLENOID.....	1	91B80
18	BUSHING-PIPE.....	1	64E2
19	TEE-TUBE.....	1	86E119
20	ELBOW-TUBE.....	1	86E60
21	VALVE, SOLENOID.....	1	91B81
22	NIPPLE-PIPE.....	1	63D1G
23	VALVE.....	1	90AR107
24	ELBOW-TUBE.....	1	86E64
25	CONNECTOR-TUBE.....	1	86E4
26	TEE-PIPE.....	1	64G3G
27	CONNECTOR-TUBE.....	1	86E9
28	CONNECTOR.....	1	86N218
29	CONNECTOR.....	1	86N218
30	CONNECTOR-TUBE.....	1	86E4
31	ELBOW-TUBE.....	1	86E64
32	CONNECTOR-TUBE.....	1	86E9

DET. NO.	NAME OF PART	QTY	PART NO.
33	VALVE-AIR CONT.....	1	90AR35
34	CONNECTOR-TUBE.....	1	86E9
35	TEE-TUBE.....	1	86E136
36	ELBOW-TUBE.....	1	86E64
37	CONNECTOR.....	1	86N218
38	ELBOW-TUBE.....	1	86E64
39	ELBOW-TUBE.....	1	86E60
40	SCREW-HEX CAP.....	2	75A51
41	NUT-FLANGED.....	2	50AW3
43	TUBE.....	30 FT.	85K3
44	TUBE.....	20 FT.	85K5
46	NIPPLE-PIPE.....	1	63D1G
47	REGULATOR-PRESSURE.....	1	88H139
48	GAUGE.....	1	27P109
49	CONNECTOR-TUBE.....	1	86E9
50	CONNECTOR-TUBE.....	1	86E4
51	NIPPLE-PIPE.....	1	63D1G
52	TEE-PIPE.....	1	64G3G
53	CONNECTOR-TUBE.....	1	86E4
54	NIPPLE-PIPE.....	1	63D1G
55	SEAL PLUG.....	1	24CA2597
56	FITTING-CONDUIT.....	1	24A341
57	GASKET.....	1	24A342
58	COVER.....	1	24A343
59	NUT-FLANGED.....	4	50AW5
60	TEE-TUBE.....	1	86E136
61	CONNECTOR-TUBE.....	1	86E9
62	CONNECTOR-TUBE.....	1	86E9
63	ELBOW-TUBE.....	1	86E64
64	ELBOW-TUBE.....	1	86E64
65	SCREW-SO HD CAP.....	2	75P4

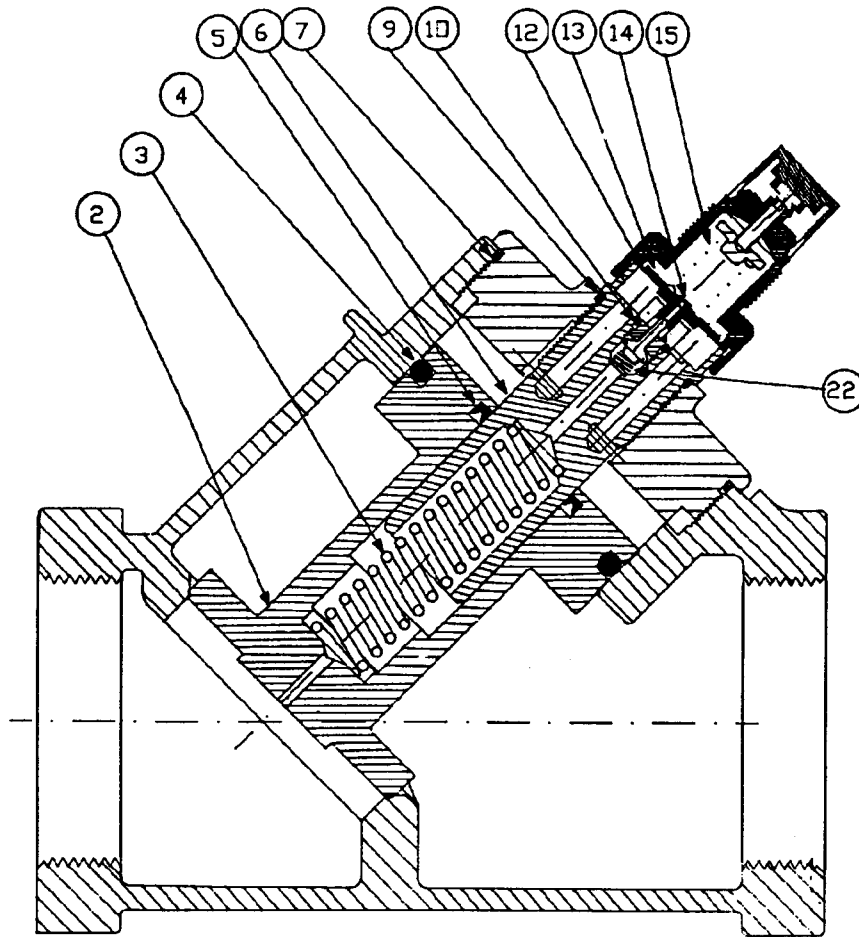

**MINIMUM PRESSURE & CHECK VALVE - 200EDM527
(COMPLETE ASSEMBLY)**

DET. NO.	NAME OF PART	QTY	PART NO.
2	VALVE.....	1	2116606
3	MAIN SPRING.....	1	2116232
4	O-RING.....	1	2116608
5	U-CUP 1-3/8 x 1-3/4 x 3/16.....	1	2116609
6	REGULATOR HOUSING.....	1	2116610
7	O-RING.....	1	2116611
9	O-RING.....	1	2116612
10	O-RING.....	1	2116613
12	O-RING.....	1	2116614
13	O-RING.....	1	2116615
14	O-RING.....	1	2116616
15	O-RING.....	1	2116617
22	1

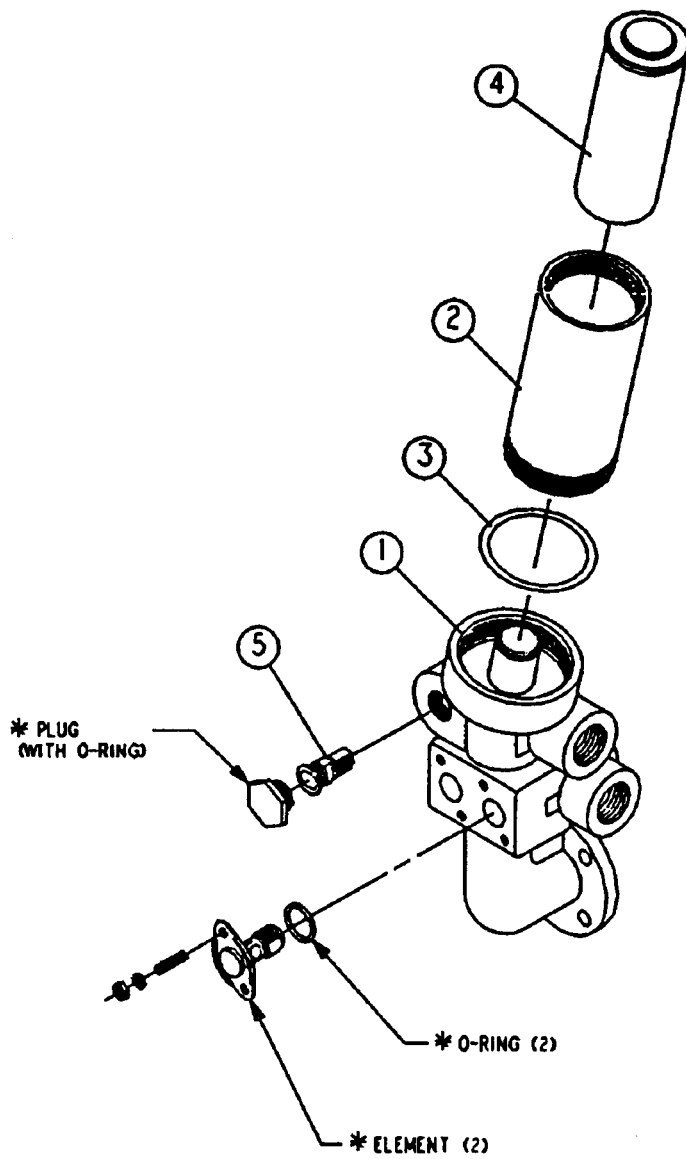

212EDM810

**FILTER ASSEMBLY
(WITH 150° ELEMENT - STD.)**

DET. NO.	NAME OF PART	QTY	PART NO.
1	MANIFOLD-OIL.....	1	200EDM116
2	BODY-OIL FILTER.....	1	200EDM032
3	O-RING.....	1	25BC380
4	FILTER-OIL	1	200EDM369
5	CARTRIDGE-FILTER.....	1	2116640

* FOR REPAIR: 2116676 PLUG - WITH O-RING (VITON)
 2116677 ELEMENT - WITH O-RING (VITON) (150°)
 2116678 ELEMENT - WITH O-RING (VITON) (160°)
 2116679 ELEMENT - WITH O-RING (VITON) (180°)

ENCLOSURE
COMMON PARTS - AIR/WATER COOLED

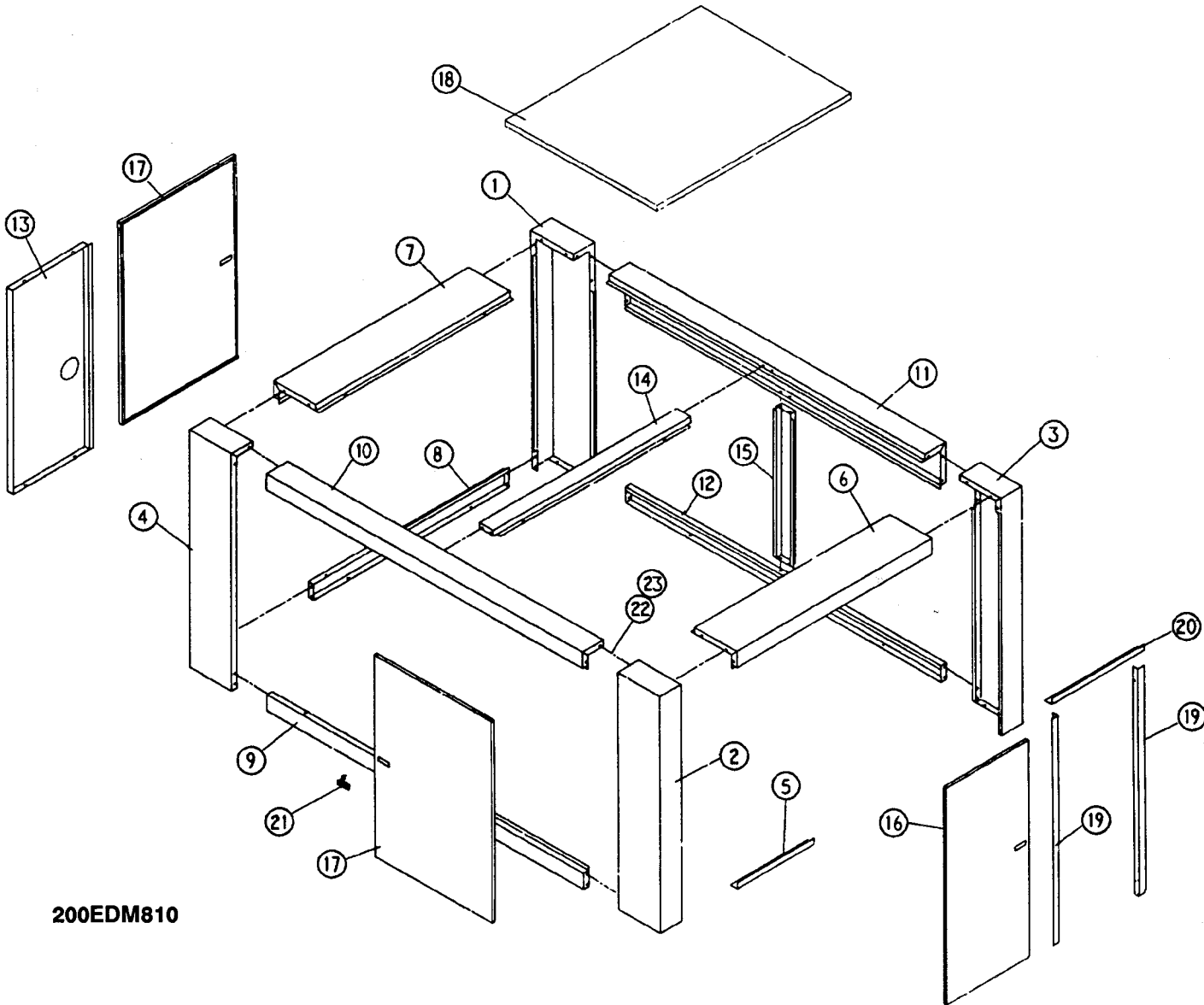

200EDM810

**ENCLOSURE
COMMON PARTS - AIR/WATER COOLED**

DET. NO.	NAME OF PART	QTY	PART NO.
1	POST	1	200EDM313
2	POST	1	201EDM313
3	POST	1	202EDM313
4	POST	1	203EDM313
5	FRAME.....	1	200EDM314
6	FRAME.....	1	201EDM314
7	FRAME.....	1	202EDM314
8	FRAME.....	1	203EDM314
9	FRAME.....	1	204EDM314
10	FRAME.....	1	205EDM314
11	FRAME.....	1	206EDM314
12	FRAME.....	1	207EDM314
13	BRACE.....	1	200EDM326
14	BRACE.....	1	201EDM326
15	BRACE.....	1	202EDM326
16	DOOR-CANOPY.....	1	200EDM334
17	DOOR-CANOPY.....	2	201EDM334
18	PANEL	1	203EDM216
19	BRACKET	2	201EDM142
20	BRACKET	1	202EDM142
21	LATCH	7	31D51
22	SCREW-FLANGED.....	90	75LM51
23	NUT-FLANGED	82	50AW5
*	TRIM SEAL	75	32E12
	* NOT SHOWN		

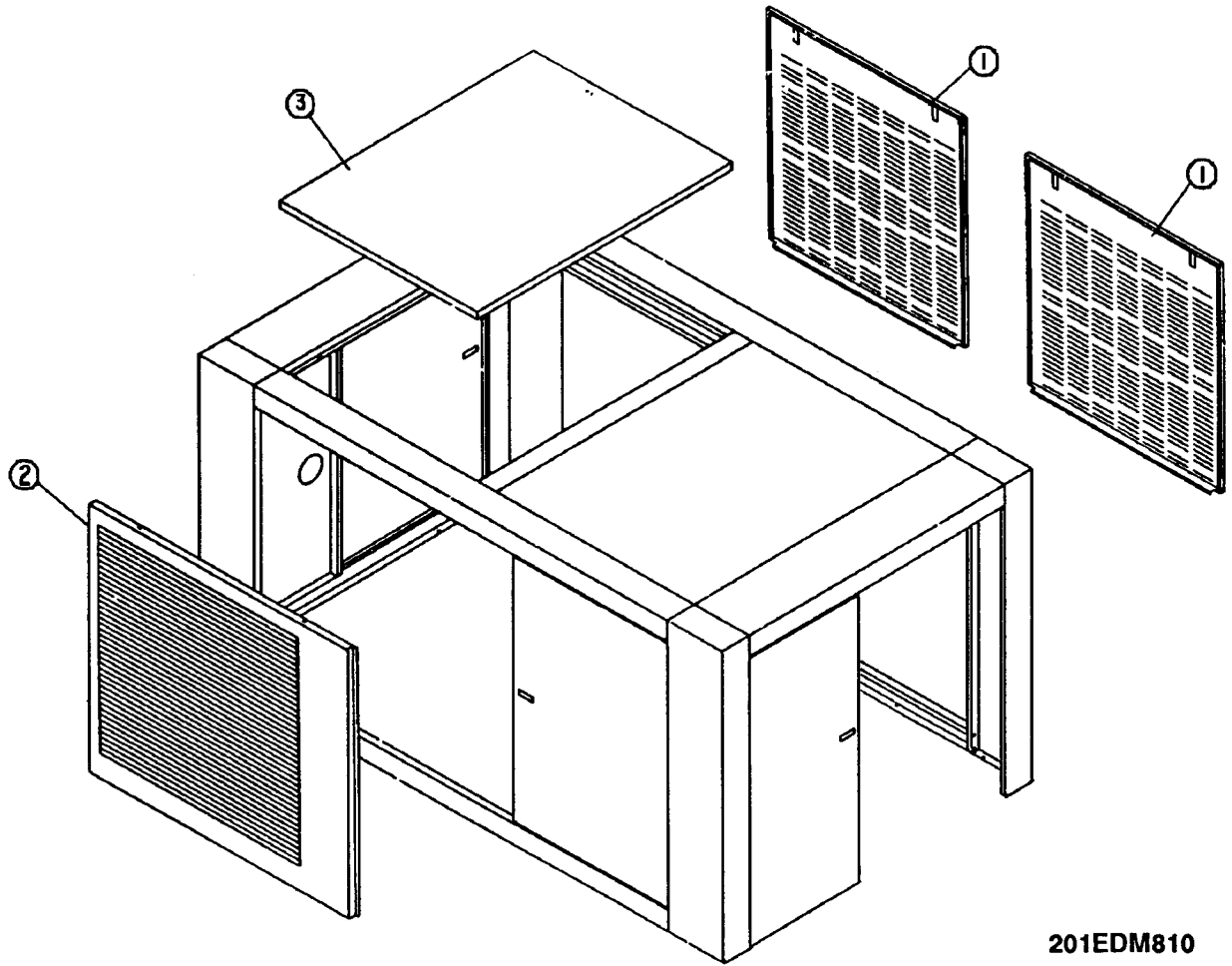

ENCLOSURE - AIR COOLED

DET. NO.	NAME OF PART	QTY	PART NO.
1	PANEL	2	200EDM216
2	PANEL	1	202EDM216
3	PANEL	1	203EDM216

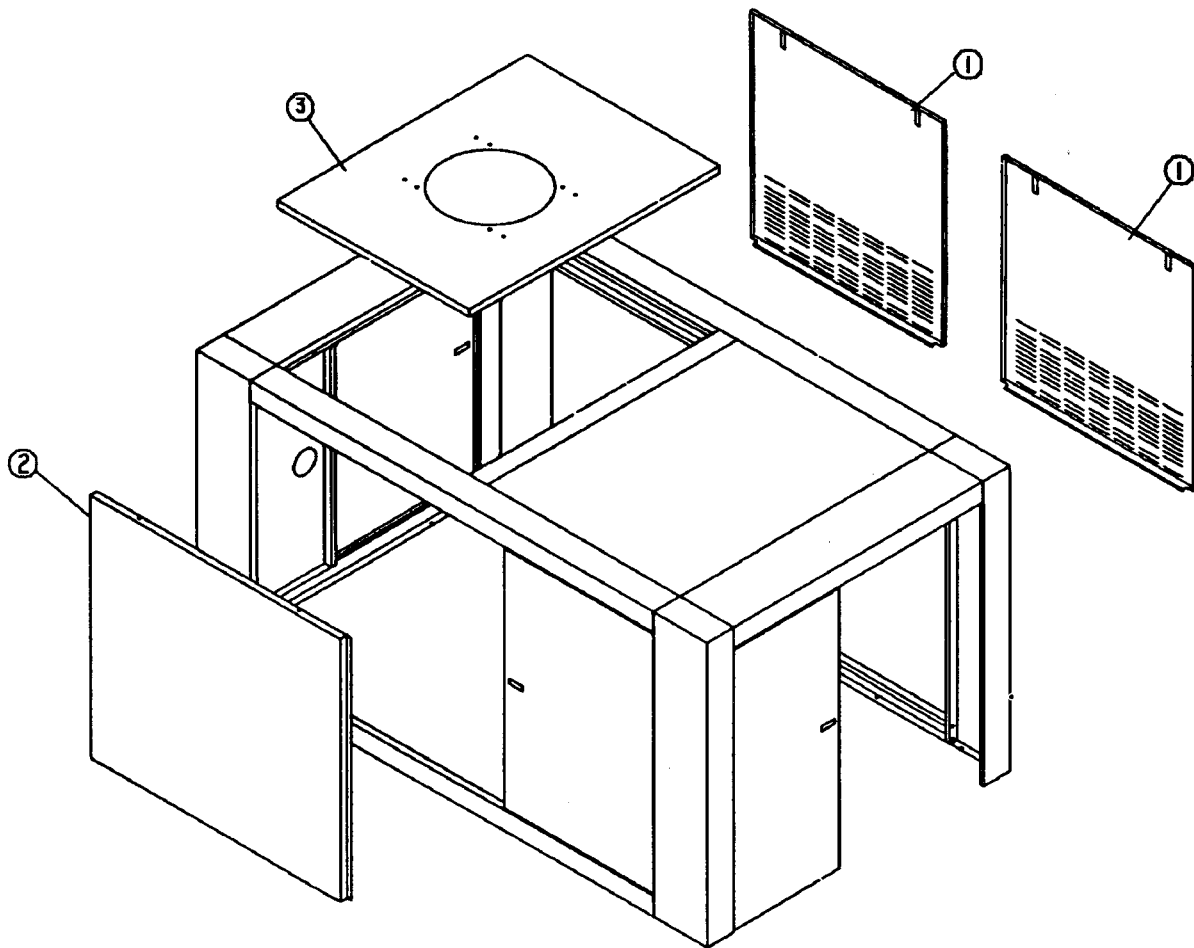

202EDM810

ENCLOSURE - WATER COOLED

DET. NO.	NAME OF PART	QTY	PART NO.
1	PANEL	2	201EDM216
2	PANEL	1	204EDM216
3	PANEL	1	205EDM216

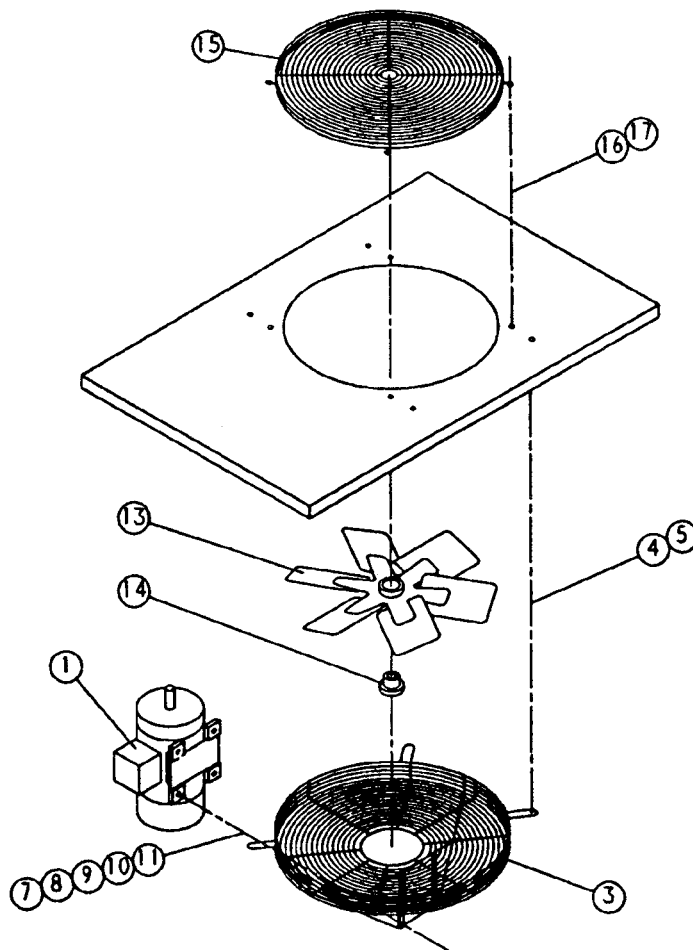

285ECM810

VENT FAN GROUP

DET. NO.	NAME OF PART	QTY	PART NO.
1	MOTOR.....	1	See Page 30
3	GUARD-FAN.....	1	202ECM393
4	SCREW-FLANGED.....	4	75K48
5	WASHER-PLAIN.....	4	95A5
7	SCREW-HEX CAP.....	4	75A35
8	RETAINER.....	4	2014731
9	WASHER-PLAIN.....	4	95A2
10	WASHER-LOCK.....	4	95B2
11	NUT-HEX.....	4	50B2
13	FAN.....	1	202ECM701
14	HUB BUSHING.....	1	22G27
15	GUARD-FAN.....	1	200ECM393
16	SCREW-FLANGED.....	4	75LM51
17	NUT-FLANGED.....	4	50AW5

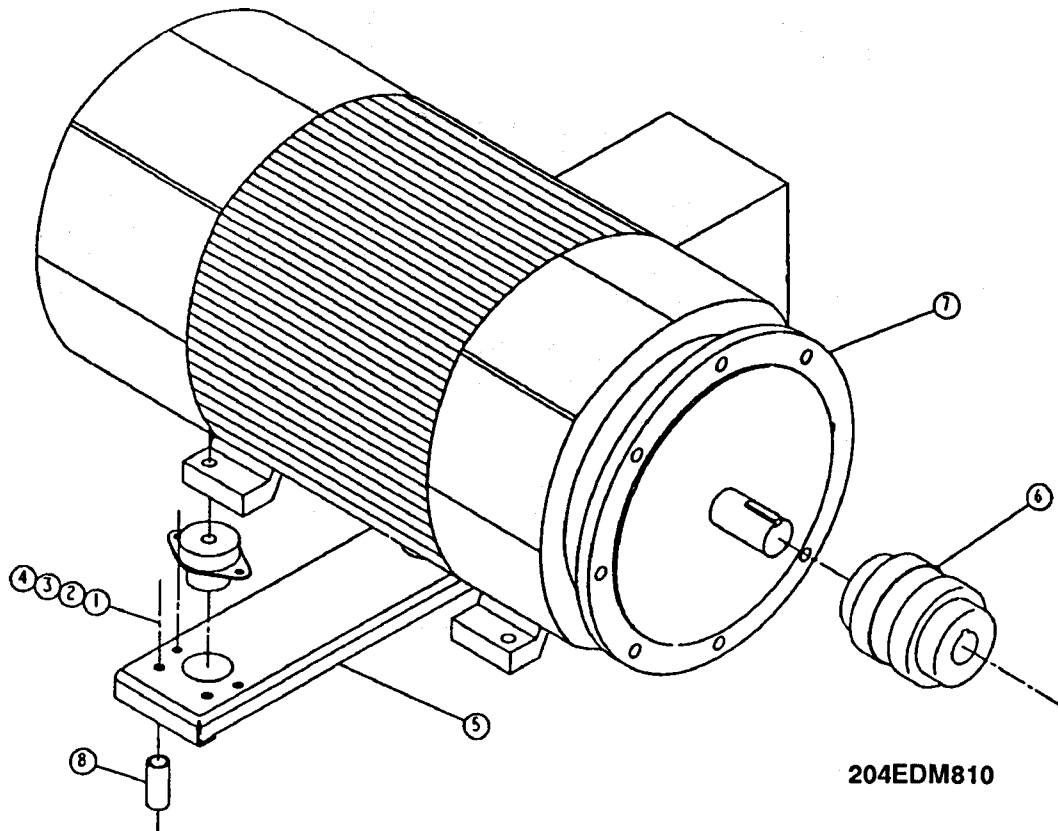

DET. NO.	NAME OF PART	QTY	PART NO.
1	WASHER-PLAIN	4	95A7
2	WASHER-LOCK.....	4	95B7
3	NUT-HEX	4	50B7
4	SCREW-HEX HD	4	655EF160
5	SUPPORT-MOTOR	1	*
6	COUPLING-FLEX.....	1	*
7	MOTOR.....	1	SEE PAGE 30
8	NIPPLE-PIPE	4	63AM12X32G

* NOTE: FLEX COUPLING (See Pages 13 & 35)

51L59 COUPLING

51L62 COUPLING

MOTOR SUPPORT

200EDM620 444/449 FRAME (125 HP, ODP)

201EDM620 404/405 FRAME (125 HP, TEFC, 150 HP - ODP/TEFC)

**MOTOR GROUP
(MAIN DRIVE MOTORS)
(WYE-DELTA)**

COLUMN CODE	NAME OF PART	125 HP PART NO.	150 HP PART NO.
----------------	--------------	--------------------	--------------------

**OPEN DRIP PROOF
(60 HZ - ODP)**

13A	MOTOR, 200V	24CA3495	24CA3496
13B	MOTOR, 230V	24CA3261	24CA3264
13C	MOTOR, 460V	24CA3262	24CA3265
13D	MOTOR, 575V	24CA3263	24CA3266

**OPEN DRIP PROOF
(60 HZ - ODP - HIGH EFFICIENCY)**

13D	MOTOR, 200V	24CA3498	24CA3499
13F	MOTOR, 230V	24CA3270	24CA3273
13G	MOTOR, 460V	24CA3271	24CA3274
13H	MOTOR, 575V	24CA3272	24CA3275

**TOTALLY ENCLOSED FAN COOLED
(60 HZ - TEFC)**

13I	MOTOR, 200V	24CA3501	24CA3502
13J	MOTOR, 230V	24CA3279	24CA3282
13K	MOTOR, 460V	24CA3280	24CA3283
13L	MOTOR, 575V	24CA3281	24CA3284

**TOTALLY ENCLOSED FAN COOLED
(60 HZ - TEFC - HIGH EFFICIENCY)**

13M	MOTOR, 200V	24CA3504	24CA3505
13N	MOTOR, 230V	24CA3288	24CA3291
13O	MOTOR, 460V	24CA3289	24CA3292
13P	MOTOR, 575V	24CA3290	24CA3293

MOTOR GROUP

**AIR COOLED FAN MOTOR (COOLING MODULE)
(T.E.A.O., 3 HP, 1200 RPM, 60 HZ, 1.33 S.F.)**

VOLTAGE	P/N
MOTOR, 200V	24CA189
MOTOR, 230V	24CA190
MOTOR, 460V	24CA190
MOTOR, 575V	24CA191

**WATER COOLED FAN MOTOR (ENCLOSURE VENT FAN)
(T.E.F.C., 1200 RPM, 60 HZ, 1.0 S.F.)**

VOLTAGE	P/N	HP
MOTOR, 200V	24CA2463	1/2
MOTOR, 230V	24CA2464	1/4
MOTOR, 460V	24CA2464	1/4
MOTOR, 575V	24CA2465	1/2

IDENTIFICATION & INSTRUMENT GROUP

NAME	QTY.	PART NO.
DECAL, G-D LOGO.....	1	69F18
DECAL, SAVER II LOGO	3	200ECP077
DECAL, SAVER II LOGO	1	201ECP077
DECAL, PARTS LIST/SERVICE MANUAL #	1	204EDE077
DECAL, DRAIN MOISTURE DAILY	1	205ESO077
DECAL, DANGER - DO NOT BREATHE	1	206EAQ077
DECAL, CAUTION - DO NOT LIFT	1	208EAQ077
DECAL, AEON 9000 LUBRICANT	1	210EAQ077
DECAL, WARNING - ROTATING MACHINERY	1	211EAQ077
DECAL, DANGER - HOT OIL UNDER PRESSURE.....	1	212EAQ077
DECAL, WARNING - ELECTRICAL SHOCK	1	213EAQ077
DECAL, NOTICE - USE GD PARTS.....	1	214EAQ077
DECAL, WARNING - READ OPERATOR MANUAL	1	215EAQ077
DECAL, WARNING - ELECTRICAL SHOCK	1	216EAQ077
DECAL, WARNING - INSPECT OIL RESERVOIR	1	217EAQ077
DECAL, DANGER - DO NOT MODIFY	1	218EAQ077
DECAL, CAUTION - USE FLOOR PLATE	1	221EAQ077
DECAL, WARNING - SEE WIRING DIAGRAM.....	1	222EAQ077
DECAL, OPERATION & MAINTENANCE.....	1	217ECM077
DECAL, WARNING	1	227ECM077
DECAL, NOTICE - USE G-D PARTS	1	224EAQ077
DECAL, HEAT EXC. "IN".....	1	200ESP077
DECAL, HEAT EXC. "OUT"	1	201ESP077

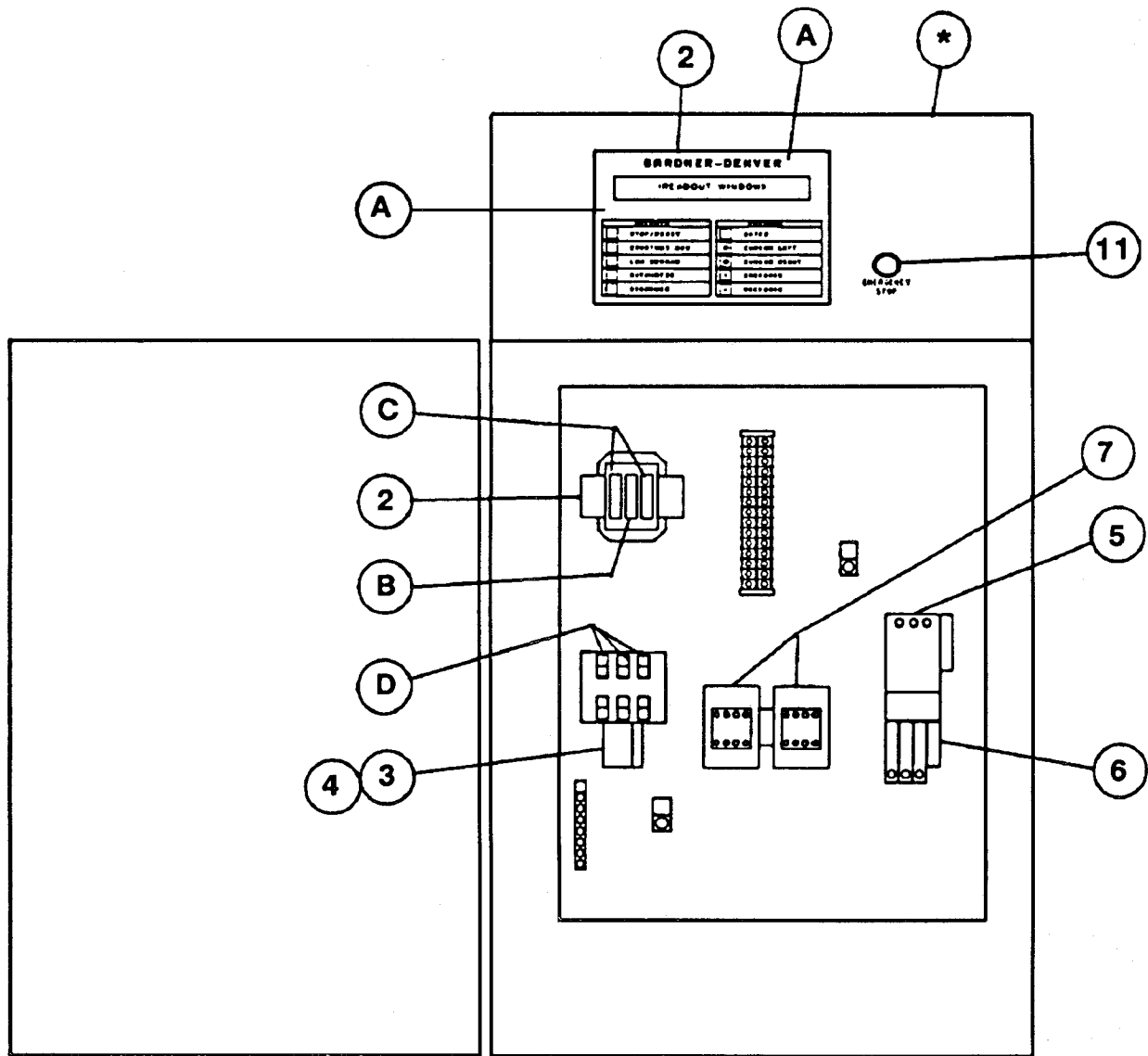

CONTROLLER ASSEMBLY
(EAQ - 125/150 HP YD STARTERS)

	QTY.	230V	460V	
* ASSEMBLED PANEL: NEMA 12	1	202EDM466	200EDM466	2
* ASSEMBLED PANEL: NEMA 4	1	211EDM466	209EDM466	2
A FUSE, CONTROL BOARD	2	24CA2932	24CA2932	2
B FUSE, TRANSFORMER SECONDARY.....	1	24CA2797	24CA2792	2
C FUSE, TRANSFORMER PRIMARY	2	24CA617	24CA276	2
D FUSE, FAN MOTOR, AIR COOLED.....	3	24CA2478	24CA2744	2
D FUSE, FAN MOTOR, WATER COOLED	3	24CA2476	24CA2475	2
2 ELECTRONIC CONTROLLER ASSEMBLY	1	202EAP1173	202EAP1173	2
3 CONTROL TRANSFORMER, 550VA.....	1	2116287	2116287	2
4 STARTER, FAN MOTOR.....	1	24CA3491	24CA3491	2
5 HEATER, FAN MOTOR OVERLOAD..... AIR COOLED	3	24CA2488	24CA2486	2
5 HEATER, FAN MOTOR OVERLOAD..... WATER COOLED	3	24CA2482	24CA2480	2
6 STARTER, MAIN MOTOR.....	1	24CA3490	24CA3255	2
7 HEATER, MAIN MOTOR OVERLOAD 125 HP.....	3	24CA2484	24CA2482	2
7 HEATER, MAIN MOTOR OVERLOAD 150 HP.....	3	24CA2484	24CA2482	2
11 OPERATOR, 22mm PUSH-PULL E-STOP.....	1	24CA2907	24CA2907	2
12 CONTACT BLOCK E22B1 SPNC.....	1	24CA2908	24CA2908	2

REPAIR KITS

- | | | |
|---|------------|------------|
| 1) ROUTINE MAINTENANCE KIT (3000 HOURS) H.P. AIR FILTER | | 200EDM6013 |
| (2) ELEMENT, AIR FILTER | 2010509 | |
| (3) OIL FILTER (STAT/FIL) | 200EDM369 | |
| 2) PERIODIC MAINTENANCE KIT (9000 HOURS) | | 201EDM6013 |
| (2) PACKING-RING | 60DD561 | |
| (1) O-RING | 25BC378 | |
| 3) PERIODIC OVERHAUL (18,000 HOURS) | | SSQ81162 |
| (1) GASKET KIT | SSQ81160 | |
| (1) BEARING-ROLLER | 12BA126 | |
| (1) SLEEVE-WEAR | 80M28 | |
| (1) BEARING-ROLLER | 12BA138 | |
| (1) BEARING-ROLLER | 12BA78 | |
| (1) SPRING-WAVE | 78W49 | |
| (1) SEAL-OIL (VITON) | 60DD571 | |
| (1) SEAL-OIL | 60DD562 | |
| (1) GASKET (ELIMINATOR) | 25BC222 | |
| 4) SEPARATOR KIT (18,000 HOURS) | | 203EDM6013 |
| (1) OIL SEPARATOR | 55B43 | |
| (1) GASKET | 200EDM715N | |
| 5) PNEUMATIC CONTROLS & GAUGES (18,000 HOURS) | | 205EAP6013 |
| (2) VALVE-CHECK | 90AR261 | |
| (2) VALVE-SHUTTLE | 90AR107 | |
| (1) VALVE-AIR CONTROL | 90AR35 | |
| (1) REGULATOR-PRESSURE | 88H139 | |
| (1) GAUGE-PRESSURE | 27P109 | |

REPAIR KITS (CONTINUED)

6) ELECTRICAL CONTROL KIT (18,000 HOURS)		206EAP6013
(1) SOLENOID VALVE	91B70	
(1) SOLENOID VALVE	91B80	
(1) SOLENOID VALVE	91B81	
(2) THERMISTOR PROBE	21D231	
(1) TRANSDUCER	88H178	
(1) VAC SWITCH	88H154	
KIT (MISC.) - DRIVE COUPLING (51L62)		ECK77781
(1) CUSHION ASSY - (6) CUSHIONS	2109116	
KIT (MISC.) - DRIVE COUPLING (51L59)		200EDH6003
(1) CUSHION ASSY - (6) CUSHIONS	2116477	



**Gardner-Denver
Industrial Machinery**

For additional information, contact Gardner-Denver Industrial Machinery
Division, 1800 Gardner Expressway, Quincy, Illinois 62305-4024
Telephone (217) 224-8800 FAX 217-224-7814 Telex 404332.

Specifications subject to change without notice.
COPYRIGHT © 1991 Cooper Industries, Inc.

Litho in USA. 25C-5-91