



GARDNER-DENVER®

13-9-542
2nd Edition

“ECM”
ELECTRA-SAVER II®
STATIONARY
BASE-MOUNTED
COMPRESSOR

Models

60 HP
ECMQKB, ECMSKB

75 HP
ECMQLB, ECMSLB

13-9-542

Parts List



INDUSTRIAL MACHINERY

TABLE OF CONTENTS
(Electra-Saver II® – 60 & 75 HP)

	Models
	ECMQKB
	ECMSKB
	ECMLB
	ECMSLB
	13-9-632
Service Manual	
<hr/>	
Group Name	Page No.
<hr/>	
Thirteen (13) Character Model Designations	ECM Matrix/Menu
Ordering Instructions	P/L 139-500b
Bare Compressor Illustration	139-B39-1
Bare Compressor List of Parts (60 HP)	139-B39-1a
Bare Compressor List of Parts (75 HP)	139-B39-1b
Inlet Valve & Mounting Group (SSH Air Ends)	139-A39-2
Inlet Valve & Air Filter Group (SSM Air Ends)	139-A39-3
Standard Air Filter Group (SSH Units)	139-A39-4
Standard Air Filter Group (SSH & SSM Units)	139-A39-4a
Heavy Duty Air Filter Group	139-A39-5
Oil Reservoir Group/Separator & Discharge Manifold	139-B39-6
Blowdown Valve, Check Valve, Safety Valve, Minimum Pressure Valve & Temperature Switch Probe	
Minimum Pressure Valve (Component Parts)	139-A39-7
Oil Piping Group	139-B39-8
Oil Filter, Mixing Valve & Temperature Switch Probe	
Oil Filter (Component Parts)	139-A39-9
Thermostatic Mixing Valve (Component Parts)	139-A39-10
Air-Cooled Oil Cooler (No Aftercooler)	139-A39-11
Air-Cooled Oil Cooler With Aftercooler	139-A39-12
Water-Cooled Oil Cooler (No Aftercooler)	139-A39-13
Water-Cooled Oil Cooler With Aftercooler	139-A39-14
Instrument Panel Group	139-A39-15
Control Lines	139-B39-16
Control	139-A39-16a
Control Items	139-A39-16b
Subtractive Pilot Valve	139-A39-17
Purge Valve Group	139-A39-18
Compressor Base Group	139-A39-19
Enclosure Group	139-A39-20
Baffle Assembly	139-A39-21
Vent Fan Group	139-A39-22
Coupling Guard Group and Identification & Instruction Group	139-A39-23
Repair Kits	139-A39-24

MODELS ECMQ__ B & ECMS__ B 60 & 75 HP Air or Water-Cooled Base-Mounted
Electra-Saver^{II} Compressors — Thirteen (13) Character Model Designations

NOTICE TO CUSTOMER — To find the construction options for your compressor unit, FILL IN THE BALANCE OF LETTERS OR NUMBERS FROM YOUR UNIT NAMEPLATE
Column Number:

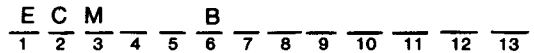

FOLLOW THE LINE DOWN AND OVER FROM EACH SPACE THUS FILLED IN TO FIND THE APPROPRIATE CONSTRUCTION WITH WHICH YOUR MACHINE IS EQUIPPED. THE NUMBER "9" IN ANY COLUMN SPACE INDICATES "NOT APPLICABLE", THE NUMBER "8" IN ANY COLUMN SPACE INDICATES SPECIAL DESIGN — REFER TO FACTORY ORDER TICKET.

COLUMNS 1 & 2 — ELECTRA-SAVER II FAMILY-SINGLE-STAGE

COLUMN 3 — AIR END
M. SSH or SSM Air End — 60 & 75 HP Units

COLUMN 4 — CONSTRUCTION
Q Air Cooled — Base Mounted (Std) S Water Cooled — Base Mounted (Std)

COLUMN 5 — HORSEPOWER
K 60 HP L 75 HP

COLUMN 6 — ENGINEERING SPECIFICATION

COLUMN 7 — PRESSURE & HZ
D. 100 PSIG — 60 Hz N. 100 PSIG — 50 Hz
F. 125 PSIG — 60 Hz P. 125 PSIG — 50 Hz
H. 150 PSIG — 60 Hz R. 150 PSIG — 50 Hz

COLUMN 8 — CONTROLS, VOLTAGE TO TRANSFORMER & NEMA CLASS
CONSTANT SPEED — LOW DEMAND MODE — AIR COOLED — 60 Hz
A 200 Volt Nema 1 B 230/460/575 Volt Nema 1
C 200 Volt Nema 4 D 230/460/575 Volt Nema 4
CONSTANT SPEED — LOW DEMAND MODE — AIR COOLED — 50 Hz
E 380/415 Volt Nema 1 F 380/415 Volt Nema 4
CONSTANT SPEED — LOW DEMAND MODE — WATER COOLED — 60 Hz
G 200 Volt Nema 1 H 230/460/575 Volt Nema 1
I 200 Volt Nema 4 J 230/460/575 Volt Nema 4
CONSTANT SPEED — LOW DEMAND MODE — WATER COOLED — 50 Hz
K 380/415 Volt Nema 1 L 380/415 Volt Nema 4
AUTO-START/TIMED STOP — AIR COOLED — 60 Hz
M 200 Volt Nema 1 N 230/460/575 Volt Nema 1
O 200 Volt Nema 4 P 230/460/575 Volt Nema 4
AUTO-START/TIMED STOP — AIR COOLED — 50 Hz
Q 380/415 Volt Nema 1 R 380/415 Volt Nema 4
AUTO-START/TIMED STOP — WATER COOLED — 60 Hz
S 200 Volt Nema 1 T 230/460/575 Volt Nema 1
U 200 Volt Nema 4 V 230/460/575 Volt Nema 4
AUTO-START/TIMED STOP — WATER COOLED — 50 Hz
W 380/415 Volt Nema 1 X 380/415 Volt Nema 4

COLUMN 9 — CONTROL — MAIN STARTER

	200 Volt	230 Volt	460 Volt	575 Volt
Mag Starter/Nema 1	A	B	C	D
Mag Starter/Nema 4	E	F	G	H

Y. Less Starter

COLUMN 10 — ENCLOSURE
A Standard — Air Cooled F. Water Cooled — 500/525/550 V — 50 Hz
B Water Cooled — 208 V — 60 Hz G. Standard — Air Cooled — Quiet
C Water Cooled — 230/460/575 V — 60 Hz H. No Enclosure (Standard Filter — SSM Air End)
D. Water Cooled — 220/440 V — 50 Hz I. No Enclosure (Heavy Duty Filter)
E. Water Cooled — 380/400/415 V — 50 Hz S. No Enclosure (Standard Filter — SSH Air End)

COLUMN 11 — OIL COOLERS — AIR & WATER
AIR COOLED:
A STEEL — W/O Aftercooler C. STEEL — W/Aftercooler
WATER COOLED:
I. Fresh Water W/O Aftercooler U. Salt Water W/O Aftercooler
K. Fresh Water W/Aftercooler V. Salt Water W/Aftercooler
M. Fresh Water W/O Aftercooler W/Water Temp. Regulator W. Salt Water W/O Aftercooler W/Water Temp. Regulator
O. Fresh Water W/Aftercooler W/Water Temp. Regulator X. Salt Water W/Aftercooler W/Water Temp. Regulator

COLUMN 12 — COOLER ELECTRICAL
AIR COOLED — NEMA 1 Starter Enclosure:
A 200 V — 60 Hz D. 575 V — 60 Hz G. 415 V — 50 Hz
B 230 V — 60 Hz E. 220 V — 50 Hz H. 440 V — 50 Hz
C. 460 V — 60 Hz F. 380 V — 50 Hz I. LESS MOTOR
AIR COOLED — NEMA 4 Starter Enclosure:
J. 200 V — 60 Hz N. 220 V — 50 Hz R. LESS MOTOR
K. 230 V — 60 Hz O. 380 V — 50 Hz S. LESS MOTOR & STARTER
L. 460 V — 60 Hz P. 415 V — 50 Hz
M. 575 V — 60 Hz Q. 440 V — 50 Hz
WATER COOLED — MAGNETIC SHUTOFF VALVE
T. Nema 1 — Fresh Water U. Nema 4 — Fresh Water X. NO WATER SHUTOFF VALVE

COLUMN 13 — COMPRESSOR DRIVE MOTOR
OPEN DRIP-PROOF MOTORS
A 200 V — 60 Hz D. 575 V — 60 Hz I. 415 V — 50 Hz
B 230 V — 60 Hz G. 220 V — 50 Hz J. 440 V — 50 Hz
C. 460 V — 60 Hz H. 380 V — 50 Hz K. 550 V — 50 Hz
TOTALLY ENCLOSED — FAN COOLED
M. 200 V — 60 Hz P. 575 V — 60 Hz U. 415 V — 50 Hz
N. 230 V — 60 Hz S. 220 V — 50 Hz V. 440 V — 50 Hz
O. 460 V — 60 Hz T. 380 V — 50 Hz W. 550 V — 50 Hz
Y. LESS MOTOR (ODP/TEFC)

INSTRUCTIONS FOR ORDERING REPAIR PARTS

When ordering parts, specify Compressor **MODEL**, Method of Cooling, **HORSEPOWER** and **SERIAL NUMBER** (see nameplate on unit). Serial Number is also stamped on top of the cylinder flange to the right of the inlet housing.

All orders for Parts should be placed with the nearest Sales and Service Office.

Where NOT specified, quantity of parts required per compressor or unit is one (1); where more than one is required per unit, quantity is indicated in parenthesis. **SPECIFY EXACTLY THE NUMBER OF PARTS REQUIRED.**

DO NOT ORDER BY SETS OR GROUPS.

To determine the Right Hand and Left Hand side of an Electra-Screw[®] compressor, stand at the motor end and look toward the compressor. Right Hand and Left Hand are indicated in parenthesis following part name, i.e. (RH) & (LH).

PARTS RETURNED

All claims must be made within five days after receipt of goods. If order has been filled correctly, we cannot allow the return of the goods without our consent and then only on a basis of a charge for service and rehandling plus transportation charges.

Transportation charges must be prepaid. If it is necessary to return a part to the factory for duplication or inspection, do not fail to do the following:

1. Write the nearest Sales and Service Office a letter advising what material you wish to return and why.
2. After receiving permission to return the item or items, obtain from the Sales and Service Office the correct forms filled out by that office for the proper return of material.
3. Place a tag in the package showing your name and address.
4. Tag each article in the box or package stating what and how many are returned.
5. Always give the serial number of the machine from which the parts were removed or the invoice number on which the parts were originally shipped.

All parts returned for credit should be handled in the same manner as that for duplication or inspection.

BARE COMPRESSOR

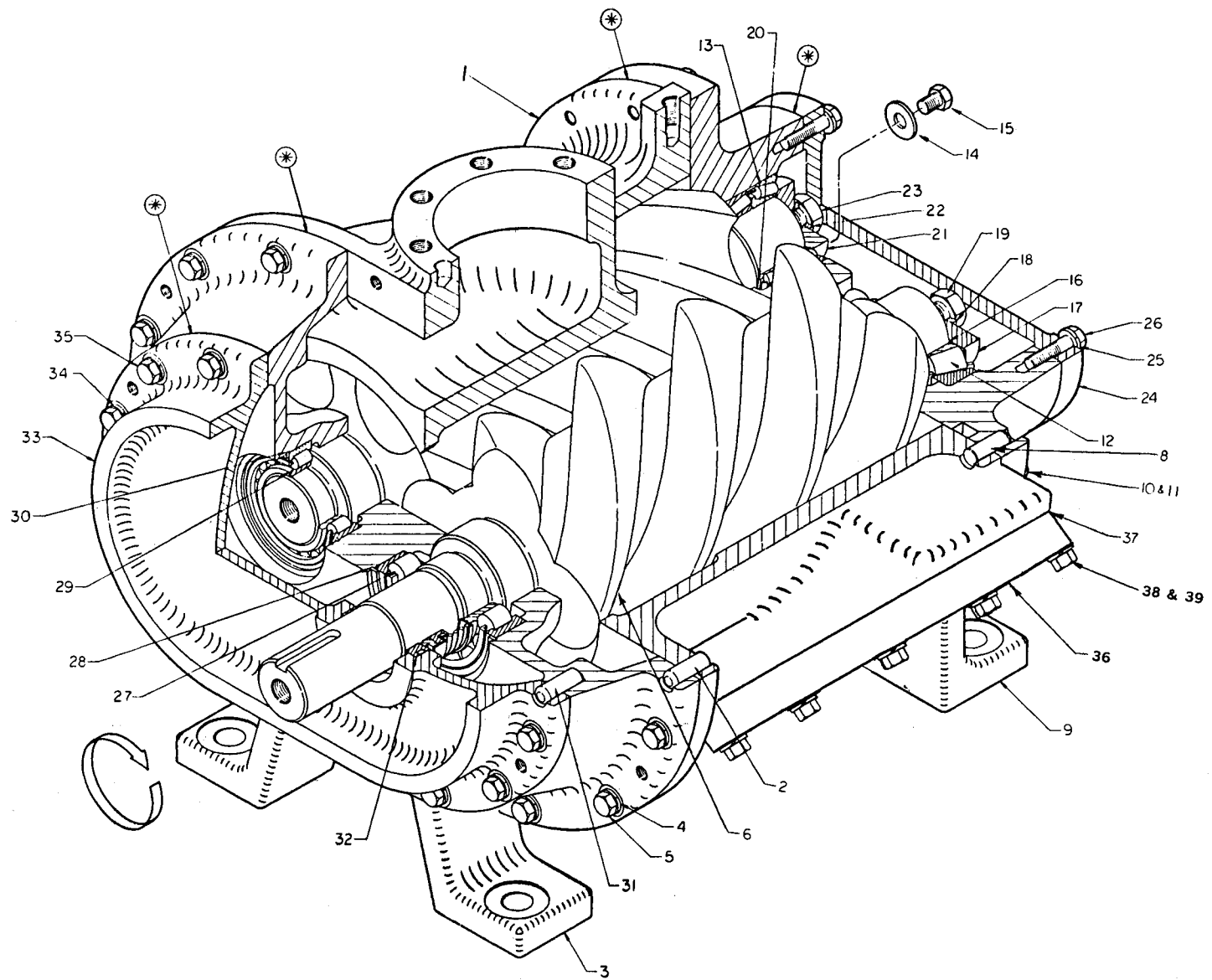

139-B39-1

Parts List for Models ECM_KB, 60HP see page 139-B39-1a
Parts List for Models ECM_LB, 75HP see page 139-B39-1b

E76920

Order by Part Number and Description. Reference Numbers for reference only.

Ref No	Name of Part	Qty. Req Per Comp	**Column Code 5K **Column Code 7D & 7N	**Column Code 5K **Column Code 7F	**Column Code 5K **Column Code 7H	**Column Code 5K **Column Code 7P
			SSMMBA03 Part No	SSHMBA01 Part No	SSHMBA02 Part No	SSMMBA04 Part No
BARE COMPRESSOR						
1	CYLINDER, Compressor	1	201 SSM002	201 SSH002	201 SSH002	201 SSM002
2	PIN-DOWEL, Inlet Bearing Housing to Cylinder	2	62 M83	62 M83	62 M83	62 M83
3	HOUSING-BEARING, Inlet End	1	201 SSM006	200 SSH006	200 SSH006	201 SSM006
4	WASHER-LOCK, Bearing Housing to Cylinder	16	95 B3	95 B3	95 B3	95 B3
5	SCREW-HEX CAP, Bearing Housing to Cylinder	16	75 A7	75 A2	75 A2	75 A7
6	ROTOR KIT (Main & Secondary Pair)	1	SSM77087	SSH77081	SSH77082	SSM77088
8	PIN-DOWEL, Discharge Bearing Housing to Cylinder	2	62 M83	62 M83	62 M83	62 M83
9	HOUSING-BEARING, Discharge End	1	202 SSM006	202 SSH006	202 SSH006	202 SSM006
10	SCREW-HEX CAP, Housing to Cylinder	9	75 A9	75 A9	75 A9	75 A9
10	SCREW-HEX CAP	6	75 A2	75 A2	75 A2	75 A2
11	WASHER-LOCK, Bearing Housing to Cylinder	15	95 B3	95 B3	95 B3	95 B3
‡	PLUG-CSK PIPE, Discharge Bearing Housing	1	64 B5	64 B5	64 B5	64 B5
12	BEARING-ROLLER, Discharge End Main Rotor	1	12 BA92	12 BA91	12 BA91	12 BA92
13	BEARING-ROLLER, Discharge End Secondary Rotor (Consists of Two [2] Bearings & Cup Spacer)	1	12 BA94	12 BA90	12 BA90	12 BA94
14	WASHER-PLAIN, Outer Race Retainer	2	95 A3	95 A3	95 A3	95 A3
15	SCREW-HEX CAP, Outer Race Retainer	2	75 A5N	75 A5N	75 A5N	75 A5N
16	SHIM SET, Discharge End Main Rotor Bearing	1	77 H56	77 H54	77 H54	77 H56
17	PLATE-BEARING RETAINER, Discharge End Main Rotor Bearing	1	201 SSM253	201 SSH253	201 SSH253	201 SSM253
18	WASHER-LOCK, Bearing Retainer	1	95 B7	95 B7	95 B7	95 B7
19	SCREW-HEX CAP, Bearing Retainer	1	75 A17N	75 A29N	75 A29N	75 A17N
20	SHIM SET, Discharge End Secondary Rotor Bearing	1	77 H57	77 H53	77 H53	77 H57
21	PLATE-BEARING RETAINER, Discharge End Secondary Rotor Bearing	1	200 SSM253	200 SSH253	200 SSH253	200 SSM253
22	WASHER-LOCK, Bearing Retainer	1	95 B7	None	None	95 B7
23	SCREW-HEX CAP, Bearing Retainer	1	75 A29N	75 A29N	75 A29N	75 A29N
24	PLATE-BEARING COVER, Discharge End	1	200 SSM315	200 SSH315	200 SSH315	200 SSM315
25	WASHER-LOCK, Cover to Bearing Housing	See ()	95 B3 (12)	95 B3 (9)	95 B3 (9)	95 B3 (12)
25	GASKET-RING	3	None	25 F13	25 F13	None
26	SCREW-HEX CAP, Cover to Bearing Housing	See ()	75 A7 (12)	75 A7 (9)	75 A7 (9)	75 A7 (12)
26	SCREW-HEX CAP (3/8 x 1-1/2)	3	None	75 A7 N	75 A7 N	None
27	BEARING-ROLLER, Inlet End Main Rotor	1	12 W34	12 BA89	12 BA89	12 W34
28	RING-RETAINER, Inlet End Main Rotor Bearing	1	74 D39	74 D38	74 D38	74 D34
29	BEARING-ROLLER, Inlet End Secondary Rotor	1	12 BA93	12 BA88	12 BA88	12 BA93
30	RING-RETAINER, Inlet End Secondary Rotor Bearing	1	74 D38	74 D37	74 D37	74 D38
31	PIN-DOWEL, Seal Housing to Bearing Housing	2	62 M83	62 M83	62 M83	62 M83
32	SEAL-SHAFT, Main Rotor	1	60 DD98	60 DD98	60 DD98	60 DD98
33	HOUSING-SEAL, Inlet End	1	200 SSM362	200 SSH362	200 SSH362	200 SSM362
34	WASHER-LOCK, Seal Housing to Bearing Housing	16	95 B3	95 B3	95 B3	95 B3
35	SCREW-HEX CAP, Seal Housing to Bearing Housing	16	75 A2	75 A2	75 A2	75 A2
36	COVER, Cylinder	2	200 SSH225	200 SSH225	200 SSH225	200 SSH225
37	GASKET	2	201 SSH715	201 SSH715	201 SSH715	201 SSH715
38	SCREW-HEX CAP	18	75 A7	75 A7	75 A7	75 A7
39	WASHER-LOCK	18	95 B3	95 B3	95 B3	95 B3
‡	PLUG-SQHD	2	64 AA6	64 AA6	64 AA6	64 AA6
‡	PLUG-SQHD	1	64 A25	None	None	64 A25
‡	COVER, Bottom of Cylinder	1	200 SSM225	None	None	200 SSM225
‡	GASKET	1	200 SSM715	None	None	200 SSM715
‡	SCREW-HEX CAP	12	75 A2	None	None	75 A2
‡	WASHER-LOCK	12	95 B3	None	None	95 B3
‡	PLUG-SQHD PIPE	1	64 AA6	None	None	64 AA6
‡	GASKET-RING	1	None	None	None	25 C2398
‡	PLUG-HEX HEAD PIPE	2	64 T50	64 T50	64 T50	64 T50
‡	ADAPTOR-UNLOADER	1	None	None	None	200 ECH186
‡	SCREW-HEX CAP, Adaptor to Cylinder	8	None	None	None	75 A80
‡	WASHER-LOCK, Adaptor to Cylinder	8	None	None	None	95 B5

* Joints marked with asterisk sealed with Gardner-Denver® Gasket Eliminator Part No. 25BC256.

** See Matrix/Menu Page for Column 7 designator.

‡ Not shown on illustration.

139-B39-1a

GARDNER-DENVER COMPRESSOR

139-B39-1a
Revised September, 1986

Order by Part Number and Description. Reference Numbers for your convenience only.

Ref. No.	Name of Part	Qty. Req. Per Comp.	**Column Code 5L	**Column Code 5L	**Column Code 5L
			**Column Code 7D & 7N	**Column Code 7F & 7P	**Column Code 7H & 7R
BARE COMPRESSOR			SSMMBA01	SSMMBA02	SSMMBA03
			Part No.	Part No.	Part No.
1	CYLINDER, Compressor	1	201 SSM002	201 SSM002	201 SSM002
2	PIN-DOWEL, Inlet Bearing Housing to Cylinder	2	62 M83	62 M83	62 M83
3	HOUSING-BEARING, Inlet End	1	201 SSM006	201 SSM006	201 SSM006
4	WASHER-LOCK, Bearing Housing to Cylinder	16	95 B3	95 B3	95 B3
5	SCREW-HEX CAP, Bearing Housing to Cylinder	16	75 A7	75 A7	75 A7
6	ROTOR KIT (Main & Secondary Pair)	1	SSM77085	SSM77086	SSM77087
8	PIN-DOWEL, Discharge Bearing Housing to Cylinder	2	62 M83	62 M83	62 M83
9	HOUSING-BEARING, Discharge End	1	202 SSM006	202 SSM006	202 SSM006
10	SCREW-HEX CAP, Housing to Cylinder	9	75 A9	75 A9	75 A9
10	SCREW-HEX CAP	6	75 A2	75 A2	75 A2
11	WASHER-LOCK, Bearing Housing to Cylinder	15	95 B3	95 B3	95 B3
†	PLUG-CSK PIPE, Discharge Bearing Housing	1	64 B5	64 B5	64 B5
12	BEARING-ROLLER, Discharge End Main Rotor	1	12 BA92	12 BA92	12 BA92
13	BEARING-ROLLER, Discharge End Secondary Rotor (Consists of Two [2] Bearings & Cup Spacer)	1	12 BA94	12 BA94	12 BA94
14	WASHER-PLAIN, Outer Race Retainer	2	95 A3	95 A3	95 A3
15	SCREW-HEX CAP, Outer Race Retainer	2	75 A5N	75 A5N	75 A5N
16	SHIM SET, Discharge End Main Rotor Bearing	1	77 H56	77 H56	77 H56
17	PLATE-BEARING RETAINER, Discharge End Main Rotor Bearing	1	201 SSM253	201 SSM253	201 SSM253
18	WASHER-LOCK, Bearing Retainer	1	95 B7	95 B7	95 B7
19	SCREW-HEX CAP, Bearing Retainer	1	75 A17N	75 A17N	75 A17N
20	SHIM SET, Discharge End Secondary Rotor Bearing	1	77 H57	77 H57	77 H57
21	PLATE-BEARING RETAINER, Discharge End Secondary Rotor Bearing	1	200 SSM253	200 SSM253	200 SSM253
22	WASHER-LOCK, Bearing Retainer	1	95 B7	95 B7	95 B7
23	SCREW-HEX CAP, Bearing Retainer	1	75 A29N	75 A29N	75 A29N
24	PLATE-BEARING COVER, Discharge End	1	200 SSM315	200 SSM315	200 SSM315
25	WASHER-LOCK, Cover to Bearing Housing	12	95 B3	95 B3	95 B3
26	SCREW-HEX CAP, Cover to Bearing Housing	12	75 A7	75 A7	75 A7
27	BEARING-ROLLER, Inlet End Main Rotor	1	12 W34	12 W34	12 W34
28	RING-RETAINER, Inlet End Main Rotor Bearing	1	74 D39	74 D39	74 D39
29	BEARING-ROLLER, Inlet End Secondary Rotor	1	12 BA93	12 BA93	12 BA93
30	RING-RETAINER, Inlet End Secondary Rotor Bearing	1	74 D38	74 D38	74 D38
31	PIN-DOWEL, Seal Housing to Bearing Housing	2	62 M83	62 M83	62 M83
32	SEAL-SHAFT, Main Rotor	1	60 DD98	60 DD98	60 DD98
33	HOUSING-SEAL, Inlet End	1	200 SSM362	200 SSM362	200 SSM362
34	WASHER-LOCK, Seal Housing to Bearing Housing	16	95 B3	95 B3	95 B3
35	SCREW-HEX CAP, Seal Housing to Bearing Housing	16	75 A2	75 A2	75 A2
36	COVER, Cylinder	2	200 SSH225	200 SSH225	200 SSH225
37	GASKET	2	201 SSH715	201 SSH715	201 SSH715
38	SCREW-HEX CAP	18	75 A7	75 A7	75 A7
39	WASHER-LOCK	18	95 B3	95 B3	95 B3
†	PLUG-SQHD	2	64 AA6	64 AA6	64 AA6
†	PLUG-SQHD	1	64 A25	64 A25	64 A25
†	COVER, Bottom of Cylinder	1	200 SSM225	200 SSM225	200 SSM225
†	GASKET	1	200 SSM715	200 SSM715	200 SSM715
†	SCREW-HEX CAP	12	75 A2	75 A2	75 A2
†	WASHER-LOCK	12	95 B3	95 B3	95 B3
†	PLUG-SQHD PIPE	1	64 AA6	64 AA6	64 AA6
†	PLUG-HEX HEAD PIPE, Bottom of Cylinder	2	64 T50	64 T50	64 T50

* Joints marked with asterisk sealed with Gardner-Denver® Gasket Eliminator Part No. 25BC256.
 ** See Matrix/Menu Page for Column 7 designator.
 † Not shown on illustration.

139-B39-1b

GARDNER-DENVER COMPRESSOR
 Revised September, 1986
 139-B39-1b

INLET VALVE & MOUNTING GROUP (SSH Air Ends)

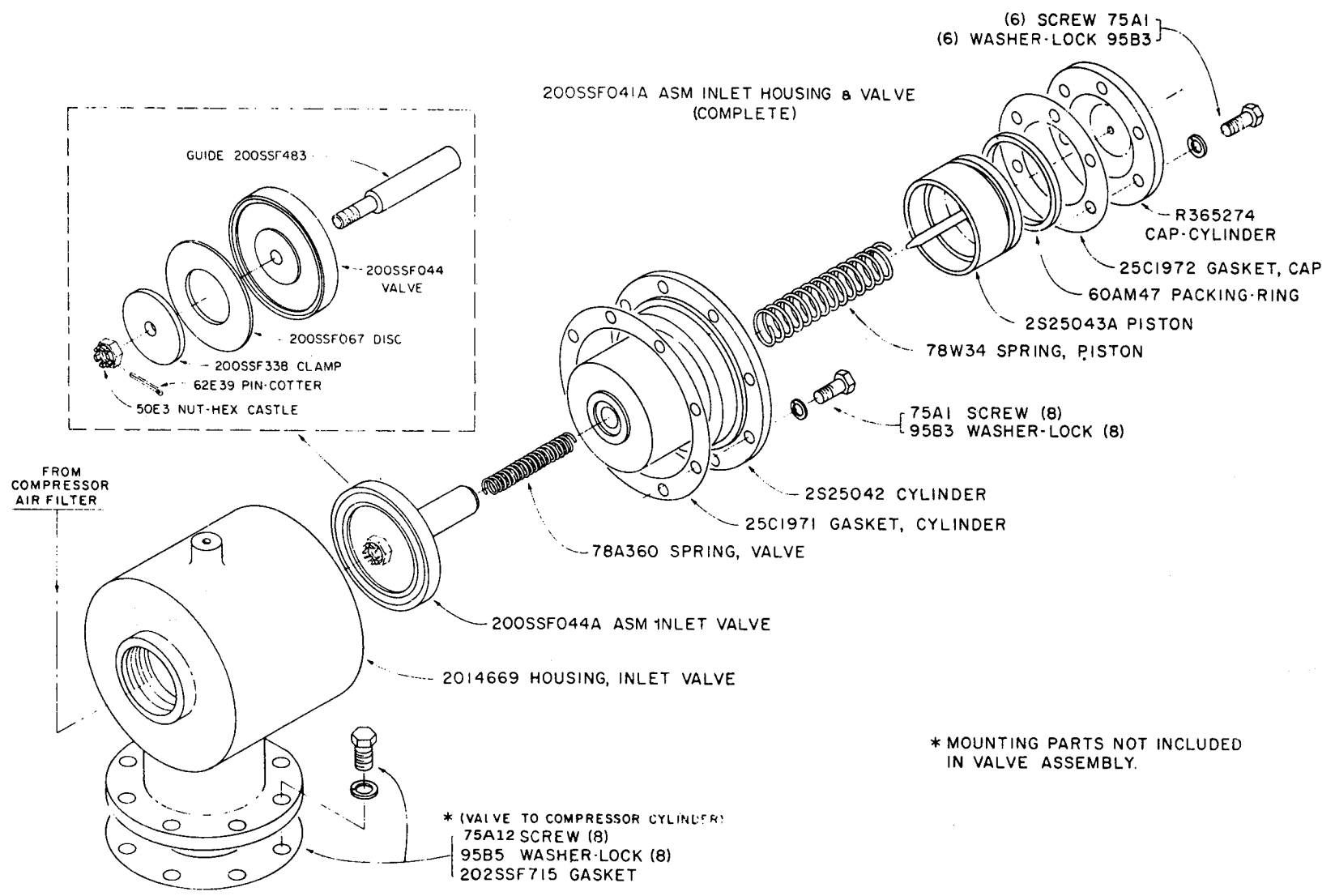

139-A39-2

D75740X

**INLET VALVE & AIR FILTER GROUP
(SSM Air Ends)**

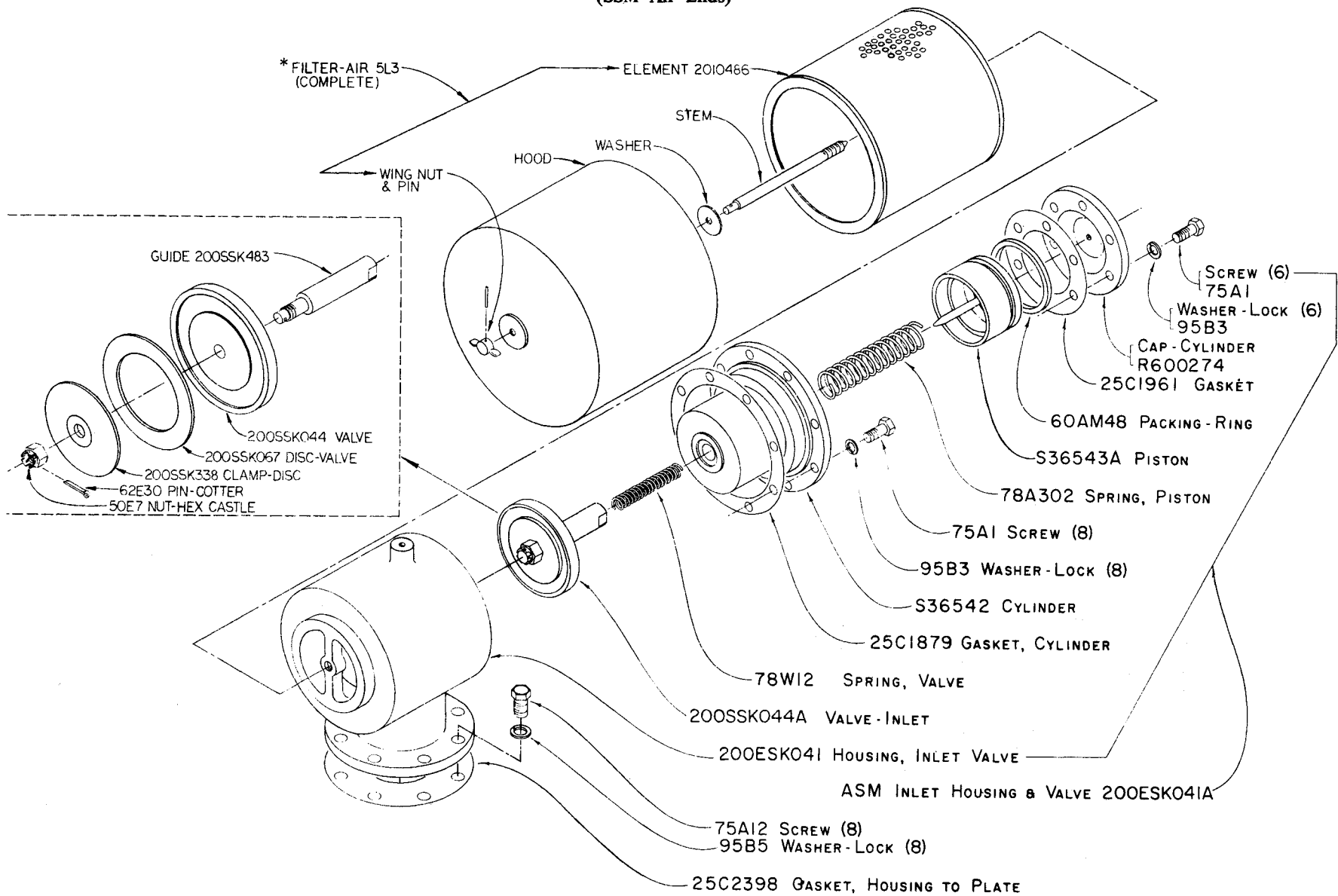

139-A39-3

* Refer to Mini-Matrix & Menu page for Column 10 option.

E75154

Order by Part Number and Description. Reference Numbers for your convenience only.

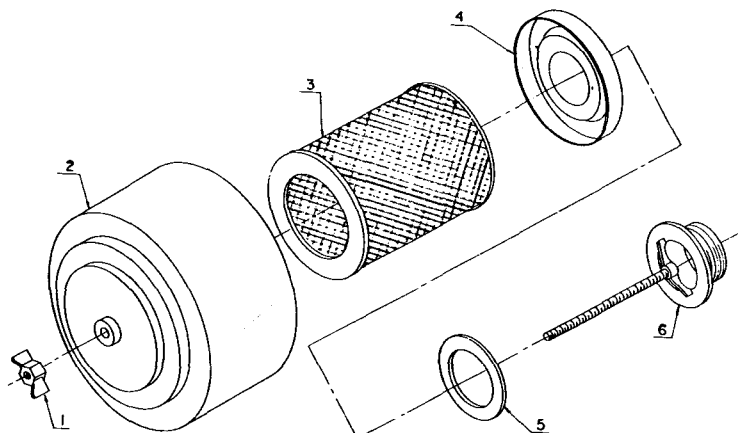

C76532

Ref No	Name of Part	Qty. Req Per Comp	Model Column Option 10S
AIR FILTER GROUP — SSH AIR ENDS (Standard) (Nonmetallic)			Part No.
	COMPLETE AIR FILTER, Incl Ref. No. 1 thru 6	1	5A460
1	NUT-WING	1	2109583
2	HOOD	1	2109585
3	ELEMENT	1	2008616
4	PLATE-BASE	1	2109587
5	GASKET	1	2008150
6	BASE & STEM	1	- - - - -

**STANDARD AIR FILTER
(With Enclosure)**

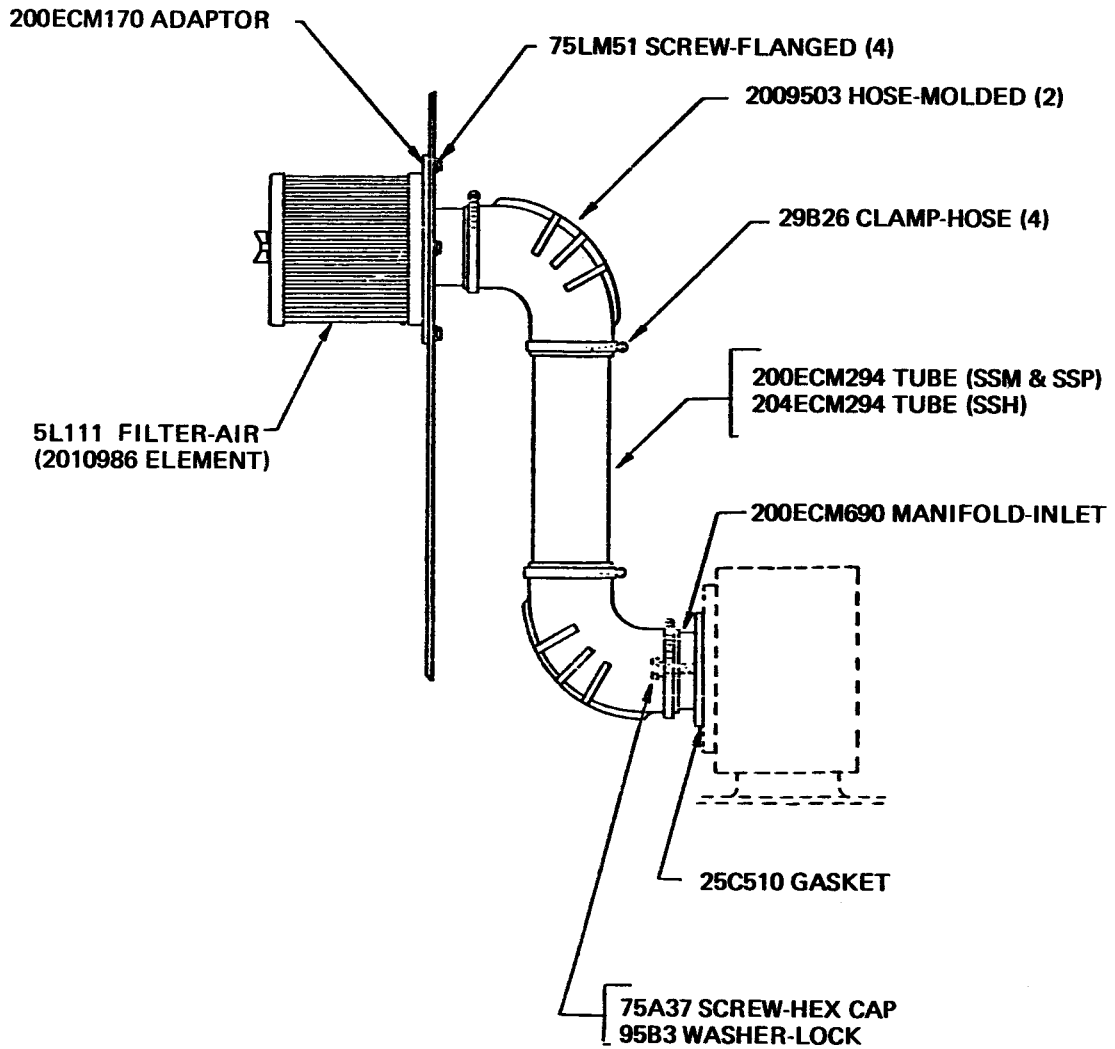

HEAVY-DUTY AIR FILTER

139-A39-5

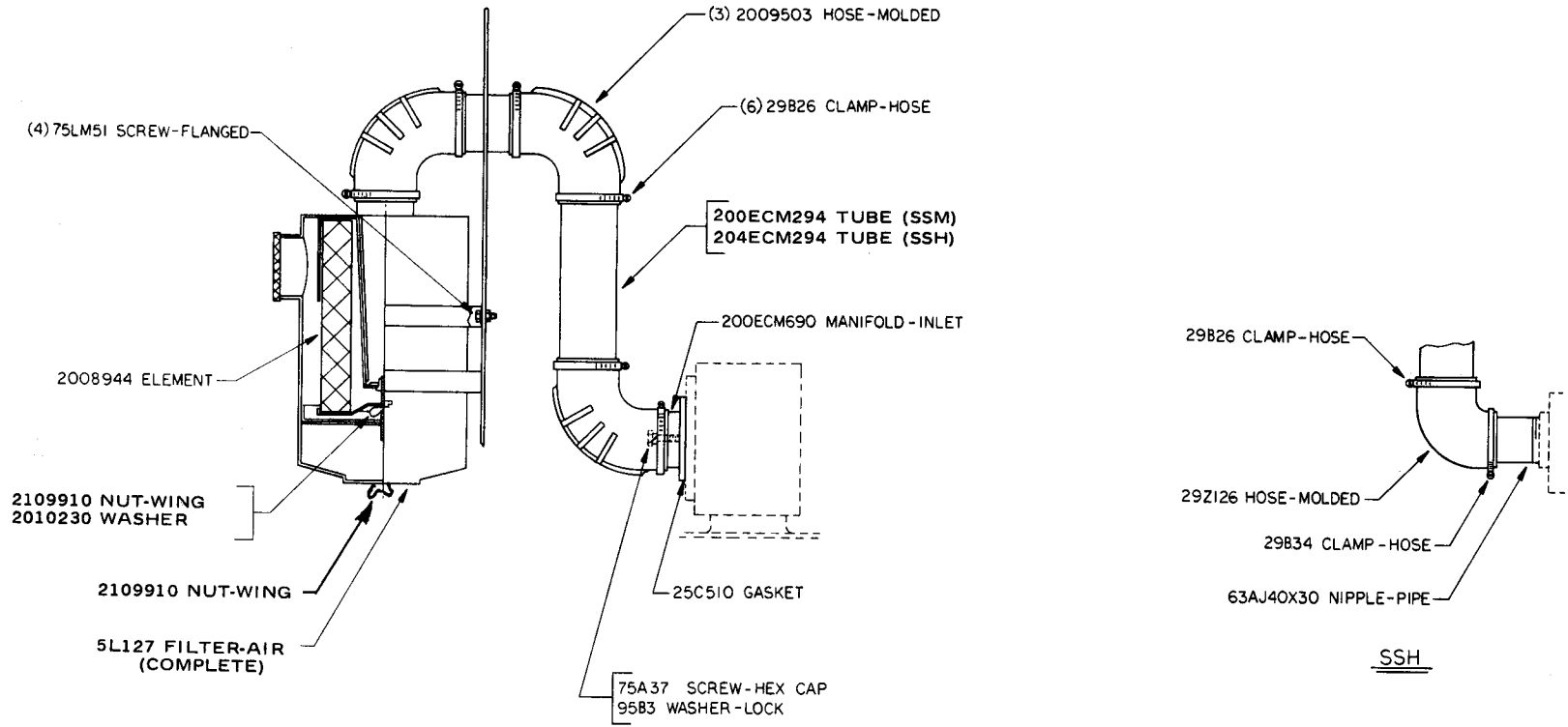

D76870

MINIMUM PRESSURE VALVE

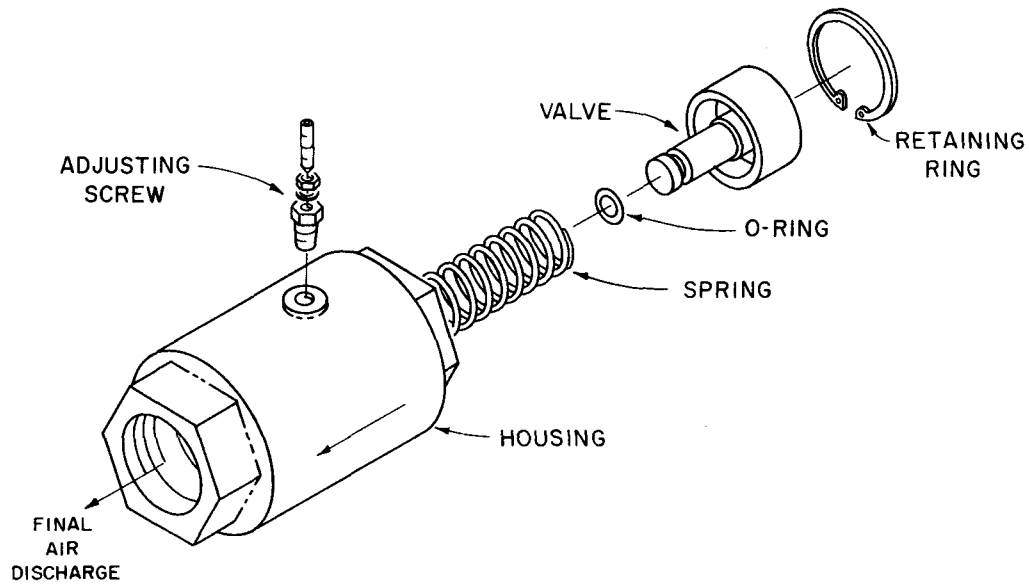

C75812

Name of Part	Part No.
ASM MINIMUM PRESSURE VALVE, Includes Following Items	200ESM527A
HOUSING	201ESM182
SPRING	78W6
O-RING	2009222
VALVE-MINIMUM PRESSURE	200ESM527
RING-RETAINING	74D7
ADJUSTING SCREW	200ESM176
ADAPTOR, Adjusting Screw	200ESM170
GASKET-RING, Adjusting Screw	25F29
LOCKNUT, Adjusting Screw	50AW17

OIL PIPING GROUP

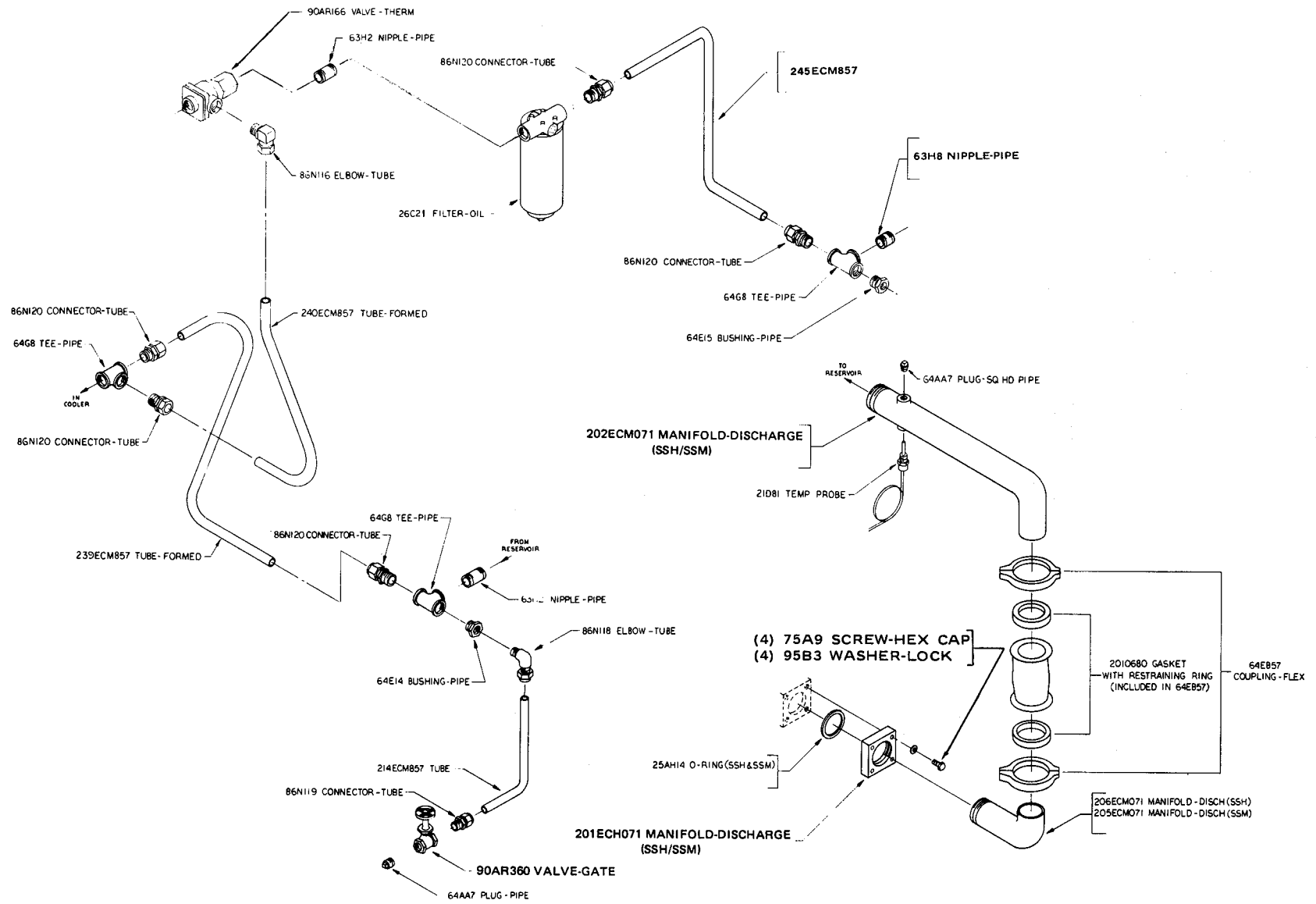

139-B39-8

E76876X

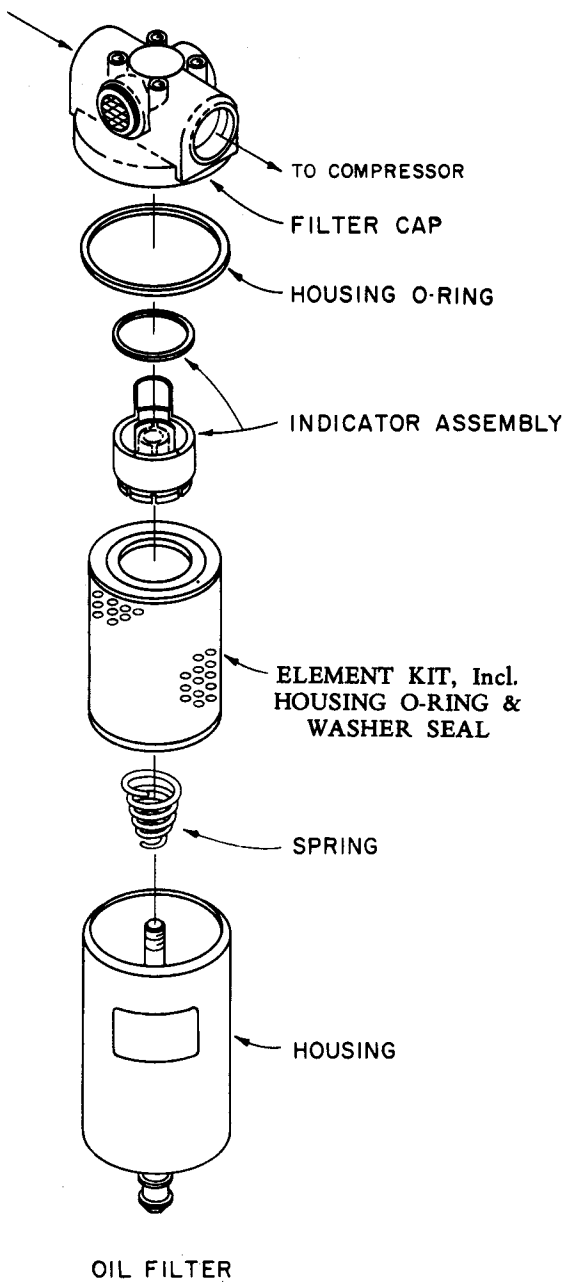

139-A39-9

Name of Part	All Models ECM
OIL FILTER	
FILTER-OIL, Includes Following Items	26C21
WINDOW ASSEMBLY — Includes Housing O-Ring *	2109463
INDICATOR ASSEMBLY (Bypass Valve) — Includes O-Ring	2109125
BOLT, Hex Head	2109774
ELEMENT ASSEMBLY	2109093
WASHER, Gasket	2109411
SPRING	2109126

* ORING PART NUMBER 54C214.

THERMOSTATIC MIXING VALVE

THERMAL VALVE (Aluminum Body)

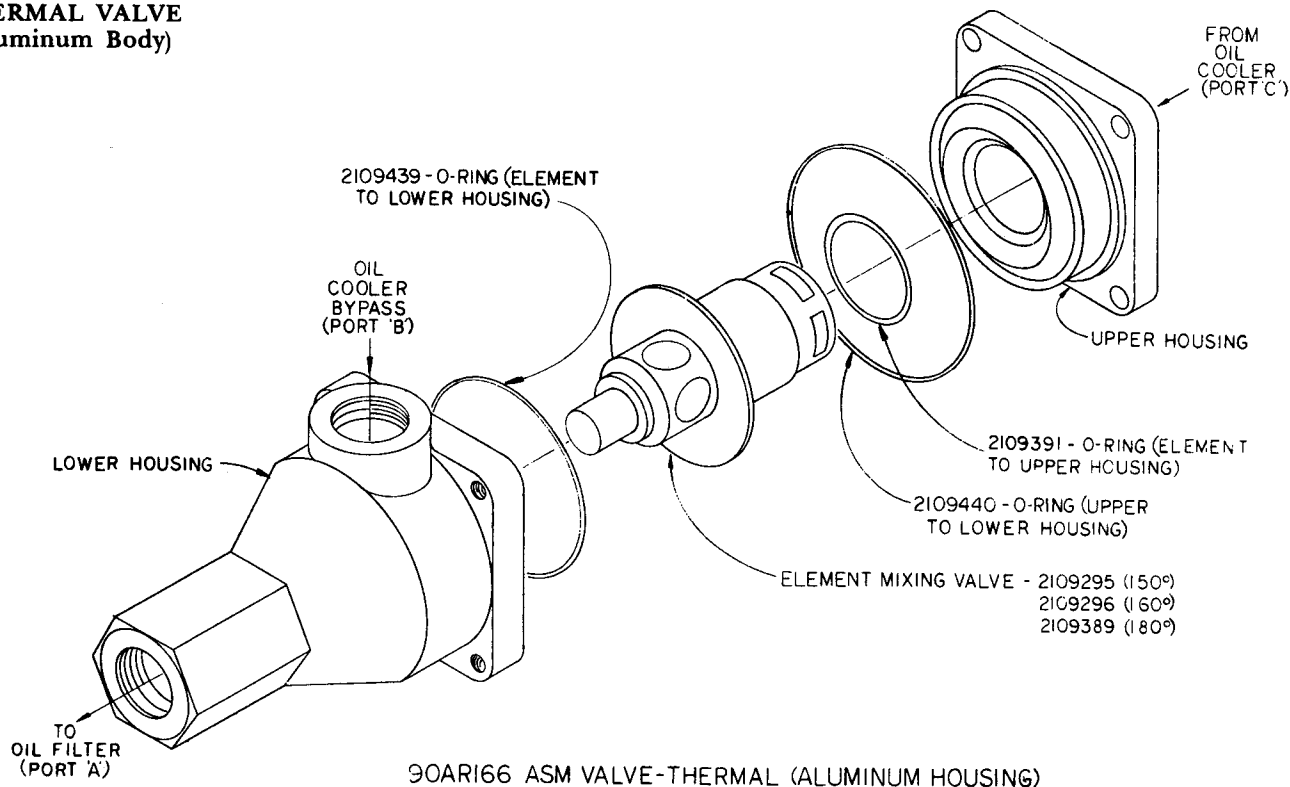

139-A39-10

C76528

AIR-COOLED OIL COOLER (NO AFTERCOOLER)

139-A39-11

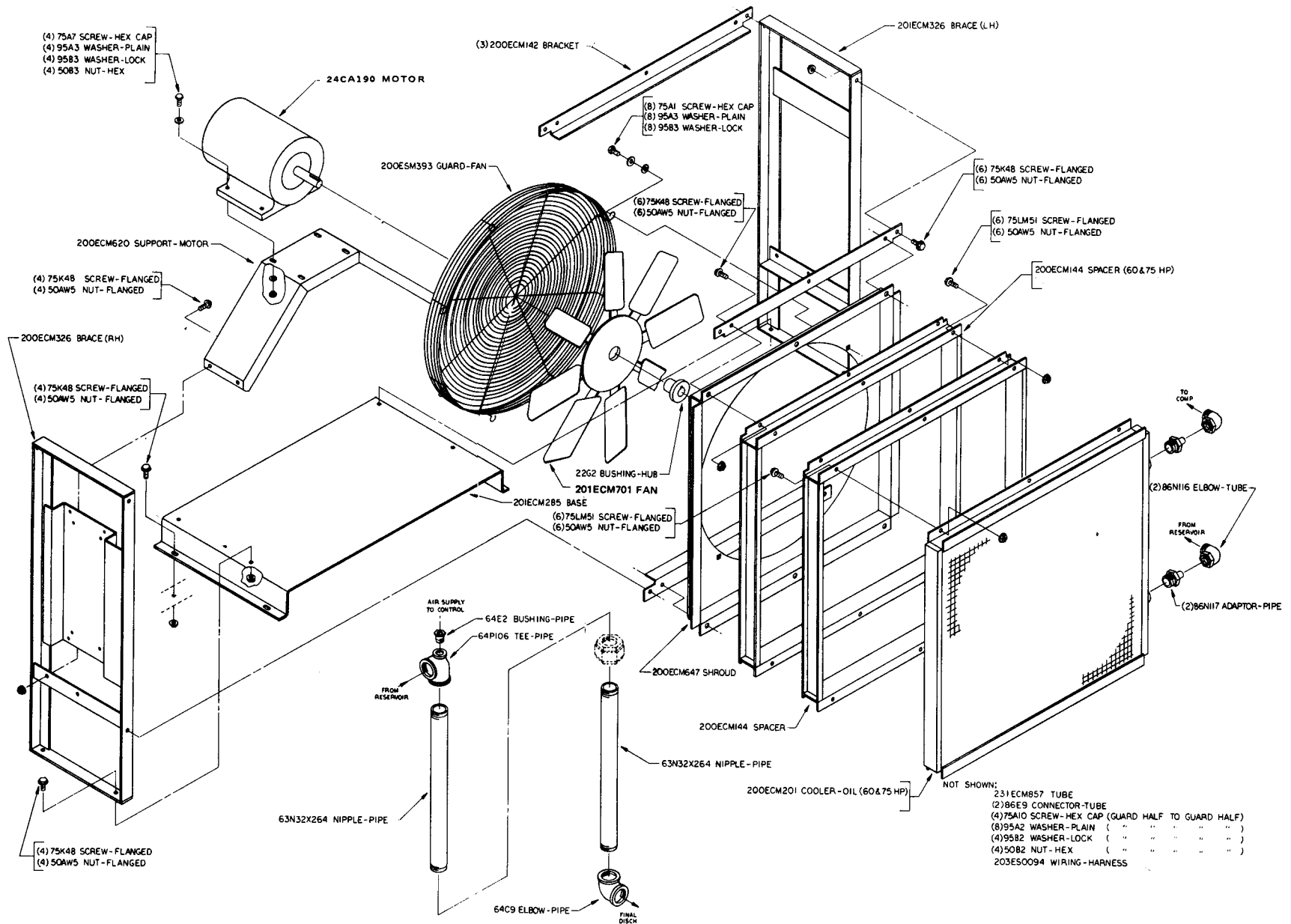

E76874X

AIR-COOLED OIL COOLER (WITH AFTERCOOLER)

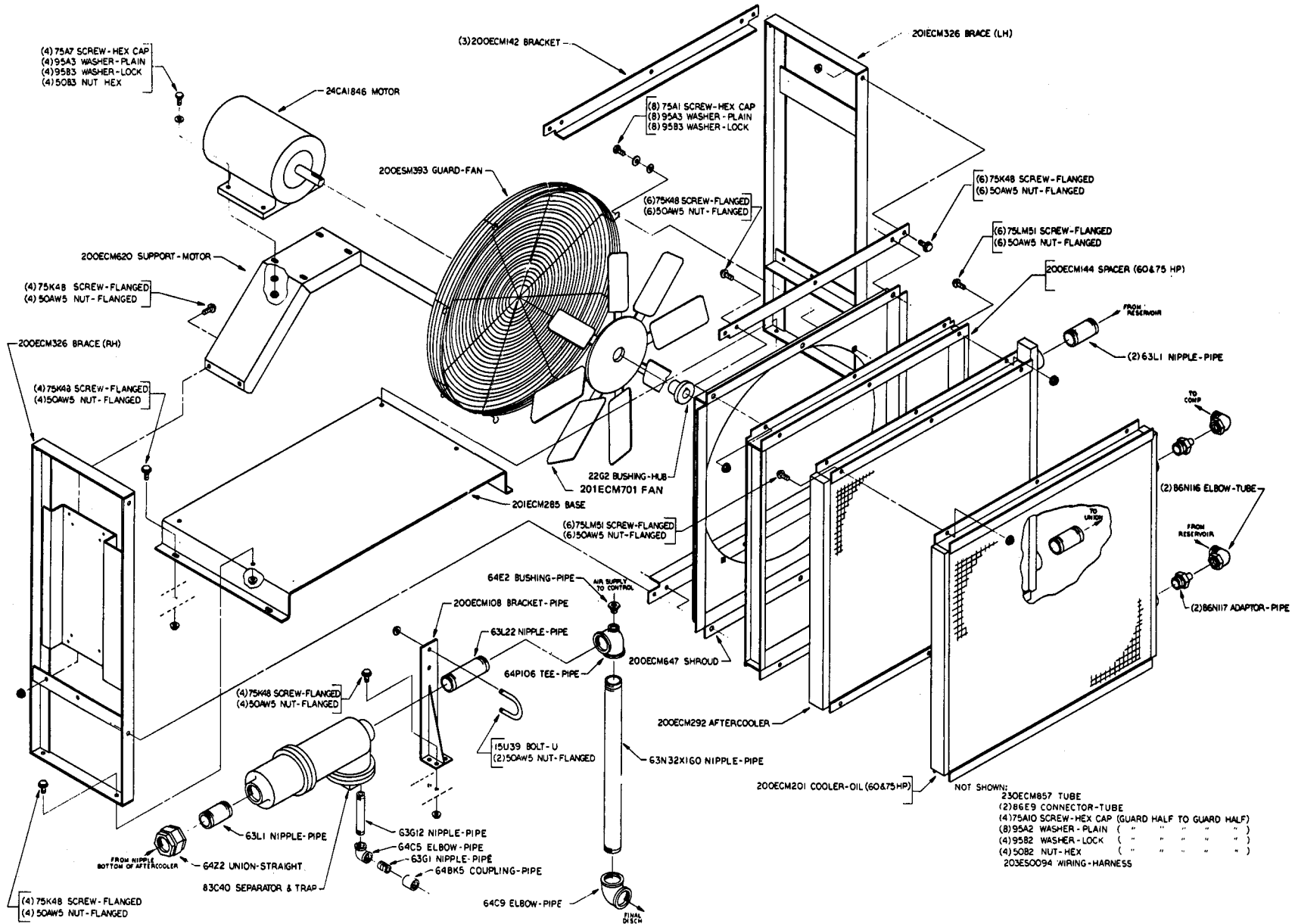

139-A39-12

E76873X

WATER-COOLED OIL COOLER (NO AFTERCOOLER)

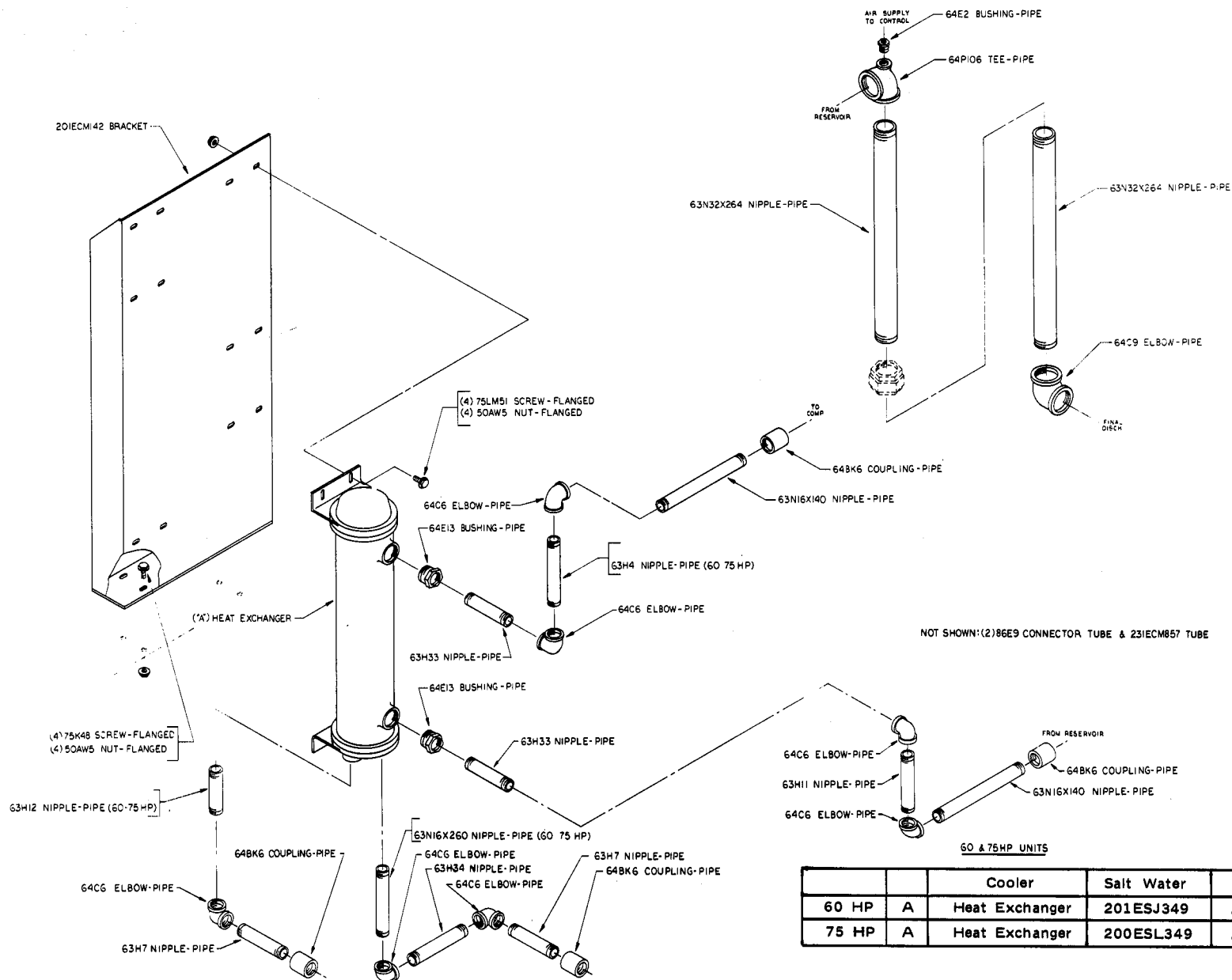

130-A39-13

E76872

INSTRUMENT PANEL GROUP

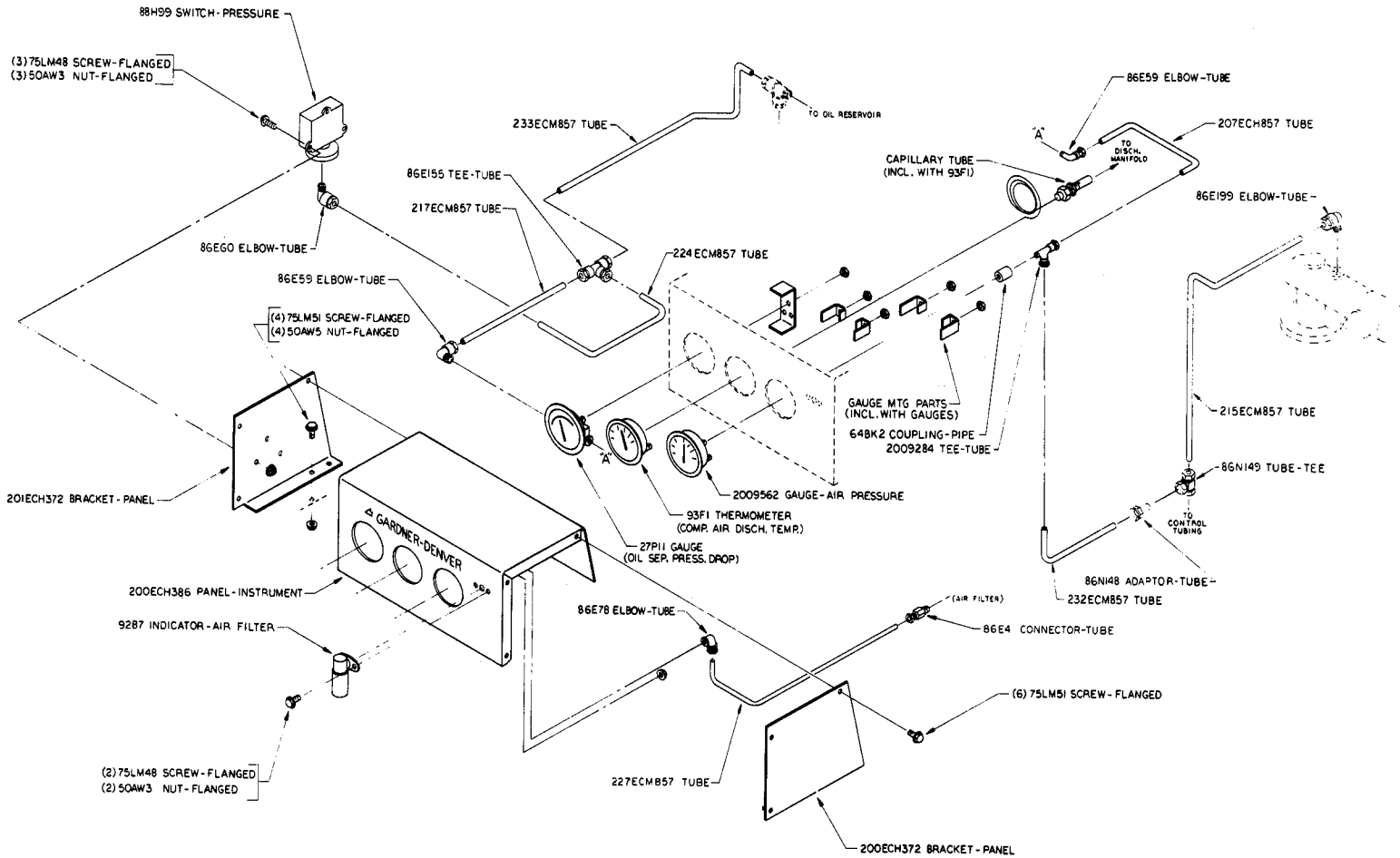

139-A39-15

CONTROL LINES GROUP

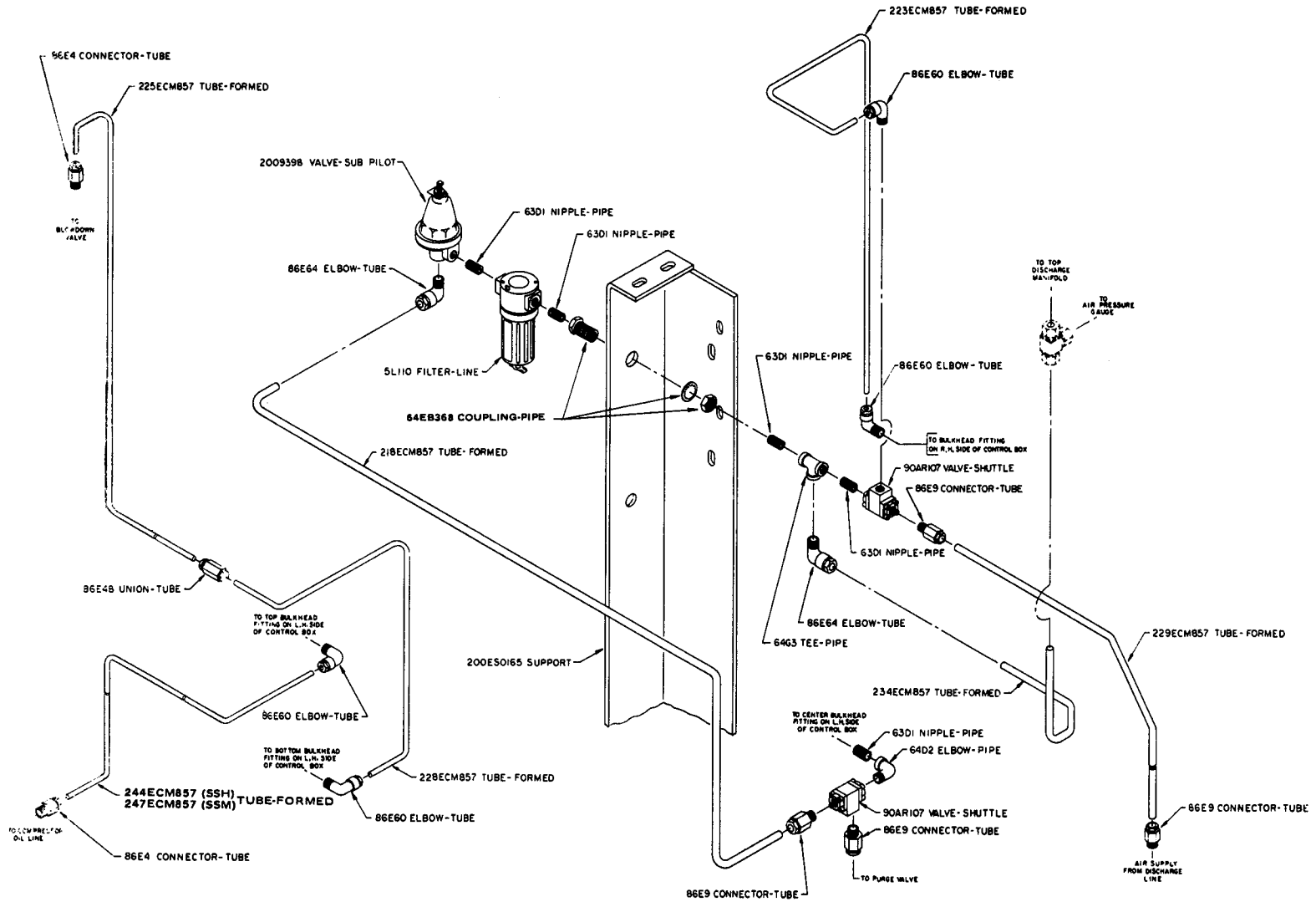

139-B39-16

E76882X

GARDNER-DENVER COMPRESSOR
 Revised September, 1986
 139-B39-16

ORDER BY PART NUMBER AND DESCRIPTION. REFERENCE NUMBERS FOR YOUR CONVENIENCE ONLY.

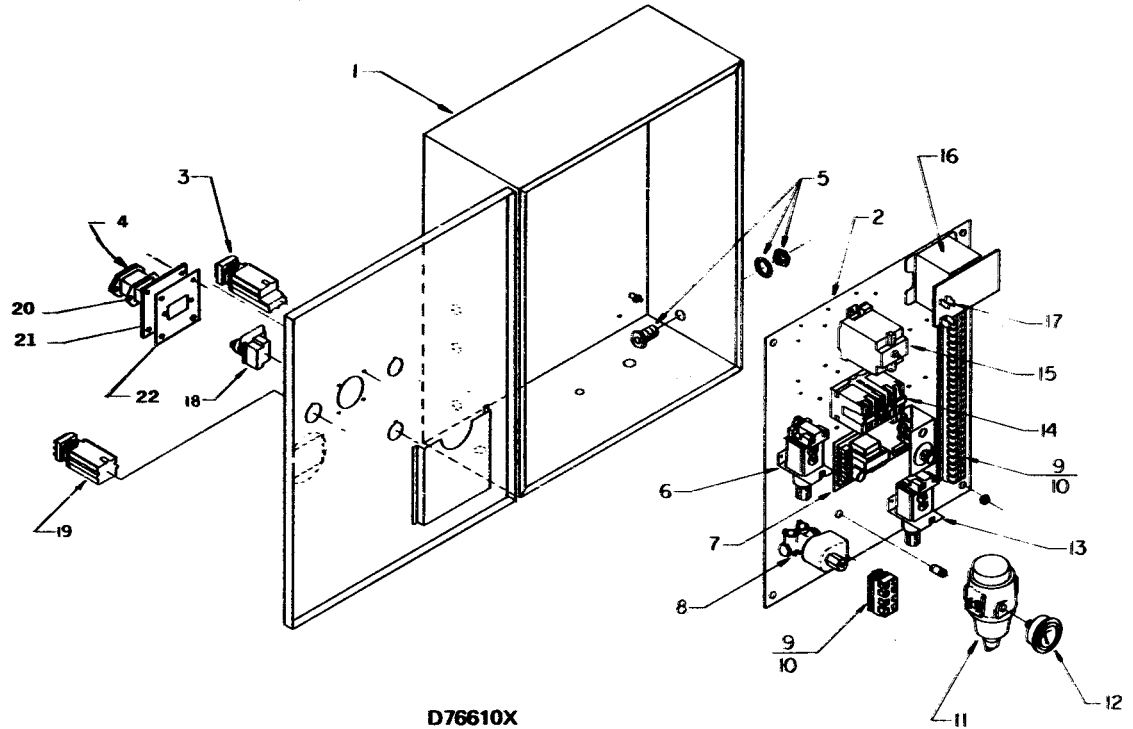

D76610X

Ref. No.	Name of Part	Qty. Req. Per Comp.	All ECM Models
CONTROL			
1	BOX-CONTROL	1	See Page 16b
†	SCREW-HEX CAP, Control Box to Supports	4	75A26
†	WASHER-PLAIN, Control Box to Supports	8	95A1
†	WASHER-LOCK, Control Box to Supports	4	95B1
†	NUT-HEX, Control Box to Supports	4	50B1
2	PANEL-ELECTRICAL	1	See Page 16b
3	SWITCH-ON/OFF	1	See Page 16b
4	HOURMETER (50 Hz)	1	24CA1995
4	HOURMETER (60 Hz)	1	24CA1994
5	COUPLING, Bulkhead	5	86A168
6	SWITCH, Oil Pressure	1	88A301
7	SWITCH, Air Temperature	1	21D80
8	VALVE-SOLENOID	1	91B34
9	BLOCK-TERMINAL	35	24CA925
10	BLOCK-END	3	24CA924
11	REGULATOR-PRESSURE	1	88H26
12	GAUGE-PRESSURE	1	27P104
13	SWITCH, Air Pressure	1	2009006
14	RELAY, Timing	1	24CA285
15	RELAY	1	24CA771
16	TRANSFORMER	1	See Page 16b
17	FUSETRON	1	See Page 16b
18	SWITCH - 2 Position Selector	1	24CA782
19	LIGHT, Pilot - Dual	1	24CA552
20	GASKET, Hourmeter	1	24CA2087
21	PLATE, Hourmeter	1	202EAQ247
22	GASKET, Plate	1	200EAQ715

† Not shown on illustration.

CONTROL ITEMS
(Selective)

Part Name & Description	Constant Speed Low Demand Mode		Automatic Start-Timed Stop	
	Nema 1	Nema 4	Nema 1	Nema 4
BOX-CONTROL	200ESO179	201ESO179	203EAQ179	204EAQ179
PANEL, Electrical	207ESO216	208ESO216	207ESO216	208ESO216
BOOT, Transparent (PB)	-----	24CA281	-----	24CA281
O-RING, Bulkhead (4)	-----	24A383	-----	24A383
GASKET, Hourmeter	-----	201ESK715	-----	201ESK715
SEAL-PLUG (2)	-----	24A509	-----	24A509
SWITCH, Start/Stop-Reset (Momentary)	24CA1793	24CA1793	-----	-----
SWITCH, Off/On (Maintained) *	-----	-----	24CA1817	24CA1817
LAMP, Indicator	24CA40	24CA40	24CA40	24CA40
TIMER	-----	-----	24A482	24A482
RELAY	24CA541	24CA541	24CA541	24CA541
LIGHT-PILOT, Dual Indicating	24CA552	24CA552	24CA552	24CA552
BOX-CONTROL, Timer	-----	-----	-----	200ESK179
GASKET, Control Box	-----	-----	-----	202ESK715
COVER, Timer	-----	-----	-----	202ESK225
GASKET, Timer Cover	-----	-----	-----	203ESK715
TRANSFORMER, 50 Hz (380/400/415V) 250VA ...	24CA1460	24CA1460	24CA1460	24CA1460
TRANSFORMER, 60 Hz (208/277/380V) 250VA ...	24CA160	24CA160	24CA160	24CA160
TRANSFORMER, 60 Hz (230/460/575V) 250VA ...	24CA159	24CA159	24CA159	24CA159
FUSETRON	24CA1026	24CA1026	24CA1026	24CA1026

* 24CA1817 Switch is "Maintained" ON and "Momentary" Reset.

SUBTRACTIVE PILOT VALVE - 2009398
(See Note)

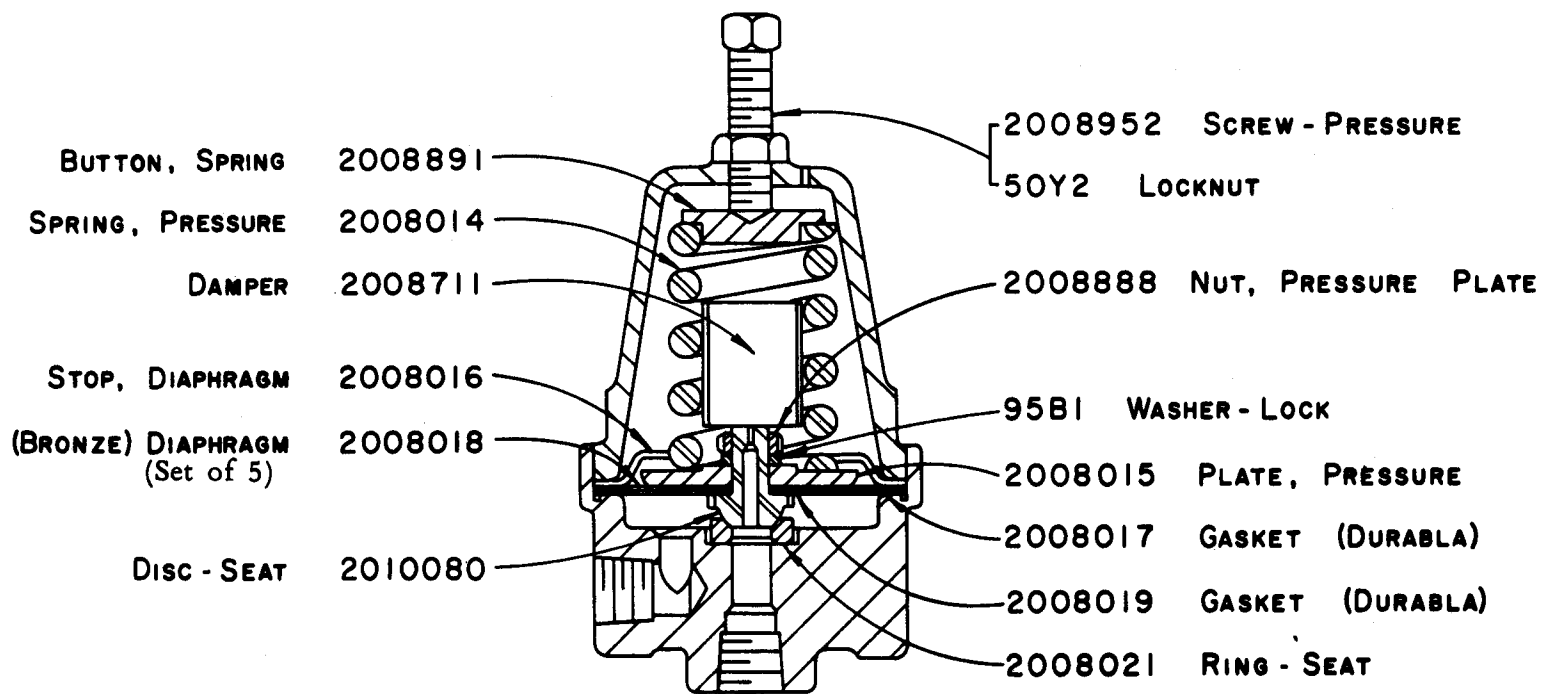

139-A39-17

NOTE: It is necessary to replace some parts in groups to insure satisfactory repair. When replacing diaphragm also replace both diaphragm and seat gaskets. When replacing seat disc or seat ring replace also the mating seat ring or disc and the seat disc gasket.

B74408X

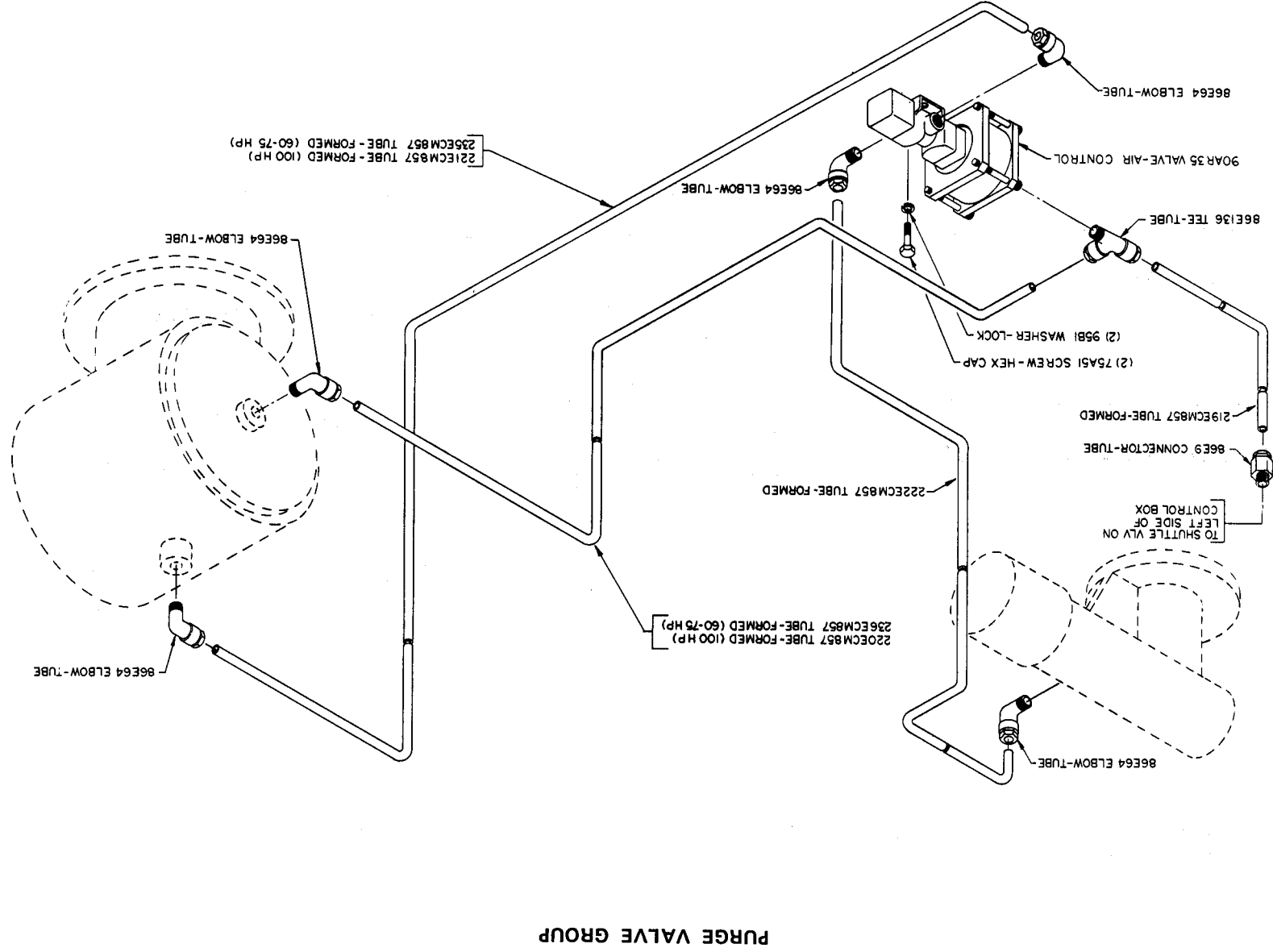

D76869

COMPRESSOR BASE GROUP

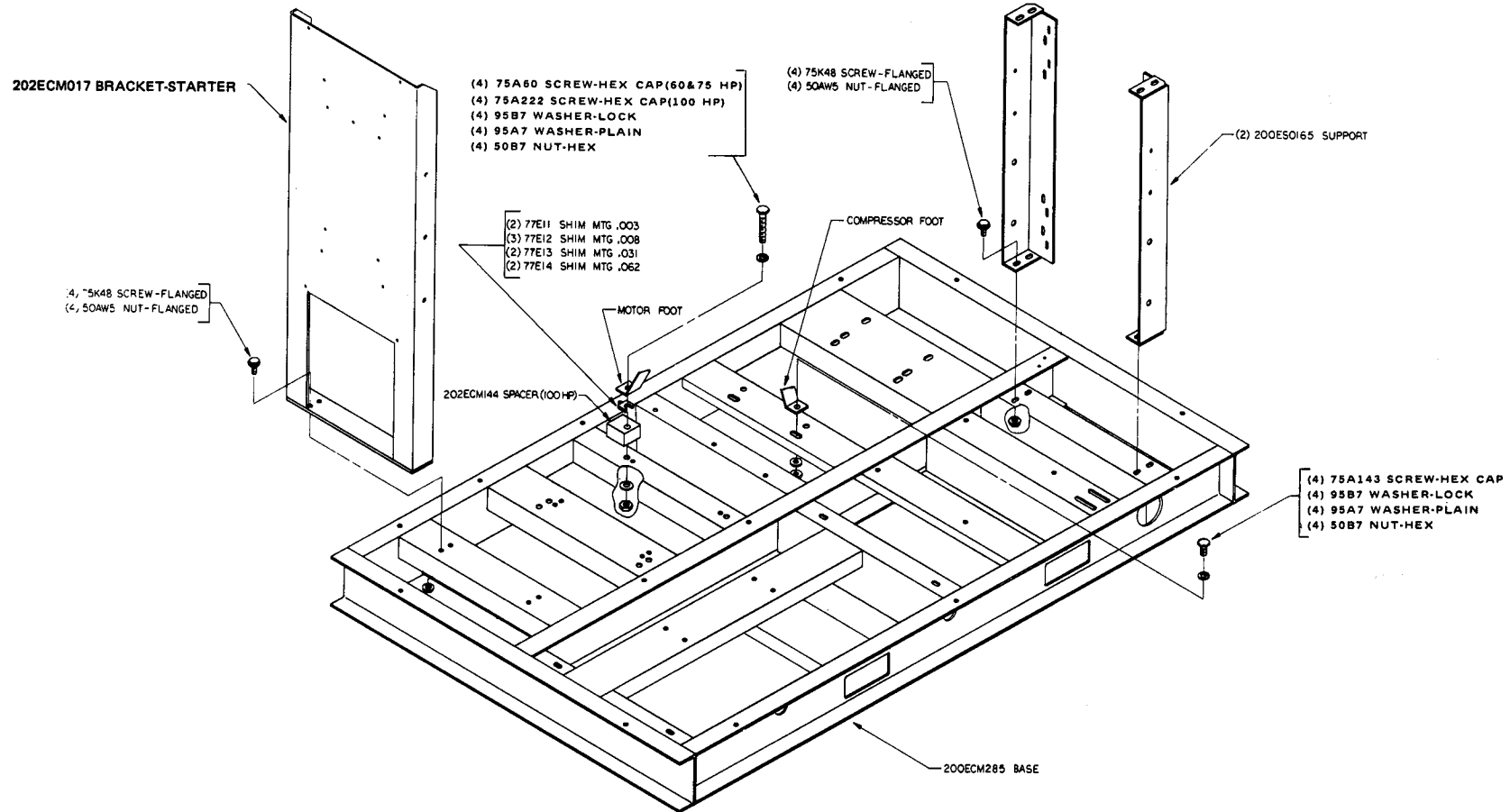

139-A39-19

GARDNER-DENVER COMPRESSOR

139-A39-19
 Revised September, 1986

E76878X

BAFFLE ASSEMBLY

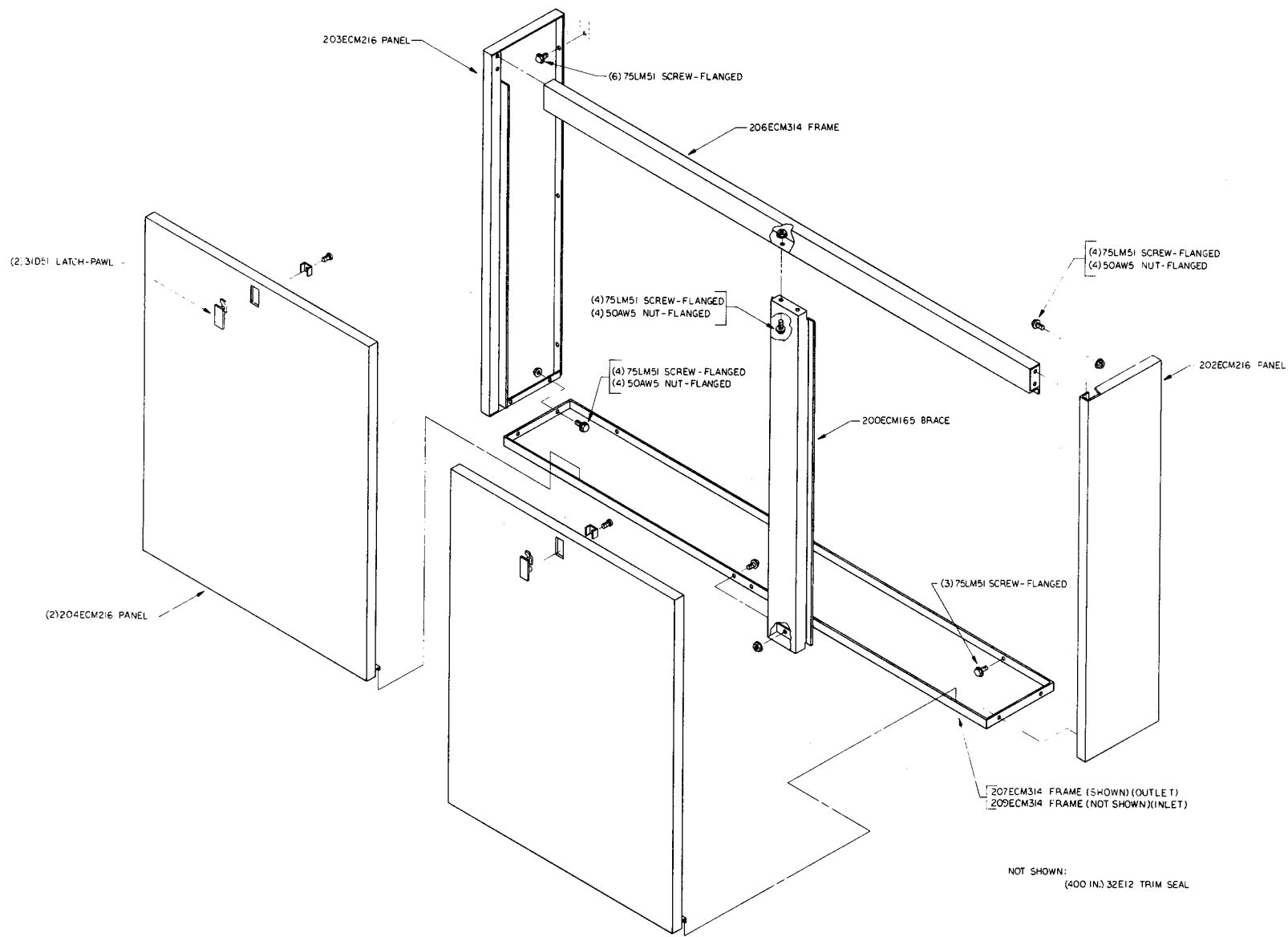

139-A39-21

E76877

VENT FAN

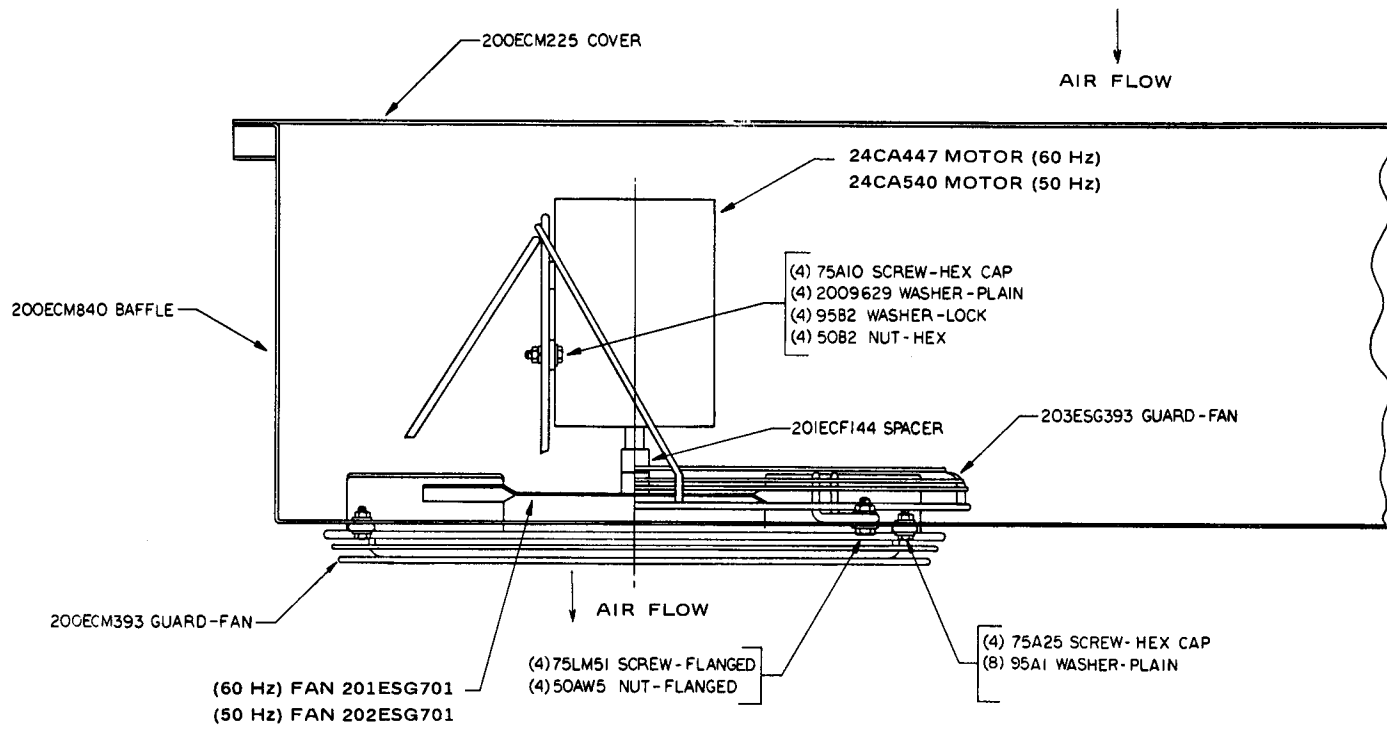

NOT SHOWN:
 CONTROL ASM-ECM 76521
 WIRING HARNESS-ECM 77169

139-A39-22

GARDNER-DENVER COMPRESSOR

139-A39-22
 Revised September, 1986

D76868X

Name of Part	Qty. Req. Per Comp.	60 & 75 HP With Enclosure	60 & 75 HP Without Enclosure
COUPLING GUARD GROUP			
		Part No.	Part No.
GUARD-COUPLING, Flexible Coupling	2	204ECM339	205ECM339
SCREW-FLANGED, Guards to Base	4	75LM51	75LM51
NUT-FLANGED, Guards to Base	4	50AW5	50AW5
COUPLING-FLEXIBLE (ODP/TEFC Motor)	1	51L42	51L42
KEY-SQUARE, Compressor Shaft (3/8 SQ x 2.00 ROE)	1	35L35	35L35
SPIDER-COUPLING, Flexible – Urethane	1	2010219	2010219
IDENTIFICATION & INSTRUCTION GROUP			
DECAL, Drain Moisture	1	205ESO077	205ESO077
DECAL, G-D Vertical	2	69F18	69F18
DECAL, Control Voltage	1	69D38	69D38
DECAL, Grounding	1	208ESG077	208ESG077
DECAL, Copper Wire Only	1	214ESG077	214ESG077
DECAL, Warning – Do Not Breathe Air	1	209SPH077	209SPH077
DECAL, Warning Shock	2	202ESG077	202ESG077
PLATE-DATA, Oil Level	1	200ESG454	200ESG454
DECAL, Filled at Factory with GD-800	1	200EBE077	200EBE077
DECAL, Caution	1	203ESF077	203ESF077
DECAL, Operating & Maintenance	1	200ECM077	200ECM077
DECAL, Oil Reservoir	1	None	200ECH077
DECAL, Electra-Saver®	3	201ECM077	None
DECAL, Red with Black Border	4	203ESO077	None
ASM DRAWING, Decal Locations	0	219ECM810	219ECM810

REPAIR KITS

Name of Part	Model Quantity	Model SSH Units*	Model SSM Units*
Routine Maintenance Kit (3000 Hours) STANDARD FILTER 5L3 -			
SSM Units Without Enclosure – 5L111 - SSH & SSM Units With Enclosure,			
Includes the following items			
ELEMENT, Air Filter	2	ECM77062 2010486	ECM77062 2010486
ELEMENT, Oil Filter	3	2109093	2109093
Routine Maintenance Kit (3000 Hours) STANDARD FILTER 5A460 -			
SSH Units Without Enclosure, Includes the following items			
ELEMENT, Air Filter	2	ECM79874 2008616	----- -----
ELEMENT, Oil Filter	3	2109093	-----
Routine Maintenance Kit (3000 Hours) HEAVY-DUTY FILTER, Includes			
the following items			
ELEMENT, Air Filter	2	ECM77067 2008944	ECM77067 2008944
ELEMENT, Oil Filter	3	2109093	2109093
Periodic Maintenance Kit (9000 Hours), Includes the following items			
DISCHARGE VALVE, Inlet Valve	1	ECH75592 200SSF067	ECM77076 200SSK067
SPRING, Inlet Valve	1	78A360	78W12
SPRING, Inlet Valve Piston	1	78W34	78A302
PACKING-RING, Block Vee	2	60AM47	60AM48
Periodic Overhaul Kit (18000 Hours), Includes the following items			
SEAL-SHAFT, Drive Shaft	1	ECH75593 60DD98	ECM77077 60DD98
BEARING-FOLLER, Inlet End Main Rotor	1	12BA89	12W34
BEARING-ROLLER, Inlet End Secondary Rotor	1	12BA88	12BA93
BEARING-ROLLER, Discharge End Main Rotor	2	12BA91	12BA92
BEARING-ROLLER, Discharge End Secondary Rotor	2	12BA90	12BA94
KIT (Gasket & Shim)	1	ECH76365	SSM77775
Separator Kit (18000 Hours), Includes the following items			
SEPARATOR KIT, First Stage	1	ECM77079 ESM66049	ECM77079 ESM66049
SEPARATOR KIT, Second Stage	1	2010742	2010742
CONNECTOR, Discharge Manifold	2	86N15	86N15
TEE-TUBE, Dip Tube Connections	1	86E155	86E155
TUBE, Dip Tube Second Stage	1	212ECM857	212ECM857
TUBE, Dip Tube First Stage	27"	85E4A	85E4A
TAG-INSTRUCTION, Separator Replacement Parts	1	200ECH304	200ECH304
GASKET (Eliminator), Discharge Manifold to Cover	1	25BC222	25BC222
PAINT (Primer/Cleaner), Manifold & Cover	1	25BC223	25BC223
Pneumatic Control & Gauges Kit (18000 Hours), Includes the following items			
REGULATOR-PRESSURE, Set 15 Lbs.	1	ECH76318 88H26	ECH76318 88H26
GAUGE, Air Pressure	1	2009562	2009562
THERMOMETER, Compressor Discharge Temperature	1	93F1	93F1
VALVE, Shuttle	1	90AR107	90AR107
VALVE-AIR CONTROL, Blowdown Valve	1	90AR324	90AR324
VALVE-SUBTRACTIVE PILOT	1	2009398	2009398
GAUGE, Oil Separator Differential	1	27P11	27P11
Electrical Control Kit (18000 Hours), Includes following items			
SWITCH-PRESSURE, Air	1	EAQ73721 2009006	EAQ73721 2009006
SWITCH-PRESSURE, Oil	1	88A301	88A301
SWITCH-TEMPERATURE	1	21D80	21D80
SWITCH-TEMPERATURE, Probe	2	21D81	21D81
RELAY, Timing (Set 10 Seconds Maximum)	1	24CA285	24CA285
VALVE-SOLENOID, 4-Way - 120 VAC	1	91B34	91B34
SWITCH-PRESSURE, Reservoir Pressure	1	88H99	88H99
Drive Coupling Kit, Includes the following item			
SPIDER-COUPLING	1	ECK77777 2010219	ECK77777 2010219

* For applicable kit refer to page 139-B39-1a or 139-B39-1b for proper bare compressor.



INDUSTRIAL MACHINERY

1800 GARDNER EXPRESSWAY • QUINCY, ILLINOIS 62305-4024 • (217) 222-5400