

---

---

**GARDNER DENVER®**

13-9-523

**ELECTRA-SCREW®  
STATIONARY  
COMPRESSOR**

**MODELS**

**ECKQ & ECKS**

**(ESKA, ESKB & ESKC)**

**(ESLA, ESLB & ESLC)**

**(ESMA, ESMB & ESMC)**

**60 HP, 75HP & 100 HP**

**PARTS LIST**

**Gardner**  

---

**Denver**

## TABLE OF CONTENTS

GROUP NAME	PAGE NO.
Ordering Instructions	P/L 139-500b
Thirteen Digit Model Designation	ECK Mini Matrix
Bare Compressor (w/Gears)	139-B4-1
Repair Kits, Bare Compressor	139-B4-1a
Air Filter (Standard) & Inlet Valve	139-A4-2
Air Filter, Heavy-Duty (Optional)	139-A4-2a
Oil Reservoir Group (Dual Separators)	139-B4-3
Oil Level Gauge (Repair Kit)	
Switch, Hi Temperature Shutdown	
Oil Reservoir Group (Selective Items)	139-B4-3a
Valve, Safety	
Valve, Solenoid (Automatic Blowdown)	
Oil Separator Repair Kits	
Oil Return Line	
Air Discharge Piping ( <i>Without Aftercooler</i> )	139-B4-3b
Air Discharge Piping ( <i>Air-Cooled Units With Aftercooler</i> )	139A-A4-3b (F)
Air Discharge Piping ( <i>Water-Cooled Units With Aftercooler</i> )	139A-A4-3b (W)
Check Valve	
Manual Blowdown Valve	
Moisture Separator ( <i>With Aftercooler Units Only</i> )	
Oil Piping Group ( <i>Air-Cooled Units</i> )	139-A4-5 (F)
Oil & Water Piping Group ( <i>Without Aftercooler</i> )	139-A4-5 (W)
Oil & Water Piping Group ( <i>With Aftercooler</i> )	139A-A4-5 (W)
Selective Items ( <i>Fresh Water Service</i> )	139-A4-5a (W)
Selective Items ( <i>Salt Water Service</i> )	139-A4-5b (W)
Heat Exchanger	
Temperature Regulator	
Solenoid Valve, Water	
Aftercooler	
Oil Filter, Minimum Pressure & Thermal Valves	139-B1-6
Radiator Group ( <i>Without Aftercooler</i> )	139-A4-7 (F)
Selective Items	139-A4-7a (F)
Radiator Group ( <i>With Aftercooler</i> )	139A-A4-7 (F)
Selective Items	139A-A4-7a (F)
Coupling & Base	139-A4-9
Control Groups (Optional and/or Selective)	139-C1-10
Constant Speed Control:	Panel
(w/Pilot Valve)	Tubing
	139-A4-12
	139-A4-12a
Automatic Start-Stop Control:	Panel
(w/Pressure Switch)	Tubing
	139-A4-13
	139-A4-13a
Dual Control:	Panel
(w/Pilot and Switch)	Tubing
	139-A4-14
	139-A4-14a
Duomatic Control:	Panel
(w/Unloader Valve)	Tubing
	139-A4-15
	139-A4-15a
Recommended Spares	139-B4-16

ELECTRA-SCREW® STATIONARY COMPRESSOR

ECK Mini Matrix

60HP - 75HP - 100HP

Nov., 1980

THIRTEEN DIGIT MODEL DESIGNATION

NOTICE TO CUSTOMER - To find the construction options for your compressor unit, FILL IN THE BALANCE OF THE LETTERS FROM YOUR COMPRESSOR NAME PLATE .....

E C K

COLUMN NUMBER:

1 2 3 4 5 6 7 8 9 10 11 12 13

FOLLOW THE LINE DOWN AND OVER FROM EACH LETTER THUS FILLED IN TO FIND THE APPROPRIATE CONSTRUCTION OPTION WITH WHICH YOUR MACHINE IS EQUIPPED. THE NUMBER "9" IN ANY COLUMN SPACE INDICATES "NOT APPLICABLE". THE NUMBER "8" IN ANY COLUMN SPACE INDICATES SPECIAL DESIGN - REFER TO FACTORY ORDER TICKET.

COLUMNS	1, 2 & 3	COMPRESSOR TYPE & SIZE
COLUMN	4	TYPE OF CONSTRUCTION Q - Air Cooled Base Mounted S - Water Cooled Base Mounted
COLUMN	5	HORSEPOWER K - 60 L - 75 M - 100
COLUMN	6	ENGINEERING SPEC.
COLUMN	7	OPERATING PRESSURE D - 100 PSIG - 60 Hz      N - 100 PSIG - 50 Hz F - 125 PSIG - 60 Hz      P - 125 PSIG - 50 Hz H - 150 PSIG - 60 Hz      R - 150 PSIG - 50 Hz
COLUMN	8	CONTROL - See Pages 139-C1-10 thru 139-A4-15a A thru D - Constant Speed, NEMA I or NEMA IV, 50 or 60 Hz E thru H - Dual Control, NEMA I or NEMA IV, 50 or 60 Hz I thru L - Duomatic, NEMA I or NEMA IV, 50 or 60 Hz
COLUMN	9	CONTROL, MAIN MOTOR STARTER & OPTIONS - Letter varies with options (Air & Water Cooled W/O Enclosure) A thru L - NEMA I, 200V thru 415V, 50 or 60 Hz M thru X - NEMA IV, 200V thru 415V, 50 or 60 Hz
COLUMN	10	ENCLOSURE For information and/or repair, consult Sales Office. NOTE - STANDARD AIR FILTER FURNISHED
COLUMN	11	COOLERS - Letters vary with Material, Manufacturer & Aftercooler (if used) See Pages 139-B4-3b thru 139-A4-5b(W) A thru D - Air Cooled, W/O Aftercooler, No Remote Elevated Kit E thru H - Air Cooled, W/O Aftercooler, With Remote Elevated Kit I thru L - Fresh Water Cooled, W/O Aftercooler, No Water Regulator M thru T - Fresh Water Cooled, W/O Aftercooler, With Water Regulator U thru V - Salt Water Cooled, W/O Aftercooler, No Water Regulator W thru X - Salt Water Cooled, W/O Aftercooler, With Water Regulator
COLUMN	12	COOLER ELECTRICAL - Letter varies with Voltage and Hz A thru I - Air Cooled, NEMA I Starter Enclosure, 50 or 60 Hz J thru S - Air Cooled, NEMA IV Starter Enclosure, 50 to 60 Hz T thru X - Fresh or Salt Water Cooled, NEMA I or NEMA IV, Magnetic Water Shutoff Valve
COLUMN	13	COMPRESSOR DRIVE MOTOR MOTOR IS NOT LISTED IN THIS BOOK - When ordering replacement motor for your unit, it is MOST IMPORTANT that the COMPLETE THIRTEEN DIGIT MODEL NUMBER is given in order to obtain correct drive motor.

ASM SSKB/1 THRU SSKB/6 †

COMPRESSOR (60, 75 & 100 HP)

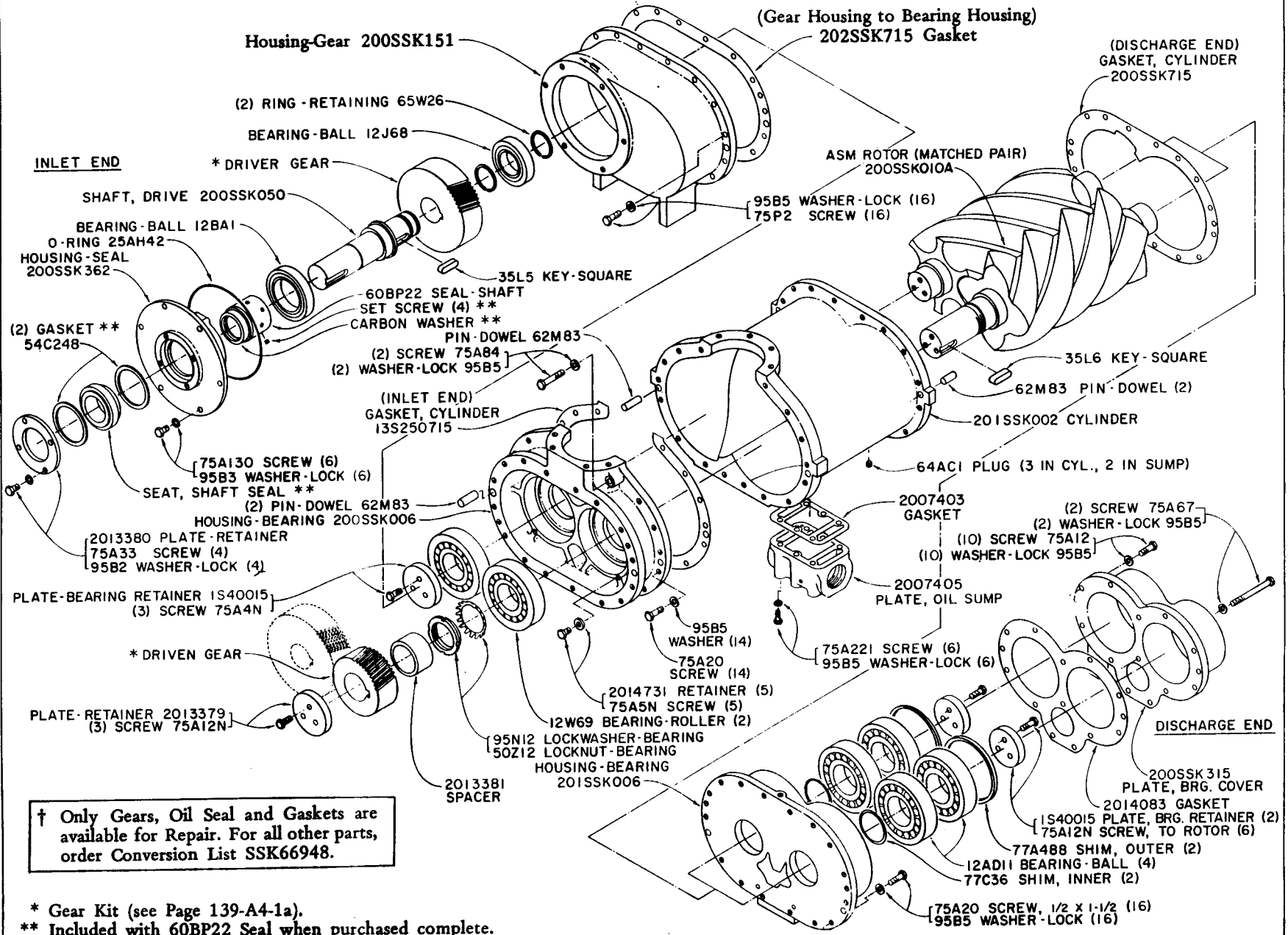

† Only Gears, Oil Seal and Gaskets are available for Repair. For all other parts, order Conversion List SSK66948.

\* Gear Kit (see Page 139-A4-1a).  
 \*\* Included with 60BP22 Seal when purchased complete.

139-A4-1

GARDNER-DENVER COMPRESSOR  
 † Closed Out August, 1975  
 Revised April, 1976  
 139-A4-1

BARE COMPRESSOR REPAIR KITS

(60, 75 & 100 HP)

PSI	HP	MODEL	φ	BARE COMPRESSOR	GASKET KIT *
			GEAR KIT	FIELD REPLACEMENT (INCLUDES GEARS)	
			PART NO.	PART NO.	PART NO.
100	60	ESKAE, ESKAF, ESKAG, ESKAH	SSK65890 SSK65890	ESK65945 ESK65945	SSK65887 SSK65887
	75	ESLAE, ESLAF, ESLAG, ESLAH ESLAJ	SSK65891 SSK65891 SSK65891	ESL65946 ESL65946 ESL65945	SSK65887 SSK65887 SSK65887
	100	ESMAE, ESMAF, ESMAH, ESMAJ	SSK65892 SSK65892	ESM65947 ESM65947	SSK65887 SSK65887
125	60	ESKBE, ESKBF, ESKBG, ESKBH	SSK65893 SSK65893	ESK65949 ESK65949	SSK65887 SSK65887
	75	ESLBE, ESLBF, ESLBG, ESLBH	SSK65894 SSK65894 SSK65890	ESL65950 ESL65950 ESK65945	SSK65887 SSK65887 SSK65887
	100	ESMBE, ESMBF, ESMBH	SSK65895 SSK65895	ESM65951 ESM65951	SSK65887 SSK65887
150	60	-----	-----	-----	-----
	75	ESLCE, ESLCF	SSK65893	ESK65949	SSK65887
	100	ESMCE, ESMCF	SSK65891	ESL65946	SSK65887

φ Gear Kit includes Gears, Keys, Gear Housing Gasket and O-Rings.

\* Gasket Kits are for Complete Unit, Less Motor.

139-A4-1a

GARDNER-DENVER COMPRESSOR

139-A4-1a  
Revised August, 1975

ASM SSKB/7 THRU SSKB/12†

COMPRESSOR (60, 75 & 100 HP)

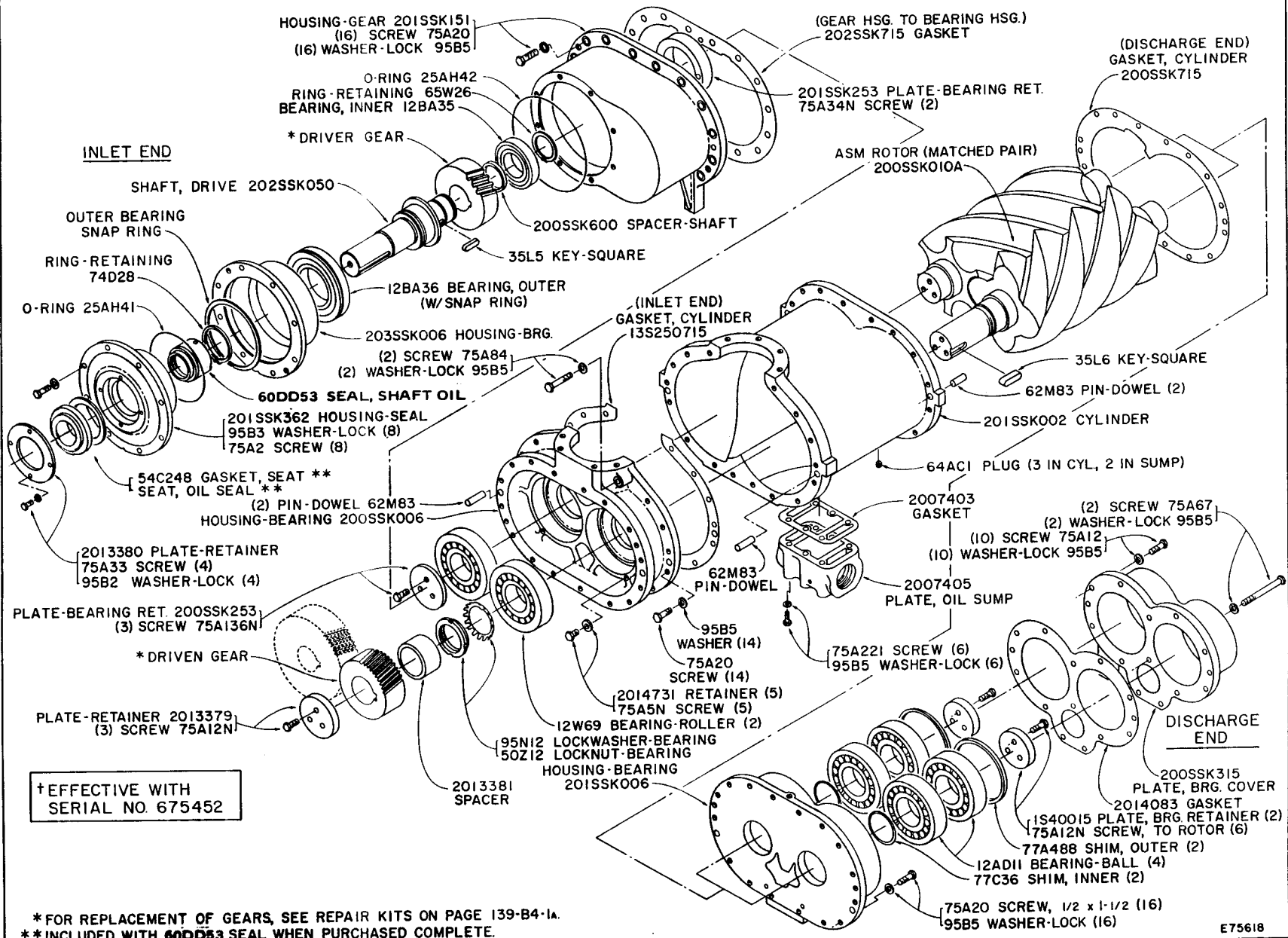

† EFFECTIVE WITH  
SERIAL NO. 675452

\* FOR REPLACEMENT OF GEARS, SEE REPAIR KITS ON PAGE 139-B4-1a.  
\*\* INCLUDED WITH 60DD53 SEAL WHEN PURCHASED COMPLETE.

E75618

139-B4-1

BARE COMPRESSOR REPAIR KITS

(60, 75 & 100 HP)

PSI	HP	MODEL	φ	BARE COMPRESSOR FIELD REPLACEMENT (INCLUDES GEARS)	GASKET KIT *
			GEAR KIT		
			PART NO.	PART NO.	PART NO.
100	60	ESKAE, ESKAF, ESKAG, ESKAH ESKAJ	SSK65890 SSK65890 SSK65890	ESK65945 ESK65945 ESK65945	SSK65887 SSK65887 SSK65887
	75	ESLAE, ESLAF, ESLAG, ESLAH ESLAJ	SSK65891 SSK65891 SSK65891	ESL65946 ESL65946 ESL65946	SSK65887 SSK65887 SSK65887
	100	ESMAE, ESMAF, ESMAH, ESMAJ	SSK65892 SSK65892	ESM65947 ESM65947	SSK65887 SSK65887
125	60	ESKBE, ESKBF, ESKBG, ESKBH	SSK65893 SSK65893	ESK65949 ESK65949	SSK65887 SSK65887
	75	ESLBE, ESLBF, ESLBG, ESLBH	SSK65894 SSK65894 SSK65890	ESL65950 ESL65950 ESK65945	SSK65887 SSK65887 SSK65887
	100	ESMBE, ESMBF, ESMBH	SSK65895 SSK65895	ESM65951 ESM65951	SSK65887 SSK65887
150	60	-----	-----	-----	-----
	75	ESLCE, ESLCF	SSK65893	ESK65949	SSK65887
	100	ESMCE, ESMCF	SSK65891	ESL65946	SSK65887

φ Gear Kit includes Gears, Keys, Gear Housing Gasket and O-Rings.

\* Gasket Kits are for Complete Unit, Less Motor.

139-B4-1a

GARDNER-DENVER COMPRESSOR

139-B4-1a  
Revised May, 1976



**OIL RESERVOIR GROUP**  
(Selective Items)

PART NAME & DESCRIPTION	60 HP	75 & 100 HP
Reservoir (Standard)	200ESK037	200ESK037
Reservoir (ABS & USCG)	201ESK037	201ESK037
Manifold, Compressor (Standard)	200ESK071	200ESK071
Manifold, Compressor (ABS & USCG)	201ESK071	200ESK071
Valve, Safety (Set 115 Lbs.)	90G448	90G448
Valve, Safety (Set 135 Lbs.)	90G298	90G298
Valve, Safety (Set 165 Lbs.)	90G11	90G11
Coil (Nema 1)	24A421	24A421
Valve-Solenoid, Automatic Blowdown (NEMA 1)	90AC162	90AC162
Valve-Solenoid, Automatic Blowdown (NEMA 4)	90AC163	90AC163
Valve-Solenoid, Automatic Blowdown (Explosion-Proof)	90AC165	90AC165
Coil (Nema 4)	24A421	24A421
Switch, Hi Temperature Shutdown (NEMA 1 & 4) (2 Req'd.)	21D23	21D23
Switch, Hi Temperature Shutdown (Explosion-Proof)	2009549	2009549
Well-Thermal (Explosion-Proof)	200EST239	200EST239
<b>OIL SEPARATOR GROUP</b>		
Repair Kit (w/Separator 2009599) (1st Stage)	2014828	-----
Repair Kit (w/Separator 55B4) (1st Stage)	-----	ESM66049
Repair Kit (w/Separator 55B8) (2nd Stage)	2010741	-----
Repair Kit (w/Separator 55B9) (2nd Stage)	-----	2010742
φ Tube-Formed (Thru Manifold & 2nd Stage Separator)	201ESG857	200ESL857
NOTE: Repair Kits include Separator, Top Manifold Gaskets and Tube Fittings as shown in illustration below.		
(Oil Return Line - To Compressor)		
Tube, From Tee on Manifold (1/4" OD)	85G3X150	85G3X150
Connector-Tube (1/4 T)	86E48	86E48
Tube, To Compressor (1/4" OD)	85G3X310	85G3X310
Elbow-Tube (1/4 T x 1/8 P x 90°)	86E59	86E59

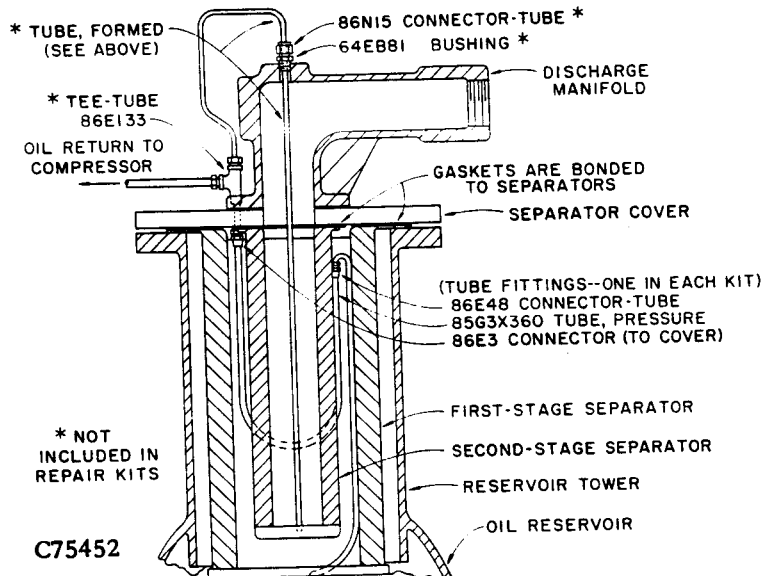

φ When ordering Formed Tube for Repair, also order related Tube Fittings as shown in illustration.

### AIR DISCHARGE PIPING

(WITHOUT AFTERCOOLER)

AIR & WATER-COOLED UNITS

C75775

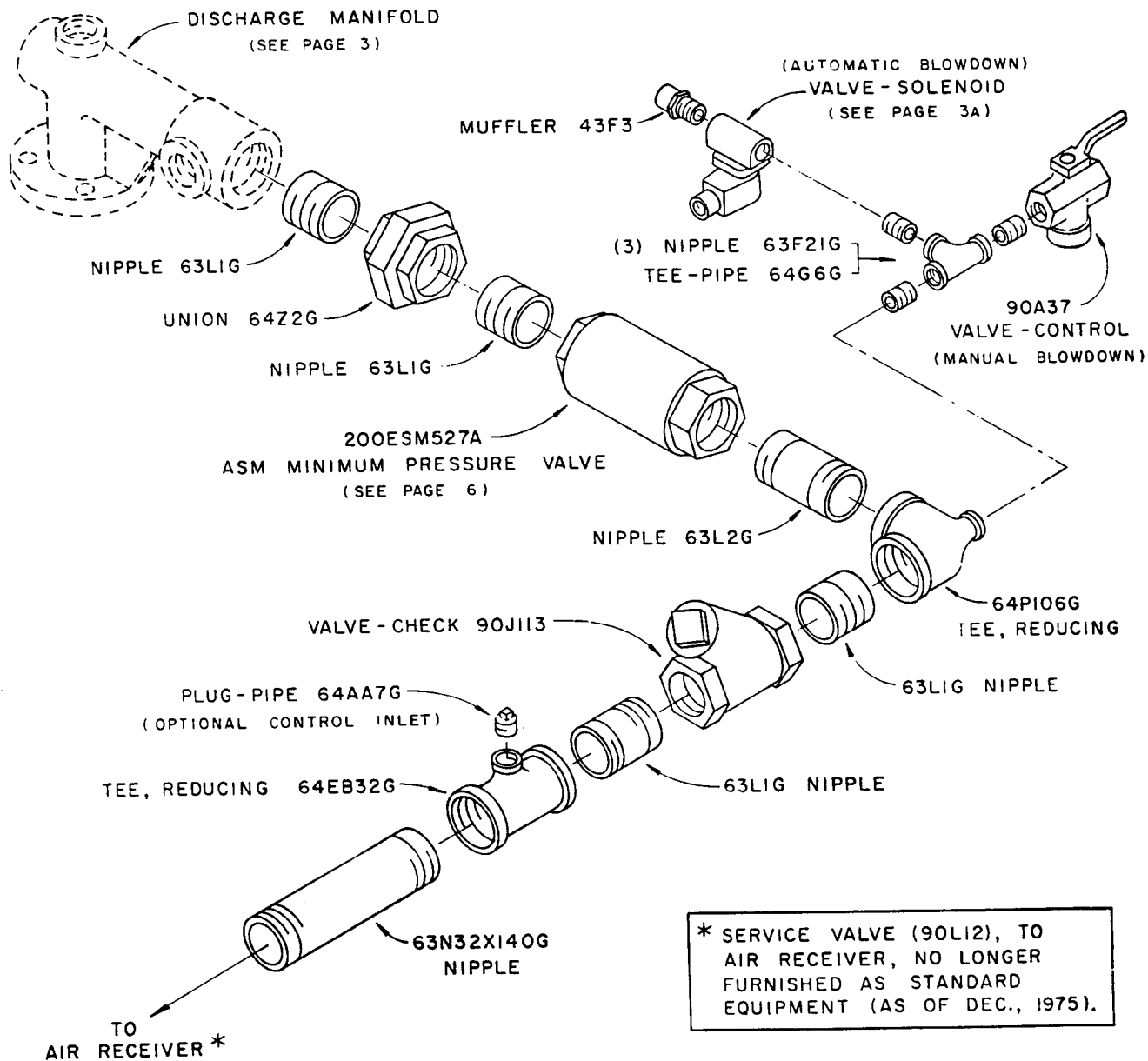

### AIR DISCHARGE PIPING (AIR-COOLED UNITS WITH AFTERCOOLER)

139A-A4-38 (F)

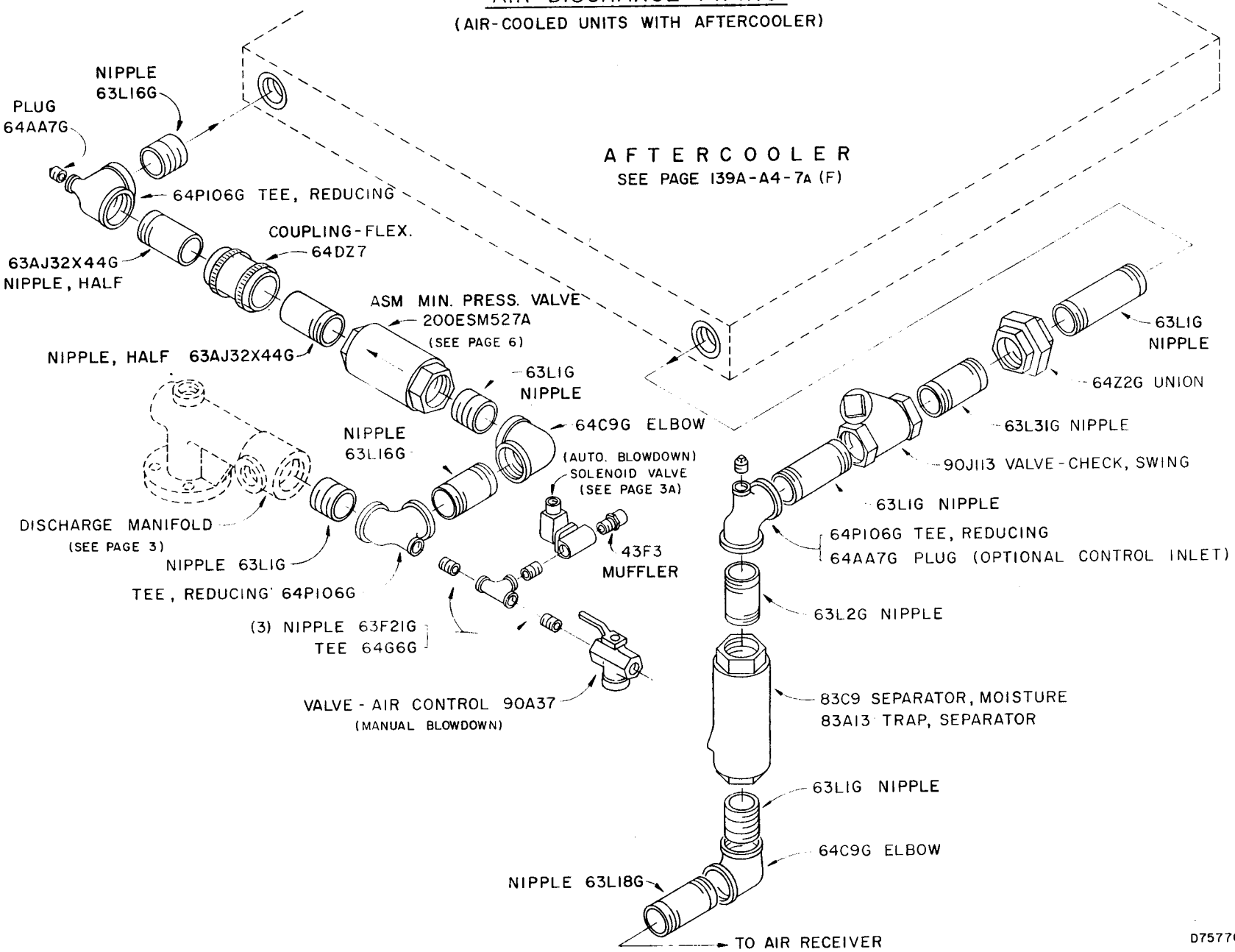

D75776

MAY, 1976

139A-A4-38 (F)

**AIR DISCHARGE PIPING**  
(WATER-COOLED UNITS WITH AFTERCOOLER)

D75777

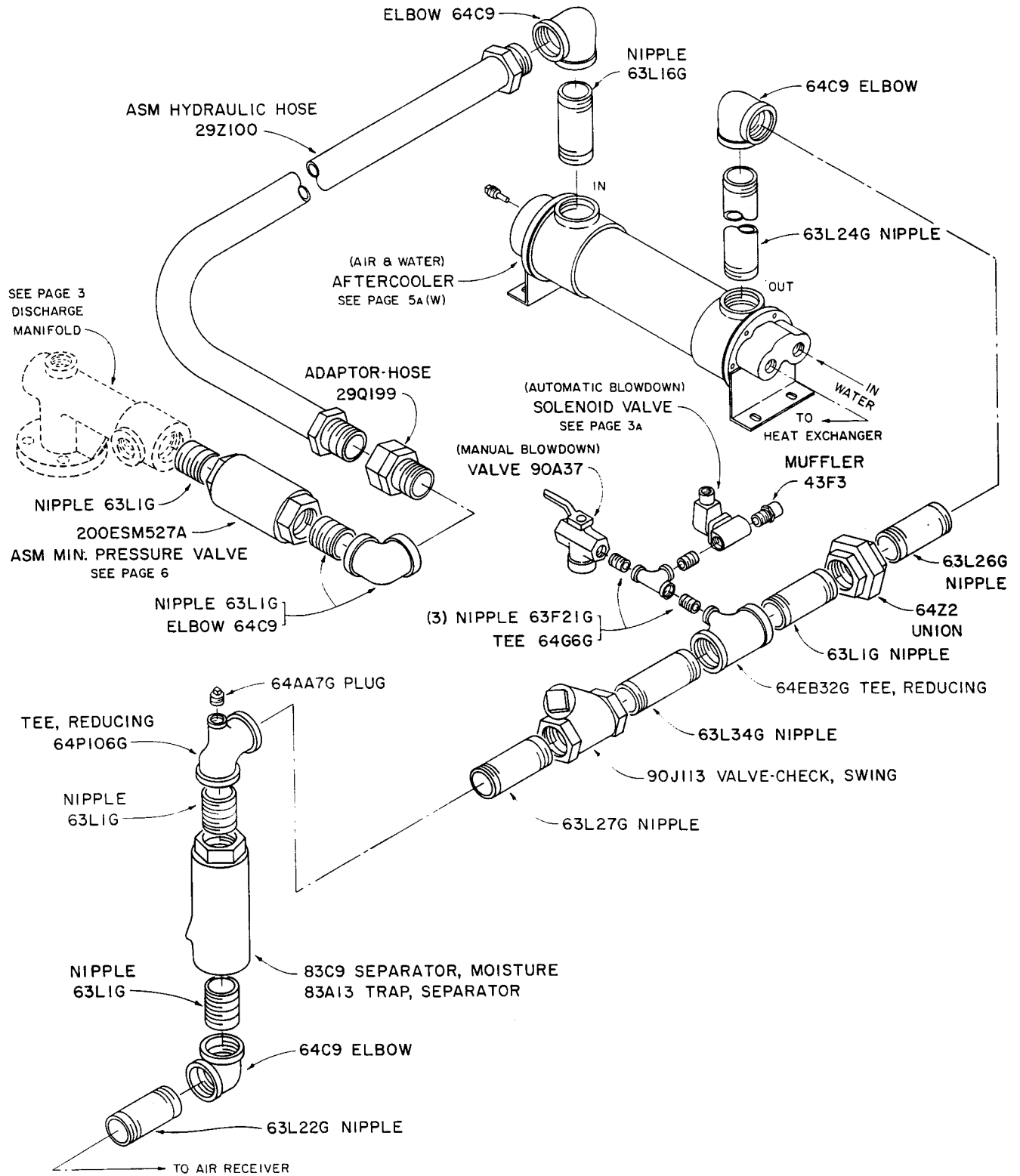

**OIL & WATER PIPING GROUP (Water-Cooled Units)  
(WITHOUT AFTERCOOLER)**

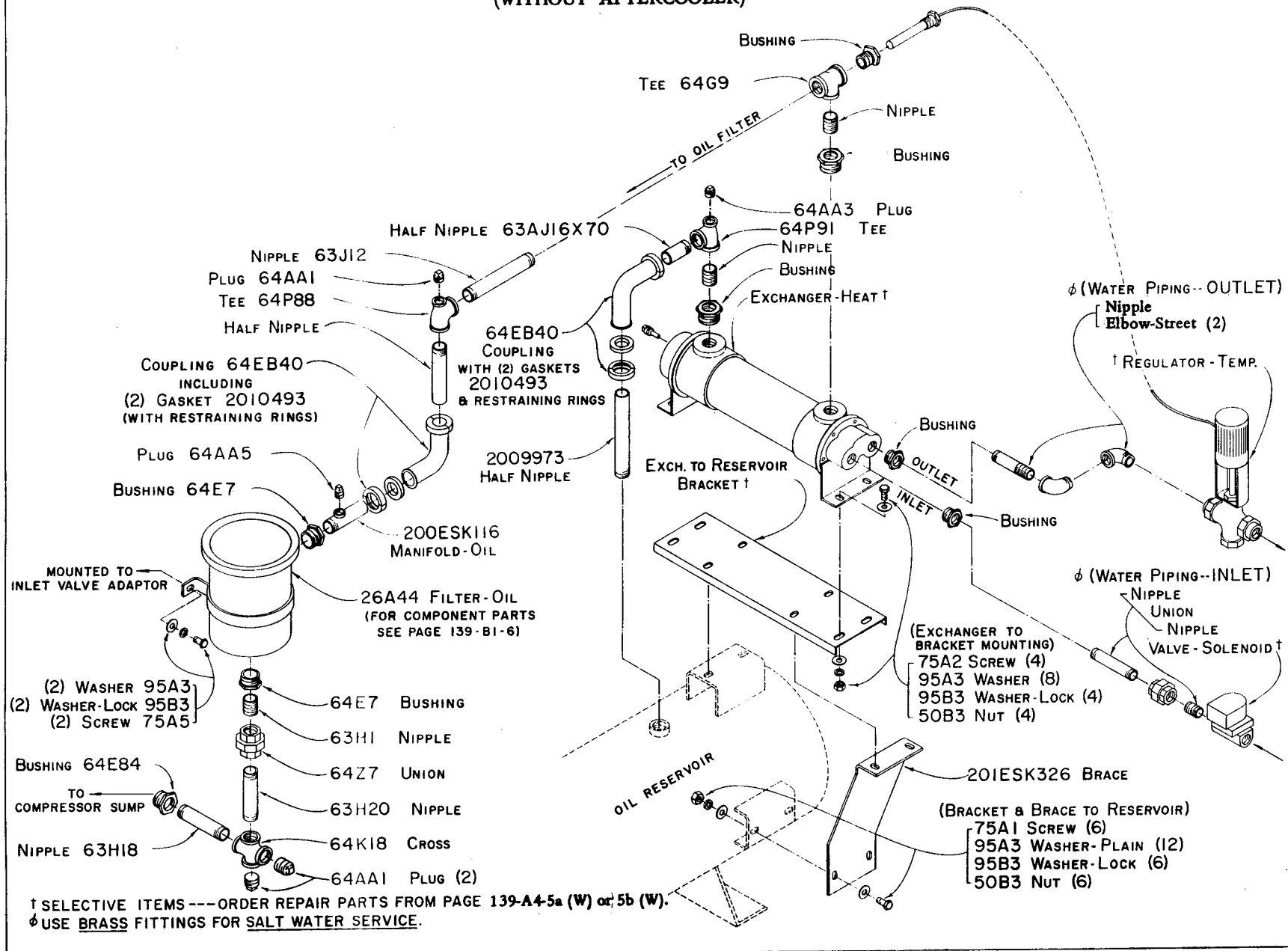

139-A4-5 (W)

**SELECTIVE ITEMS - WATER-COOLED UNITS**  
**(FRESH WATER SERVICE)**

PART NAME & DESCRIPTION	60 HORSEPOWER		75 HORSEPOWER		100 HORSEPOWER	
	(YOUNG)	(THERMAL TRANSFER)	(YOUNG)	(THERMAL TRANSFER)	(YOUNG)	(THERMAL TRANSFER)
Heat Exchanger, Incl. Next 6 Parts:	48C45	202ESJ349	2014188	203ESL349	200ESM349	204ESM349
Bracket, Mounting (2)	2010214	2109062	2010207	2109067	2010214	2109062
Gasket, Inlet-Outlet	2010211	2109058	2010252	2109063	2010211	2109058
Bonnet, Inlet-Outlet	2010210 *	2109060	2010280 *	2109065	2010210 *	2109060
Gasket, Return	2010213	2109059	2010204	2109064	2010213	2109059
Bonnet, Return	2010212 *	2109061	2010281 *	2109066	2010212 *	2109061
Anode-Zinc (2)	2010283	2109057	2010284	2109068	2010283	2109057
Regulator-Temperature (TRERICE), Incl. Next Part: ASM Stem Packing	90AC192 2010803	90AC192 2010803	90AC192 2010803	90AC192 2010803	90AC192 2010803	90AC192 2010803
<b>OR</b>						
Regulator-Temperature (POWERS), Incl. Next Part: ASM Stem Packing	90AR98 2109051	90AR98 2109051	90AR98 2109051	90AR98 2109051	90AR98 2109051	90AR98 2109051
Bracket, Exchanger to Reservoir	200ESK142	200ESK142	200ESK142	200ESK142	200ESM142	200ESM142
Valve-Solenoid, Magnetic Water (NEMA 1)	90AC118	90AC118	90AC118	90AC118	90AC118	90AC118
Valve-Solenoid, Magnetic Water (NEMA 4)	90AC103	90AC103	90AC103	90AC103	90AC103	90AC103
Valve-Solenoid, Magnetic Water (Explosion-Proof)	90AC103	90AC103	90AC103	90AC103	90AC103	90AC103
Aftercooler, Incl. Next 6 Parts:	-----	200ESL292	-----	200ESL292	-----	201ESM292
Bracket, Mounting (2)	-----	2109062	-----	2109062	-----	2109062
Gasket, Inlet-Outlet	-----	2109058	-----	2109058	-----	2109058
Bonnet, Inlet-Outlet	-----	2109060	-----	2109060	-----	2109060
Gasket, Return	-----	2109059	-----	2109059	-----	2109059
Bonnet, Return	-----	2109061	-----	2109061	-----	2109061
Anode-Zinc (2)	-----	2109057	-----	2109057	-----	2109057
Support, Aftercooler	212ESK165	212ESK165	212ESK165	212ESK165	212ESK165	212ESK165

139-A4-5a (W)

\* When purchasing Bonnet for "YOUNG" Heat Exchangers, gasket and pipe plugs are included.

**SELECTIVE ITEMS -- WATER-COOLED UNITS  
(SALT WATER SERVICE)**

PART NAME & DESCRIPTION	60 HORSEPOWER		75 HORSEPOWER		100 HORSEPOWER	
	(YOUNG)	(THERMAL TRANSFER)	(YOUNG)	(THERMAL TRANSFER)	(YOUNG)	(THERMAL TRANSFER)
Heat Exchanger, Incl. Next 6 Parts	-----	203ESJ349	200ESL349	202ESL349	201ESM349	203ESM349
Bracket, Mounting (2)	-----	2109062	2010207	2109067	2010214	2109062
Gasket, Inlet-Outlet	-----	2109058	2010252	2109063	2010211	2109058
Bonnet, Inlet-Outlet	-----	2109075	2010830 *	2109077	2010832 *	2109075
Gasket, Return	-----	2109059	2010204	2109064	2010213	2109059
Bonnet, Return	-----	2109074	2010831 *	2109076	2010833 *	2109074
Anode-Zinc (2)	-----	2109057	2010284	2109068	2010283	2109057
<b>(USE BRASS FITTINGS)</b>						
Regulator-Temperature (TRERICE), Incl. Next Part:	-----	90AR36	90AR36	90AR36	90AR36	90AR36
ASM Stem Packing	-----	2010803	2010803	2010803	2010803	2010803
<b>OR</b>						
Regulator-Temperature (POWERS), Incl. Next Part:	-----	90AR98	90AR98	90AR98	90AR98	90AR98
ASM Stem Packing	-----	2109051	2109051	2109051	2109051	2109051
Bracket, Exchanger to Reservoir	-----	200ESK142	200ESK142	200ESK142	200ESM142	200ESM142
Aftercooler, Incl. Next 6 Parts:	-----	201ESL292	-----	201ESL292	-----	202ESM292
Bracket, Mounting (2)	-----	2109062	-----	2109062	-----	2109062
Gasket, Inlet-Outlet	-----	2109058	-----	2109058	-----	2109058
Bonnet, Inlet-Outlet	-----	2109075	-----	2109075	-----	2109075
Gasket, Return	-----	2109059	-----	2109059	-----	2109059
Bonnet, Return	-----	2109074	-----	2109074	-----	2109074
Anode-Zinc (2)	-----	2109057	-----	2109057	-----	2109057
Support, Aftercooler	-----	212ESK165	-----	212ESK165	-----	212ESK165

\* When purchasing Bonnet for "YOUNG" Heat Exchangers, gasket and pipe plugs are included.

139-A4-5b (W)

GARDNER-DENVER COMPRESSOR

139-A4-5b (W)  
Revised June, 1979

**RADIATOR GROUP (AIR-COOLED UNITS)  
(WITHOUT AFTERCOOLER)**

139-A4-7 (F)

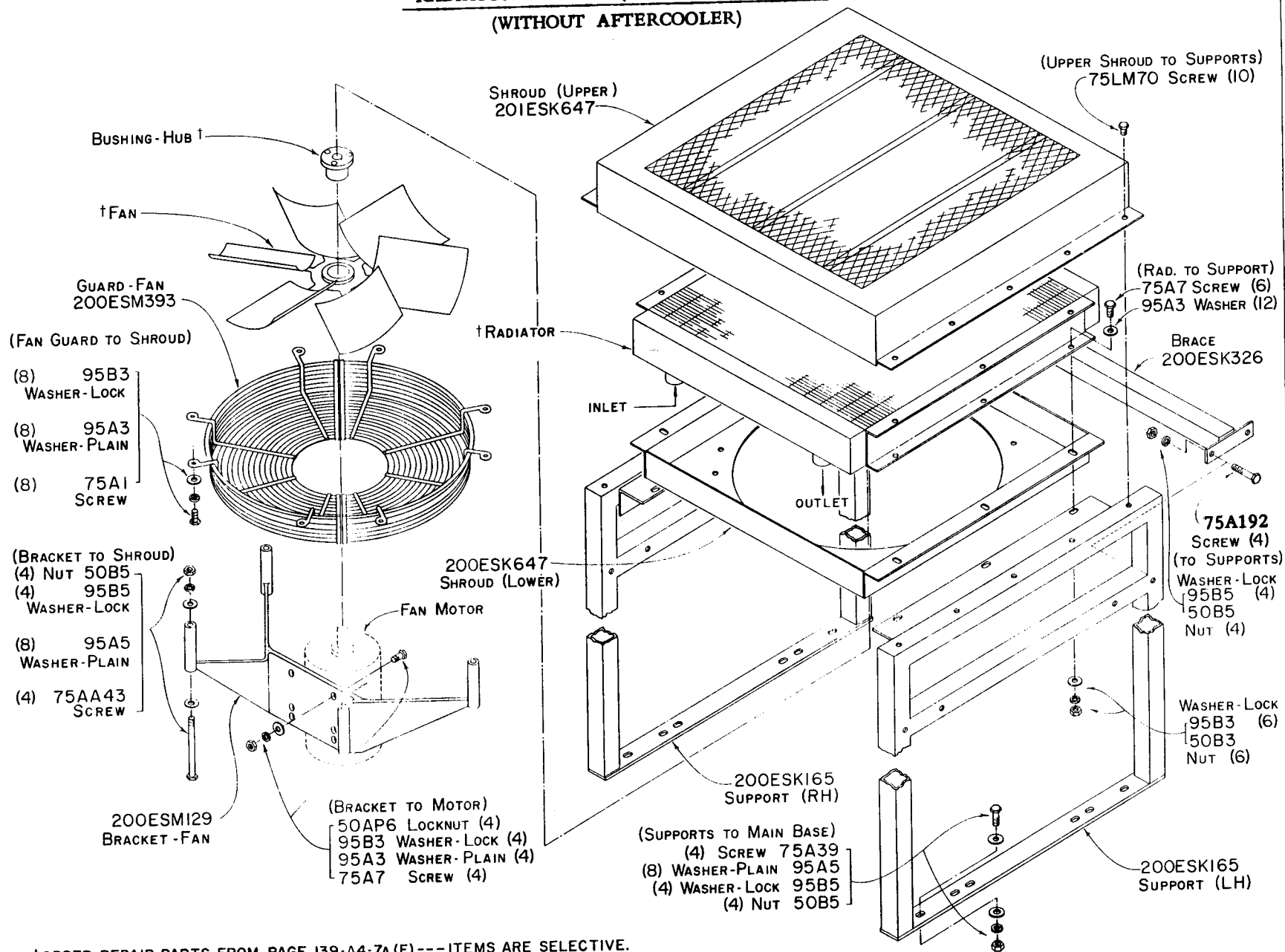

RADIATOR GROUP

(Selective Items)

PART NAME & DESCRIPTION	60 & 75 HP	100 HP
<b>(60 Hz)</b>		
Radiator	200ESL300	200ESM300
Fan, Radiator (Without Aftercooler)	201ESK701	201ESK701
Bushing-Hub	22G2	22G2
Fan, Radiator (With Aftercooler)	203ESK701	203ESK701
Aftercooler	200ESK292	200ESM292
Baffle (2)	200ESK840	200ESK840
<b>(50 Hz)</b>		
Radiator	200ESL300	200ESM300
Fan, Radiator	201ESK701	202ESM701
Bushing-Hub	22G2	22G1
<b>* REMOTE MOUNTED RADIATOR</b>		
(For Information and/or Repair consult Quincy Sales and Service Office.)		

\* Optional Construction.

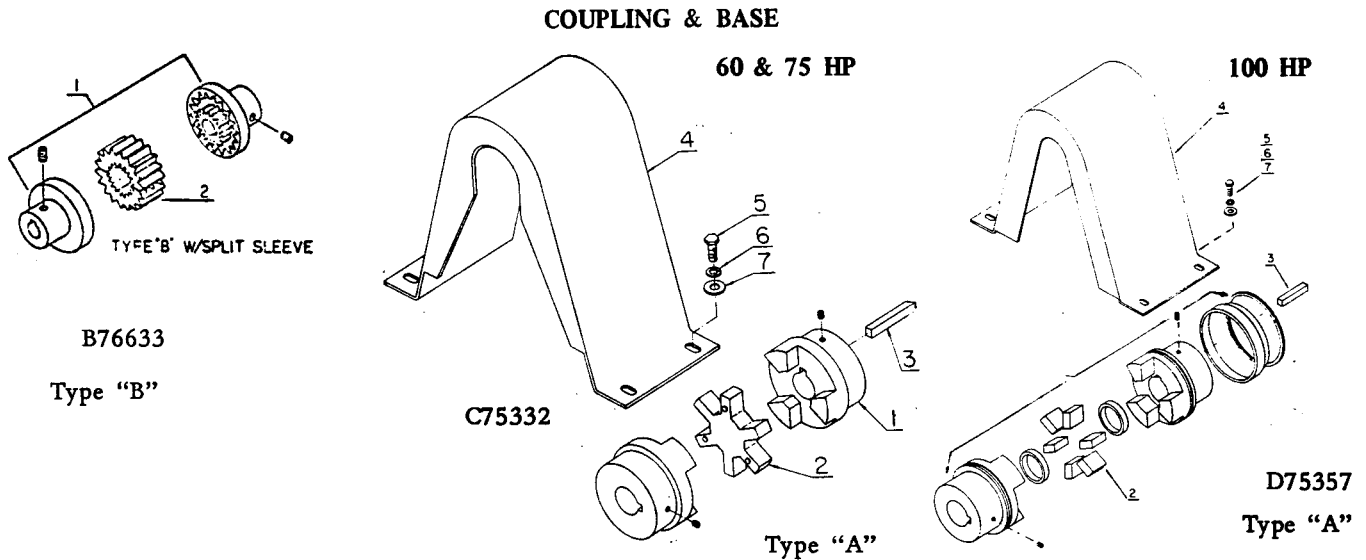

ORDER BY PART NUMBER AND DESCRIPTION. REFERENCE NUMBERS FOR YOUR CONVENIENCE ONLY.

Ref. No.	Part Name & Description	Qty.	60 & 75 HP	100 HP
<b>COUPLING GROUP</b>				
1	COUPLING, Incl. Ref. No. 2	1	51K13	51L10
2	SPIDER or CUSHION (Type "A")	See ( )	2010219 (1)	2109116 (6)
2	SPLIT SLEEVE (Type "B")	1	2109605	2109606
3	KEY, To Compressor	1	35C19	35L25
4	ASM COUPLING GUARD (Includes Fasteners)	1	205ESK339A	201ESM339A
5	SCREW, Guard to Subbase	4	75A1	75A1
6	WASHER-LOCK	4	95B3	95B3
7	WASHER-PLAIN	4	95A3	95A3
<b>BASE &amp; MOUNTING GROUP</b>				
∅	BASE, Main	1	200ESK285	200ESK285
∅	BASE (Subbase)	1	202ESK285	201ESM285
∅	SCREW, Motor to Subbase	4	75A47	75A215
∅	WASHER-LOCK	4	95B7	95B8
∅	WASHER-PLAIN	4	95A7	95A8
∅	NUT-HEX	4	50B7	50B8
∅	MOUNTING-VIBRATION	4	49C6	49C6
∅	SCREW, Mounting to Base (1 x 6)	4	75AA135	75AA135
∅	WASHER-PLAIN (1")	12	95A10	95A10
∅	WASHER-LOCK (1")	4	95B10	95B10
∅	NUT-HEX (1")	4	50B10	50B10
∅	SCREW, Compressor to Subbase (1/2 x 1-1/4)	4	75A12	75A12
∅	WASHER-LOCK (1/2)	4	95B5	95B5
∅	SHIM, Motor to Subbase (.003)	2	77E16	77E16
∅	SHIM, Motor to Subbase (.008)	3	77E17	77E17
∅	SHIM, Motor to Subbase (.031)	1	77E18	77E18
∅	SHIM, Motor to Subbase (.062)	1	77E19	77E19
∅	SUPPORT, Instrument Panel (NEMA 1)	1	200ESK146	200ESK146
∅	SUPPORT, Instrument Panel (NEMA 4)	1	202ESK146	202ESK146
∅	SCREW, Support to Main Base (3/8 x 1-1/4)	4	75A2	75A2
∅	WASHER-PLAIN (3/8)	8	95A3	95A3
∅	WASHER-LOCK (3/8)	4	95B3	95B3
∅	NUT-HEX (3/8)	4	50B3	50B3
∅	SCREW, Instrument Panel to Support (10-32 x 1/2)	10	75LM39	75LM39
ENCLOSURE GROUP (For Information Or Repair Consult Quincy Sales and Service Office)			-----	-----

∅ Not shown on illustration.

CONTROL PANEL GROUP (CONSTANT SPEED) \*

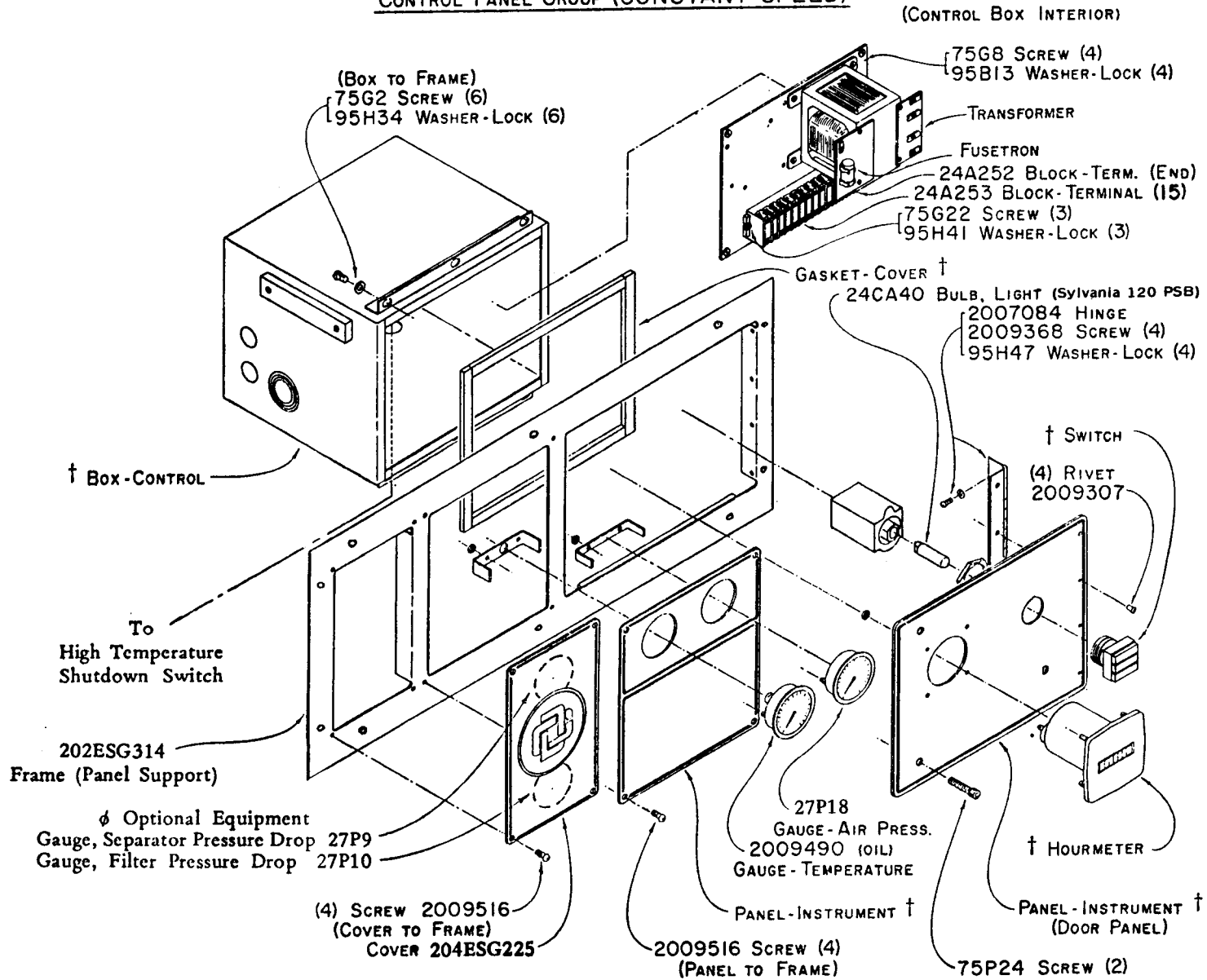

\* For Constant Speed Control Tubing see Page 139-A4-12a.  
† Order Repair Parts from Page 139-C1-10 - Items are Selective.  
φ Furnished only when unit is equipped with Pressure Drop Panel Group.

139-A4-12

CONTROL PANEL GROUP (AUTOMATIC START-STOP) \*

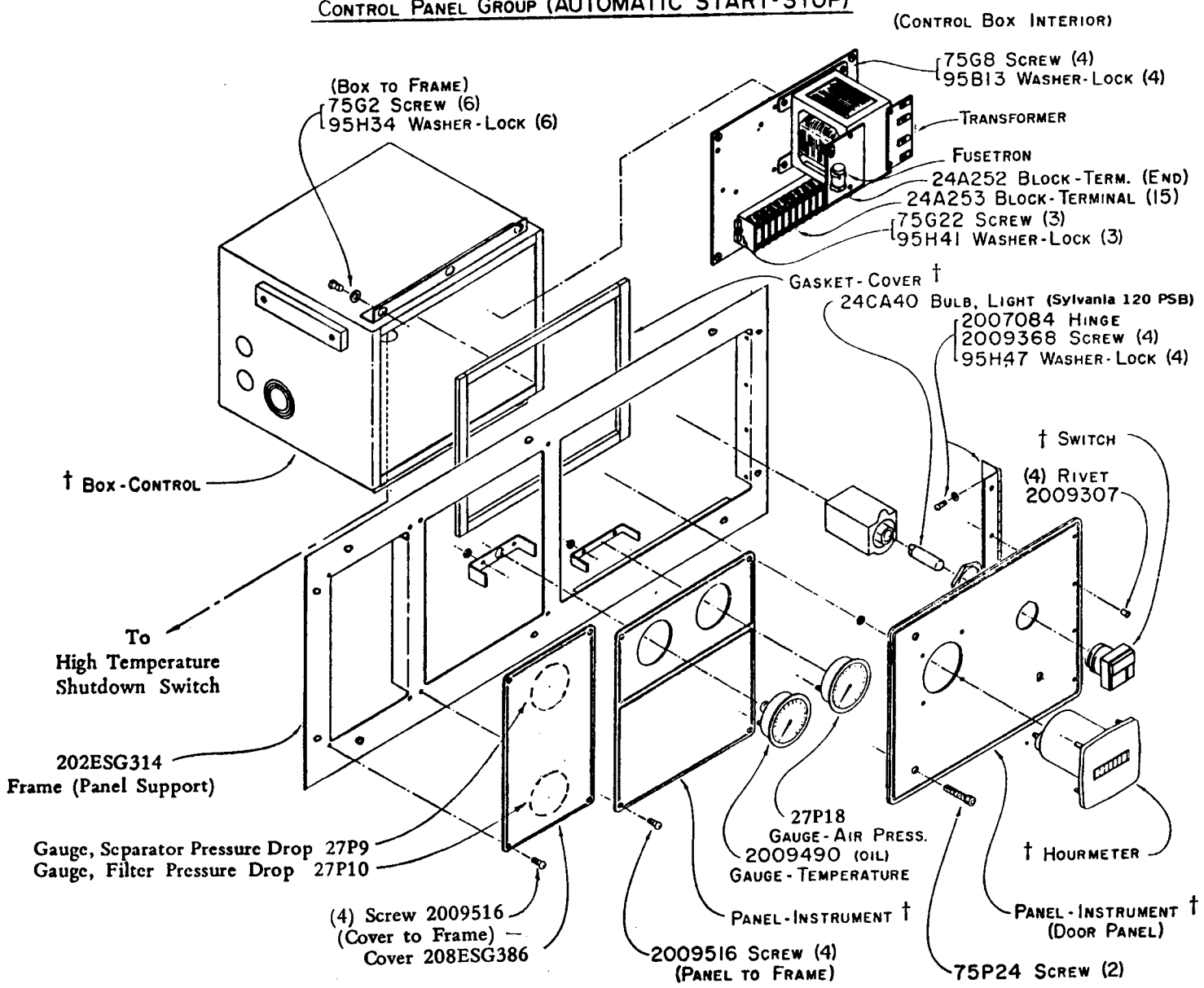

139-A4-13

\* For Automatic Start-Stop Control Tubing see Page 139-A4-13a.  
† Order Repair Parts from Page 139-C1-10 — Items are Selective.

CONTROL TUBING (AUTOMATIC START-STOP)

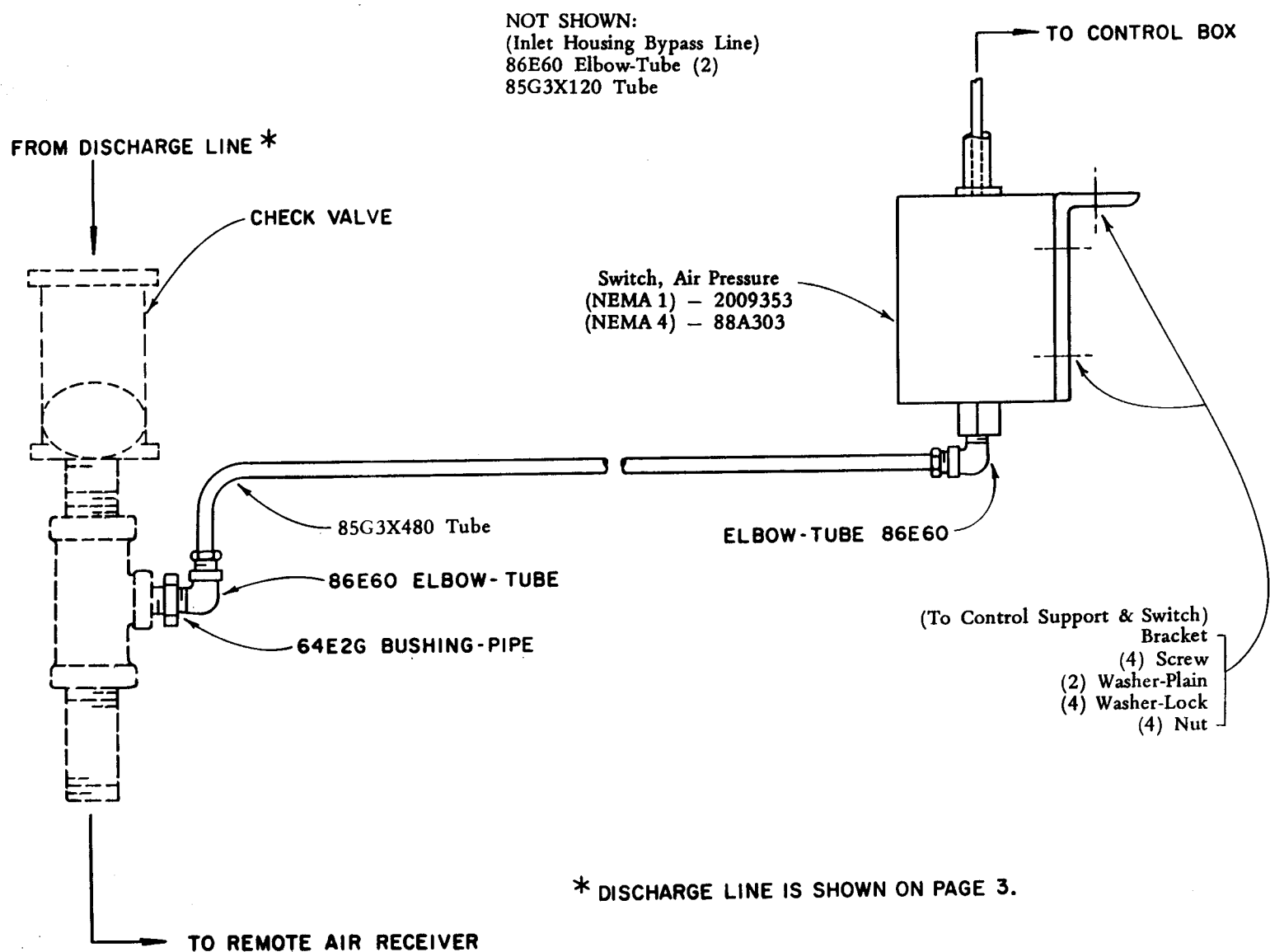

139-A4-13A

\* DISCHARGE LINE IS SHOWN ON PAGE 3.

**CONTROL PANEL GROUP (DUAL CONTROL) \***

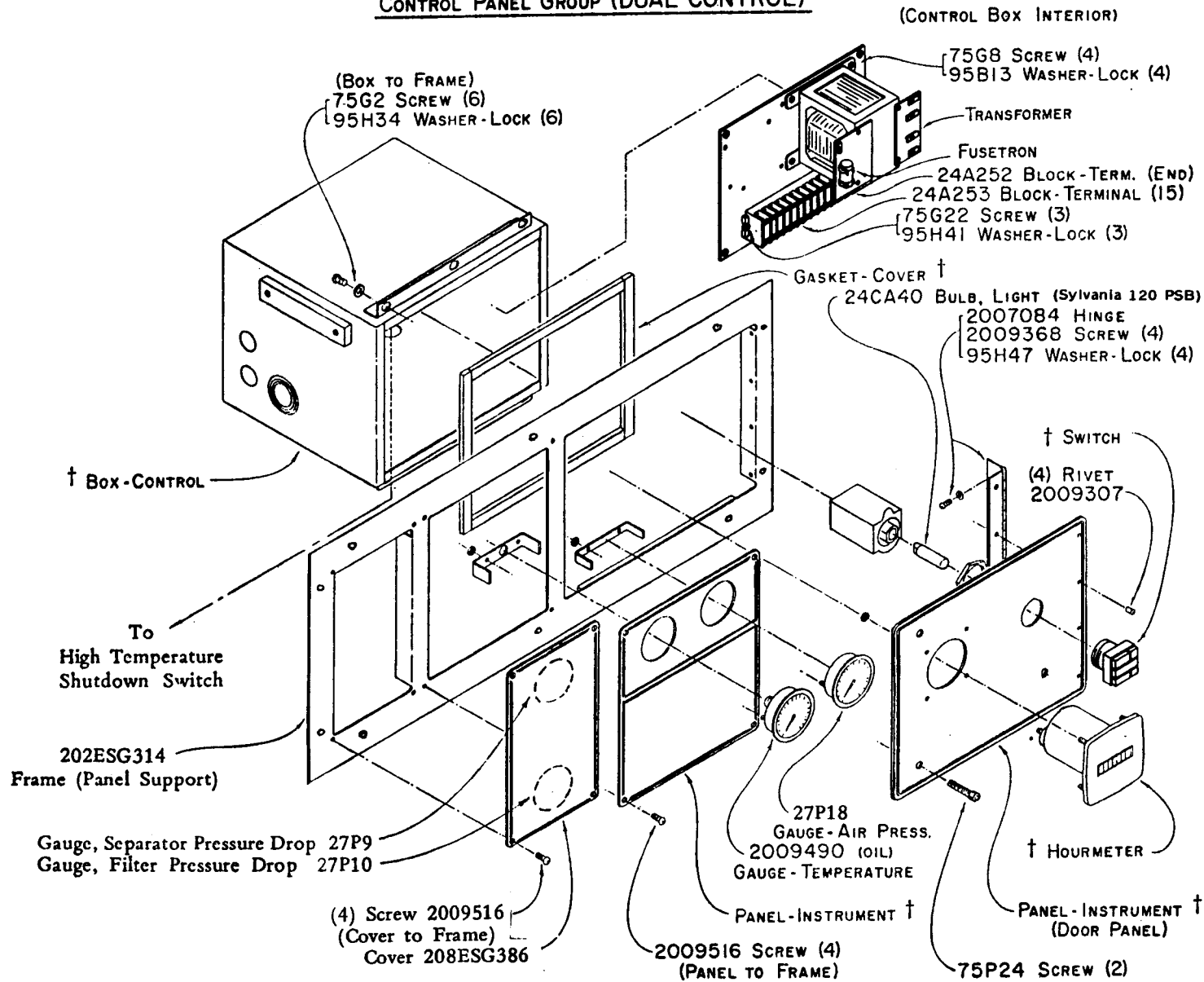

139-A4-14

\* For Dual Control Tubing see Page 139-A4-14a.  
 † Order Repair Parts from Page 139-C1-10 - Items are Selective.

139-A4-14A

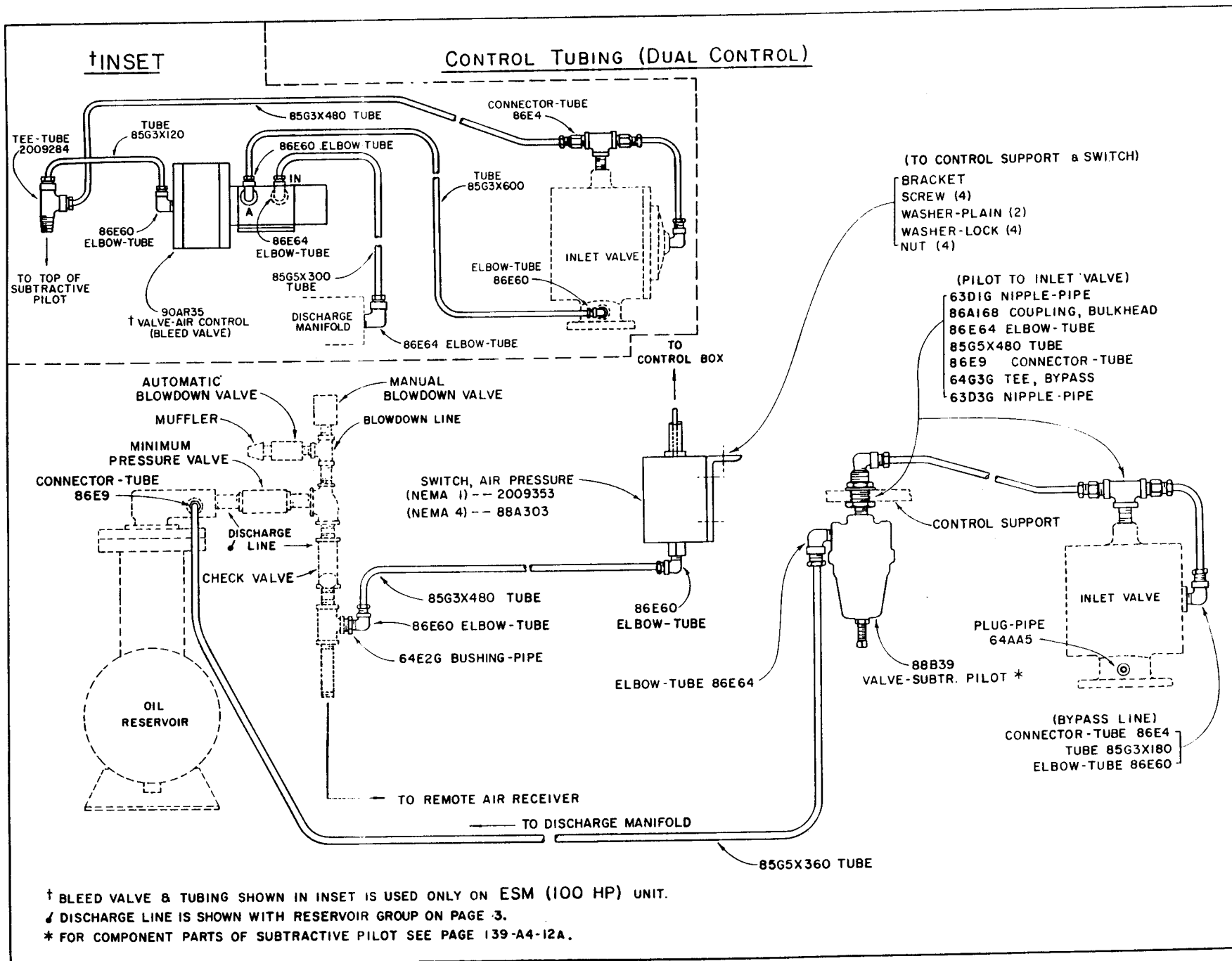

**CONTROL PANEL GROUP (DUOMATIC) \***

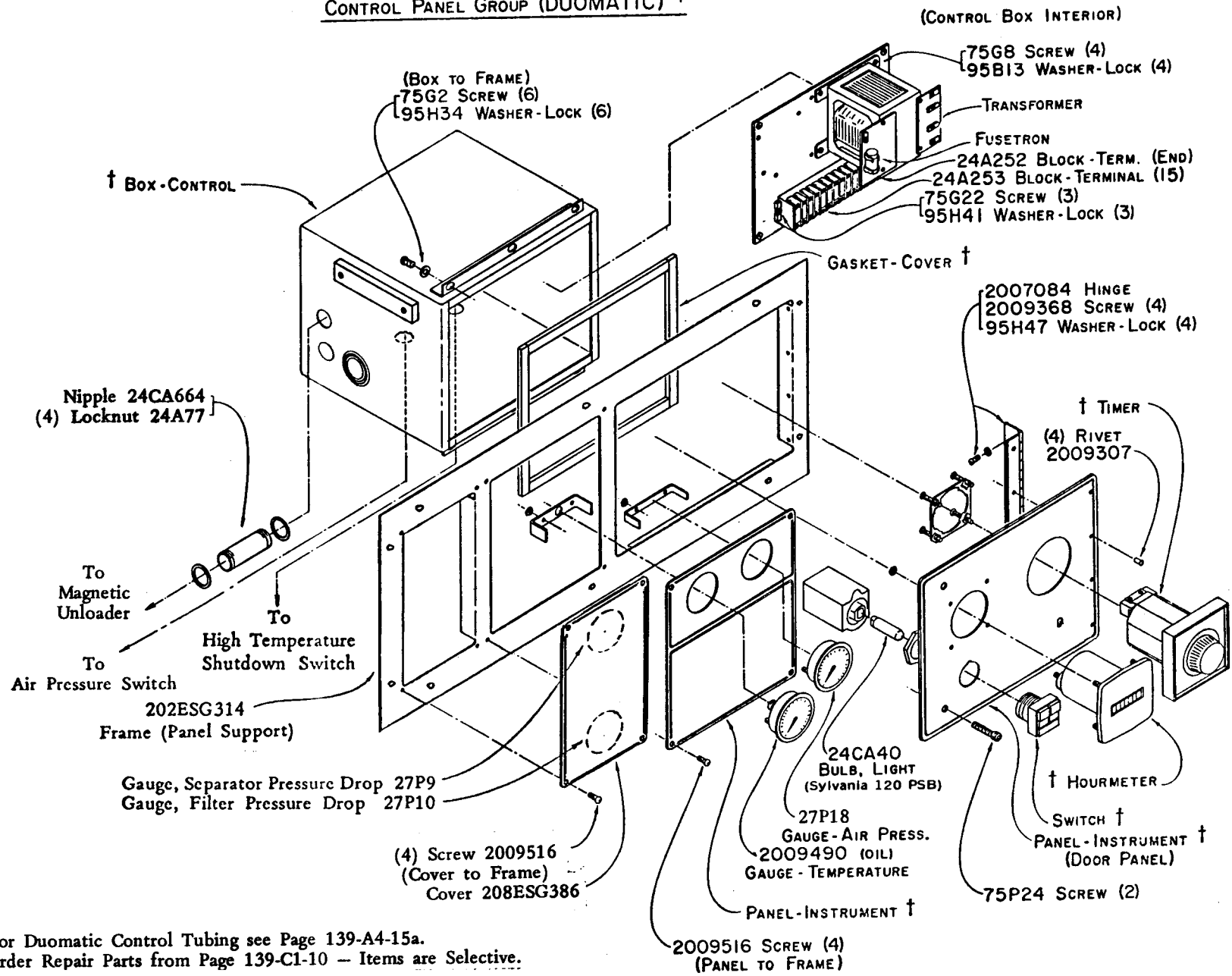

\* For Duomatic Control Tubing see Page 139-A4-15a.  
† Order Repair Parts from Page 139-C1-10 - Items are Selective.

139-A4-15

CONTROL TUBING (DUOMATIC)

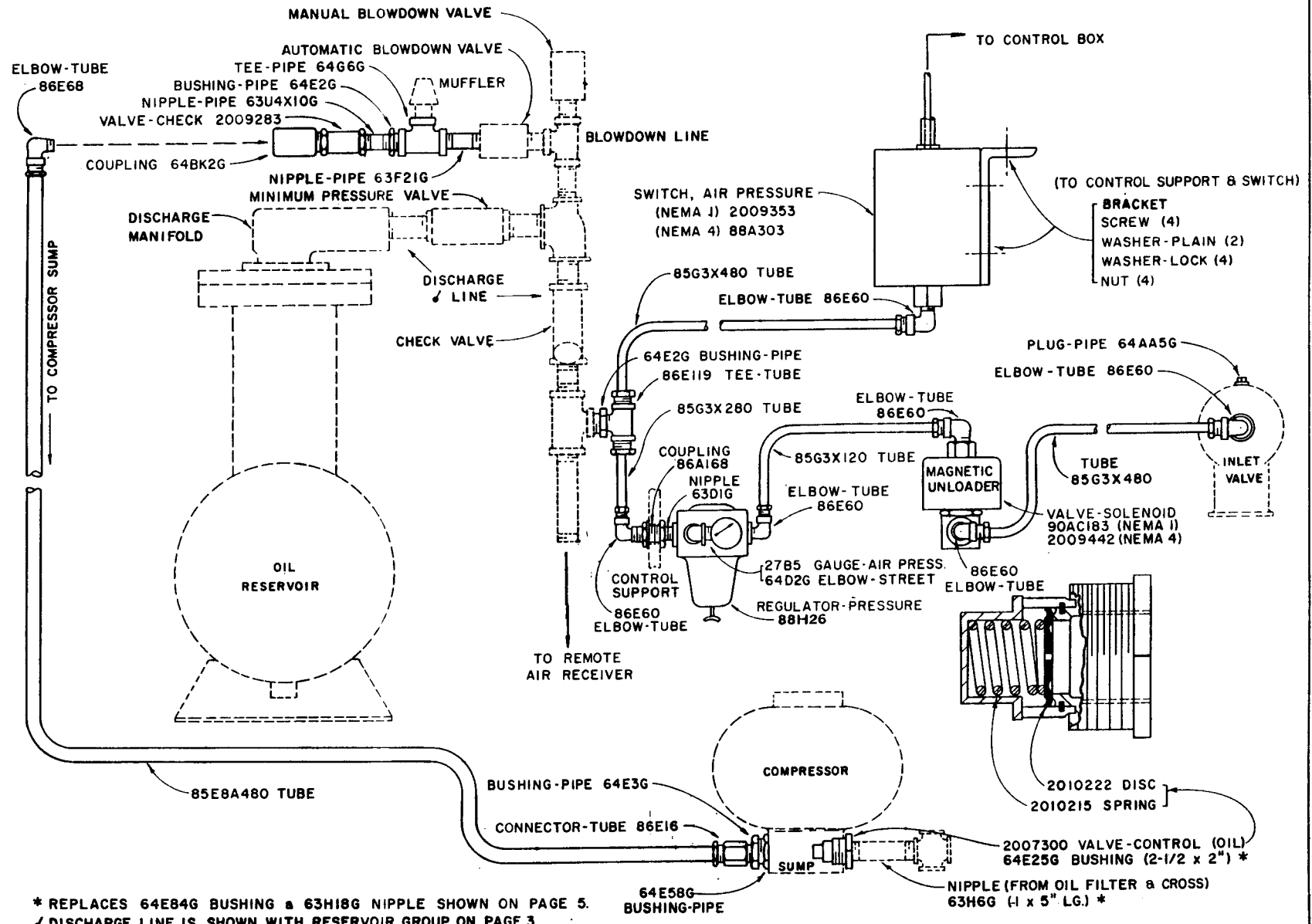

139-A4-15A

\* REPLACES 64E84G BUSHING & 63H18G NIPPLE SHOWN ON PAGE 5.  
 / DISCHARGE LINE IS SHOWN WITH RESERVOIR GROUP ON PAGE 3.

**RECOMMENDED SPARES – ELECTRA-SCREW® (60, 75 & 100 HP)**

The following kits are separated according to service and locations. These are made available to aid the customer in stocking parts to allow on-site maintenance and/or repair. Quantities shown are for one unit only. It is the responsibility of the Owner-Operator to apply a multiplier for multiple units, operating conditions and/or for hours of operation. Refer to Instruction Manual for recommended replacement time for critical parts. **KITS 1 AND 2 DO NOT INCLUDE OIL SEPARATORS, ELECTRICAL OR CONTROL ITEMS – THESE MUST BE PURCHASED SEPARATELY, OR AS KITS FOR ISOLATED SERVICE LOCATIONS.**

**Ordering Instructions**

**KIT NO. 1 – Routine Maintenance:** These are suggested as the minimum quantity of parts a customer should stock. They are usually the first items which require renewal. Order quantities of this kit to suit your requirements or particular service. One kit contains three (3) oil filter elements which require changing at least every 1000 hours under normal conditions.

**KIT NO. 2 – Periodic Maintenance:** These are suggested as the minimum spares a customer should stock for continuous operation for one year. When ordering for this service, order Kits No. 1 and 2.

**KIT NO. 3 – Periodic Overhaul, KIT NO. 4 – Oil Separators, KIT NO. 5 – Pneumatic Control & Gauges, KIT NO. 6 – Electrical Control:** These are suggested as the minimum spares a customer should stock for continuous operation. These parts include those which possibly would need renewal in an overhaul. When ordering for this service, order Kits No. 1, 2, 3, 4, 5 and 6. Apply proper multiplier for each kit to get total quantity of parts for the operational time and number of units involved. Kits No. 5 and 6 may contain extra items to meet requirements of selective control groups. Disregard extra items not suited to particular control.

**APPLY THE PROPER MULTIPLIER BASED ON NUMBER OF UNITS AND HOURS OF OPERATION;**  
Example: For four (4) units, four (4) of Kit No. 1 and only one (1) each of Kits 2 thru 6 may be sufficient.

KIT NUMBER .....	KIT NO. 1	KIT NO. 1	KIT NO. 2
COMPRESSOR HP .....	60 & 75	100	60, 75 & 100
HOURS OF OPERATION .....	3000	3000	9000
PART NUMBER (Complete Kit) For Units With:			
Standard Air Filter .....	ESM66046	ESM66046	ESK66047
Heavy-Duty Air Filter .....	ESK66187	ESM66188	-----

Description	Page No.	Qty. Per Kit	Qty. Per Kit	Qty. Per Kit
<b>KIT NO. 1</b>				
<b>ROUTINE MAINTENANCE</b>				
Air Filter Element .....	139- -2	.... 1	1	
Oil Filter Element Kit .....	139- -6	.... 3	3	
<b>KIT NO. 2</b>				
<b>PERIODIC MAINTENANCE</b>				
Compressor Shaft Seal .....	139- -1	.....		1
Inlet Valve .....	139- -2	.....		1
Inlet Valve Spring .....	139- -2	.....		1
Inlet Valve Piston Spring .....	139- -2	.....		1
Inlet Valve Packing .....	139- -2	.....		1
Gasket Kit .....	139- -1a	.....		1
Mixing Valve Element & O-Rings .....	139- -5(F)	.....		1 ea.
Subtractive Pilot .....	139- -12a	.....		1

† Effective with Serial Number 675452.

**RECOMMENDED SPARES — ELECTRA-SCREW® (60, 75 & 100 HP)**

KIT NUMBER .....	<b>KIT NO. 3</b>	<b>KIT NO. 3</b>
COMPRESSOR HP .....	60 & 75	100
HOURS OF OPERATION .....	18000	18000
PART NUMBER (Complete Kit) For Units With Standard Air Filter .....	ESK66964	ESM74080

Description	Page No.	Qty. Per Kit	Qty. Per Kit
-------------	----------	--------------	--------------

**KIT NO. 3  
 PERIODIC OVERHAUL  
 (Mechanical)**

Gear Drive Ball Bearing (Inner) .....	139- -1	....	1	1
Gear Drive Ball Bearing (Outer) .....	139- -1	....	1	1
Roller Bearing .....	139- -1	....	2	2
Ball Bearing .....	139- -1	....	4	4
Gasket Kit .....	139- -1a	....	1	1
Cushion, Coupling .....	139- -9	....	1	6

KIT NUMBER .....	<b>KIT NO. 4</b>	<b>KIT NO. 4</b>
COMPRESSOR HP .....	60	75 & 100
HOURS OF OPERATION .....	18000	1800
PART NUMBER (Complete Kit) For Units With Standard Air Filter .....	ESK74076	ESL74079

Description	Page No.	Qty. Per Kit	Qty. Per Kit
-------------	----------	--------------	--------------

**KIT NO. 4  
 OIL SEPARATORS**

Oil Separator, First Stage .....	139- -3a	....	1	1
Oil Separator, Second Stage .....	139- -3a	....	1	1
Tubing & Fittings .....	139- -3a	....	1 ea.	1 ea.

KIT NUMBER .....	<b>KIT NO. 5</b>	<b>KIT NO. 6</b>
COMPRESSOR HP .....	60, 75, 100	60, 75, 100†
HOURS OF OPERATION .....	18000	18000
PART NUMBER (Complete Kit) For Units With Standard Air Filter .....	ESK74077	ESK74078

Description	Page No.	Qty. Per Kit	Qty. Per Kit
-------------	----------	--------------	--------------

**KIT NO. 5  
 PNEUMATIC CONTROL & GAUGES**

Pressure Regulator .....	139- -15a	....	1
Air Pressure Gauge .....	139- -15a	....	1
Solenoid (Blowdown) Valve .....	139- -3a	....	1
Air Control (Bleed) Valve .....	139- -12a	....	1

**KIT NO. 6  
 ELECTRICAL CONTROL**

Air Pressure Switch .....	139- -13a	.....	1
High Air Temperature Switch .....	139- -3	.....	1
Solenoid (Magnetic Unloader) Valve .....	139- -15a	.....	1

† Effective with Serial Number 675452.

**RECOMMENDED SPARES - MODELS ESK, ESL & ESM**

The following kits are separated according to service and locations. These are made available to aid the customer in stocking parts to allow on-site maintenance and/or repair. Quantities shown are for one unit only. It is the responsibility of the Owner-Operator to apply a multiplier for multiple units, operating conditions and/or for hours of operation. Refer to Instruction Manual for recommended replacement time for critical parts. **KITS DO NOT INCLUDE OIL SEPARATORS, ELECTRICAL OR CONTROL ITEMS - THESE MUST BE PURCHASED SEPARATELY.**

**Ordering Instructions**

**KIT NO. 1 - Routine Maintenance:** These are suggested as the minimum quantity of parts a customer should stock. They are usually the first items which require renewal. Order quantities of this kit to suit your requirements or particular service. One kit contains three (3) oil filter elements which require changing at least every 1000 hours under normal conditions.

**KIT NO. 2 - Domestic Service:** These are suggested as the minimum spares a customer should stock for continuous operation for one year. When ordering for this service, order Kits No. 1 and 2.

**KIT NO. 3 - Isolated Domestic or Export Service:** These are suggested as the minimum spares a customer should stock for continuous operation. These parts include those which possibly would need renewal in an overhaul. When ordering for this service, order Kits No. 1, 2 and 3.

APPLY THE PROPER MULTIPLIER BASED ON NUMBER OF UNITS AND HOURS OF OPERATION;  
Example: For four (4) units, Four (4) of Kit No. 1 and only One (1) each of Kits 2 and 3 may be sufficient.

COMPRESSOR MODEL.....		ESK & ESL	ESM	ESK, ESL & ESM	ESK, ESL & ESM
HOURS OF OPERATION.....		3000	3000	9000	18000
PART NO. (Complete Kit) For Units With:		ESM66046	ESM66046	ESK66047	ESK66048
Standard Air Filter .....		ESK66187	ESM66188	-----	-----
Heavy-Duty Air Filter .....		<b>KIT NO. 1</b>		<b>KIT NO. 2</b>	<b>KIT NO. 3</b>
Description	Page No.	Qty. Per Kit		Qty. Per Kit	Qty. Per Kit
<b>KIT NO. 1 ROUTINE MAINTENANCE</b>					
Air Filter Element	139 -2	1			
Oil Filter Element Kit	139 -6	3			
<b>KIT NO. 2 DOMESTIC SERVICE</b>					
Bearing Housing O-Ring	139 -1			1	
Compressor Shaft Seal	139 -1			1	
Seal Housing O-Ring	139 -1			1	
Inlet Valve	139 -2			1	
Inlet Valve Spring	139 -2			1	
Inlet Valve Piston Spring	139 -2			1	
Inlet Valve Packing	139 -2			1	
Gasket Kit	139 -1a			1	
<b>KIT NO. 3 ISOLATED DOMESTIC OR EXPORT SERVICE</b>					
Gear Drive Ball Bearing (Inner)	139 -1				1
Gear Drive Ball Bearing (Outer)	139 -1				1
Roller Bearing	139 -1				2
Ball Bearing	139 -1				4
Gasket Kit	139 -1a				1

**Gardner**  

---

**Denver**

For additional information contact your local representative or  
Gardner Denver Machinery Inc., Customer Service Department,  
1800 Gardner Expressway, Quincy, Illinois 62301  
Telephone: (800) 682-9868 FAX: (217) 224-7814



Sales and Service in all major cities.

For parts information, contact Gardner Denver,  
Master Distribution Center, Memphis, TN  
Telephone: (800) 245-4946 FAX: (901) 542-6159

Specifications subject to change without notice.  
Copyright 1996 Gardner Denver Machinery Inc.