GARDNER DENVER®

13-9-522

PARTS LIST
ELECTRA-SCREW®
STATIONARY
COMPRESSOR

MODELS

ESGA, B, C - 30 HP

ESHA, B, C - 40 HP

ESJA, B, C - 50 HP

TABLE OF CONTENTS

GROUP NAME	PAGE NO.
Ordering Instructions	P/L 139-500b
Bare Compressor (w/Gears)	139-C1-1
Repair Kits, Bare Compressor	139-C1-1a
Air Filter (Standard) & Inlet Valve	139-B1-2
Air Filter, Heavy-Duty (Optional)	139-B1-2a
Oil Reservoir Group (Dual Separators)	139-C1-3
Oil Level Gauge (Repair Kit)	
Switch, Hi Temperature Shutdown	
Oil Reservoir Group (Selective Items)	139-C1-3a
Valve, Safety	
Valve, Solenoid (Automatic Blowdown)	
Oil Separator Repair Kits	
Oil Return Line	
Air Discharge Piping (<i>Without Aftercooler</i>)	139-C1-3b
Air Discharge Piping (<i>Air-Cooled Units With Aftercooler</i>)	139A-A1-3b (F)
Air Discharge Piping (<i>Water-Cooled Units With Aftercooler</i>)	139A-A1-3b (W)
Check Valve	
Manual Blowdown Valve	
Moisture Separator (<i>With Aftercooler Units Only</i>)	
Oil Piping Group (<i>Air-Cooled Units</i>)	139-B1-5 (F)
Oil & Water Piping Group (<i>Without Aftercooler</i>)	139-B1-5 (W)
Oil & Water Piping Group (<i>With Aftercooler</i>)	139A-A1-5 (W)
Selective Items (<i>Fresh Water Service</i>)	139-B1-5a (W)
Selective Items (<i>Salt Water Service</i>)	139-B1-5b (W)
Heat Exchanger	
Temperature Regulator	
Solenoid Valve, Water	
Aftercooler	
Oil Filter, Minimum Pressure & Thermal Valves	139-B1-6
Radiator Group (<i>Without Aftercooler</i>)	139-B1-7 (F)
Selective Items	139-B1-7a (F)
Radiator Group (<i>With Aftercooler</i>)	139A-A1-7 (F)
Selective Items	139A-A1-7a (F)
Coupling & Base	139-C1-9
Control Groups (Optional and/or Selective)	139-C1-10
Constant Speed Control:	Panel
(w/Pilot Valve)	Tubing
	139-B1-12
	139-B1-12a
Automatic Start-Stop Control:	Panel
(w/Pressure Switch)	Tubing
	139-B1-13
	139-B1-13a
Dual Control:	Panel
(w/Pilot and Switch)	Tubing
	139-B1-14
	139-B1-14a
Duomatic Control:	Panel
(w/Unloader Valve)	Tubing
	139-B1-15
	139-B1-15a
Recommended Spares	139-C1-16

TABLE OF CONTENTS

*MODELS: ESG (30 HP)
 ESH (40 HP)
 ESJ (50 HP)

GROUP NAME	PAGE NO.
Ordering Instructions	P/L 139-500b
Bare Compressor (w/Gears)	139-C1-1
Repair Kits, Bare Compressor	139-C1-1a
Air Filter (Standard) & Inlet Valve	139-B1-2
Air Filter, Heavy-Duty (Optional)	139-B1-2a
Oil Reservoir Group (Dual Separators)	139-C1-3
Valve, Minimum Pressure	
Valve, Check	
Valve, Manual Blowdown	
Oil Level Gauge (Repair Kit)	
Switch, Hi Temperature Shutdown	
Oil Reservoir Group (Selective Items)	139-C1-3a
Valve, Safety	
Valve, Solenoid (Automatic Blowdown)	
Oil Separator Repair Kits	
Oil Return Line	
Piping Group (Air-Cooled Units)	139-B1-5 (F)
Piping Group (Water-Cooled Units)	139-B1-5 (W)
Piping Group (Water-Cooled, Selective Items)	139-B1-5a (W)
Heat Exchanger	
Temperature Regulator	
Solenoid Valve, Magnetic Water	
Oil Filter & Thermal Valve	139-B1-6
Radiator Group (Air-Cooled Units)	139-B1-7 (F)
Radiator Group (Air-Cooled, Selective Items)	139-B1-7a (F)
Coupling & Base	139-C1-9
Control Groups (Optional and/or Selective)	139-C1-10
Constant Speed Control:	Panel
(w/Pilot Valve)	Tubing
	139-B1-12
	139-B1-12a
Automatic Start-Stop Control:	Panel
(w/Pressure Switch)	Tubing
	139-B1-13
	139-B1-13a
Dual Control:	Panel
(w/Pilot and Switch)	Tubing
	139-B1-14
	139-B1-14a
Duomatic Control:	Panel
(w/Unloader Valve)	Tubing
	139-B1-15
	139-B1-15a
Recommended Spares	139-C1-16

* Refer to Page 139-C1-1a for Complete Model Designations.

† EFFECTIVE WITH SERIAL NUMBER 673112.

TABLE OF CONTENTS

*MODELS: ESG (30 HP)
 ESH (40 HP)
 ESJ (50 HP)

GROUP NAME	PAGE NO.
Ordering Instructions	P/L 139-500b
Bare Compressor (w/Gears)	† 139-B1-1
Repair Kits, Bare Compressor	† 139-B1-1a
Air Filter (Standard) & Inlet Valve	139-B1-2
Air Filter, Heavy-Duty (Optional)	139-B1-2a
Oil Reservoir Group (Dual Separators)	139-C1-3
Valve, Minimum Pressure	
Valve, Check	
Valve, Manual Blowdown	
Oil Level Gauge (Repair Kit)	
Switch, Hi Temperature Shutdown	
Oil Reservoir Group (Selective Items)	139-C1-3a
Valve, Safety	
Valve, Solenoid (Automatic Blowdown)	
Oil Separator Repair Kits	
Oil Return Line	
Piping Group (Air-Cooled Units)	139-B1-5 (F)
Piping Group (Water-Cooled Units)	139-B1-5 (W)
Piping Group (Water-Cooled, Selective Items)	139-B1-5a (W)
Heat Exchanger	
Temperature Regulator	
Solenoid Valve, Magnetic Water	
Oil Filter & Thermal Valve	139-B1-6
Radiator Group (Air-Cooled Units)	139-B1-7 (F)
Radiator Group (Air-Cooled, Selective Items)	139-B1-7a (F)
Coupling & Base	139-B1-9
Control Groups (Optional and/or Selective)	139-C1-10
Constant Speed Control:	Panel
(w/Pilot Valve)	Tubing
	139-B1-12
	139-B1-12a
Automatic Start-Stop Control:	Panel
(w/Pressure Switch)	Tubing
	139-B1-13
	139-B1-13a
Dual Control:	Panel
(w/Pilot and Switch)	Tubing
	139-B1-14
	139-B1-14a
Duomatic Control:	Panel
(w/Unloader Valve)	Tubing
	139-B1-15
	139-B1-15a
Recommended Spares	† 139-B1-16

* Refer to Page 139-B1-1a for Complete Model Designations.

INSTRUCTIONS FOR ORDERING REPAIR PARTS

When ordering parts, specify Compressor **SERIAL NUMBER** (see nameplate on unit), **MODEL**, **OPERATING PRESSURE**, **HORSEPOWER** and **METHOD OF COOLING**. Serial Number is also stamped on top of the cylinder flange.

All orders for Parts should be placed with the nearest Sales and Service Office listed on the back cover of this book.

DO NOT ORDER BY SETS OR GROUPS. Where NOT specified, quantity of parts required per compressor or unit is one (1); where more than one is required per unit, quantity is indicated in parenthesis. **SPECIFY EXACTLY THE NUMBER OF PARTS REQUIRED.**

PARTS NOT SHOWN OR LISTED: Special parts such as Solenoid and Safety Valves, Motors, Starters, Transformers, etc. that require ordering according to voltage, pressure or speed, must be referred to the **FACTORY** and **MUST BE ORDERED** by **MODEL** and **SERIAL NUMBER**.

Piping, copper tubing, hardware and electrical connections may be purchased locally. However, **IT IS THE RESPONSIBILITY OF THE CUSTOMER** when making repairs to purchase parts of **EQUAL** or **BETTER** quality as those used in the original construction. Refer to Operating Instructions and Service Manual for Piping Schematics and Electrical Diagrams.

PARTS RETURNED

All claims must be made within five days after receipt of goods. If order has been filled correctly, we cannot allow the return of the goods without our consent and then only on a basis of a charge for service and rehandling plus transportation charges.

Transportation charges must be prepaid. If it is necessary to return a part to the factory for duplication or inspection, do not fail to do the following:

1. Write the nearest Sales and Service Office a letter advising what material you wish to return and why.
2. After receiving permission to return the item or items, obtain from the Sales and Service Office the correct forms filled out by that office for the proper return of material.
3. Place a tag in the package showing your name and address.
4. Tag each article in the box or package stating what and how many are returned.
5. Always give the serial number of the machine from which the parts were removed or the invoice number on which the parts were originally shipped.

All parts returned for credit should be handled in the same manner as that for duplication or inspection.

BARE COMPRESSOR REPAIR KITS

(30, 40 & 50 HP)

PSI	HP	MODEL	φ	BARE COMPRESSOR	GASKET KIT *
			GEAR KIT	FIELD REPLACEMENT (INCLUDES GEARS)	
			PART NO.	PART NO.	PART NO.
100	30	ESGAE, ESGAF, ESGAH, ESGAJ	SSF65897 SSF65897	ESG65942 ESG65942	SSF65888 SSF65888
	40	ESHAE, ESHAF, ESHAH, ESHAJ	SSF65898 SSF65902	ESH65943 ESJ65940	SSF65888 SSF65888
	50	ESJAE, ESJAF, ESJAG, ESJAH	SSF65899 SSF65899	ESJ65944 ESJ65944	SSF65888 SSF65888
125	30	ESGBE, ESGBF, ESGBH	SSF65900 SSF65900	ESG65936 ESG65936	SSF65888 SSF65888
	40	ESHBE, ESHBF, ESHBG, ESHBH	SSF65901 SSF65901	ESH65938 ESH65938	SSF65888 SSF65888
	50	ESJBE, ESJBF, ESJBG, ESJBH	SSF65902 SSF65902	ESJ65940 ESJ65940	SSF65888 SSF65888
150	30	-----	-----	-----	-----
	40	ESHCE, ESHCF	SSF65897	ESG65942	SSF65888
	50	ESJCE, ESJCF	SSF65898	ESJ65943	SSF65888

φ Gear Kit includes Gears, Keys, Gear Housing Gasket and O-Rings.

* Gasket Kits are for Complete Unit, Less Motor.

ASM SSFD/1 THRU SSFD/6 †

COMPRESSOR

(30, 40 & 50 HP)

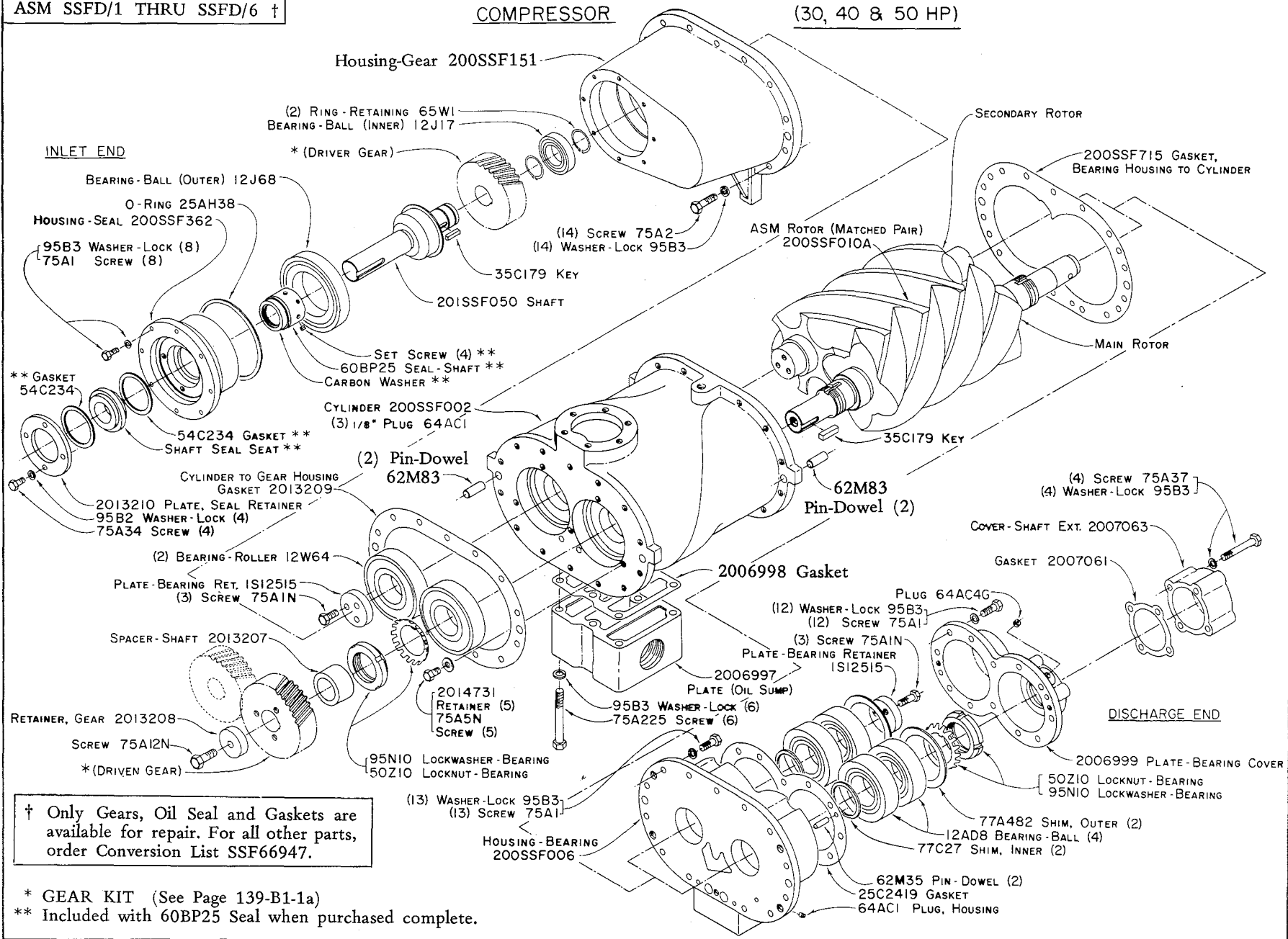

† Only Gears, Oil Seal and Gaskets are available for repair. For all other parts, order Conversion List SSF66947.

* GEAR KIT (See Page 139-B1-1a)
 ** Included with 60BP25 Seal when purchased complete.

139-B1-1

BARE COMPRESSOR REPAIR KITS

(30, 40 & 50 HP)

PSI	HP	MODEL	φ	BARE COMPRESSOR	GASKET KIT *
			GEAR KIT	FIELD REPLACEMENT (INCLUDES GEARS)	
			PART NO.	PART NO.	PART NO.
100	30	ESGAE, ESGAF, ESGAH, ESGAJ	SSF65897 SSF65897	ESG65942 ESG65942	SSF65888 SSF65888
	40	ESHAE, ESHAF, ESHAH, ESHAJ	SSF65898 SSF65902	ESH65943 ESJ65940	SSF65888 SSF65888
	50	ESJAE, ESJAF, ESJAG, ESJAH	SSF65899 SSF65899	ESJ65944 ESJ65944	SSF65888 SSF65888
125	30	ESGBE, ESGBF, ESGBH	SSF65900 SSF65900	ESG65936 ESG65936	SSF65888 SSF65888
	40	ESHBE, ESHBF, ESHBG, ESHBH	SSF65901 SSF65901	ESH65938 ESH65938	SSF65888 SSF65888
	50	ESJBE, ESJBF, ESJBG, ESJBH	SSF65902 SSF65902	ESJ65940 ESJ65940	SSF65888 SSF65888
150	30	-----	-----	-----	-----
	40	ESHCE, ESHCF	SSF65897	ESG65942	SSF65888
	50	ESJCE, ESJCF	SSF65898	ESJ65943	SSF65888

φ Gear Kit includes Gears, Keys, Gear Housing Gasket and O-Rings.

* Gasket Kits are for Complete Unit, Less Motor.

139-B1-1a

GARDNER-DENVER COMPRESSOR

139-B1-1a
Revised July, 1975

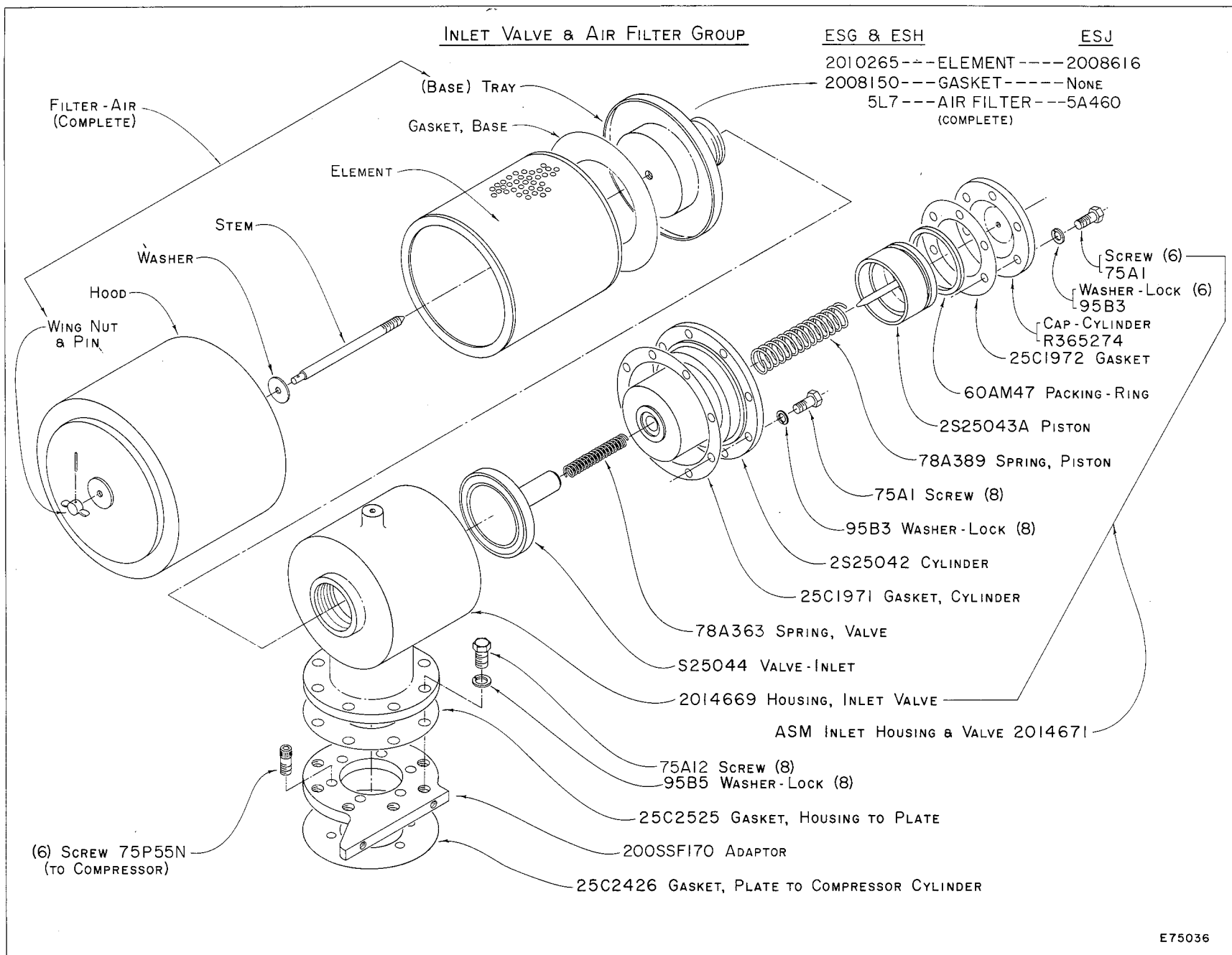

E75036

AIR FILTER GROUP--- HEAVY DUTY
 *(OPTIONAL EQUIPMENT)

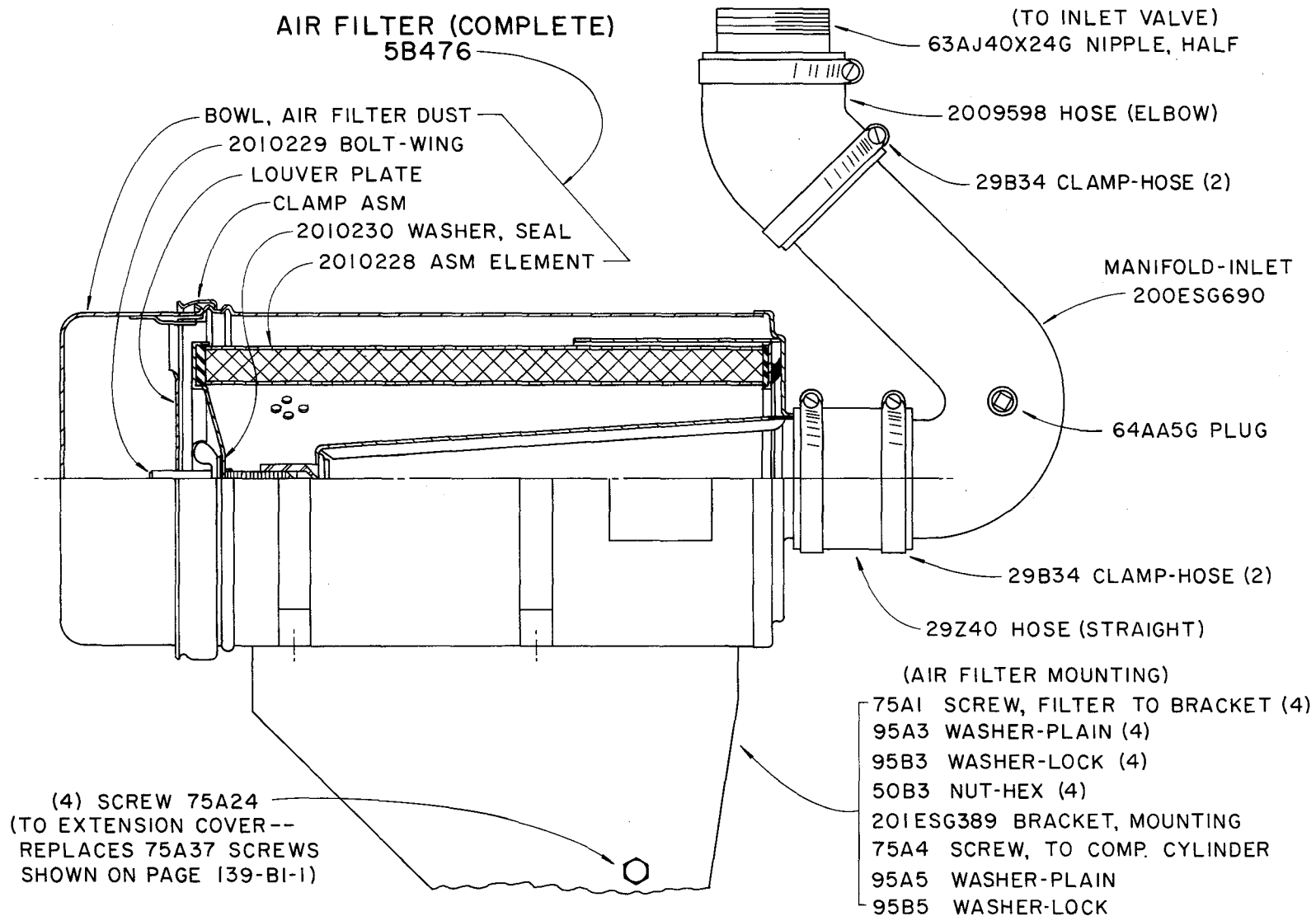

* WHEN HEAVY DUTY AIR FILTER IS SPECIFIED THE ABOVE GROUP OF PARTS REPLACES AIR FILTER SHOWN ON PAGE 139-BI-2.

C75340

E75338

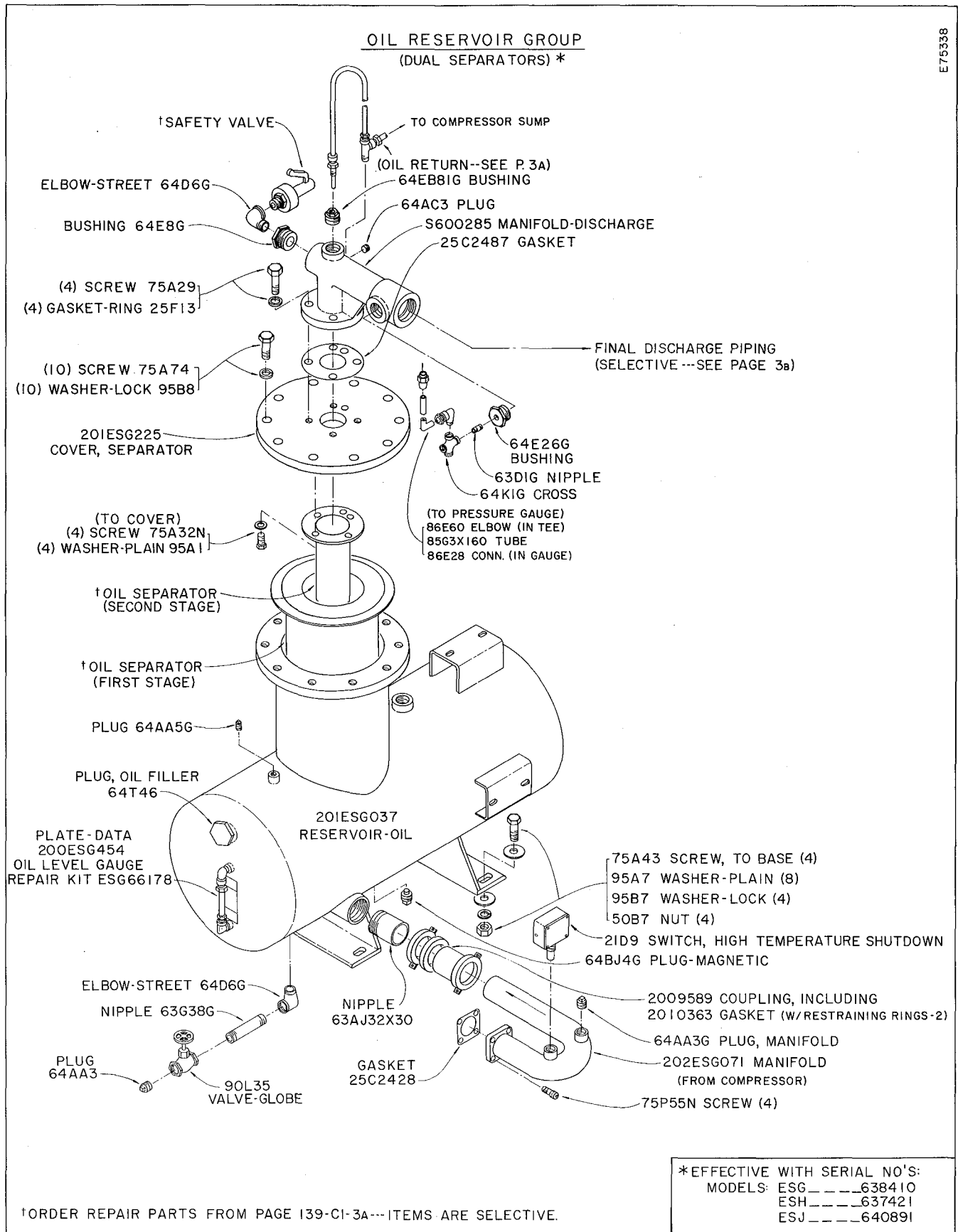

OIL RESERVOIR GROUP
(Selective Items)

PART NAME & DESCRIPTION	30, 40 & 50 HP
Valve-Safety (Set 115 Lbs.) Valve-Safety (Set 135 Lbs.) Valve-Safety (Set 165 Lbs.) Valve-Solenoid, Automatic Blowdown (NEMA 1) Valve-Solenoid, Automatic Blowdown (NEMA 4)	90AR33 90G261 90G33 90AC162 90AC163
OIL SEPARATOR GROUP	
OIL SEPARATOR REPAIR KIT (1st Stage) (w/2009599 Separator)	2014828
OIL SEPARATOR REPAIR KIT (2nd Stage) (w/55B8 Separator)	2010741
φ Tube-Formed (Thru Manifold & 2nd Stage Separator)	201ESG857
NOTE: Repair Kits include Separator, Top Manifold Gasket and Tube Fittings as shown in illustration below.	
(Oil Return Line - To Compressor)	
Tube, From Tee on Manifold (1/4" OD) Connector-Tube (1/4 T) Tube, To Compressor (1/4" OD) Elbow-Tube (1/4 T x 1/8 P x 90°)	85G3X130 86E48 85G3X260 86E59

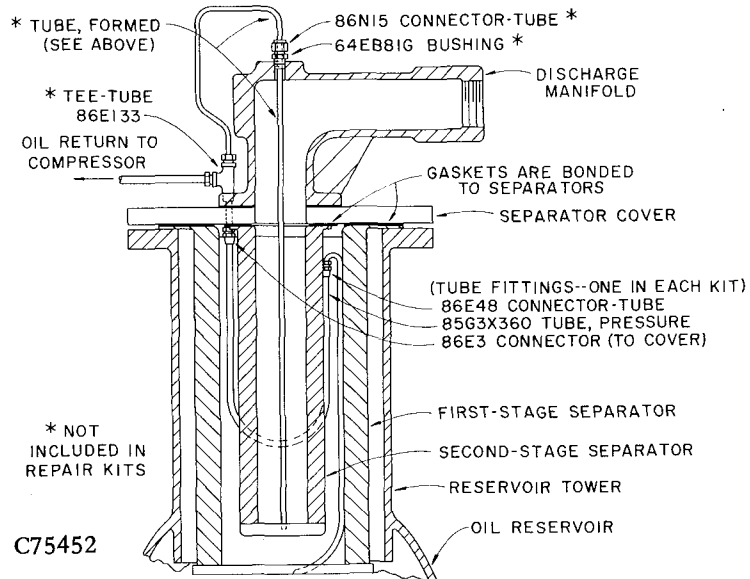

φ When ordering Formed Tube for Repair, also order related Tube Fittings as shown in illustration.

AIR DISCHARGE PIPING
(WITHOUT AFTERCOOLER)
AIR & WATER-COOLED UNITS

C75767

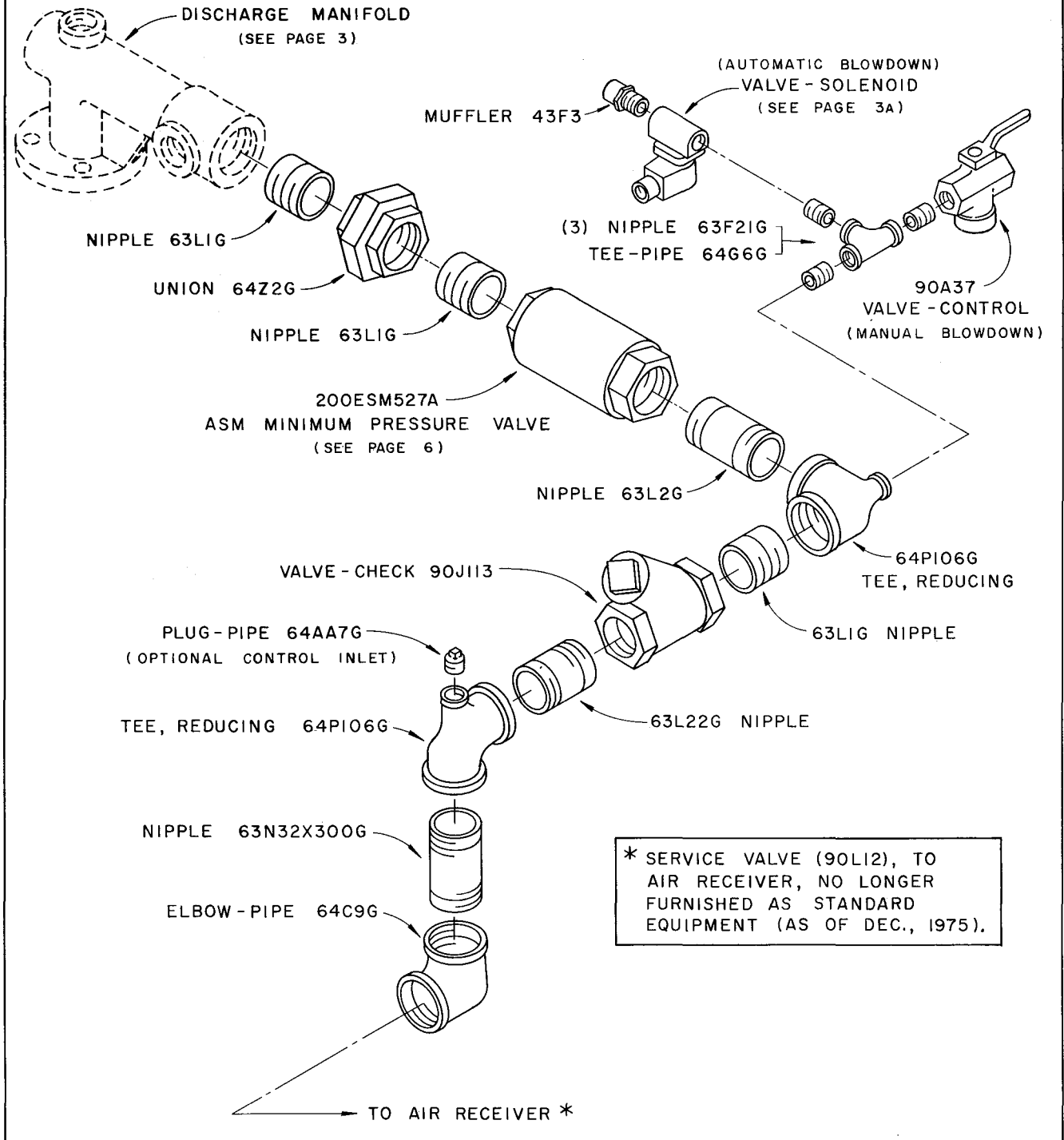

AIR DISCHARGE PIPING
 (AIR-COOLED UNITS WITH AFTERCOOLER)

AFTERCOOLER
 SEE PAGE I39A-AI-7A (F)

I39A-AI-3B (F)

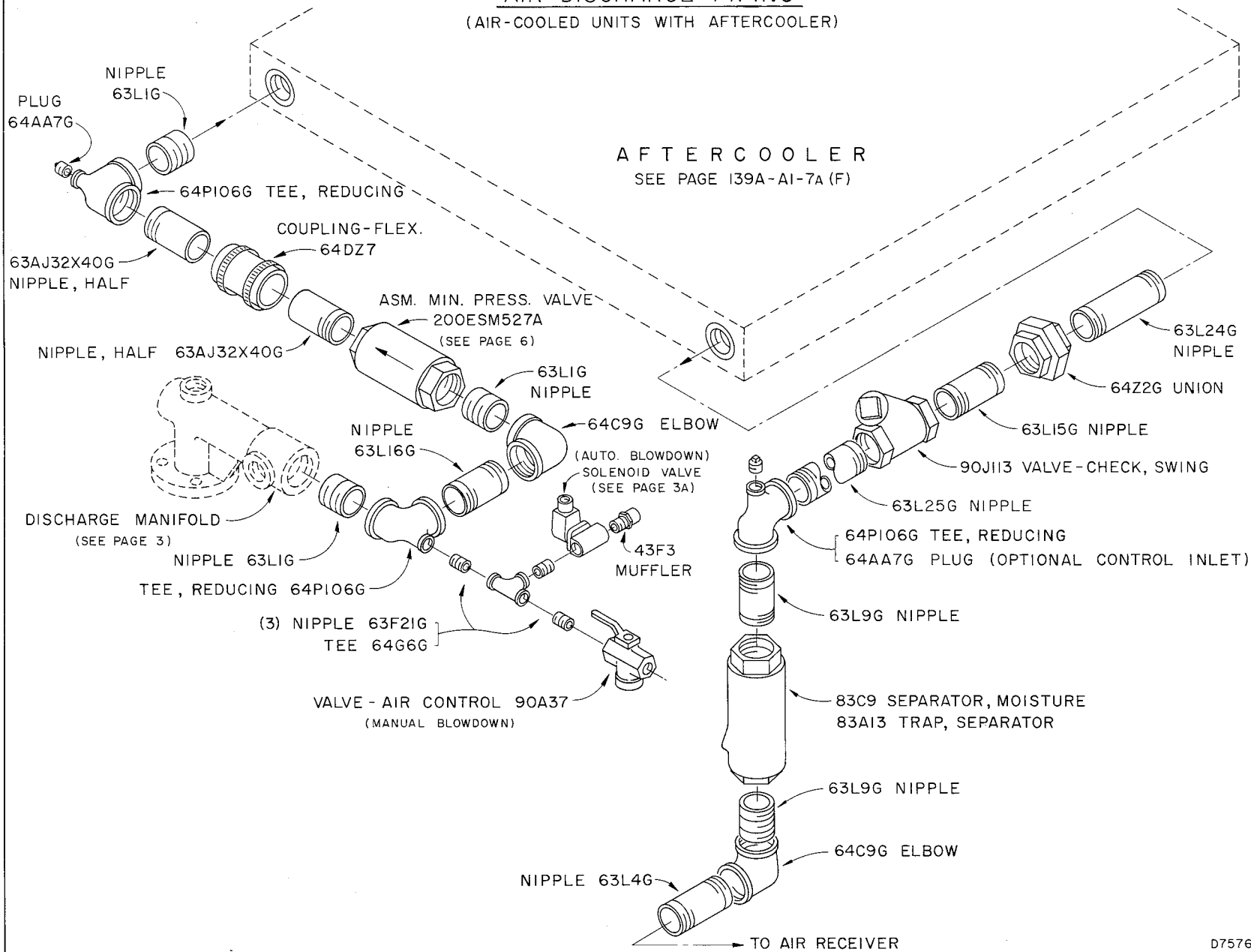

D75768

075774

AIR DISCHARGE PIPING (WATER-COOLED UNITS WITH AFTERCOOLER)

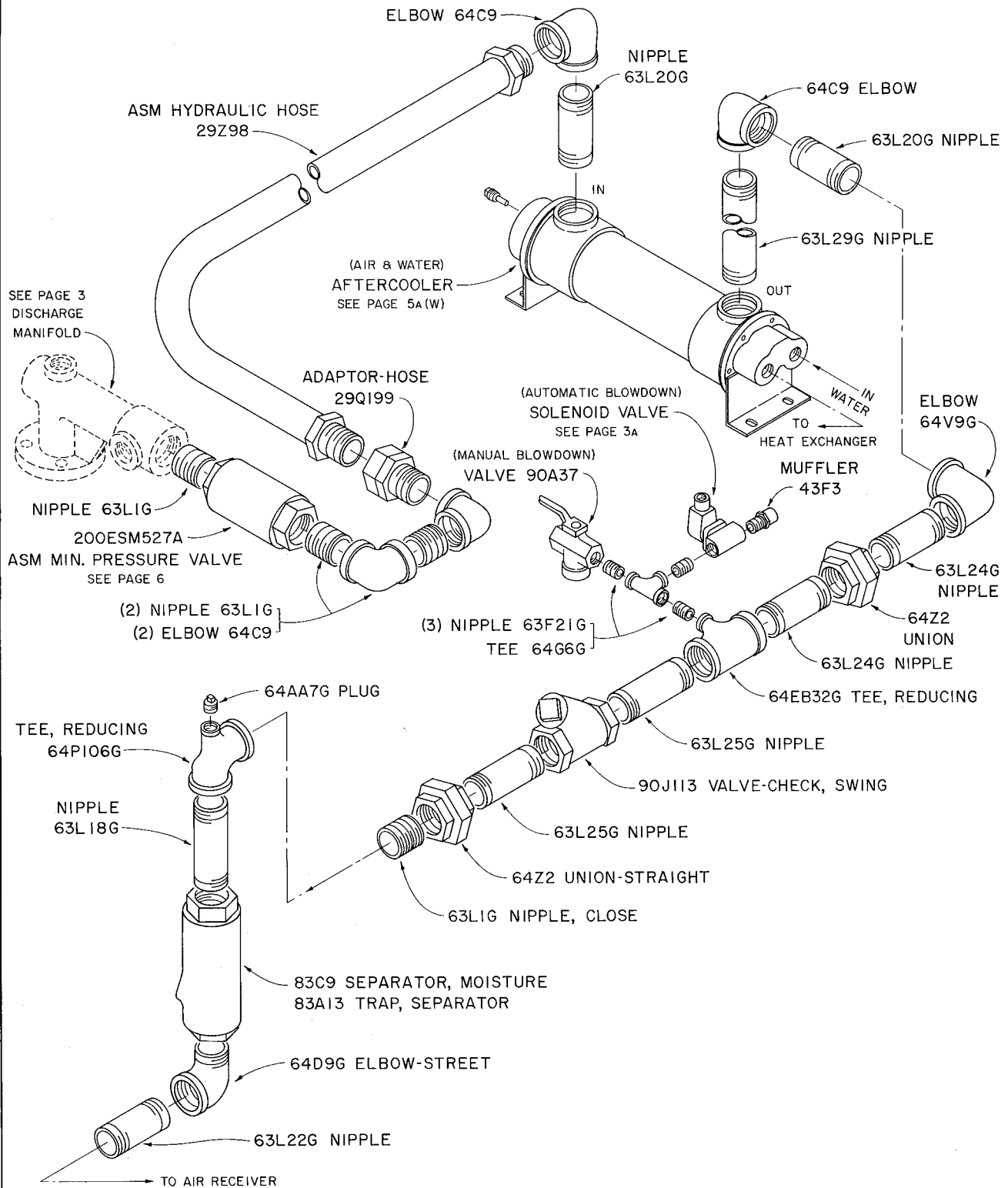

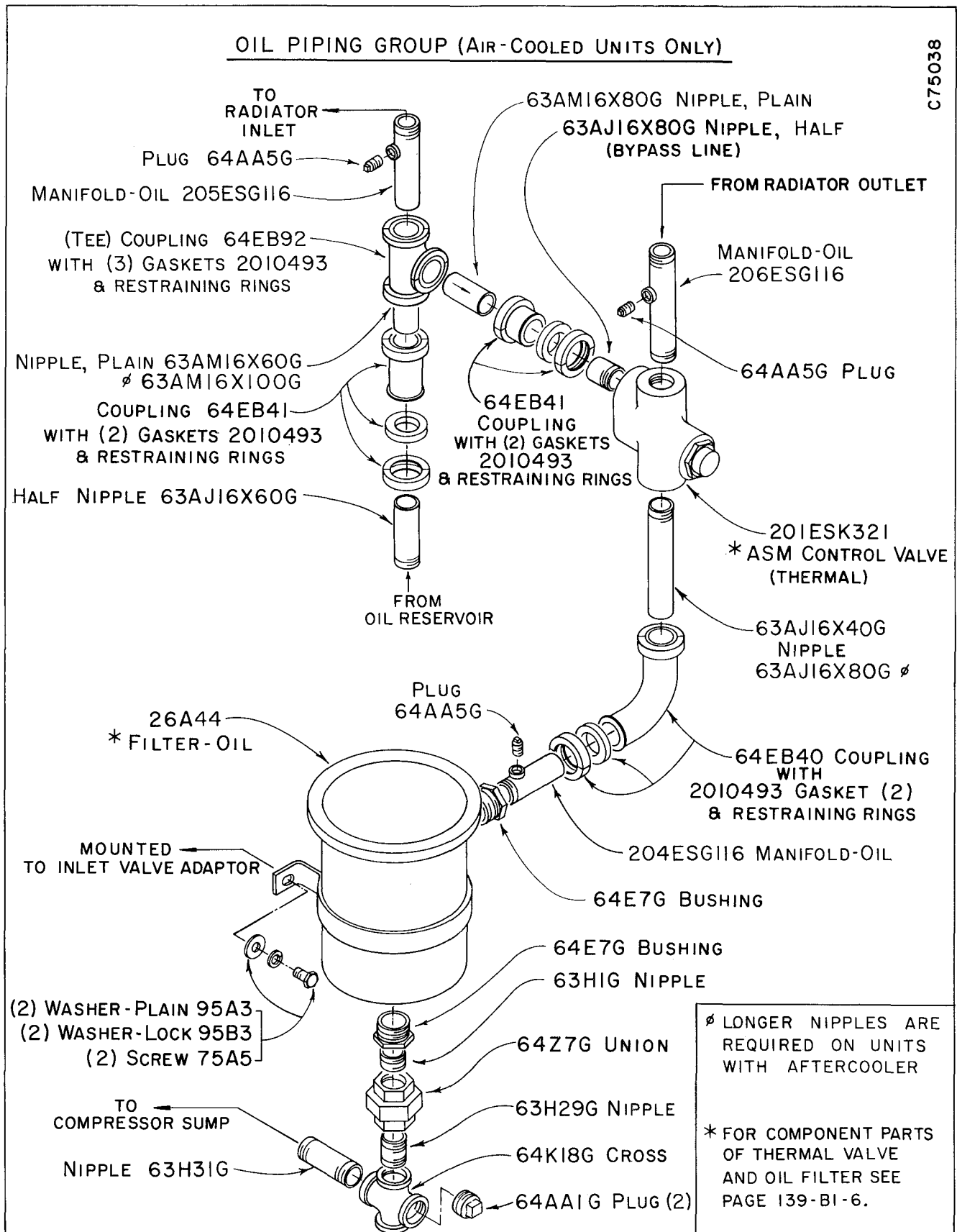

OIL & WATER PIPING GROUP (WATER-COOLED UNITS)
(UNITS WITHOUT AFTERCOOLER)

139-BI-5 (W)

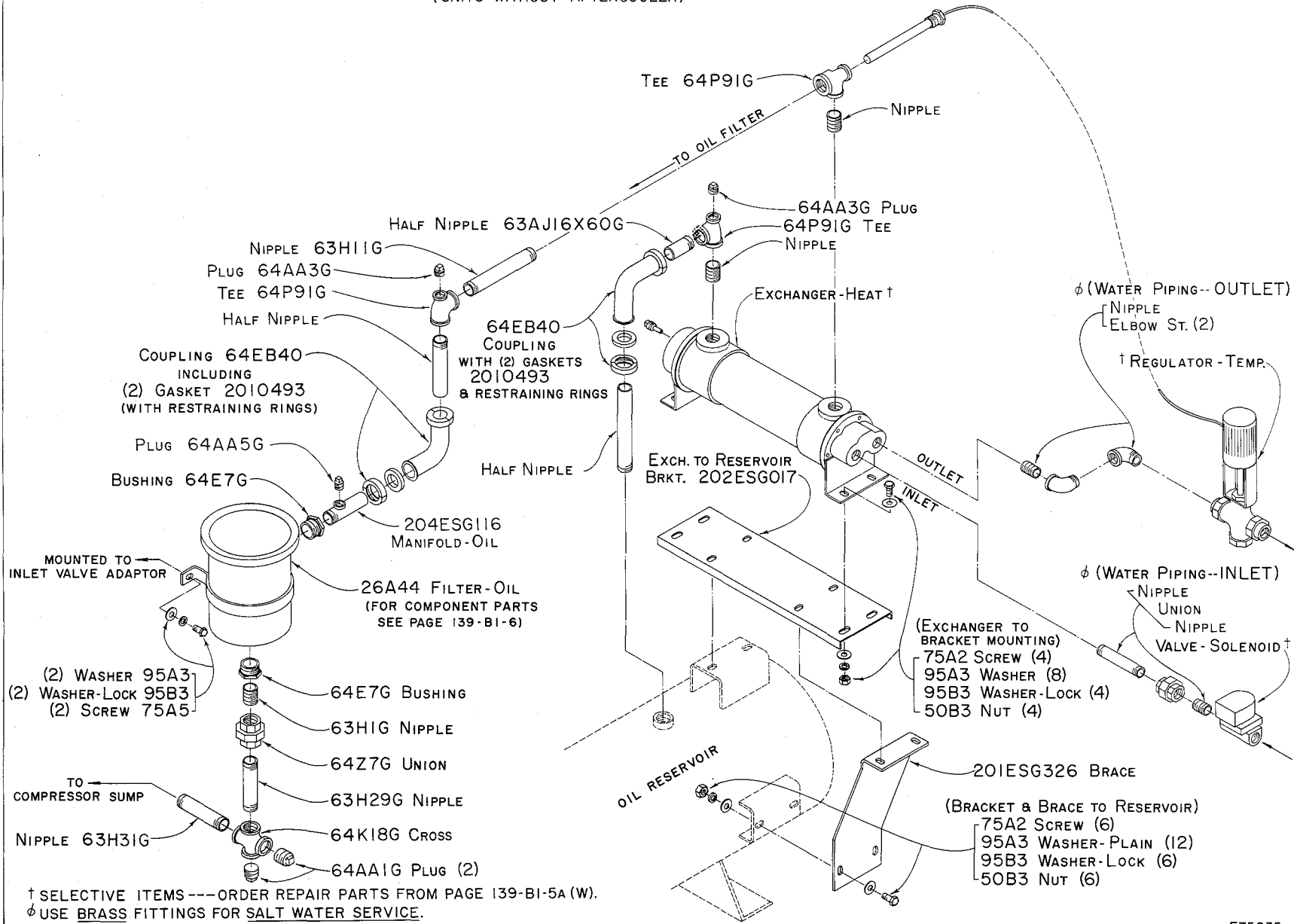

† SELECTIVE ITEMS --- ORDER REPAIR PARTS FROM PAGE 139-BI-5A (W).
 † USE BRASS FITTINGS FOR SALT WATER SERVICE.

E75035

OIL & WATER PIPING GROUP (WATER-COOLED)
(UNITS WITH AFTERCOOLER)

139A-AI-5(W)

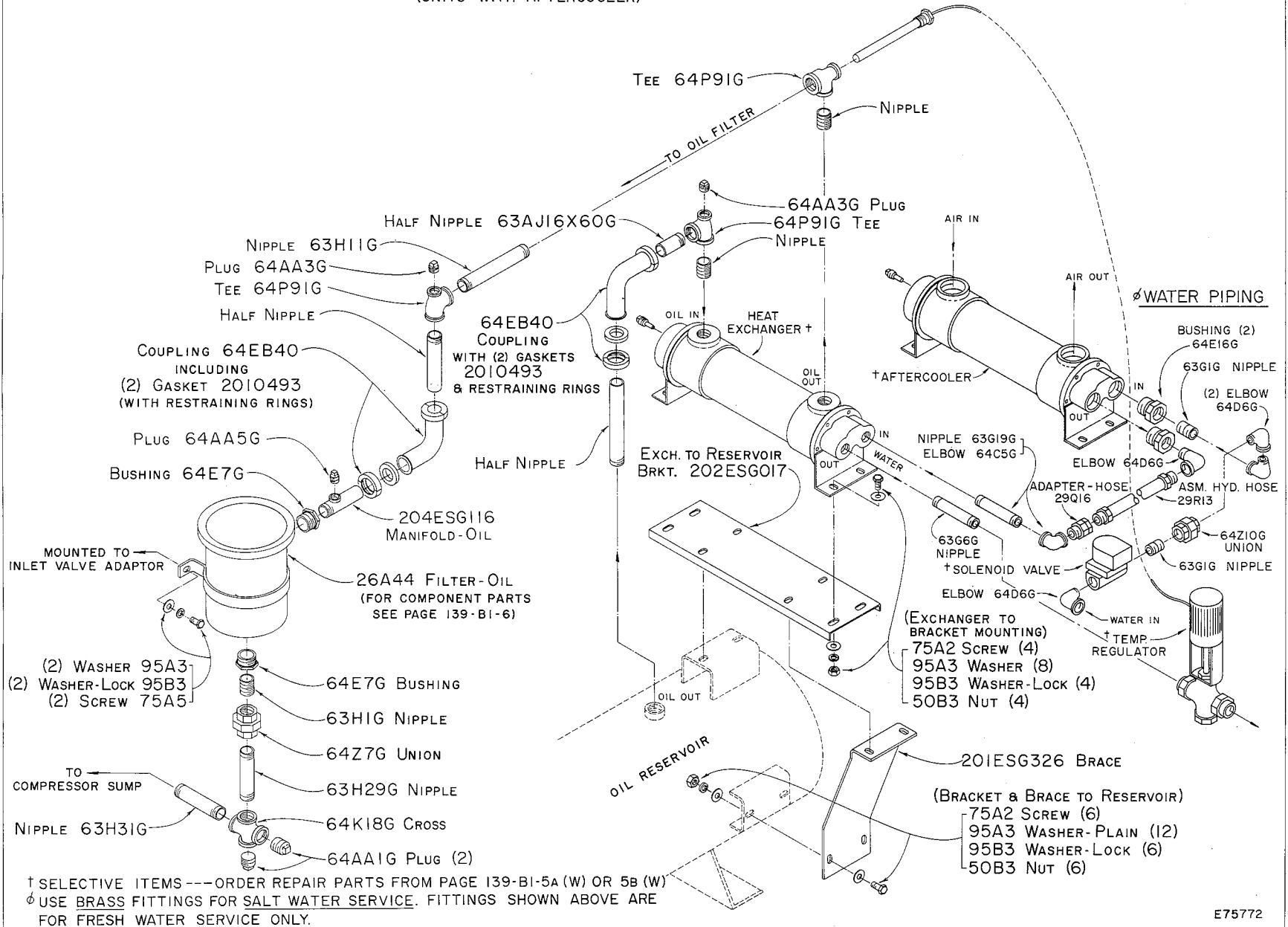

E75772

GARDNER-DENVER COMPRESSOR

139A-AI-5 (W)

REVISED MAY, 1976

**SELECTIVE ITEMS – WATER-COOLED UNITS
(FRESH WATER SERVICE)**

PART NAME & DESCRIPTION	30 & 40 HP		50 HP	
	(YOUNG)	(THERMAL TRANSFER)	(YOUNG)	(THERMAL TRANSFER)
Heat Exchanger, Incl. Next 6 Parts	200ESG349	203ESG349	48C45	200ESJ349
Bracket, Mounting (2)	2010319	2109056	2010214	2109062
Gasket, Inlet-Outlet	2010316	2109052	2010211	2109058
Bonnet, Inlet-Outlet	2010314 *	2109054	2010210 *	2109060
Gasket, Return	2010317	2109053	2010213	2109059
Bonnet, Return	2010315 *	2109055	2010212 *	2109061
Anode-Zinc (2)	2010283	2109057	2010283	2109057
Regulator-Temperature (TRERICE), Incl. Next Part	90AC192	90AC192	90AC192	90AC192
ASM Stem Packing	2010803	2010803	2010803	2010803
OR				
Regulator-Temperature (POWERS), Incl. Next Part	90AR97	90AR97	90AR97	90AR97
ASM Stem Packing	2109051	2109051	2109051	2109051
Valve-Solenoid, Magnetic Water (NEMA I)	90AC118	90AC118	90AC118	90AC118
Valve-Solenoid, Magnetic Water (NEMA IV)	90AC103	90AC103	90AC103	90AC103
Valve-Solenoid, Magnetic Water (Explosion- Proof)	90AC103	90AC103	90AC103	90AC103
Bushing, Heat Exchanger Oil Inlet & Outlet (1-1/2 x 1") (2)	-----	-----	64E13G	64E13G
Bushing, Heat Exchanger Water Inlet & Outlet (3/4 x 1") (2)	-----	-----	64E16G	64E16G
Aftercooler, Incl. Next 6 Parts	-----	201ESG292	-----	201ESG292
Bracket, Mounting (2)	-----	2109062	-----	2109062
Gasket, Inlet-Outlet	-----	2109058	-----	2109058
Bonnet, Inlet-Outlet	-----	2109060	-----	2109060
Gasket, Return	-----	2109059	-----	2109059
Bonnet, Return	-----	2109061	-----	2109061
Anode-Zinc (2)	-----	2109057	-----	2109057
Support, Aftercooler	-----	209ESG165	-----	209ESG165

* When purchasing Bonnet for "YOUNG" Heat Exchangers, Gasket and Pipe Plugs are included.

SELECTIVE ITEMS - WATER-COOLED UNITS
(SALT WATER SERVICE)

PART NAME & DESCRIPTION	30 & 40 HP		50 HP	
	(YOUNG)	(THERMAL TRANSFER)	(YOUNG)	(THERMAL TRANSFER)
Heat Exchanger, Incl. Next 6 Parts	201ESG349	204ESG349	-----	201ESJ349
Bracket, Mounting (2)	2010319	2109056	-----	2109062
Gasket, Inlet-Outlet	2010316	2109052	-----	2109058
Bonnet, Inlet-Outlet	2010818 *	2109072	-----	2109075
Gasket, Return	2010317	2109053	-----	2109059
Bonnet, Return	2010819 *	2109073	-----	2109074
Anode-Zinc (2)	2010283	2109057	-----	2109057
(USE BRASS FITTINGS)				
Regulator-Temperature (TRERICE), Incl. Next Part	90AR36	90AR36	-----	90AR36
ASM Stem Packing	2010803	2010803	-----	2010803
OR				
Regulator-Temperature (POWERS), Incl. Next Part	90AR98	90AR98	-----	90AR98
ASM Stem Packing	2109051	2109051	-----	2109051
Aftercooler, Incl. Next 6 Parts	-----	202ESG292	-----	202ESG292
Bracket, Mounting (2)	-----	2109062	-----	2109062
Gasket, Inlet-Outlet	-----	2109058	-----	2109058
Bonnet, Inlet-Outlet	-----	2109075	-----	2109075
Gasket, Return	-----	2109059	-----	2109059
Bonnet, Return	-----	2109074	-----	2109074
Anode-Zinc (2)	-----	2109057	-----	2109057
Support, Aftercooler	-----	209ESG165	-----	209ESG165

* When purchasing Bonnet for "YOUNG" Heat Exchangers, Gasket and Pipe Plugs are included.

OIL FILTER, MIN. PRESSURE & THERMAL VALVES

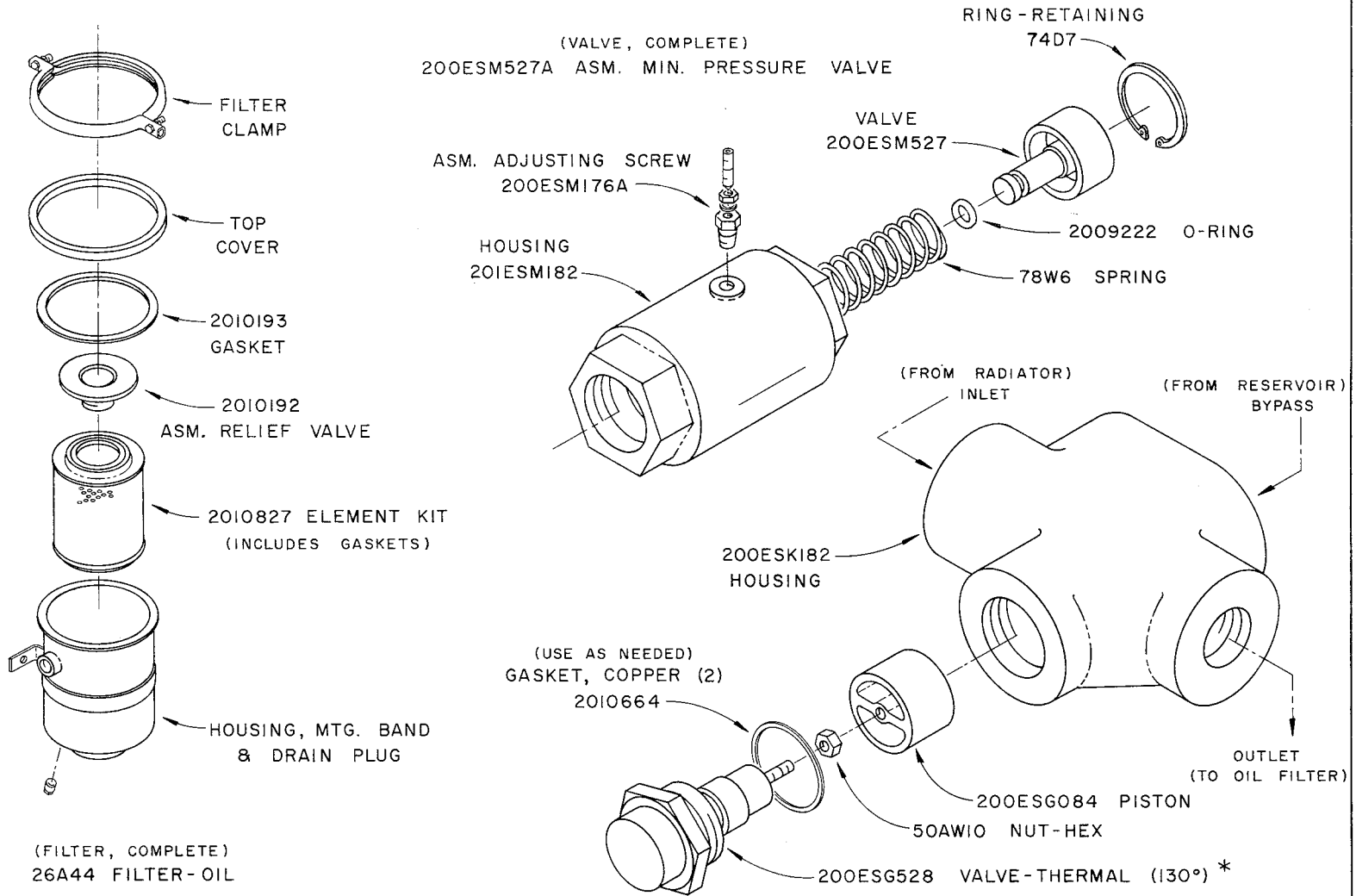

* THERMAL VALVE SHOWN ABOVE IS FOR 130° RANGE. IF 150° RANGE IS DESIRED, ORDER KIT ESG66784 WHICH INCLUDES 201ESG528 (150° VALVE) PLUS NUT, PISTON & COPPER GASKETS.

C75769

RADIATOR GROUP (AIR-COOLED)
(UNITS WITHOUT AFTERCOOLER)

139-BI-7(F)

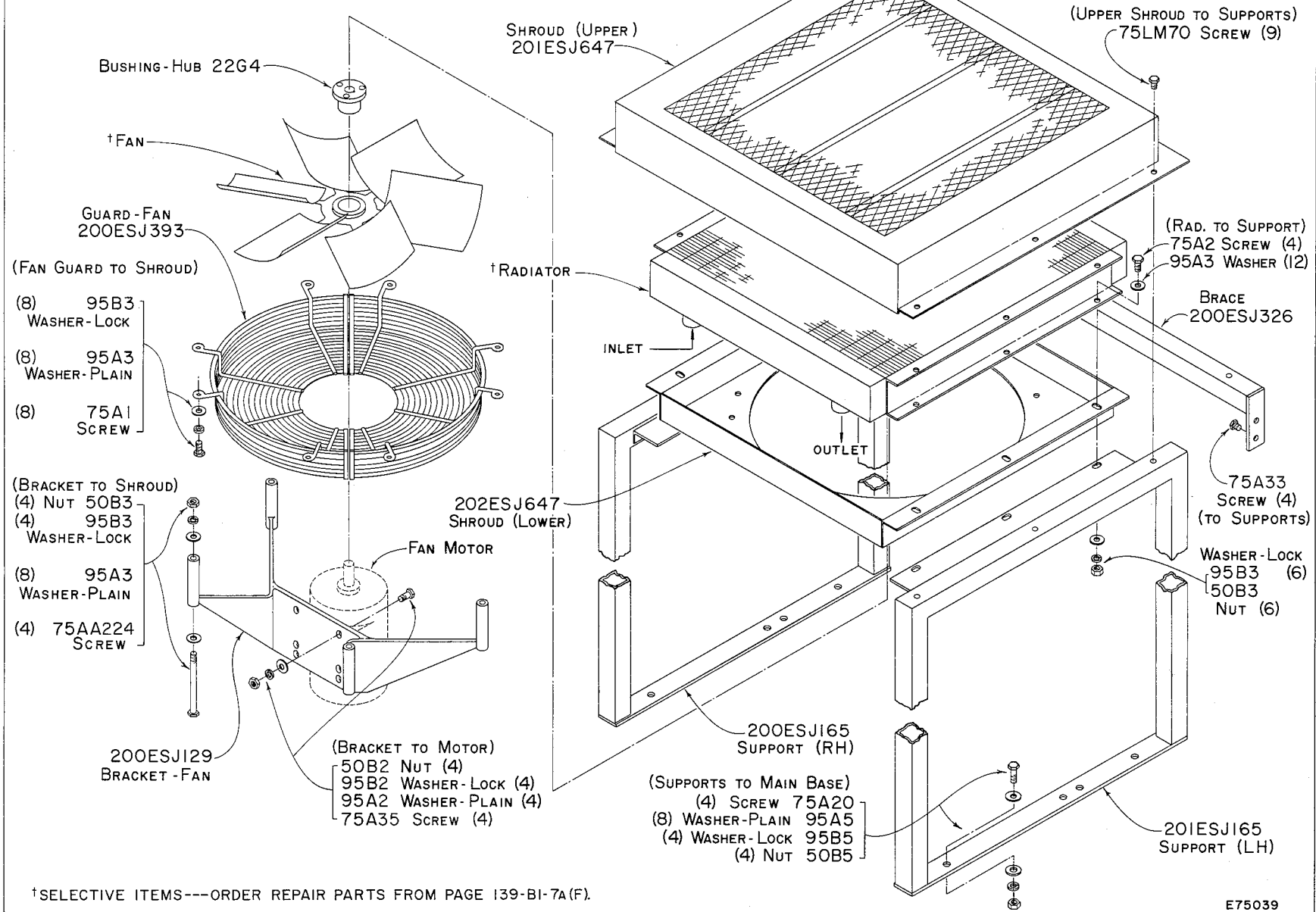

†SELECTIVE ITEMS---ORDER REPAIR PARTS FROM PAGE 139-BI-7A(F).

E75039

RADIATOR GROUP
(Selective Items)

PART NAME & DESCRIPTION	30 HP	40 HP	50 HP
<p style="text-align: center;">(60 Hz)</p> <p>Radiator Fan, Radiator Bushing-Hub</p>	<p>200ESH300 200ESG701 22G4</p>	<p>200ESH300 200ESG701 22G4</p>	<p>201ESJ300 200ESJ701 22G4</p>
<p style="text-align: center;">(50 Hz)</p> <p>Radiator Fan, Radiator Bushing-Hub</p>	<p>200ESH300 200ESJ701 22G4</p>	<p>200ESH300 200ESG701 22G4</p>	<p>201ESJ300 200ESG701 22G4</p>
<p>* REMOTE MOUNTED RADIATOR</p> <p>(For Information and/or Repair consult the Quincy Sales and Service Office.)</p>	<p>-----</p>	<p>-----</p>	<p>-----</p>

* Optional Construction.

RADIATOR GROUP (AIR-COOLED)
(UNITS WITH AFTERCOOLER)

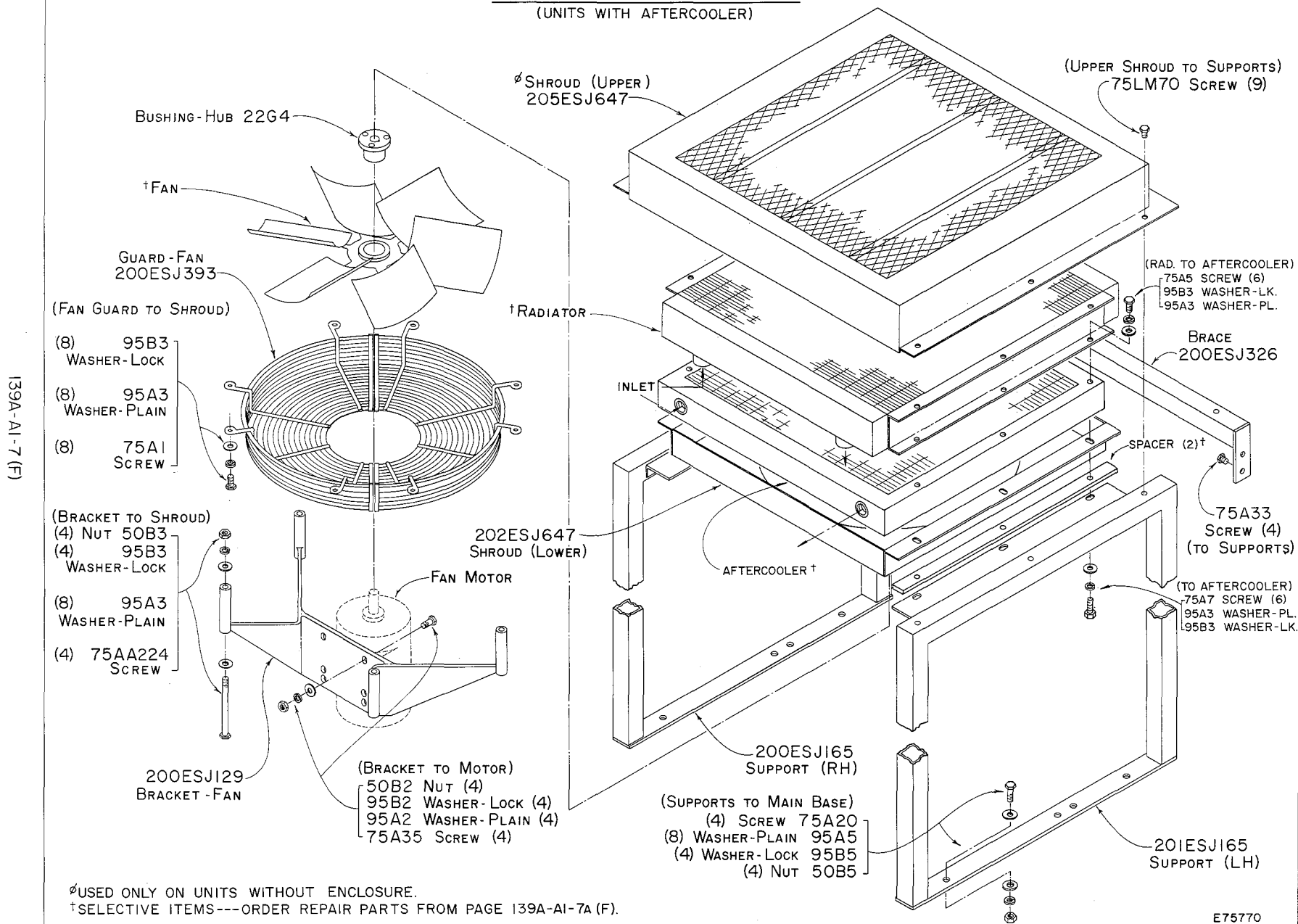

ØUSED ONLY ON UNITS WITHOUT ENCLOSURE.

†SELECTIVE ITEMS---ORDER REPAIR PARTS FROM PAGE 139A-AI-7A (F).

E75770

139A-AI-7(F)

RADIATOR GROUP

(Selective Items)

PART NAME & DESCRIPTION	30 HP	40 HP	50 HP
(60 Hz)			
Radiator Fan, Radiator Bushing-Hub	200ESH300 205ESG701 22G4	200ESH300 205ESG701 22G4	201ESJ300 205ESG701 22G4
Aftercooler Baffle (2) Spacer (2)	200ESG292 200ESG840 201ESG144	200ESG292 200ESG840 201ESG144	200ESJ292 200ESG840 -----
(50 Hz)			
Radiator Fan, Radiator Bushing-Hub	200ESH300 200ESJ701 22G4	200ESH300 200ESG701 22G4	201ESJ300 200ESG701 22G4
<p>* REMOTE MOUNTED RADIATOR</p> <p>(For Information and/or Repair consult the Quincy Sales and Service Office.)</p>	-----	-----	-----

* Optional Construction.

COUPLING & BASE

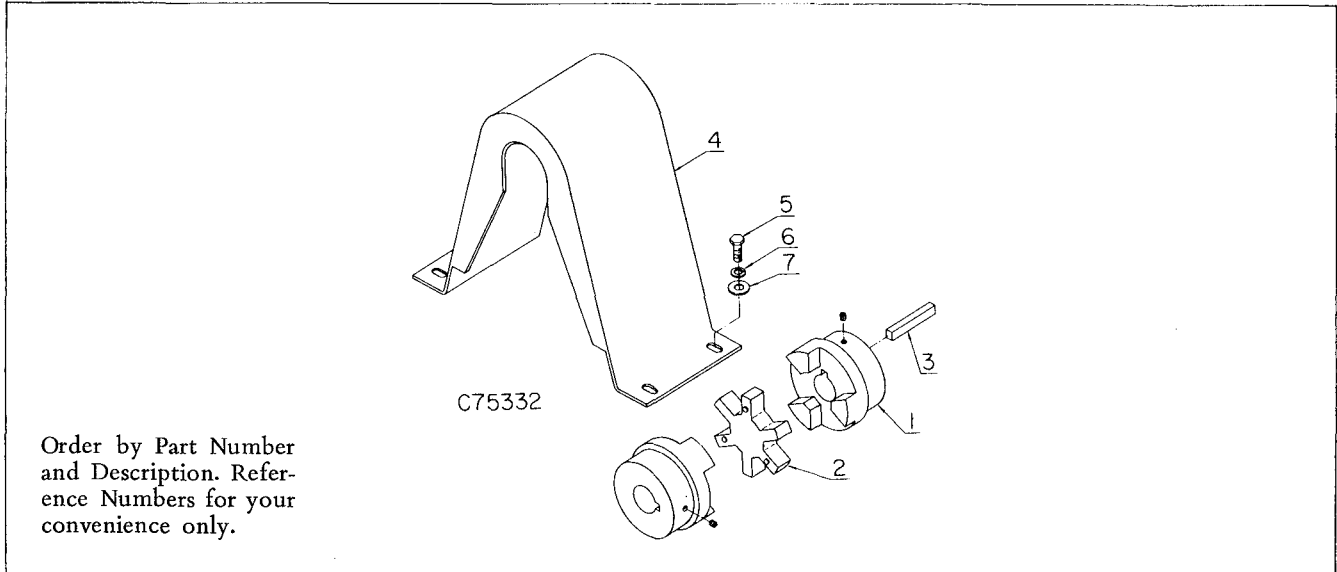

Order by Part Number and Description. Reference Numbers for your convenience only.

REF. NO.	PART NAME & DESCRIPTION	QTY.	30 HP	40 & 50 HP
COUPLING GROUP				
1	Coupling, Incl. Ref. No. 2	1	51K12	51K11
2	Spider	1	2010385	2010218
3	Key, to Compressor	1	35B35	35B35
4	ASM Coupling Guard	1	203ESG339A	203ESG339A
5	Screw, Guard to Base (3/8 x 1)	4	75A1	75A1
6	Washer-Lock	4	95B3	95B3
7	Washer-Plain	4	95A3	95A3
BASE & MOUNTING GROUP				
	Base	1	204ESG285	202ESH285
	Screw, Motor to Base	4	75A54	75A47
	Washer-Lock	4	95B5	95B7
	Washer-Plain	4	95A5	95A7
	Nut-Hex	4	50B5	50B7
	Screw, Compressor to Base (1/2 x 1)	4	75A4	75A4
	Washer-Lock (1/2)	4	95B5	95B5
	Shim, Motor to Base (.003)	2	77E11	77E11
	Shim, Motor to Base (.008)	3	77E12	77E12
	Shim, Motor to Base (.031)	1	77E13	77E13
	Shim, Motor to Base (.062)	1	77E14	77E14
	Support, Instrument Panel (NEMA I)	1	207ESG146	207ESG146
	Support, Instrument Panel (NEMA IV)	1	202ESG146	202ESG146
	Screw, Support to Base (3/8 x 1-1/4)	4	75A2	75A2
	Washer-Plain (3/8)	8	95A3	95A3
	Washer-Lock (3/8)	4	95B3	95B3
	Nut-Hex (3/8)	4	50B3	50B3
	Screw, Instrument Panel to Support (10-32 x 1/2)	10	75LM39	75LM39
	* METAL ENCLOSURE GROUP (For Information Or Repair Consult Quincy Sales and Service Office)		-----	-----

* FIBERGLASS ENCLOSURES DISCONTINUED AS OF MARCH, 1976.

COUPLING & BASE

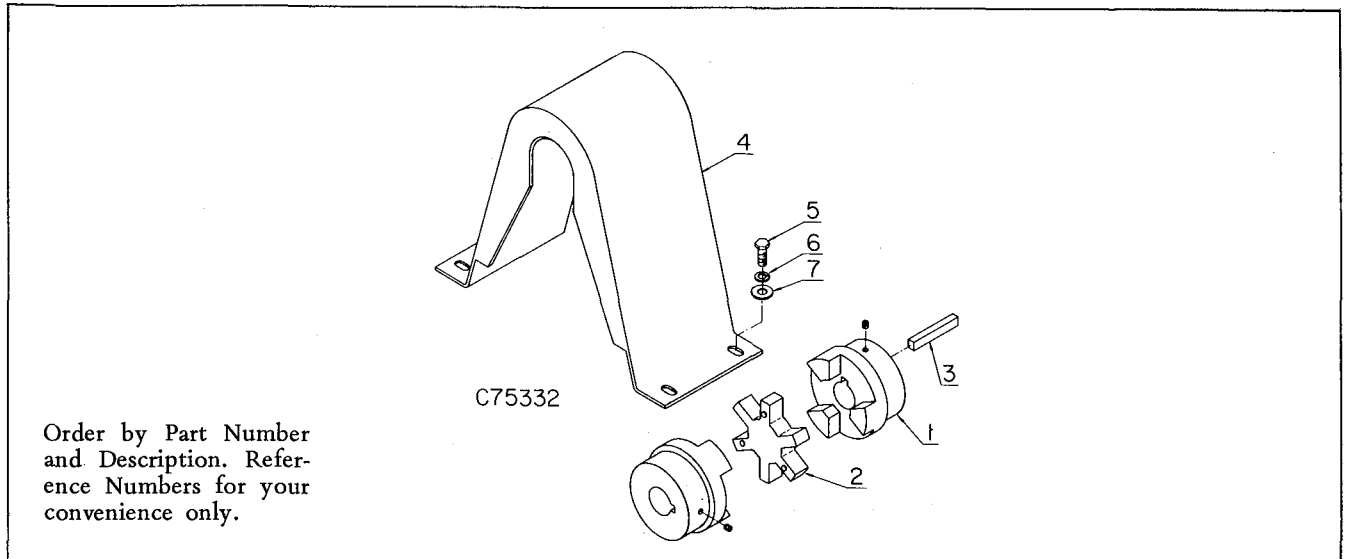

Order by Part Number and Description. Reference Numbers for your convenience only.

REF. NO.	PART NAME & DESCRIPTION	QTY.	30 HP	40 & 50 HP
COUPLING GROUP				
1	Coupling, Incl. Ref. No. 2	1	51K12	51K11
2	Spider	1	2010385	2010218
3	Key, to Compressor	1	35B35	35B35
4	Guard-Coupling	1	201ESG339	201ESG339
5	Screw, Guard to Subbase (3/8 x 1)	4	75A1	75A1
6	Washer-Lock	4	95B3	95B3
7	Washer-Plain	4	95A3	95A3
BASE & MOUNTING GROUP				
	Base, Main	1	201ESG285	201ESG285
	Base (Subbase)	1	202ESG285	200ESJ285
	Screw, Motor to Subbase	4	75A54	75A47
	Washer-Lock	4	95B5	95B7
	Washer-Plain	4	95A5	95A7
	Nut-Hex	4	50B5	50B7
	Mounting-Vibration	4	49C17	49C17
	Screw, Mounting to Base (5/8 x 4-1/2)	4	75A168	75A168
	Washer-Plain (5/8)	20	95A7	95A7
	Locknut (5/8)	4	50AP10	50AP10
	Screw, Compressor to Subbase (1/2 x 1)	4	75A4	75A4
	Washer-Lock (1/2)	4	95B5	95B5
	Shim, Motor to Subbase (.003)	2	77E11	77E11
	Shim, Motor to Subbase (.008)	3	77E12	77E12
	Shim, Motor to Subbase (.031)	1	77E13	77E13
	Shim, Motor to Subbase (.062)	1	77E14	77E14
	Support, Instrument Panel (NEMA I)	1	200ESG146	200ESG146
	Support, Instrument Panel (NEMA IV)	1	202ESG146	202ESG146
	Screw, Support to Main Base (3/8 x 1-1/4)	4	75A2	75A2
	Washer-Plain (3/8)	8	95A3	95A3
	Washer-Lock (3/8)	4	95B3	95B3
	Nut-Hex (3/8)	4	50B3	50B3
	Screw, Instrument Panel to Support (10-32 x 1/2)	10	75LM39	75LM39
	ENCLOSURE GROUP (For Information Or Repair Consult Quincy Sales and Service Office)		-----	-----

CONTROL GROUPS (30 THRU 100 HP)

CONTROL GROUPS	CONSTANT SPEED		AUTOMATIC START/STOP		DUAL		TIMED DUOMATIC	
	NEMA 1	NEMA 4	NEMA 1	NEMA 4	NEMA 1	NEMA 4	NEMA 1	NEMA 4
SELECTIVE *								
Bracket, Mounting	201ESG108	202ESG108	201ESG108	202ESG108	201ESG108	202ESG108	201ESG108	202ESG108
Panel, Gauge	200ESG386	200ESG386	200ESG386	200ESG386	201ESG386	201ESG386	202ESG386	202ESG386
Panel, Instrument	211ESG386	-----	211ESG386	-----	211ESG386	-----	207ESG386	-----
Box-Control	200ESG179	201ESG179	200ESG179	201ESG179	200ESG179	201ESG179	200ESG179	202ESG179
Switch, Control	24CA46	24CA46	24CA47	24CA47	24CA48	24CA48	24CA49	24CA49
Gasket, Cover	2009592	-----	2009592	-----	2009592	-----	2009592	-----
Hourmeter (60 Hz)	2009369	2009369	2009369	2009369	2009369	2009369	2009369	2009369
Hourmeter (50 Hz)	2009370	2009370	2009370	2009370	2009370	2009370	2009370	2009370
Gasket, Hourmeter	-----	201ESK715	-----	201ESK715	-----	201ESK715	-----	201ESK715
Boot, Transparent (Push Button or Pilot Light)	-----	24CA281	-----	24CA281	-----	24CA281	-----	24CA281
Valve-Solenoid (Unloader)	-----	-----	-----	-----	-----	-----	90AC183	2009442
Valve-Check (In Blowdown Line)	-----	-----	-----	-----	-----	-----	2009283	2009283
Valve-Control (In Comp. Sump)	-----	-----	-----	-----	-----	-----	2007300	2007300
Relay (Adjustable Timer)	-----	-----	-----	-----	-----	-----	24A482	24A482
Box-Control, Timer	-----	-----	-----	-----	-----	-----	-----	200ESK179
Gasket, Control Box	-----	-----	-----	-----	-----	-----	-----	202ESK715
Cover, Plexiglass	-----	-----	-----	-----	-----	-----	-----	202ESK225
Gasket, Cover	-----	-----	-----	-----	-----	-----	-----	203ESK715
OPTIONAL ϕ	LOW OIL PRESSURE SHUTDOWN				WEATHER-TIGHT (NEMA 4, 5, 12)			
	NEMA 1		NEMA 4		LEAD-LAG (2 COMP.)		LEAD-LAG (3 COMP.)	
Switch, Pressure Block-Contact **	88A302 (Oil) 24CA217		88A303 (Oil) 24CA217		2009006 (Air) -----		2009006 (Air) (2) -----	
Relay, Reset	24CA541		24CA541		-----		-----	
Relay (Adjustable Timer)	24CA285		24CA285		-----		-----	
Box, Control	206ESG179		206ESG179		204ESG179		205ESG179	
Switch (3 Pole - 2 Throw)	-----		-----		24CA448		-----	
Switch (6 Pole - 3 Throw)	-----		-----		-----		24CA449	

* NEMA 1 Illustrations for Panels and Tubing (with mounting parts) are shown on Pages 12 thru 15a. For accuracy in servicing units equipped with other than NEMA 1 Controls, refer Order Ticket or consult Quincy Sales and Service Office.
 ** Contact Block shown above is used with Duomatic Control only. Contact Block 24CA543 is used with other controls.
 ϕ Additional Equipment - items shown are used in conjunction with Specified Control Group.

139-C1-10

GARDNER-DENVER COMPRESSOR

139-C1-10
Revised May, 1976

CONTROL PANEL GROUP (CONSTANT SPEED) *

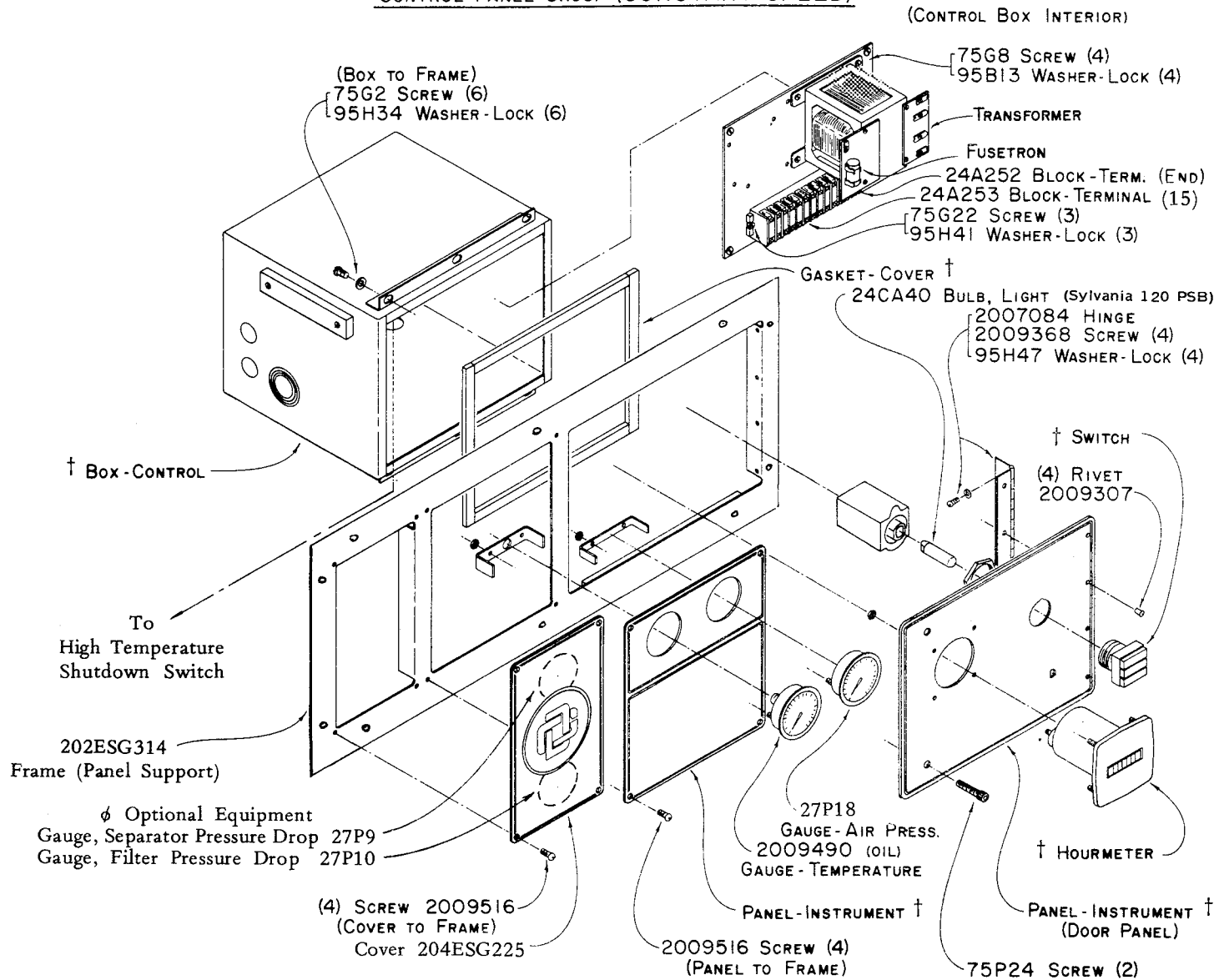

* For Constant Speed Control Tubing see Page 139-B1-12a.
† Order Repair Parts from Page 139-C1-10 — Items are Selective.
⊕ Furnished only when unit is equipped with Pressure Drop Panel Group.

139-B1-12

CONTROL TUBING (CONSTANT SPEED)

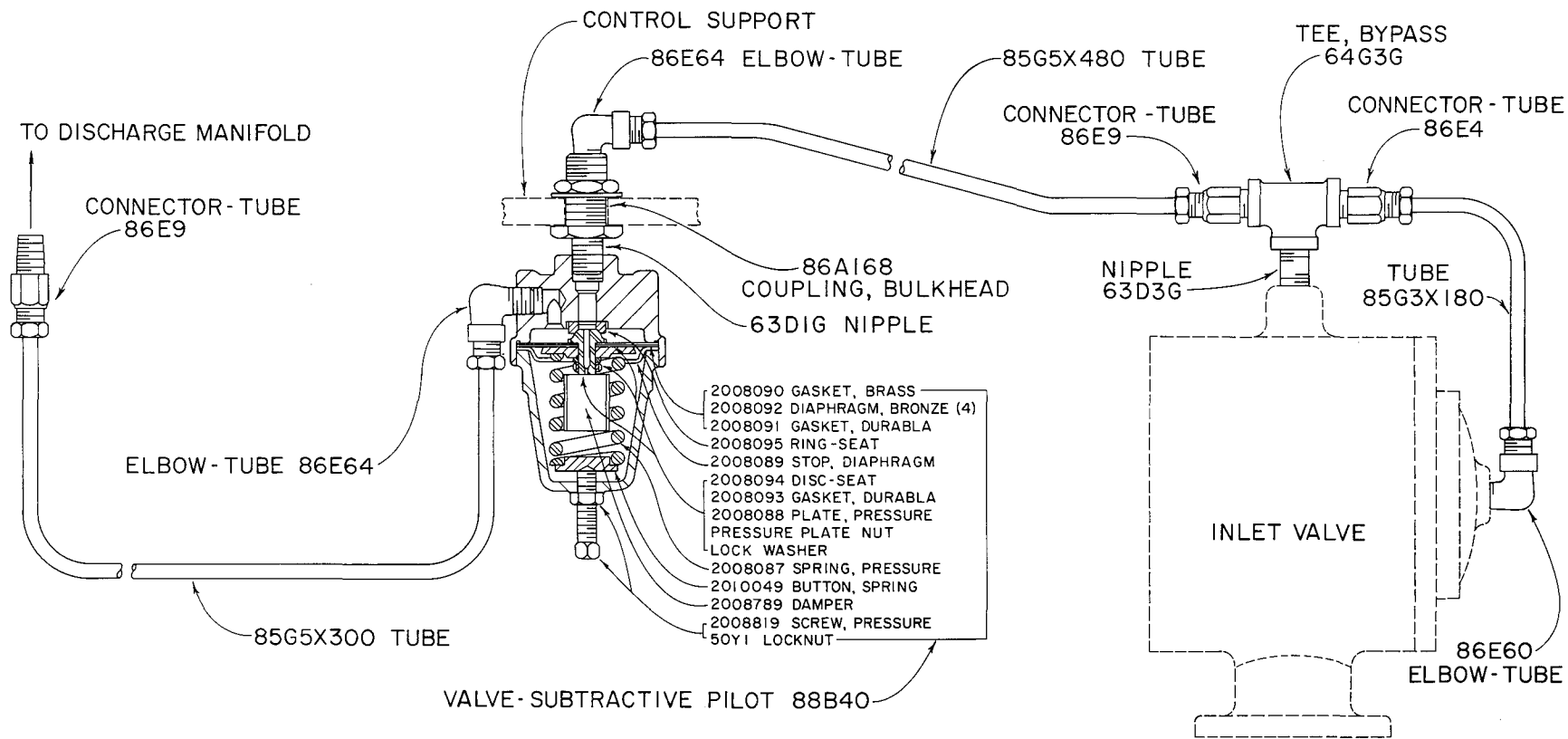

139-BI-12A

D75097

CONTROL PANEL GROUP (AUTOMATIC START-STOP) *

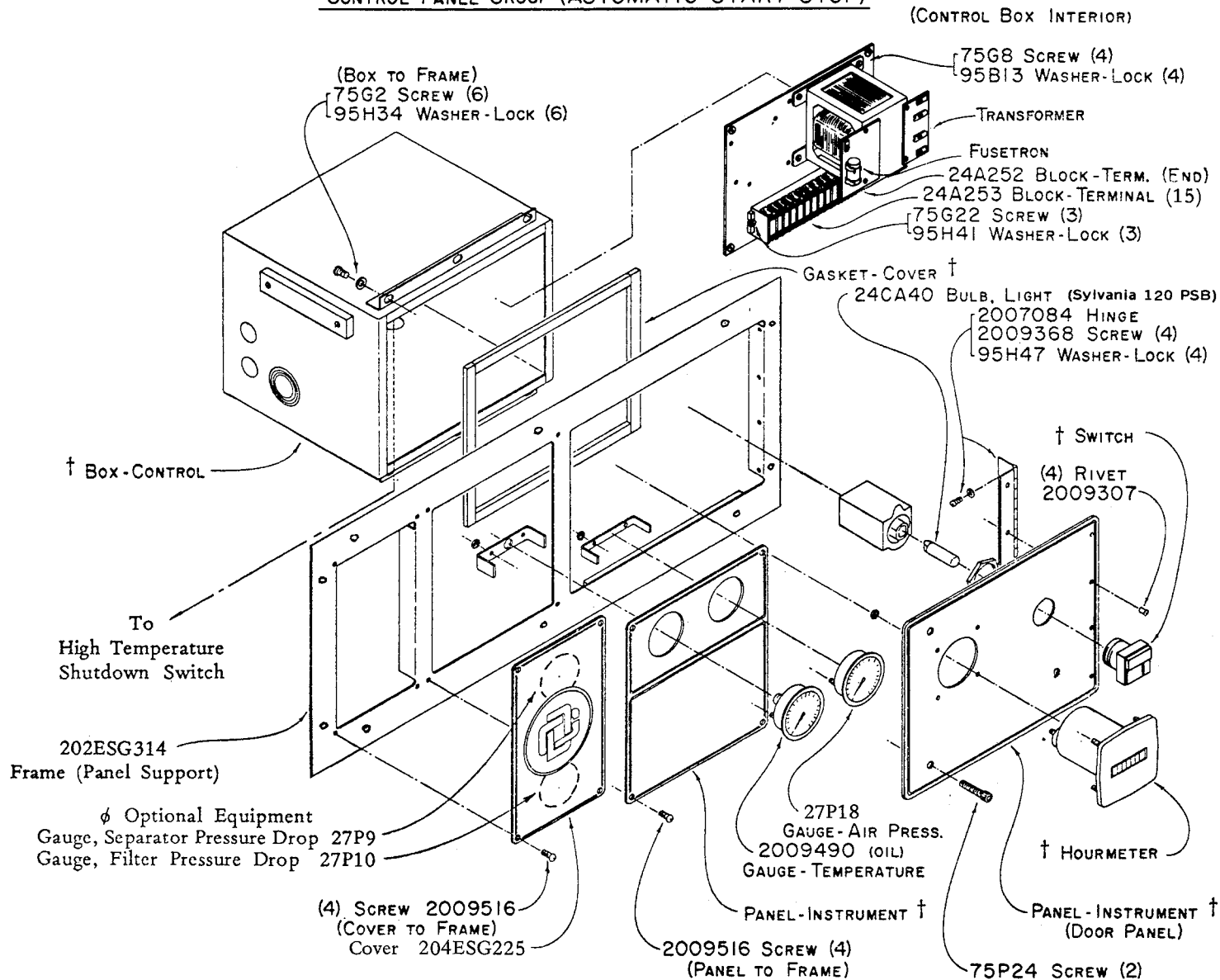

* For Automatic Start/Stop Control Tubing see Page 139-B1-13a.
† Order Repair Parts from Page 139-C1-10 - Items are Selective.
φ Furnished only when unit is equipped with Pressure Drop Panel Group.

139-B1-13

CONTROL TUBING (AUTOMATIC START-STOP)

NOT SHOWN:
(INLET HSG. BYPASS)
86E60 ELBOW-TUBE (2)
85G3X120 TUBE

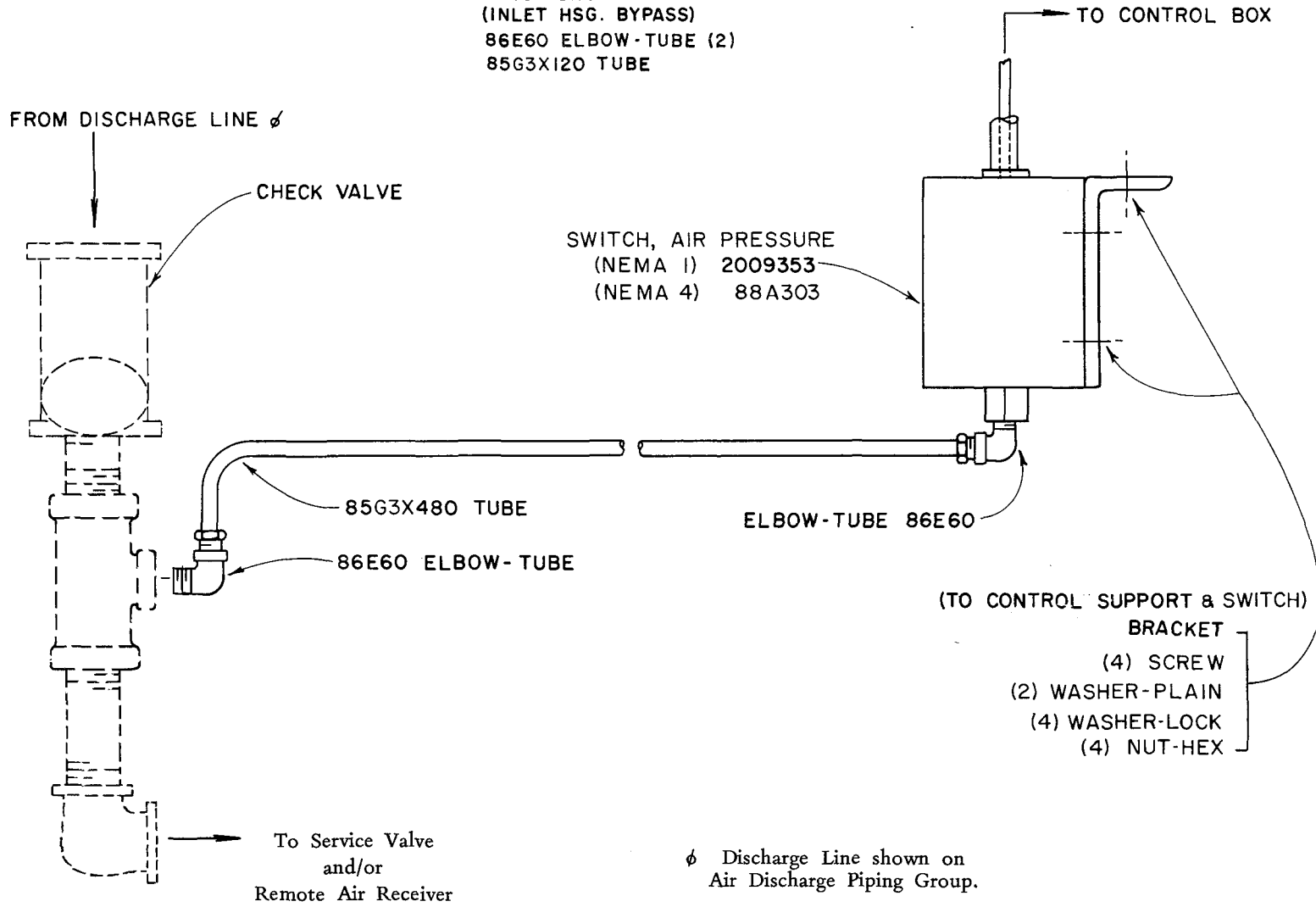

139-B1-13A

CONTROL PANEL GROUP (DUAL CONTROL) *

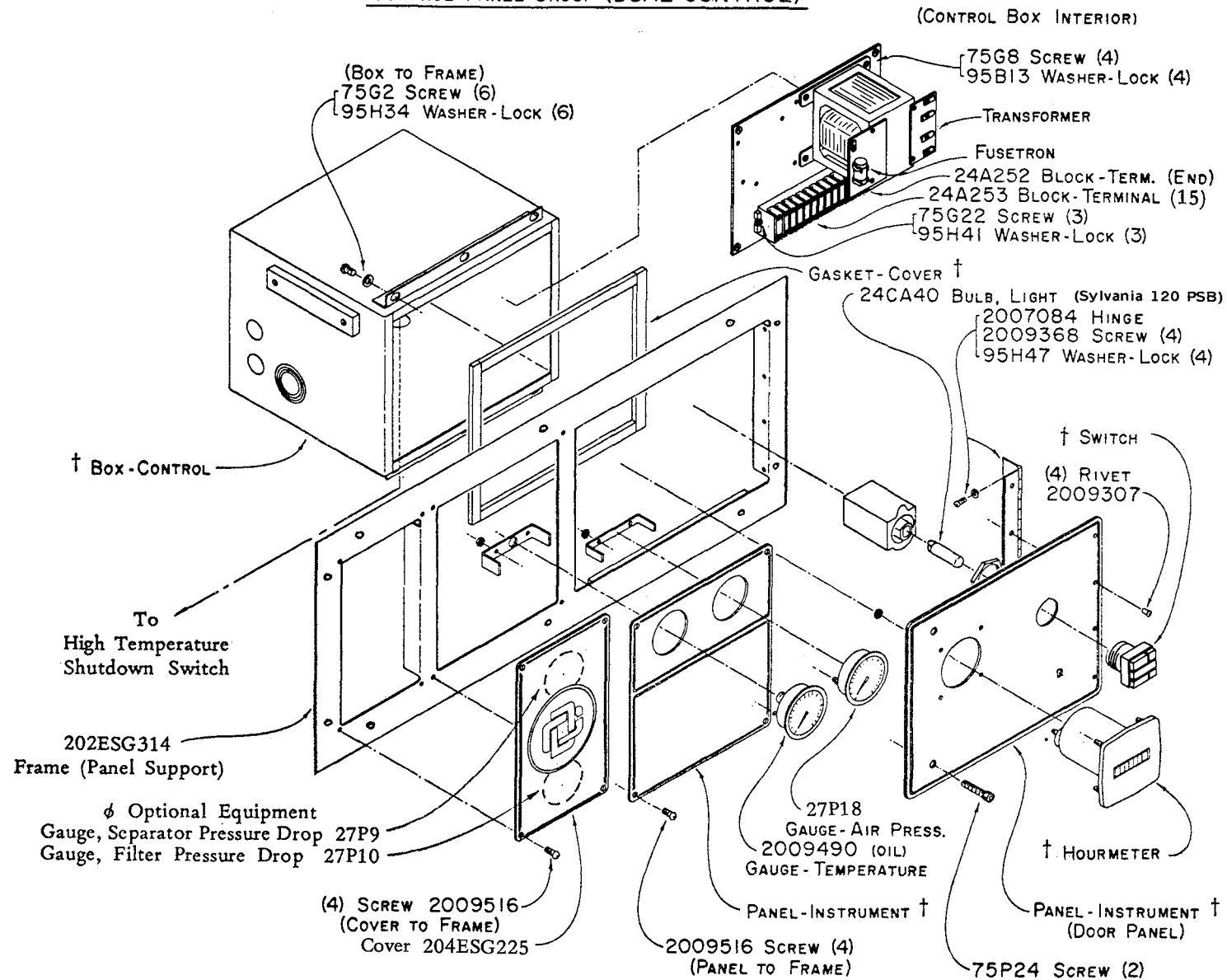

* For Dual Control Tubing see Page 139-B1-14a.
 † Order Repair Parts from Page 139-C1-10 - Items are Selective.
 φ Furnished only when unit is equipped with Pressure Drop Panel Group.

139-B1-14

139-B1-14
 Revised May, 1976

CONTROL TUBING (DUAL CONTROL)

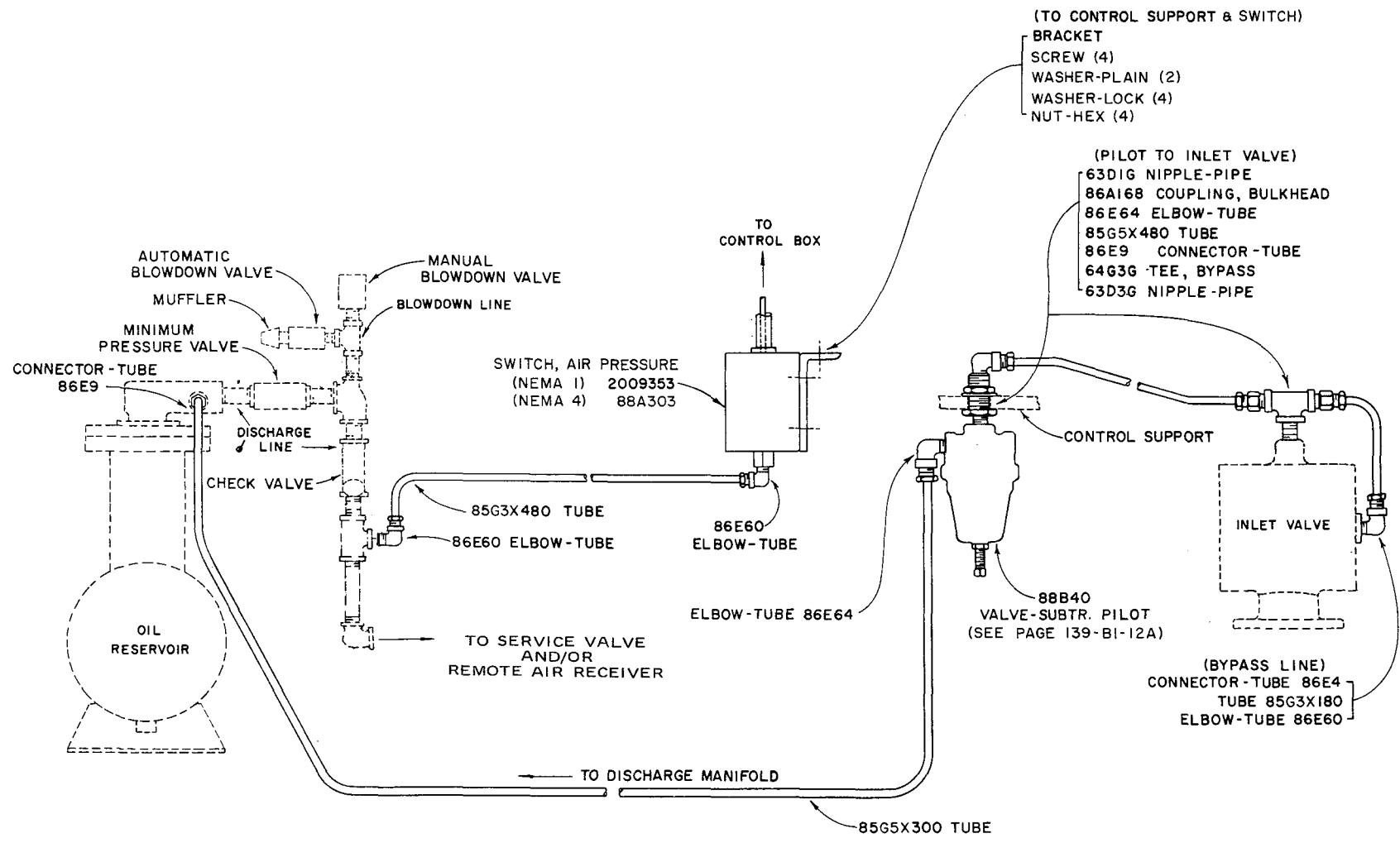

∅ DISCHARGE LINE SHOWN ON AIR DISCHARGE PIPING GROUP.

139-B1-14A

CONTROL PANEL GROUP (DUOMATIC) *

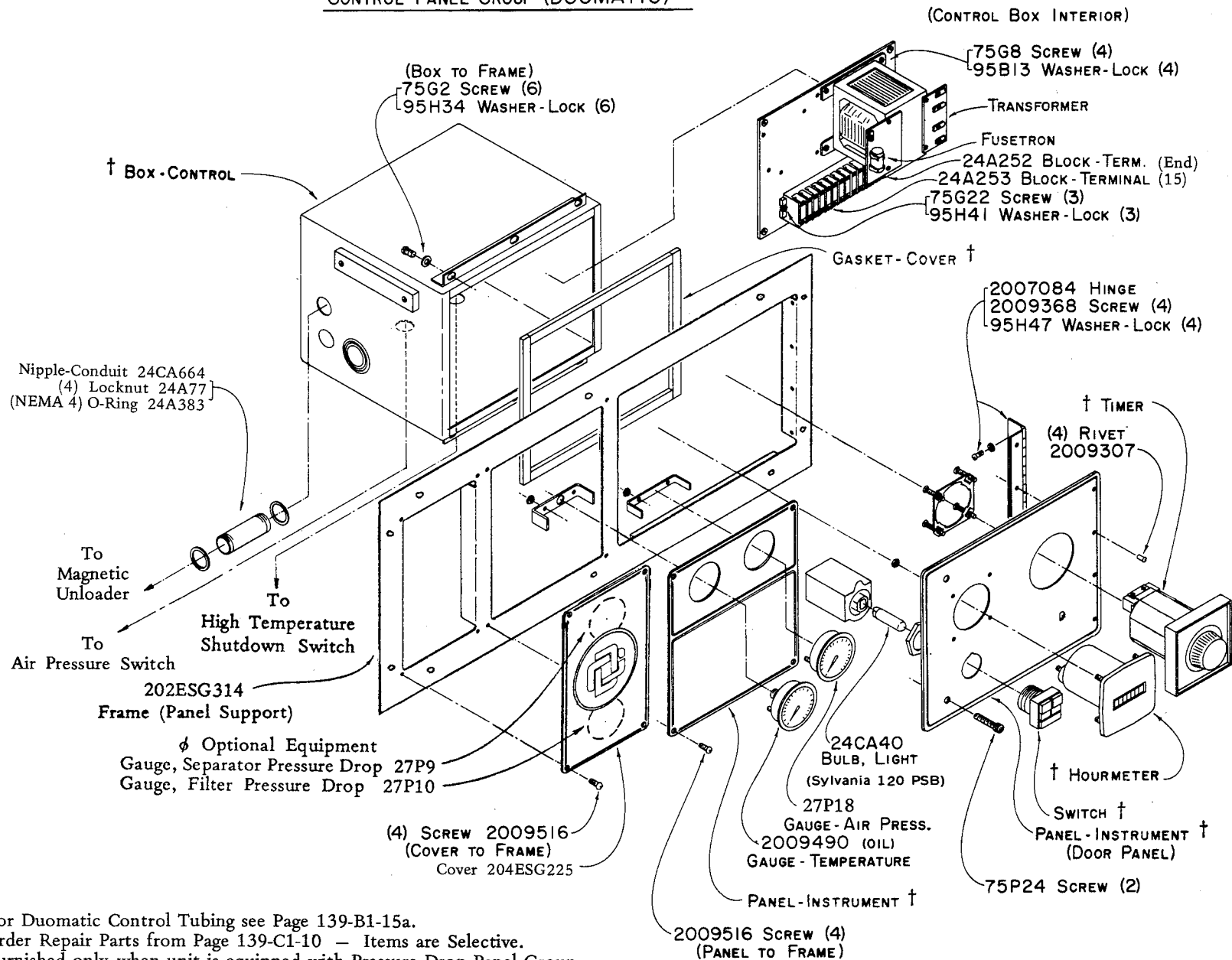

* For Duomatic Control Tubing see Page 139-B1-15a.
 † Order Repair Parts from Page 139-C1-10 — Items are Selective.
 φ Furnished only when unit is equipped with Pressure Drop Panel Group.

139-B1-15

GARDNER-DENVER COMPRESSOR

139-B1-15
 Revised May, 1976

CONTROL TUBING (DUOMATIC)

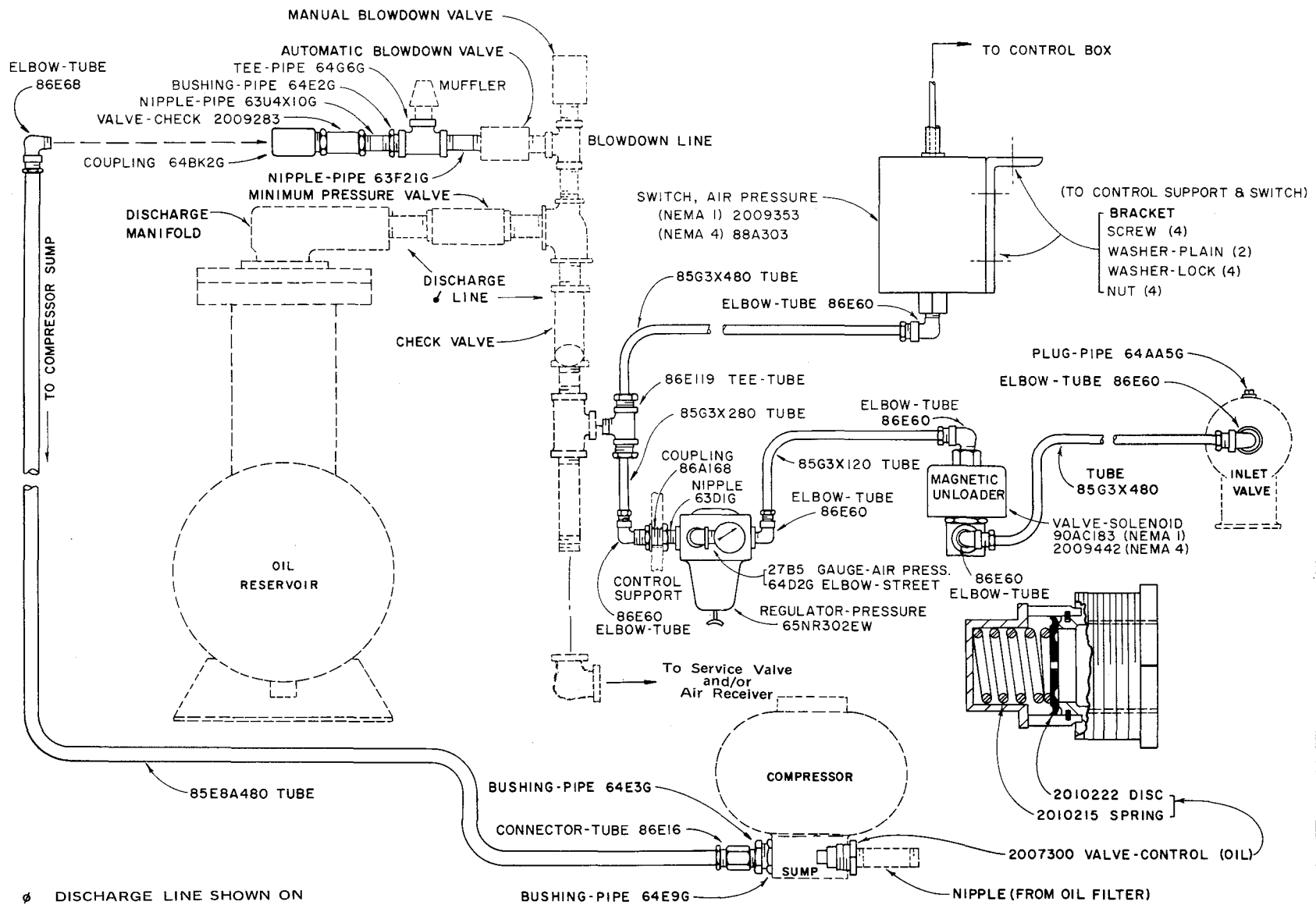

DISCHARGE LINE SHOWN ON AIR DISCHARGE PIPING GROUP.

139-B1-15A

RECOMMENDED SPARES - ESG, ESH & ESJ

The following kits are separated according to service and locations. These are made available to aid the customer in stocking parts to allow on-site maintenance and/or repair. Quantities shown are for one unit only. It is the responsibility of the Owner-Operator to apply a multiplier for multiple units, operating conditions and/or for hours of operation. Refer to Instruction Manual for recommended replacement time for critical parts. **KITS DO NOT INCLUDE OIL SEPARATORS, ELECTRICAL OR CONTROL ITEMS - THESE MUST BE PURCHASED SEPARATELY.**

Ordering Instructions

KIT NO. 1 - Routine Maintenance: These are suggested as the minimum quantity of parts a customer should stock. They are usually the first items which require renewal. Order quantities of this kit to suit your requirements or particular service. One kit contains three (3) oil filter elements which require changing at least every 1000 hours under normal conditions.

KIT NO. 2 - Domestic Service: These are suggested as the minimum spares a customer should stock for continuous operation for one year. When ordering for this service, order Kits No. 1 and 2.

KIT NO. 3 - Isolated Domestic or Export Service: These are suggested as the minimum spares a customer should stock for continuous operation. These parts include those which possibly would need renewal in an overhaul. When ordering for this service, order Kits No. 1, 2 and 3.

APPLY THE PROPER MULTIPLIER BASED ON NUMBER OF UNITS AND HOURS OF OPERATION;
Example: For four (4) units, Four (4) of Kit No. 1 and only One (1) each of Kits 2 and 3 may be sufficient.

COMPRESSOR MODEL		ESG, ESH 3000	ESJ 3000	ESG, ESH, ESJ 9000	ESG, ESH, ESJ 18000
HOURS OF OPERATION					
PART NO. (Complete Kit) For Units With:					
Standard Air Filter		ESG66021	ESJ66022	ESG66023	ESG66963
Heavy-Duty Air Filter		ESG66186	ESG66186	-----	-----
		KIT NO. 1		KIT NO. 2	KIT NO. 3
Description	Page No.	Qty. Per Kit		Qty. Per Kit	Qty. Per Kit
KIT NO. 1 ROUTINE MAINTENANCE					
Air Filter Element	139 -2	1			
Oil Filter Element Kit	139 -6	3			
KIT NO. 2 DOMESTIC SERVICE					
Compressor Shaft Seal	139 -1			1	
Seal Housing O-Ring	139 -1			1	
Inlet Valve	139 -2			1	
Inlet Valve Spring	139 -2			1	
Inlet Valve Piston Spring	139 -2			1	
Inlet Valve Packing	139 -2			1	
Gasket Kit	139 -1a			1	
KIT NO. 3 ISOLATED DOMESTIC OR EXPORT SERVICE					
Gear Drive Ball Bearing (Inner)	139 -1				1
Gear Drive Ball Bearing (Outer)	139 -1				1
Roller Bearing	139 -1				2
Ball Bearing	139 -1				4
Gasket Kit	139 -1a				1

† EFFECTIVE WITH SERIAL NUMBER 673112.

RECOMMENDED SPARES — ESG, ESH & ESJ

The following kits are separated according to service and locations. These are made available to aid the customer in stocking parts to allow on-site maintenance and/or repair. Quantities shown are for one unit only. It is the responsibility of the Owner-Operator to apply a multiplier for multiple units, operating conditions and/or for hours of operation. Refer to Instruction Manual for recommended replacement time for critical parts. **KITS DO NOT INCLUDE OIL SEPARATORS, ELECTRICAL OR CONTROL ITEMS — THESE MUST BE PURCHASED SEPARATELY.**

Ordering Instructions

KIT NO. 1 — Routine Maintenance: These are suggested as the minimum quantity of parts a customer should stock. They are usually the first items which require renewal. Order quantities of this kit to suit your requirements or particular service. One kit contains three (3) oil filter elements which require changing at least every 1000 hours under normal conditions.

KIT NO. 2 — Domestic Service: These are suggested as the minimum spares a customer should stock for continuous operation for one year. When ordering for this service, order Kits No. 1 and 2.

KIT NO. 3 — Isolated Domestic or Export Service: These are suggested as the minimum spares a customer should stock for continuous operation. These parts include those which possibly would need renewal in an overhaul. When ordering for this service, order Kits No. 1, 2 and 3.

APPLY THE PROPER MULTIPLIER BASED ON NUMBER OF UNITS AND HOURS OF OPERATION;
Example: For four (4) units, Four (4) of Kit No. 1 and only One (1) each of Kits 2 and 3 may be sufficient.

COMPRESSOR MODEL		ESG, ESH 3000	ESJ 3000	ESG, ESH, ESJ 9000	ESG, ESH, ESJ 18000
HOURS OF OPERATION					
PART NO. (Complete Kit) For Units With:					
	Standard Air Filter	ESG66021	ESJ66022	ESG66023	ESG66024
	Heavy-Duty Air Filter	ESG66186	ESG66186	-----	-----
		KIT NO. 1		KIT NO. 2	KIT NO. 3
Description	Page No.	Qty. Per Kit		Qty. Per Kit	Qty. Per Kit
KIT NO. 1 ROUTINE MAINTENANCE					
Air Filter Element	139 -2	1			
Oil Filter Element Kit	139 -6	3			
KIT NO. 2 DOMESTIC SERVICE					
Compressor Shaft Seal	139 -1			1	
Seal Housing O-Ring	139 -1			1	
Inlet Valve	139 -2			1	
Inlet Valve Spring	139 -2			1	
Inlet Valve Piston Spring	139 -2			1	
Inlet Valve Packing	139 -2			1	
Gasket Kit	139 -1a			1	
KIT NO. 3 ISOLATED DOMESTIC OR EXPORT SERVICE					
Gear Drive Ball Bearing (Inner)	139 -1				1
Gear Drive Ball Bearing (Outer)	139 -1				1
Roller Bearing	139 -1				2
Ball Bearing	139 -1				4
Gasket Kit	139 -1a				1

Gardner --- **Denver**

For additional information, contact Gardner Denver Machinery Inc.
1800 Gardner Expressway, Quincy, Illinois 62305-4024
Telephone (217) 224-8800 • FAX 217-224-7814 • Telex 404332.

Specifications subject to change without notice.

COPYRIGHT © 1994 Gardner Denver Machinery Inc.

Litho in USA.

15C-12-