GARDNER DENVER®

13-8-506
Supplement

ELECTRA-SCREW®
STATIONARY
BASE-MOUNTED
COMPRESSOR

INTERNATIONAL SUPPLEMENT

MODELS

29.8 KW (40 HP) - EDEQH

37.3 KW (50 HP) - EDEQJ

PARTS LIST

Gardner

Denver

TABLE OF CONTENTS

| GROUP NAME | PAGE NUMBER |
|--|-------------|
| Model Designations Matrix/Menu | 2 |
| General Information | 3 |
| Drive Groups (Belts, Sheaves, Hub Bushings, Relief Valves..... | 4 - 6 |
| Control/Starter Box (Part Numbers Per Voltage & H.P.) | 7 - 9 |
| Compressor Drive Motors (50/60 Hz, Std. ODP/TEFC)..... | 10 |

**MODEL EDE
40 & 50 HP AIR-COOLED BASE-MOUNTED - YD - 50/60 HZ - INTERNATIONAL
ELECTRA-SCREW® COMPRESSOR
MATRIX/MENU**

NOTICE TO CUSTOMER - To find the construction options for your compressor unit, FILL IN THE BALANCE OF LETTERS OR NUMBERS FROM YOUR UNIT NAMEPLATE.

| E | D | E | Q | C | B | 9 | 9 | | | | | |
|---|---|---|---|---|---|---|---|---|----|----|----|----|
| 1 | 2 | 3 | 4 | 5 | 6 | 7 | 8 | 9 | 10 | 11 | 12 | 13 |

COLUMN NUMBER:

Follow the line down and over from each space thus filled in to find the appropriate construction option with which your machine is equipped. The number "9" in any column space indicates "NOT APPLICABLE." The number "8" in any column space indicates SPECIAL DESIGN - REFER TO FACTORY ORDER TICKET.

COLUMNS 1, 2 & 3 - COMPRESSOR TYPE & SIZE

COLUMN 4 - TYPE OF CONSTRUCTION

- Q. Air Cooled Base Mounted

COLUMN 5 - HORSEPOWER

- H. 40 HP
- J. 50 HP

COLUMN 6 - ENGINEERING SPECIFICATION

COLUMN 7 - PRESSURE & HZ

- | | |
|---------------------|---------------------|
| A. 100 PSIG - 60 HZ | E. 100 PSIG - 50 HZ |
| B. 125 PSIG - 60 HZ | F. 125 PSIG - 50 HZ |
| C. 150 PSIG - 60 HZ | G. 150 PSIG - 50 HZ |

COLUMN 8 - CONTROL TYPE

- B. Modulating

COLUMN 9 - MAIN MOTOR CONTROL/STARTER BOX (WYE-DELTA)

- | | |
|-------------------|------------------|
| A. 40 HP-230V-N12 | I. 40 HP-230V-N4 |
| B. 40 HP-460V-N12 | J. 40 HP-460V-N4 |
| C. 40 HP-380V-N12 | K. 40 HP-380V-N4 |
| D. 40 HP-415V-N12 | L. 40 HP-415V-N4 |
| E. 50 HP-230V-N12 | M. 50 HP-230V-N4 |
| F. 50 HP-460V-N12 | N. 50 HP-460V-N4 |
| G. 50 HP-380V-N12 | O. 50 HP-380V-N4 |
| H. 50 HP-415V-N12 | P. 50 HP-415V-N4 |

COLUMN 10 - ENCLOSURE

- A. W/ENCL-HD FILTER (STD.)
- B. W/O ENCL-HD FILTER (STD.)

COLUMN 11 - SKIP - ENTER A "9" IN THIS COLUMN

COLUMN 12 - SKIP - ENTER A "9" IN THIS COLUMN

COLUMN 13 - COMPRESSOR DRIVE MOTOR (WYE-DELTA)

- | | |
|-----------------|---|
| ODP (STD. EFF.) | |
| A. 230V-60 HZ | I. LESS MOTOR - ODP/TEFC-324 FR. SIZE-40 HP |
| B. 460V-60 HZ | J. LESS MOTOR - ODP/TEFC-326 FR. SIZE-50 HP |
| C. 380V-50 HZ | |
| D. 415V-50 HZ | |
| ODP (STD. EFF.) | |
| E. 230V-60 HZ | |
| F. 460V-60 HZ | |
| G. 380V-50 HZ | |
| H. 415V-50 HZ | |

GENERAL INFORMATION

- 1) Factory filled with 8.5 gallons of AEON™ 800 Lubricant.
- 2) Refer to Parts List Book Number 13-8-506 (1st Edition) for additional information.

NOTE: Discard Square Key Furnished With Motor.

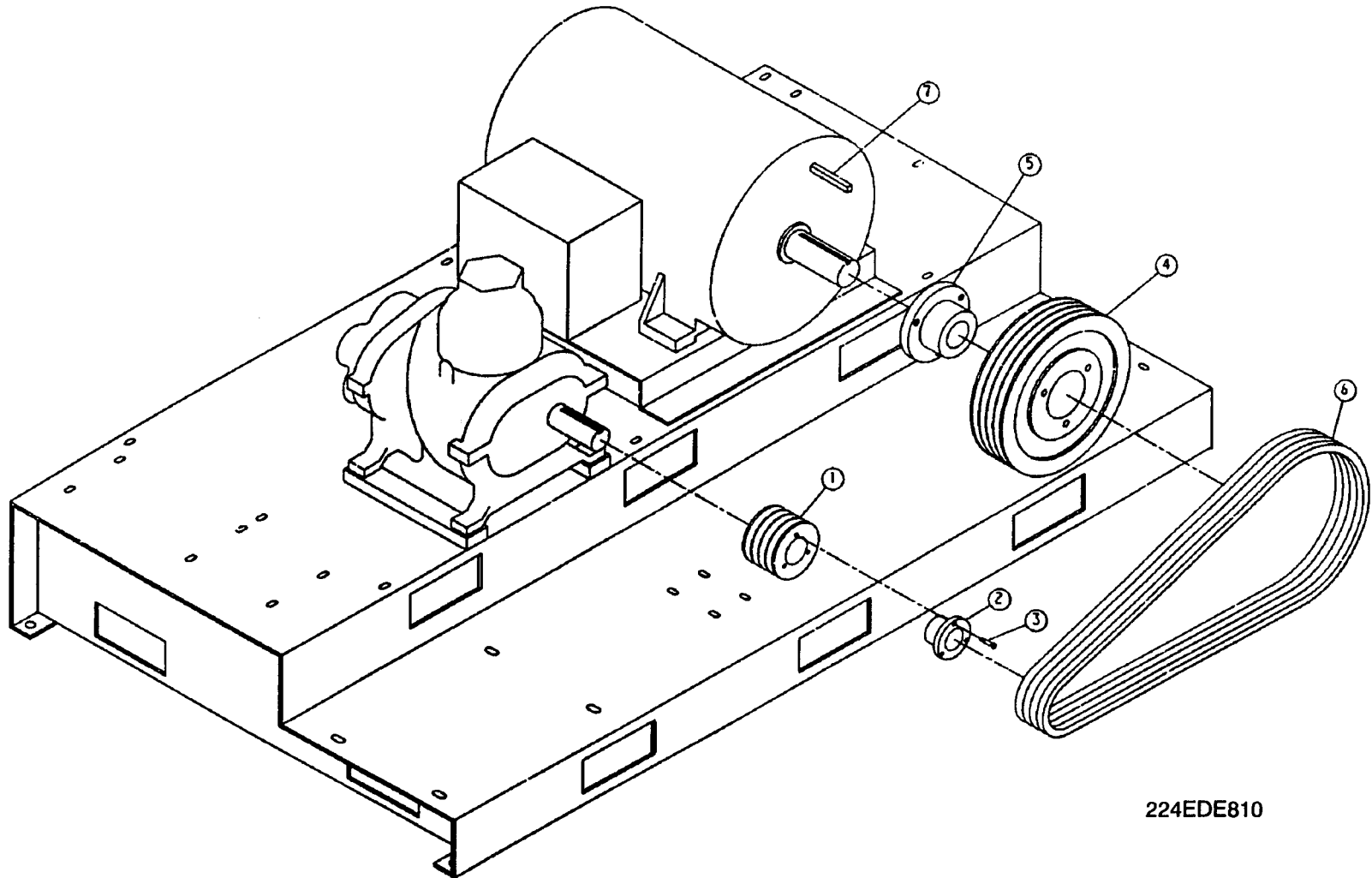

224EDE810

NOTE: Detail No. 8 not shown (Press Relief Valve).

**COMPRESSOR DRIVE GROUPS
50 HZ - WYE DELTA**

| Ref. No. | Name of Part | Qty. | Part No. Per Pressure | | |
|-------------|----------------------------|------|-----------------------|-----------|-----------|
| | | | 100 | 125 | 150 |
| | 40 H.P. DRIVE GROUP | | EDE81833 | EDE81834 | EDE81835 |
| 1 | SHEAVE, COMPRESSOR..... | 1 | 73M45V44 | 73M45V59 | 73M45V59 |
| 2 | HUB-BUSHING | 1 | 22F28SD | 22F28SD | 22F28SD |
| 3 | SCREW, HEX HD | 3 | 75P27 | 75P27 | 75P27 |
| 4 | SHEAVE-MOTOR..... | 1 | 73M45V113 | 73M45V132 | 73M45V118 |
| 5 | HUB-BUSHING | 1 | 22F34E | 22F34E | 22F34E |
| 6 | BELT SET | 1 | 13AH7104 | 13AH7504 | 13AH7504 |
| 7 | KEY | 1 | 35L52 | 35L52 | 35L52 |
| 8 | VALVE-PRESSURE/RELIEF..... | 1 | 90AR381 | 90AR382 | 90AR146 |
| 9 | FAN..... | 1 | 200EDE701 | 200EDE701 | 200EDE701 |
| 10 | ADAPTOR, FAN..... | 1 | 200EDE649 | 200EDE649 | 200EDE649 |
| 11 | SCREW-HEX CAP | 3 | 75P6N | 75P6N | 75P6N |
| 12 | SCREW-12 PT. | 3 | 75LM189 | 75LM189 | 75LM189 |

| Ref. No. | Name of Part | Qty. | Part No. Per Pressure | | |
|-------------|----------------------------|------|-----------------------|-----------|-----------|
| | | | 100 | 125 | 150 |
| | 50 H.P. DRIVE GROUP | | EDE81837 | EDE81838 | EDE81839 |
| 1 | SHEAVE, COMPRESSOR..... | 1 | 73M45V49 | 73M45V46 | 73M45V44 |
| 2 | HUB-BUSHING | 1 | 22F28SD | 22F28SD | 22F28SD |
| 3 | SCREW, HEX HD | 3 | 75P27 | 75P27 | 75P27 |
| 4 | SHEAVE-MOTOR..... | 1 | 73M45V150 | 73M45V132 | 73M45V109 |
| 5 | HUB-BUSHING | 1 | 22F34E | 22F34E | 22F34E |
| 6 | BELT SET | 1 | 13AH8004 | 13AH7504 | 13AH7104 |
| 7 | KEY | 1 | 35L52 | 35L52 | 35L52 |
| 8 | VALVE-PRESSURE/RELIEF..... | 1 | 90AR381 | 90AR382 | 90AR146 |
| 9 | FAN..... | 1 | 200EDE701 | 200EDE701 | 200EDE701 |
| 10 | ADAPTOR, FAN..... | 1 | 200EDE649 | 200EDE649 | 200EDE649 |
| 11 | SCREW-HEX CAP | 3 | 75P6N | 75P6N | 75P6N |
| 12 | SCREW-12 PT. | 3 | 75LM189 | 75LM189 | 75LM189 |

**COMPRESSOR DRIVE GROUPS
60 HZ - WYE DELTA**

| Ref. No. | Name of Part | Qty. | Part No. Per Pressure | | |
|-------------|-----------------------------|------|-----------------------|-----------|-----------|
| | | | 100 | 125 | 150 |
| | 40 H.P. DRIVE GROUP | | EDE81825 | EDE81826 | EDE81827 |
| 1 | SHEAVE, COMPRESSOR..... | 1 | 73M45V59 | 73M45V49 | 73M45V59 |
| 2 | HUB-BUSHING | 1 | 22F28SD | 22F28SD | 22F28SD |
| 3 | SCREW, HEX HD | 3 | 75P27 | 75P27 | 75P27 |
| 4 | SHEAVE-MOTOR | 1 | 73M45V125 | 73M45V90 | 73M45V97 |
| 5 | HUB-BUSHING | 1 | 22F34E | 22F34E | 22F34E |
| 6 | BELT SET | 1 | 13AH7504 | 13AH6704 | 13AH7104 |
| 7 | KEY | 1 | 35L52 | 35L52 | 35L52 |
| 8 | VALVE-PRESSURE/RELIEF | 1 | 90AR381 | 90AR382 | 90AR146 |
| 9 | FAN..... | 1 | 200EDE701 | 200EDE701 | 200EDE701 |
| 10 | ADAPTOR, FAN..... | 1 | 200EDE649 | 200EDE649 | 200EDE649 |
| 11 | SCREW-HEX CAP | 3 | 75P6N | 75P6N | 75P6N |
| 12 | SCREW-12 PT. | 3 | 75LM189 | 75LM189 | 75LM189 |

| Ref. No. | Name of Part | Qty. | Part No. Per Pressure | | |
|-------------|-----------------------------|------|-----------------------|-----------|-----------|
| | | | 100 | 125 | 150 |
| | 50 H.P. DRIVE GROUP | | EDE81829 | EDE81830 | EDE81831 |
| 1 | SHEAVE, COMPRESSOR..... | 1 | 73M45V49 | 73M45V49 | 73M45V59 |
| 2 | HUB-BUSHING | 1 | 22F28SD | 22F28SD | 22F28SD |
| 3 | SCREW, HEX HD | 3 | 75P27 | 75P27 | 75P27 |
| 4 | SHEAVE-MOTOR | 1 | 73M45V125 | 73M45V113 | 73M45V118 |
| 5 | HUB-BUSHING | 1 | 22F34E | 22F34E | 22F34E |
| 6 | BELT SET | 1 | 13AH7504 | 13AH7104 | 13AH7504 |
| 7 | KEY | 1 | 35L52 | 35L52 | 35L52 |
| 8 | VALVE-PRESSURE/RELIEF | 1 | 90AR381 | 90AR382 | 90AR146 |
| 9 | FAN..... | 1 | 200EDE701 | 200EDE701 | 200EDE701 |
| 10 | ADAPTOR, FAN..... | 1 | 200EDE649 | 200EDE649 | 200EDE649 |
| 11 | SCREW-HEX CAP | 3 | 75P6N | 75P6N | 75P6N |
| 12 | SCREW-12 PT. | 3 | 75LM189 | 75LM189 | 75LM189 |

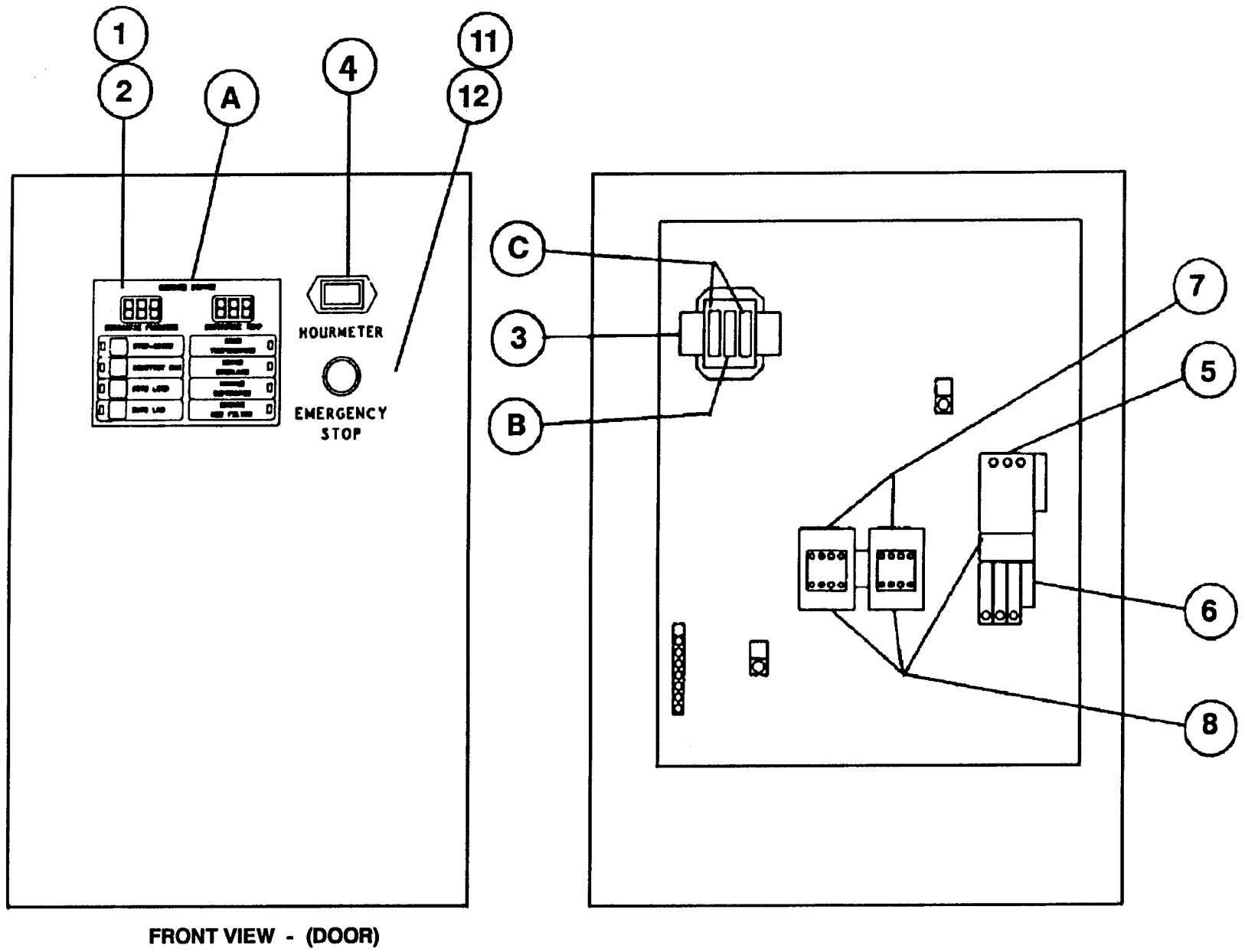

**CONTROLLER ASSEMBLY - WYE-DELTA STARTERS (OPTIONAL)
- 40 H.P. UNITS -**

| | QTY. | 230V | 460V | 380V | 415V |
|--|------|------------|------------|------------|------------|
| * ASSEMBLED PANEL: NEMA 12..... | 1 | 218EDE466 | 224EDE466 | 222EDE466 | 222EDE466 |
| * ASSEMBLED PANEL: NEMA 4..... | 1 | 220EDE466 | 226EDE466 | 223EDE466 | 223EDE466 |
| A FUSE, CONTROL BOARD | 2 | 24CA2932 | 24CA2932 | 24CA2932 | 24CA2932 |
| B FUSE, TRANSFORMER SECONDARY | 1 | 24CA3324 | 24CA3324 | 24CA3324 | 24CA3324 |
| C FUSE, TRANSFORMER PRIMARY | 2 | 24CA617 | 24CA276 | 24CA276 | 24CA276 |
| 1 KEYPAD..... | 1 | 200EJB375 | 200EJB375 | 200EJB375 | 200EJB375 |
| 2 ELECTRONIC CONTROLLER ASSEMBLY | 1 | 202EJB1173 | 202EJB1173 | 202EJB1173 | 202EJB1173 |
| 3 CONTROL TRANSFORMER, 105VA | 1 | 2116617 | 2116617 | 2116618 | 2116619 |
| 4 HOURMETER (60 HZ)..... | 1 | 24CA2895 | 24CA2895 | 24CA2895 | 24CA2895 |
| 4 HOURMETER (50 HZ)..... | 1 | 24CA3542 | 24CA3542 | 24CA3542 | 24CA3542 |
| 5 STARTER, MAIN MOTOR | 1 | 24CA3319 | 24CA3317 | 24CA3320 | 24CA3316 |
| 6 HEATER, MAIN MOTOR OVERLOAD | 3 | 24CA2608 | 24CA2604 | 24CA2606 | 24CA2606 |
| 7 CONTACTOR, MAIN MOTOR-WYE DELTA..... | 2 | 24CA3328 | 24CA3326 | 24CA3330 | 24CA3325 |
| 8 REPLACEMENT COIL FOR ITEMS 5 & 7..... | (3) | 2116623 | 2116626 | 2116621 | 2116628 |
| 9 CONTROL RELAY | 1 | 24CA3315 | 24CA3315 | 24CA3315 | 24CA3315 |
| 10 TIMER MODULE..... | 1 | 24CA3314 | 24CA3314 | 24CA3314 | 24CA3314 |
| 11 OPERATOR, 22mm PUSH-PULL E-STOP | 1 | 24CA2907 | 24CA2907 | 24CA2907 | 24CA2907 |
| 12 CONTACT BLOCK E22B1 SPNC..... | 1 | 24CA2908 | 24CA2908 | 24CA2908 | 24CA2908 |

**CONTROLLER ASSEMBLY - WYE-DELTA STARTERS
- 50 H.P. UNITS -**

| | QTY. | 230V | 460V | 380V | 415V |
|---|------|------------|------------|------------|------------|
| * ASSEMBLED PANEL: NEMA 12..... | 1 | 219EDE466 | 225EDE466 | 222EDE466 | 222EDE466 |
| * ASSEMBLED PANEL: NEMA 4..... | 1 | 221EDE466 | 227EDE466 | 223EDE466 | 223EDE466 |
| A FUSE, CONTROL BOARD..... | 2 | 24CA2932 | 24CA2932 | 24CA2932 | 24CA2932 |
| B FUSE, TRANSFORMER SECONDARY..... | 1 | 24CA3324 | 24CA3324 | 24CA3324 | 24CA3324 |
| C FUSE, TRANSFORMER PRIMARY..... | 2 | 24CA617 | 24CA276 | 24CA276 | 24CA276 |
| 1 KEYPAD..... | 1 | 200EJB375 | 200EJB375 | 200EJB375 | 200EJB375 |
| 2 ELECTRONIC CONTROLLER ASSEMBLY..... | 1 | 202EJB1173 | 202EJB1173 | 202EJB1173 | 202EJB1173 |
| 3 CONTROL TRANSFORMER, 105VA..... | 1 | 2116617 | 2116617 | 2116618 | 2116619 |
| 4 HOURMETER (60 HZ)..... | 1 | 24CA2895 | 24CA2895 | 24CA2895 | 24CA2895 |
| 4 HOURMETER (50 HZ)..... | 1 | | | | |
| 5 STARTER, MAIN MOTOR..... | 1 | 24CA3320 | 24CA3318 | 24CA3322 | 24CA3316 |
| 6 HEATER, MAIN MOTOR OVERLOAD..... | 3 | 24CA2893 | 24CA2606 | 24CA2607 | 24CA2607 |
| 7 CONTACTOR, MAIN MOTOR-WYE DELTA..... | 2 | 24CA3329 | 24CA3327 | 24CA3331 | 24CA3325 |
| 8 REPLACEMENT COIL FOR ITEMS 5 & 7..... | (3) | 2116624 | 2116627 | 2116622 | 2116628 |
| 9 CONTROL RELAY..... | 1 | 24CA3315 | 24CA3315 | 24CA3315 | 24CA3315 |
| 10 TIMER MODULE..... | 1 | 24CA3314 | 24CA3314 | 24CA3314 | 24CA3314 |
| 11 OPERATOR, 22mm PUSH-PULL E-STOP..... | 1 | 24CA2907 | 24CA2907 | 24CA2907 | 24CA2907 |
| 12 CONTACT BLOCK E22B1 SPNC..... | 1 | 24CA2908 | 24CA2908 | 24CA2908 | 24CA2908 |

**MOTOR GROUP
(MAIN DRIVE MOTORS - WYE DELTA)
(50/60 HZ-STD. ODP/TEFC)**

| COLUMN CODE | NAME OF PART | 40 HP PART NO. | 50 HP PART NO. |
|-------------|--|----------------|----------------|
| | OPEN DRIP PROOF (60 HZ-ODP) (1800 RPM) | | |
| 13A | MOTOR, 230V | 24CA3243 | 24CA3244 |
| 13B | MOTOR, 460V | 24CA3243 | 24CA3244 |
| | OPEN DRIP PROOF (50 HZ-ODP) (1500 RPM) | | |
| 13C | MOTOR, 380V | 24CA1798 | 24CA1799 |
| 13D | MOTOR, 415V | 24CA1800 | 24CA1801 |
| | TOTALLY ENCLOSED FAN COOLED (60 HZ-TEFC) (1800 RPM) | | |
| 13E | MOTOR, 230V | 24CA3247 | 24CA3248 |
| 13F | MOTOR, 460V | 24CA3247 | 24CA3248 |
| | TOTALLY ENCLOSED FAN COOLED (50 HZ-TEFC) (1500 RPM) | | |
| 13G | MOTOR, 380V | 24CA2729 | 24CA2730 |
| 13H | MOTOR, 415V | 24CA2735 | 24CA2736 |

MOTOR BASES

| HP. | FR. # | PART NO. |
|-----|-------|----------|
| 40 | 324T | 24AZ25 |
| 50 | 326T | 24AZ26 |

