

GARDNER-DENVER®

13-10-503
3rd Edition

ELECTRA-SAVER®
STATIONARY SCREW
COMPRESSOR

MODELS

EAU__PD - 200 HP
EAU__QD - 250 HP
EAU__RD - 300 HP

PARTS LIST

**COOPER**

Gardner-Denver
Industrial Machinery

TABLE OF CONTENTS

Group Name	Page No.
Ordering Instructions.....	2
Introduction Page.....	2
Matrix/Menu Model Designations.....	3
Bare Compressor.....	4
Repair Kits, Bare Compressor.....	5
Turn Valve Actuator & Valve.....	6
Inlet Valve & Air Filter (Standard).....	7
Purge Valve & Mounting Group.....	8
Air Filter Group (Heavy Duty) (200 HP).....	9
Air Filter Group (Heavy Duty) (250 & 300 HP).....	10
Oil Reservoir & Air Discharge Group (200 & 250 HP).....	11
Oil Reservoir & Air Discharge Group (300 HP).....	12
Oil Reservoir Group (Selective Items).....	13
Aftercooler Group (Water-Cooled Units).....	14
Oil Piping.....	15
Heat Exchanger & Mounting Group (Water-Cooled Units).....	16
Selective Items.....	17, 18
Oil Filter & Thermal Valves.....	19
Minimum Pressure Valve.....	20
Coupling & Miscellaneous Tube Fittings.....	21
Base & Mounting Group.....	22
Oil Cooler Module.....	23
Control Components & Tubing.....	24
Remote Mounted Oil Cooler Fittings.....	25
Subtractive Pilot Valve.....	26
Oil Reservoir Pressure Switch.....	27
Control Panels.....	28
Control Items.....	29
Control Schematic.....	30
Enclosure Group.....	31
Repair Kits.....	32 & 33

**MAINTAIN COMPRESSOR RELIABILITY AND PERFORMANCE WITH
GENUINE GARDNER-DENVER AND JOY COMPRESSOR
PARTS AND SUPPORT SERVICES**

Gardner-Denver and Joy Compressor genuine parts, engineered to original tolerances, are designed for optimum dependability -- specifically for Gardner-Denver and Joy compressor systems. Design and material innovations are the result of years of experience with hundreds of different compressor applications. Reliability in materials and quality assurance are incorporated in our genuine replacement parts.

Authorized Gardner-Denver and Joy Compressor distributors offer all the backup you'll need. A worldwide network of authorized distributors provides the finest product support in the air compressor industry.

Local authorized distributors maintain a large inventory of genuine parts and are backed up for emergency parts by direct access to the Gardner-Denver Industrial Machinery Master Distribution Center (MDC) in Memphis, Tennessee.

Authorized distributors can support your Gardner-Denver or Joy air compressor with these services:

1. Trained parts specialists to assist you in selecting the correct replacement parts.
2. Factory warranted new and remanufactured rotary screw air ends. Most popular model remanufactured air ends are maintained in stock at MDC for purchase on an exchange basis with liberal core credit available for the replacement unit.
3. A full line of factory tested AEON compressor lubricants specifically formulated for use in Gardner-Denver and Joy compressors.
4. Repair and maintenance kits designed with the necessary parts to simplify servicing your compressor.

Authorized distributor service technicians are factory-trained and skilled in compressor maintenance and repair. They are ready to respond and assist you by providing fast, expert maintenance and repair services.

For the location of your authorized Gardner-Denver and Joy Air Compressor distributor refer to the yellow pages of your phone directory or contact:

Gardner-Denver Industrial Machinery
1800 Gardner Expressway
Quincy, IL 62301
Phone: (217) 222-5400

INSTRUCTIONS FOR ORDERING REPAIR PARTS

When ordering parts, specify Compressor **MODEL**, Method of Cooling, **HORSEPOWER** and **SERIAL NUMBER** (see nameplate on unit). Serial Number is also stamped on top of the cylinder flange to the right of the inlet housing.

All orders for Parts should be placed with the nearest authorized distributor.

Where **NOT** specified, quantity of parts required per compressor or unit is one (1); where more than one is

required per unit, quantity is indicated in parenthesis. **SPECIFY EXACTLY THE NUMBER OF PARTS REQUIRED.**

DO NOT ORDER BY SETS OR GROUPS.

To determine the Right Hand and Left Hand side of a compressor, stand at the motor end and look toward the compressor. Right Hand and Left Hand are indicated in parenthesis following part name, i.e. (RH) & (LH).

AIR ENDS

NOTE: Factory warranted new and rebuilt air ends are available from your authorized Gardner-Denver and Joy Compressor Distributor.

**ELECTRA-SAVER STATIONARY SCREW COMPRESSOR
200 HP - 250 HP - 300 HP
THIRTEEN DIGIT MODEL DESIGNATIONS**

NOTICE TO CUSTOMER - To find the construction options for your compressor unit, FILL IN THE BALANCE OF LETTERS FROM YOUR COMPRESSOR NAME PLATE

E A U												
1	2	3	4	5	6	7	8	9	10	11	12	13

FOLLOW THE LINE DOWN AND OVER FROM EACH LETTER THUS FILLED IN TO FIND THE APPROPRIATE CONSTRUCTION WITH WHICH YOUR MACHINE IS EQUIPPED. THE NUMBER "9" IN ANY COLUMN SPACE INDICATES "NOT APPLICABLE", THE NUMBER "8" IN ANY COLUMN SPACE INDICATES SPECIAL DESIGN - REFER TO FACTORY ORDER TICKET.

COLUMNS 1, 2 & 3 - COMPRESSOR TYPE & SIZE

COLUMN 4 - TYPE OF CONSTRUCTION

- Q. Air Cooled Base Mounted
- S. Water Cooled Base Mounted

COLUMN 5 - HORSEPOWER

- P. 200 HP Q. 250 HP R. 300 HP

COLUMN 6 - ENGINEERING SPEC.

COLUMN 7 - OPERATING PRESSURE

- D. 100 PSIG (60 Hz) N. 100 PSIG (50 Hz)
- F. 125 PSIG (60 Hz) P. 125 PSIG (50 Hz)
- H. 150 PSIG (60 Hz) R. 150 PSIG (50 Hz)

COLUMN 8 - CONTROL - Letter varies with Voltage to Transformer

- Refer to pages 10, 11 & 12
- A thru L - Dual Control M thru X - Duomatic Control

COLUMN 9 - CONTROL ENCLOSURE & STARTER TYPE - Letters vary with options -

- Refer to pages 10, 11 & 12
- A thru D - Magnetic Starter (NEMA I)
- E thru H - Magnetic Starter (NEMA IV)
- I thru L - Manual Starter (NEMA I)
- M thru P - Manual Starter (NEMA IV)

COLUMN 10 - ENCLOSURE & AIR FILTER - Refer to pages 2 & 13

- A. Standard Enclosure/Standard Air Filter
- B. Standard Enclosure/Optional Air Filter

COLUMN 11 - COOLERS - Letters vary with Material, Manufacturer &

- Aftercooler (if used) - Refer to page
- A thru H - Air Cooled
- I thru T - Fresh Water Cooled
- U thru X - Salt Water Cooled

COLUMN 12 - COOLER ELECTRICAL - Letters vary with Voltage -

- Refer to pages 10, 11 & 12
- A thru I - Air Cooled NEMA I
- J thru S - Air Cooled NEMA IV
- T thru X - Water Cooled

COLUMN 13 - COMPRESSOR DRIVE MOTOR

Motors are not listed in this book - When ordering replacement motor for your unit, it is MOST IMPORTANT that the COMPLETE thirteen digit model number is given in order to obtain correct drive motor.

**BARE COMPRESSOR REPAIR KITS
(200, 250 & 300 HP)**

PSI	HP	Model	ø Gear Kit Part No.		Bare Compressor Field Replacement (Includes Gears)		*Gasket Kit Part No.
			60 Hz	50 Hz	60 Hz	50 Hz	
100	200	EAU_P	SSU67270	SSU68145	EAU67704	EAU68147	SSU74559
	250	EAU_Q	SSU67271	SSU67272	EAU67706	EAU67713	SSU74559
	300	EAU_R	SSU67272	SSU68146	EAU67713	EAU68148	SSU74559
125	200	EAU_P	SSU67601	SSU67602	EAU68013	EAU67707	SSU74559
	250	EAU_Q	SSU67602	SSU67271	EAU67707	EAU67706	SSU74559
	300	EAU_R	SSU67271	SSU67272	EAU67706	EAU67713	SSU74559
150	200	EAU_P	SSU67601	SSU67601	EAU68013	EAU68013	SSU74559
	250	EAU_Q	SSU67270	SSU68145	EAU67704	EAU68147	SSU74559
	300	EAU_R	SSU67602	SSU67271	EAU67707	EAU67706	SSU74559

ø Gear Kit includes both gears with keys, gear housing gasket and seal housing o-ring.

* Gasket Kit is for complete unit, less motor.

TURN VALVE ACTUATOR & VALVE*

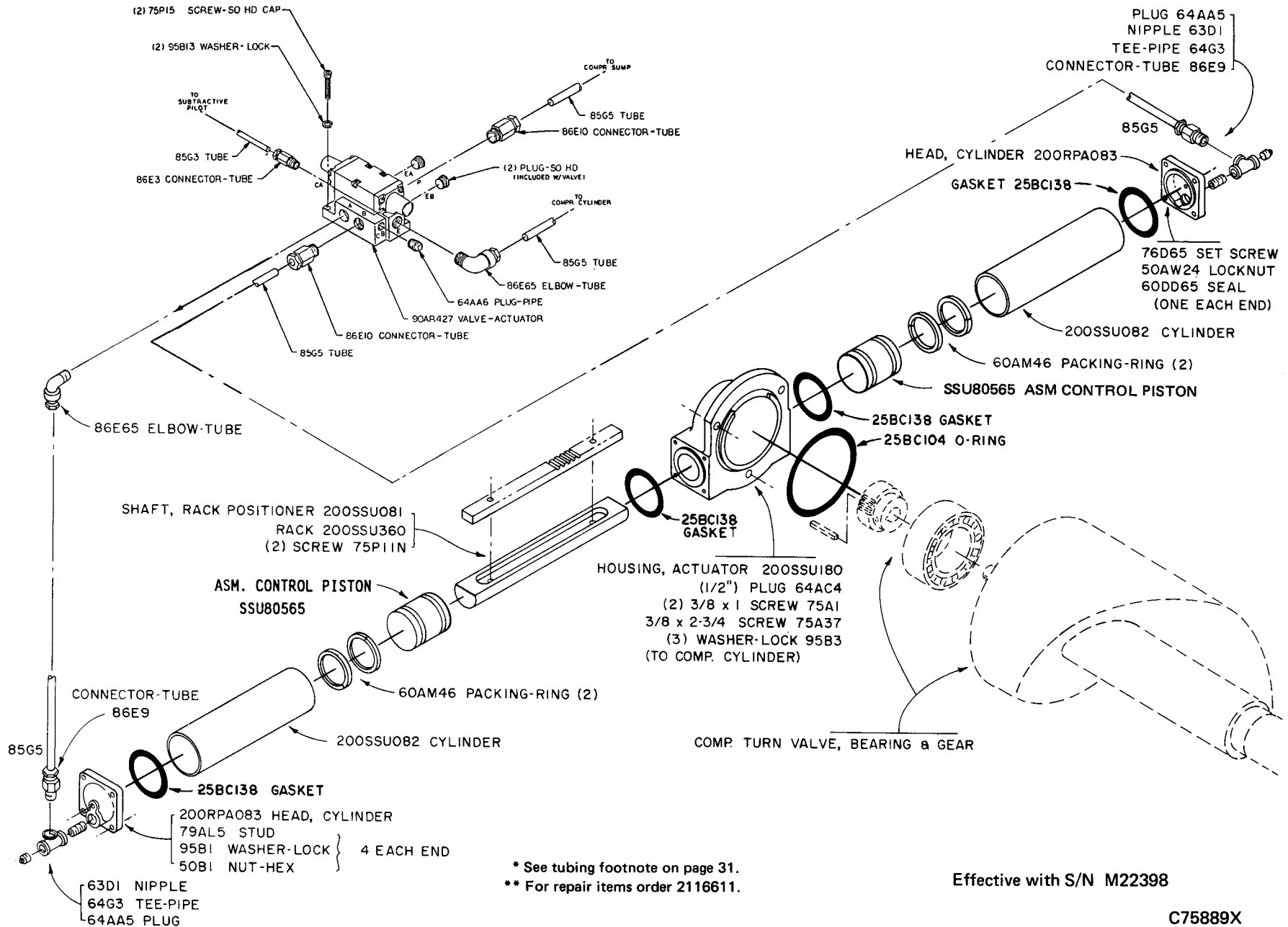

13-10-503 Page 6

* See tubing footnote on page 31.
 ** For repair items order 2116611.

Effective with S/N M22398

C75889X

INLET VALVE & AIR FILTER (STANDARD)

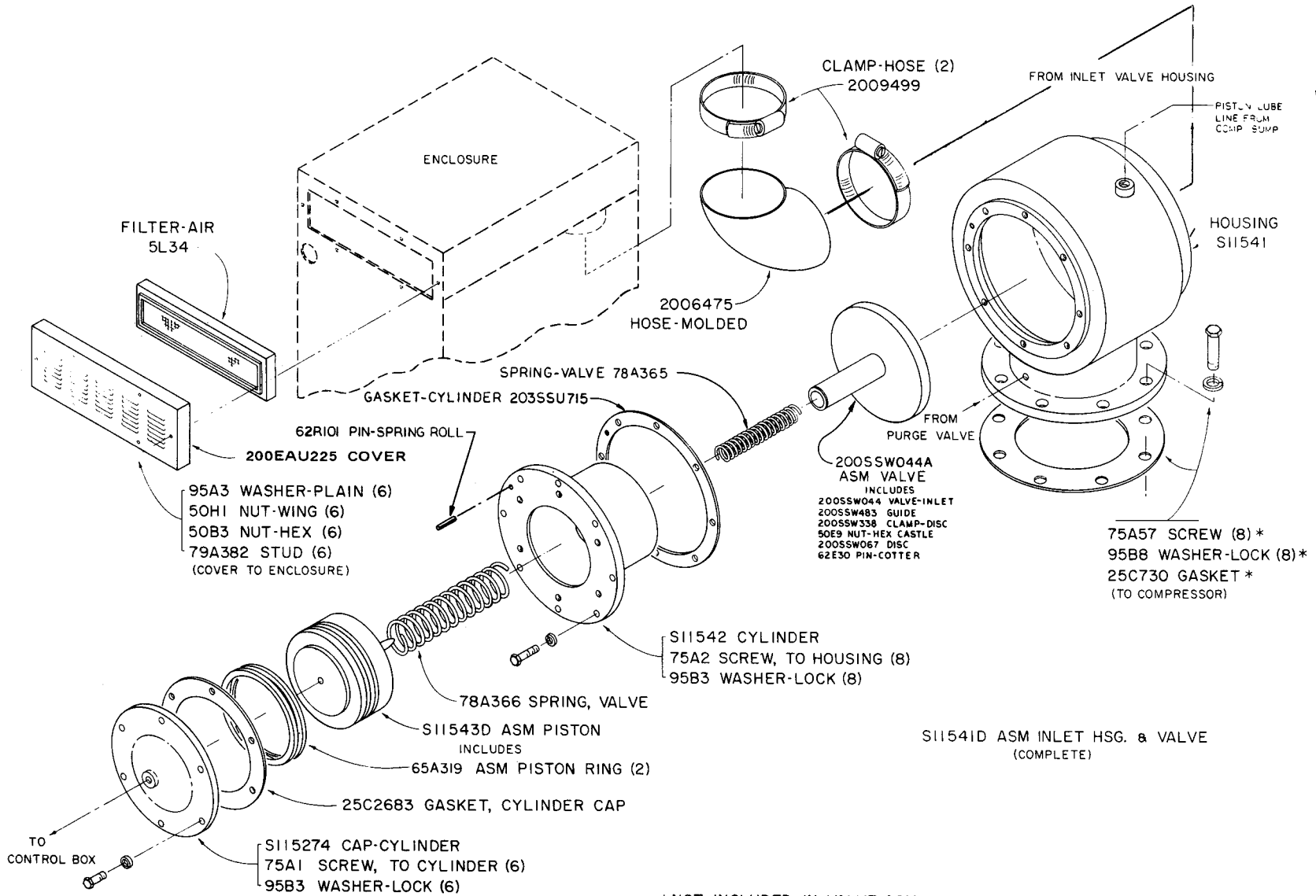

*NOT INCLUDED IN VALVE ASM.

D75890

PURGE VALVE & MOUNTING GROUP

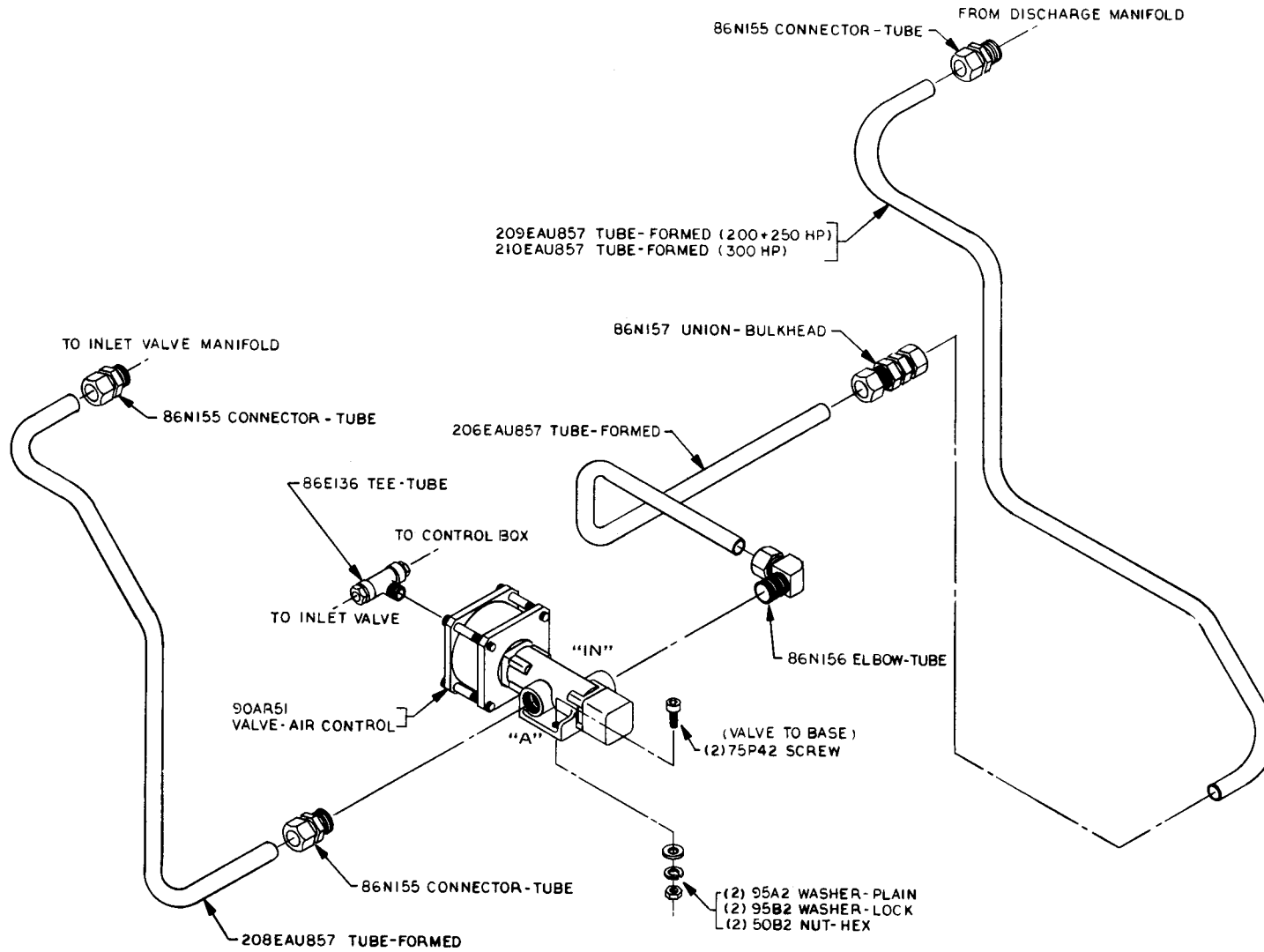

AIR FILTER GROUP, HEAVY DUTY (200 HP)

*(OPTIONAL EQUIPMENT)

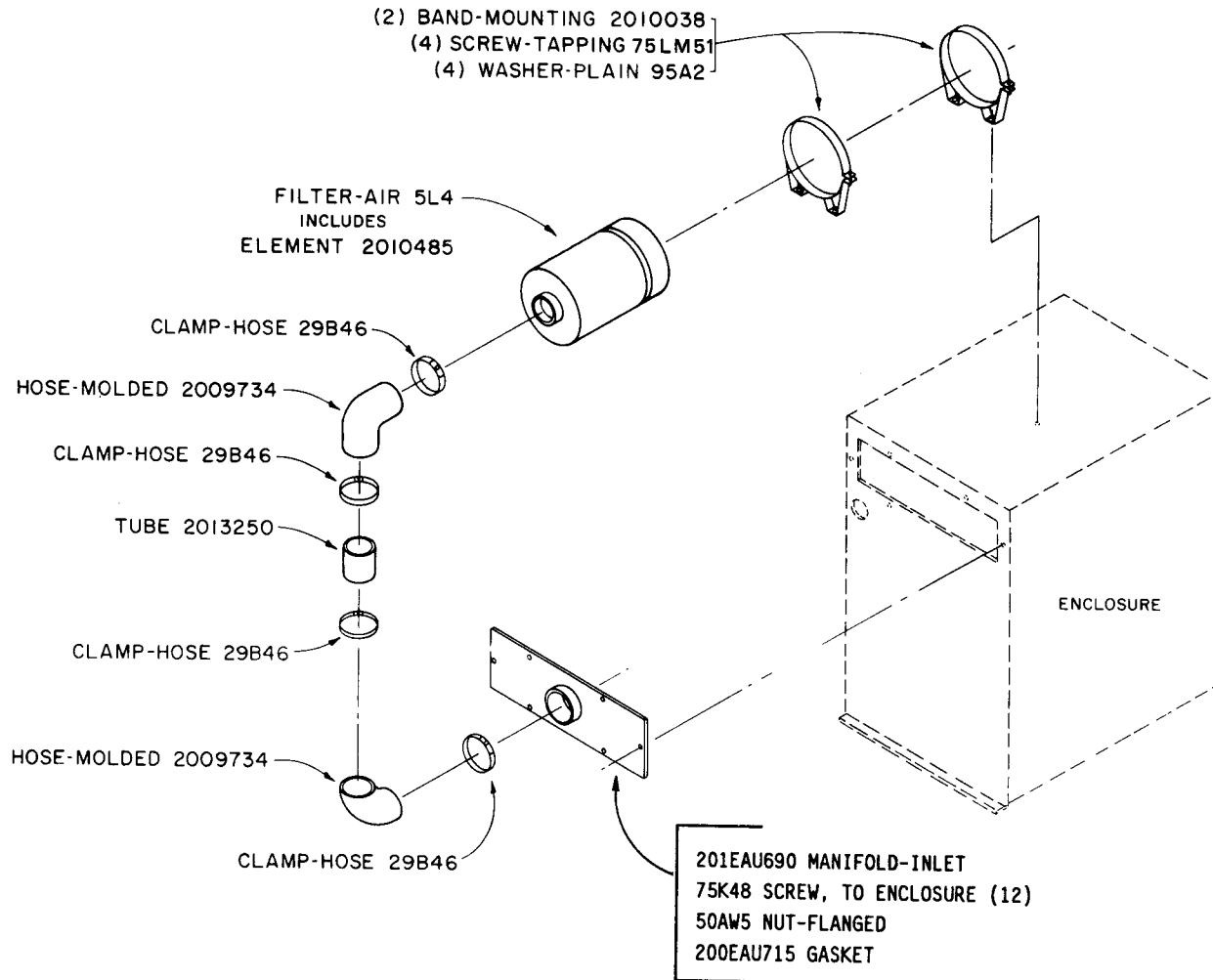

13-10-503 Page 9

* WHEN SPECIFIED ON ORDER, THIS GROUP REPLACES AIR FILTER SHOWN ON PAGE 11.

C77063

AIR FILTER GROUP, HEAVY DUTY (250 & 300 HP)

*(OPTIONAL EQUIPMENT)

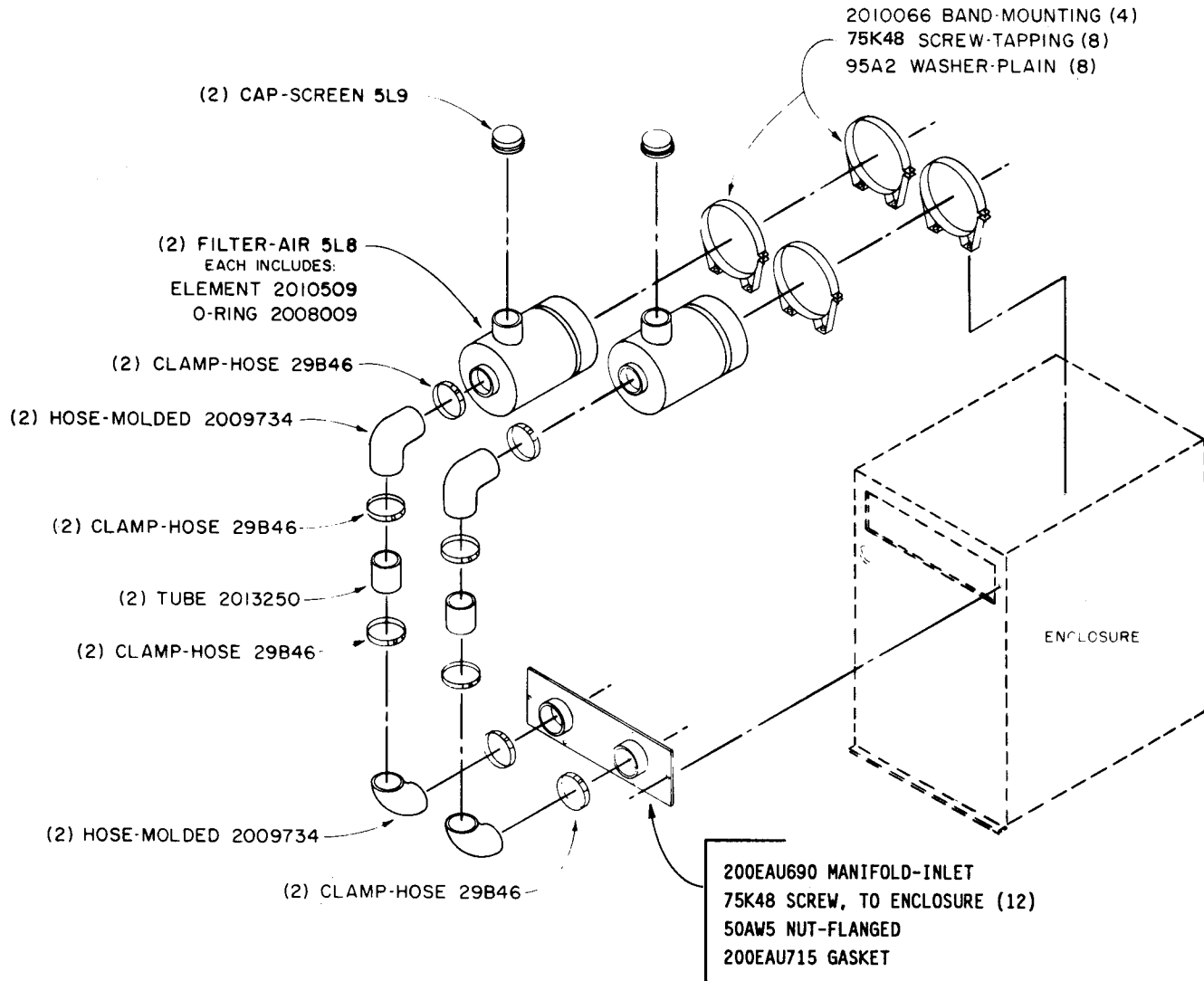

* WHEN SPECIFIED ON ORDER, THIS GROUP REPLACES AIR FILTER SHOWN ON PAGE 11.

OIL RESERVOIR & AIR DISCHARGE GROUP

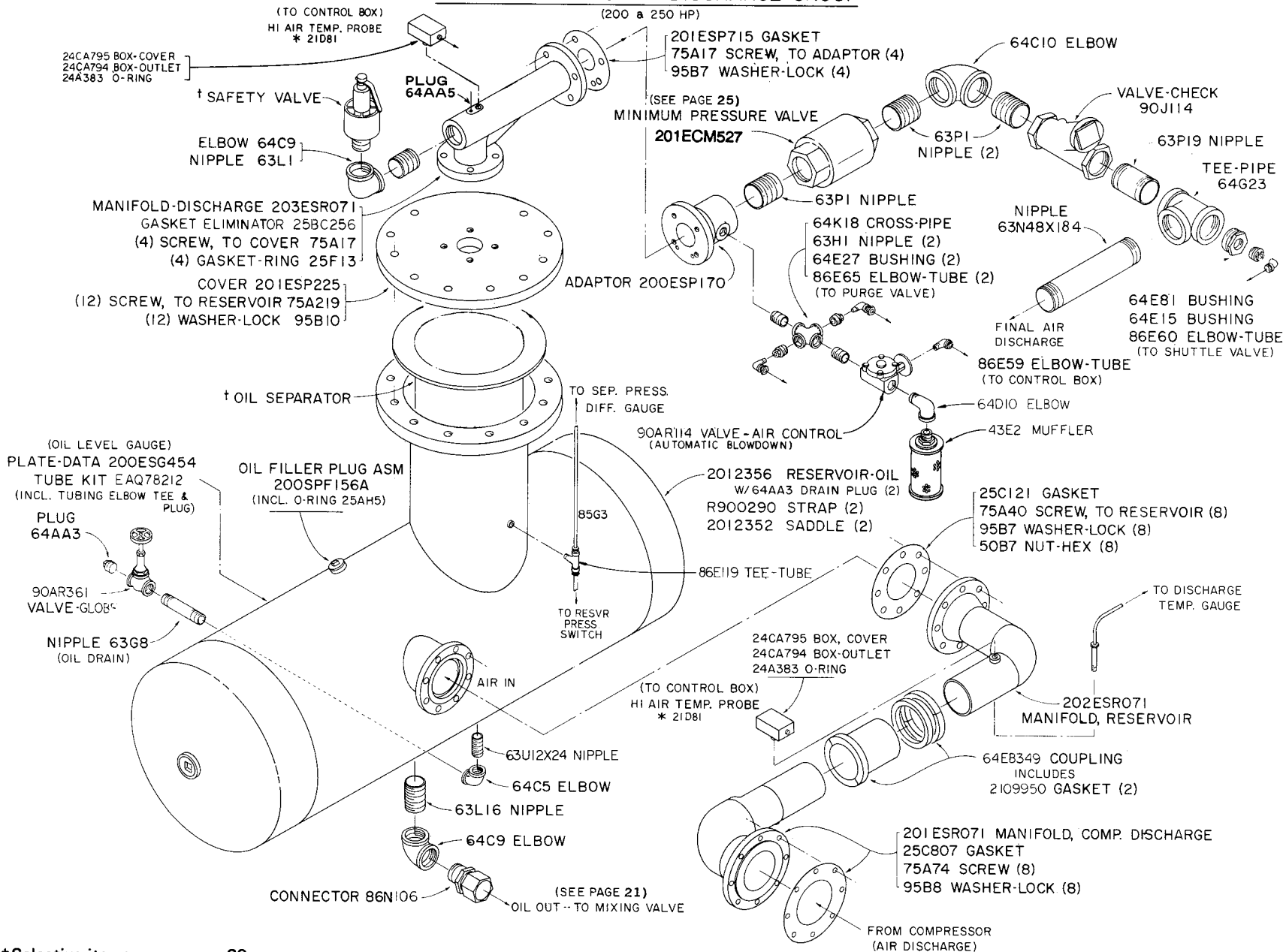

13-10-503 Page 11

† Selective items — see page 20.
* For repair order Kit No. EAQ78540

Effective with S/N M22041

E75893X

OIL RESERVOIR & AIR DISCHARGE GROUP

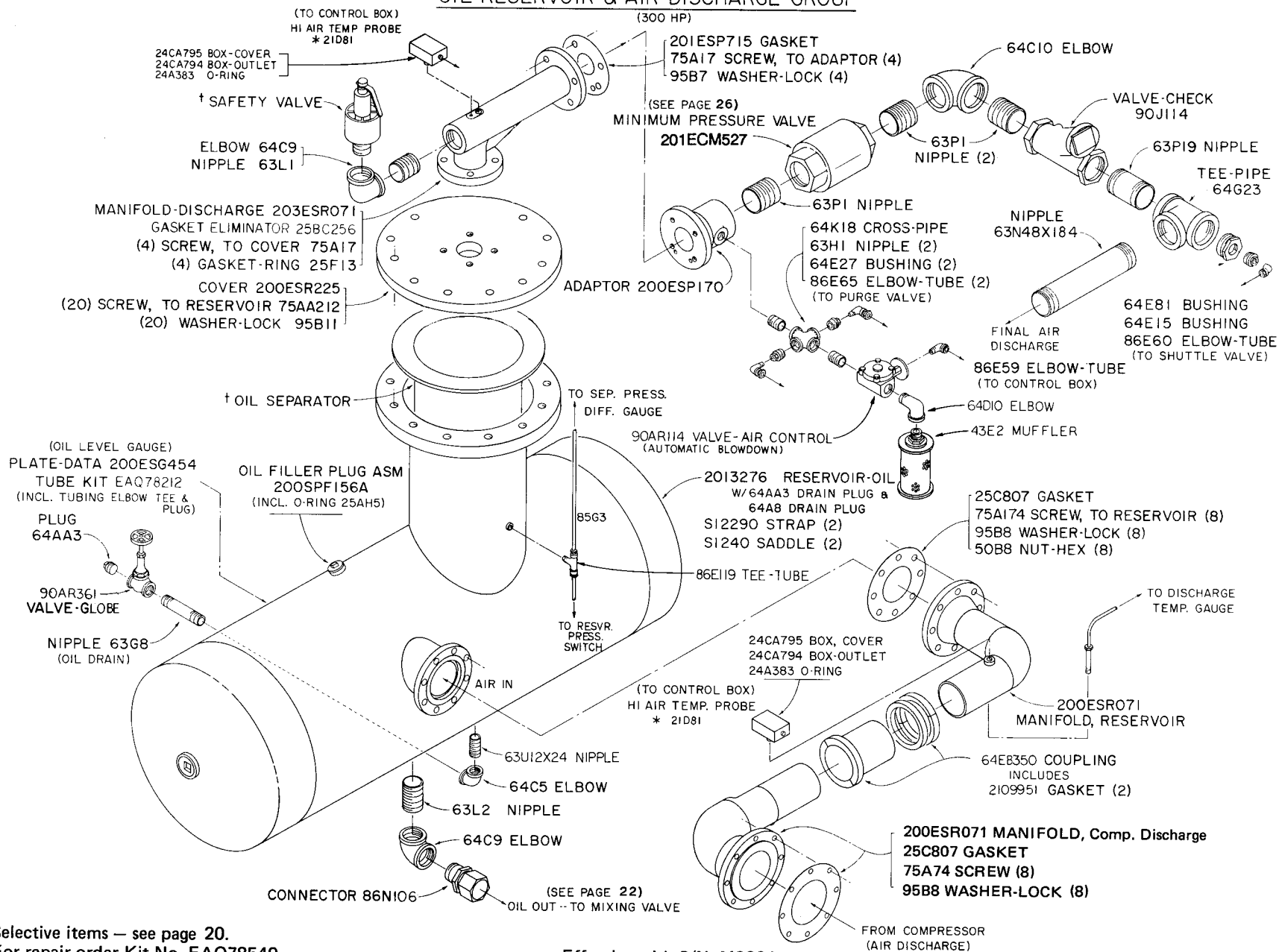

† Selective items — see page 20.
* For repair order Kit No. EAQ78540.

OIL RESERVOIR GROUP
(Selective Items)

PART NAME & DESCRIPTION	200 HP	250 HP	300 HP
VALVE-SAFETY, 100 PSI (Set 125 Lbs.)	90AR510	90AR511	90AR511
VALVE-SAFETY, 125 PSI (Set 150 Lbs.)	90AR532	90AR533	90AR533
VALVE-SAFETY, 150 PSI (Set 165 Lbs.)	90AR649	90AR649	90AR649
BUSHING, Safety Valve (1-1/2 x 2)	64E12	-----	-----

OIL SEPARATOR GROUP
(Pleated Separator)

REPAIR KIT (With Separator 55B28) (200/250 HP)	EAU80110
REPAIR KIT (With Separator 55B29) (300 HP)	EAU80127

NOTE: Repair Kit includes Separator, Oil Return Pick-up Tube, Tube Fittings and Gasket Eliminator.

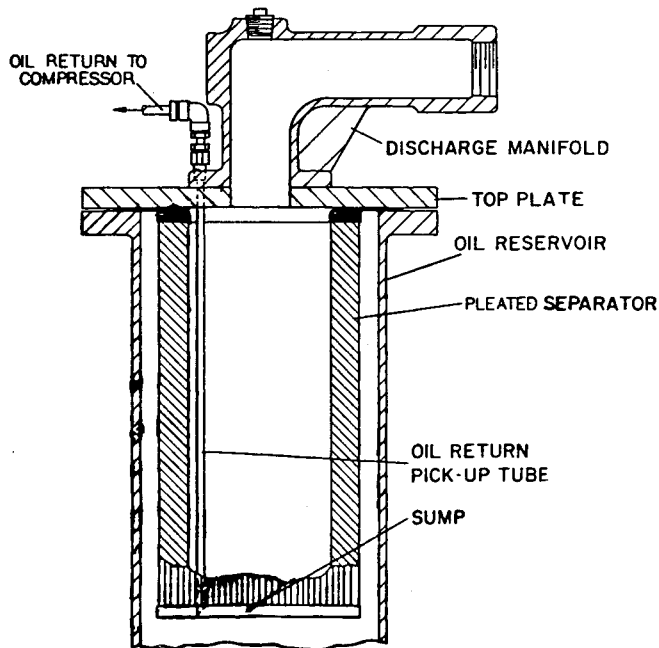

*** AFTERCOOLER GROUP (WATER-COOLED UNITS)
("B" CONSTRUCTION)**

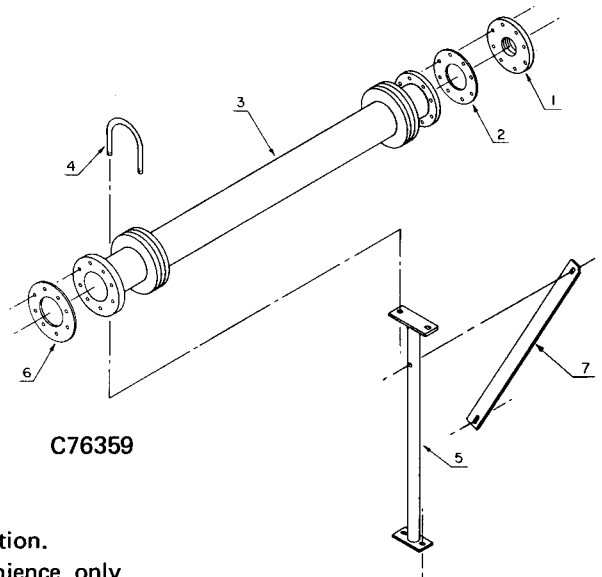

Order by Part Number and Description.
Reference Numbers for your convenience only.

Ref. No.	Part Name & Description	Qty.	200 HP	250 HP	300 HP
1	FLANGE, Reducing (Threaded)	1	64EB119	64EB120	64EB120
	SCREW, To Aftercooler.	8	75A40	75A174	75A174
	WASHER-LOCK	8	95B7	95B5	95B5
	NUT-HEX	8	50B7	59B5	50B5
2	GASKET, To Aftercooler.	1	25C121	25C807	25C807
3	AFTERCOOLER	1	*	*	*
4	U-BOLT, To Bracket.	1	15U93	15U100	200ESR213
	WASHER-PLAIN	2	95A3	95A5	95A3
	NUT-HEX	2	50B3	50B5	50B3
5	BRACKET-AFTERCOOLER.	1	200EAU118	201EAU118	202EAU118
	SCREW, To Base	2	75A20	75A20	75A20
	WASHER-PLAIN	4	95A5	95A5	95A5
	WASHER-LOCK	2	95B5	95B5	95B5
	NUT-HEX	2	50B5	50B5	50B5
6	GASKET, To Separator	1	25C807	25C701	25C701
	SCREW	8	75A214	75A214	75A214
	WASHER-LOCK	8	95B8	95B8	95B8
	NUT-HEX	8	50B8	50B8	50B8
7	BRACKET.	1	200ESR326	200ESR326	200ESR326

* AFTERCOOLER is optional Equipment — Refer also to page 24.

OIL PIPING

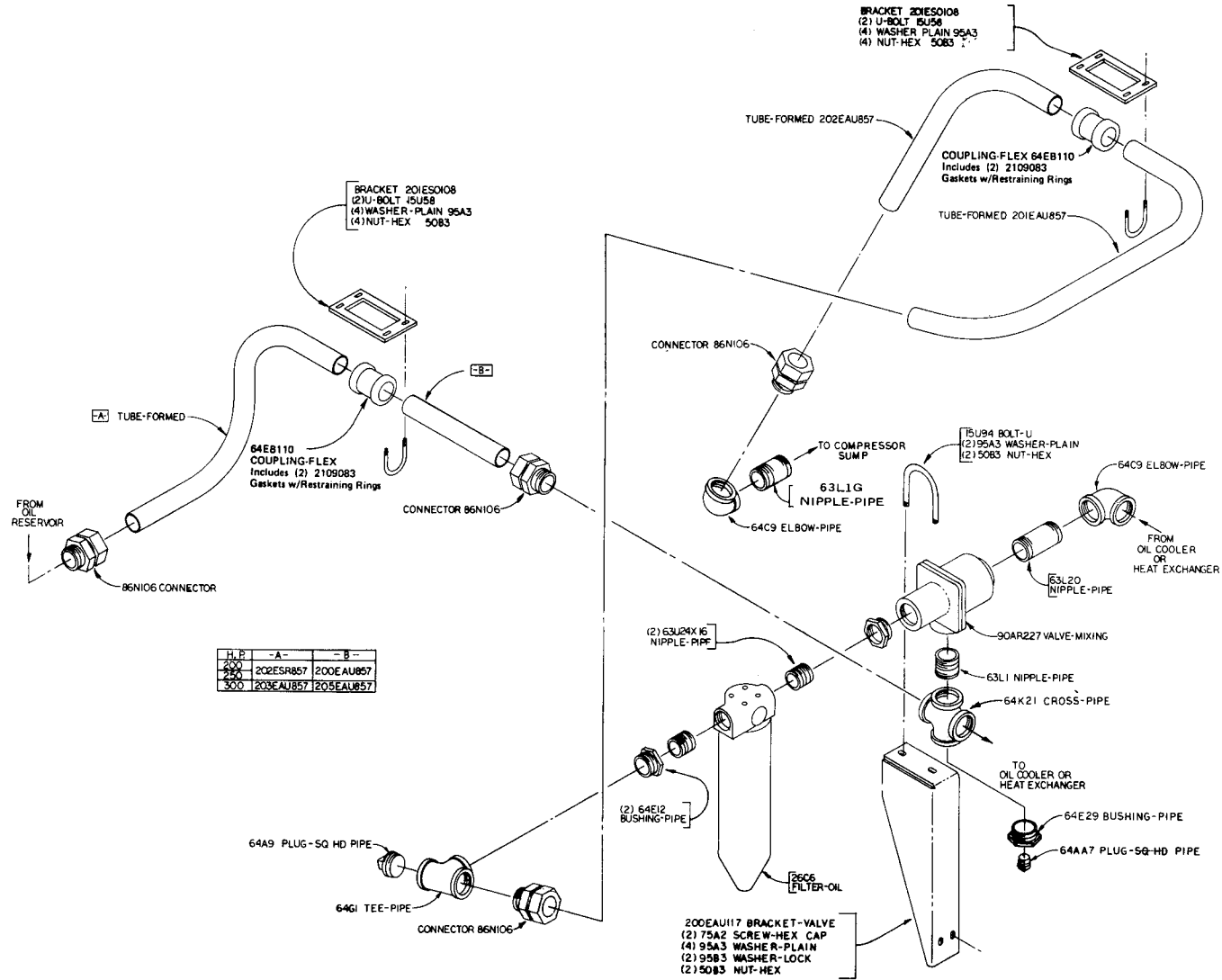

**HEAT EXCHANGER & MOUNTING GROUP
(Water-Cooled Units)
("B" Construction)**

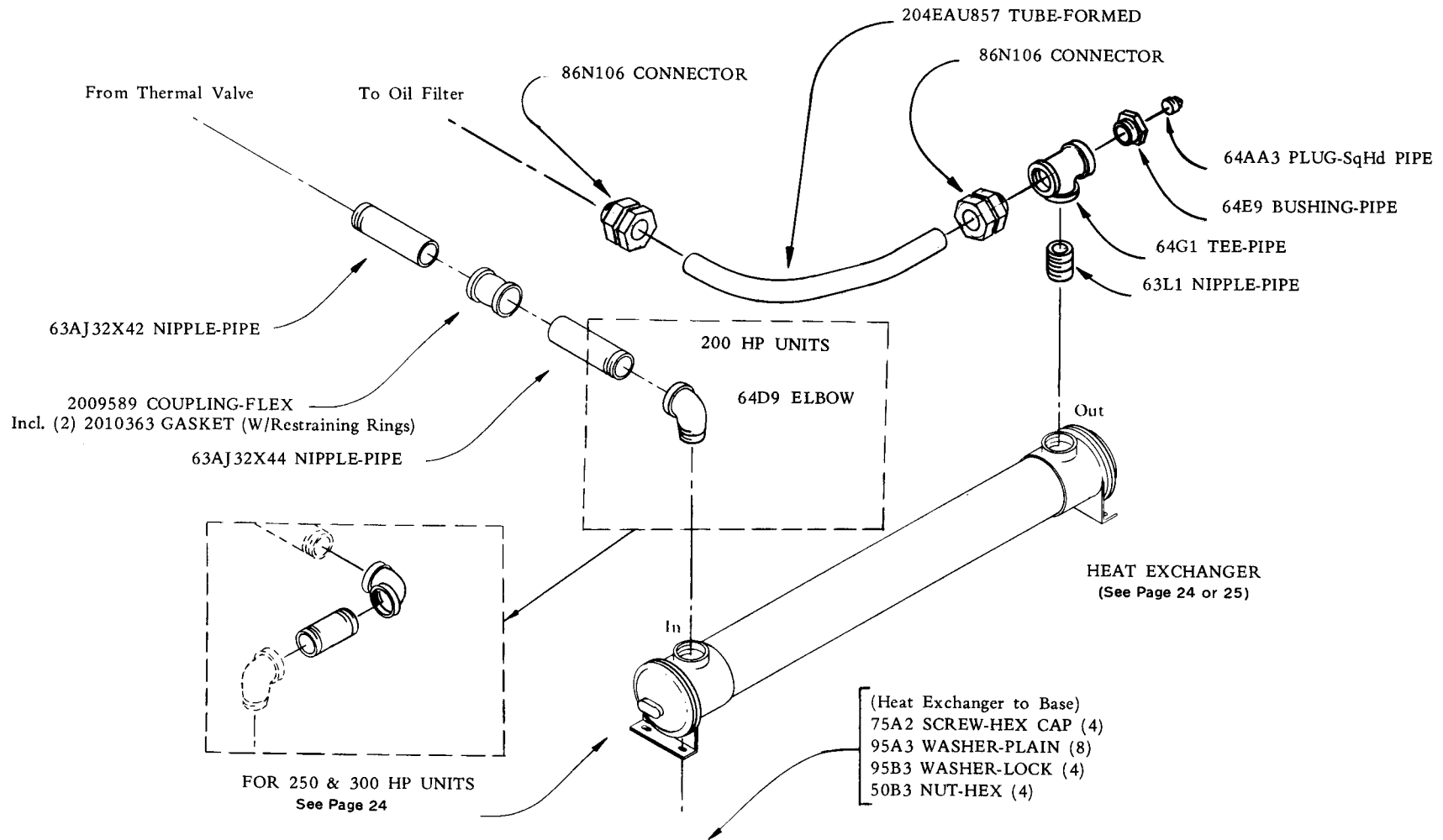

SELECTIVE ITEMS --- WATER-COOLED UNITS

(FRESH WATER SERVICE)

PART NAME & DESCRIPTION	200 HORSEPOWER		250 HORSEPOWER		300 HORSEPOWER	
	VENDOR		VENDOR		VENDOR	
		THERMAL TRANSFER		THERMAL TRANSFER		THERMAL TRANSFER
Heat Exchanger, Incl. next 6 parts: Bracket, Mounting (2) Gasket, Inlet-Outlet Bonnet, Inlet-Outlet Gasket, Return Bonnet, Return Anode-Zinc (2)		204ESS349 2109067 2109063 2109065 2109064 2109066 2109068		205ESR349 2109067 2109063 2109065 2109064 2109066 2109068		206ESR349 2109067 2109063 2109065 2109064 2109066 2109068
Elbow-Pipe (2" x 90°) Nipple (2" Diameter)	----- -----		64C9 63L4		64C9 63N32X150	
Regulator-Temperature * ASM Stem Packing (TRERICE) * Thermal System Kit (TRERICE)	90AR151 2010803 2109498		90AR152 2010803 2109498		90AR152 2010803 2109498	
Regulator-Temperature * ASM Stem Packing (POWERS) * Thermal System Kit (POWERS)	90AR151 2109051 2109490		90AR152 2109051 2109490		90AR152 2109051 2109490	
Valve-Solenoid, Water (NEMA 1) Valve-Solenoid, Water (NEMA 4)	91B3 91B24		91B2 91B23		91B2 91B23	
	VENDOR		VENDOR		VENDOR	
	ADAMS		ADAMS		ADAMS	
Aftercooler	48Z61		48Z62		48Z63	
Separator, Moisture Trap, Separator, Incl. next 3 parts Gasket, Cap Gasket, Retainer Screen, Strainer	83C6 83C41 2109518 2109519 2109520		83C7 83C41 2109518 2109519 2109520		83C7 83C41 2109518 2109519 2109520	

* Furnish as required for repair of complete Temperature Regulator (Kit consists of Remote Bulb, Capillary Tube and Bellows). Make selection of ASM Stem Packing or Thermal System Kit according to manufacturer of regulator.

SELECTIVE ITEMS --- WATER-COOLED UNITS

(SALT WATER SERVICE)

PART NAME & DESCRIPTION	200 HORSEPOWER		250 HORSEPOWER		300 HORSEPOWER	
	VENDOR		VENDOR		VENDOR	
		THERMAL TRANSFER		THERMAL TRANSFER		THERMAL TRANSFER
Heat Exchanger, Incl. next 6 parts: Bracket, Mounting (2) Gasket, Inlet-Outlet Bonnet, Inlet-Outlet Gasket, Return Bonnet, Return Anode-Zinc (2) (USE BRASS FITTINGS)		203ESS349 2109067 2109063 2109077 2109064 2109076 2109068		203ESR349 2109067 2109063 2109077 2109064 2109076 2109068		204ESR349 2109067 2109063 2109077 2109064 2109076 2109068
Regulator-Temperature * ASM Stem Packing (TRERICE) * Thermal System (TRERICE)	90AR104 2010803 2109496		90AR106 2010803 2109496		90AR77 2010803 2109496	
Regulator-Temperature * ASM Stem Packing (POWERS) * Thermal System Kit (POWERS)	90AR104 2109051 2109490		90AR106 2109051 2109490		90AR77 2109051 2109490	

* Furnish as required for repair of complete Temperature Regulator (Kit consists of Remote Bulb, Capillary Tube and Bellows). Make selection of ASM Stem Packing or Thermal System Kit according to manufacturer of regulator.

OIL FILTER, MIN. PRESSURE & THERMAL VALVES

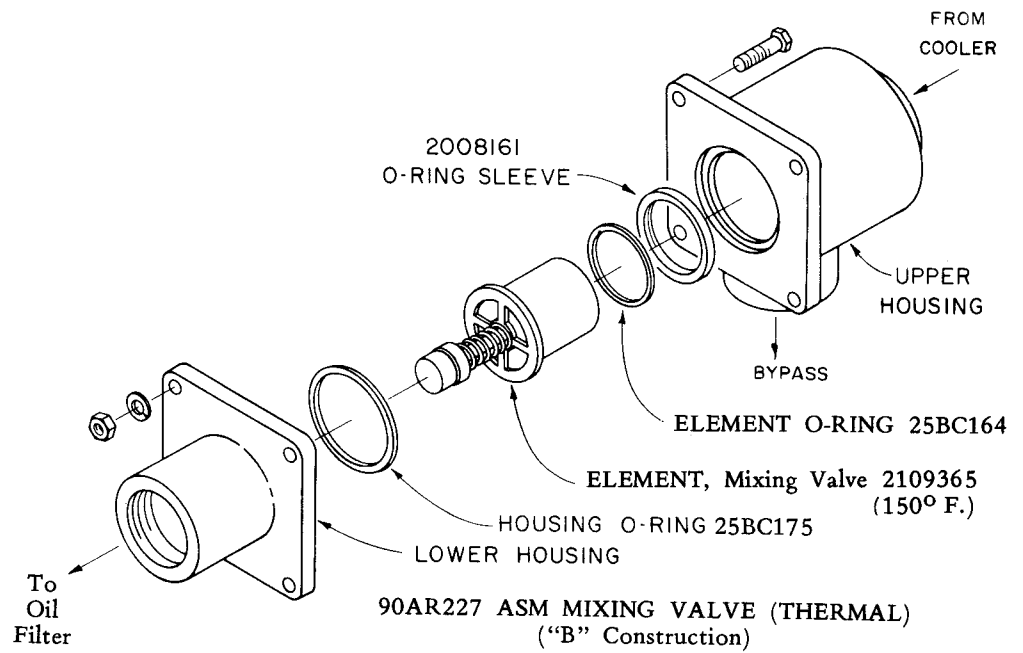
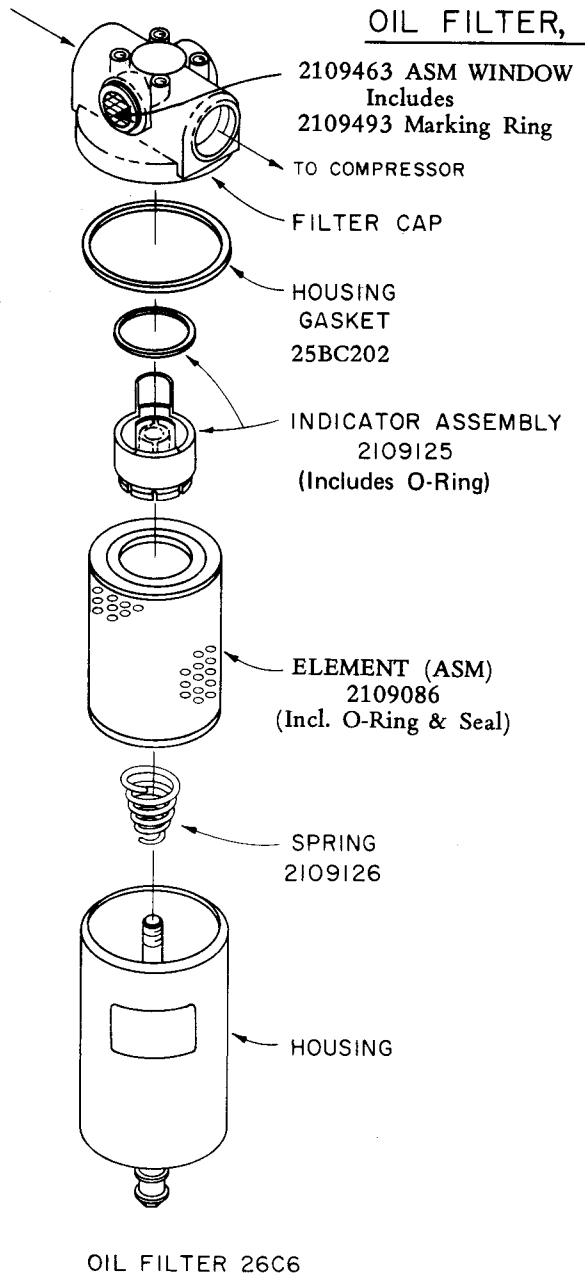

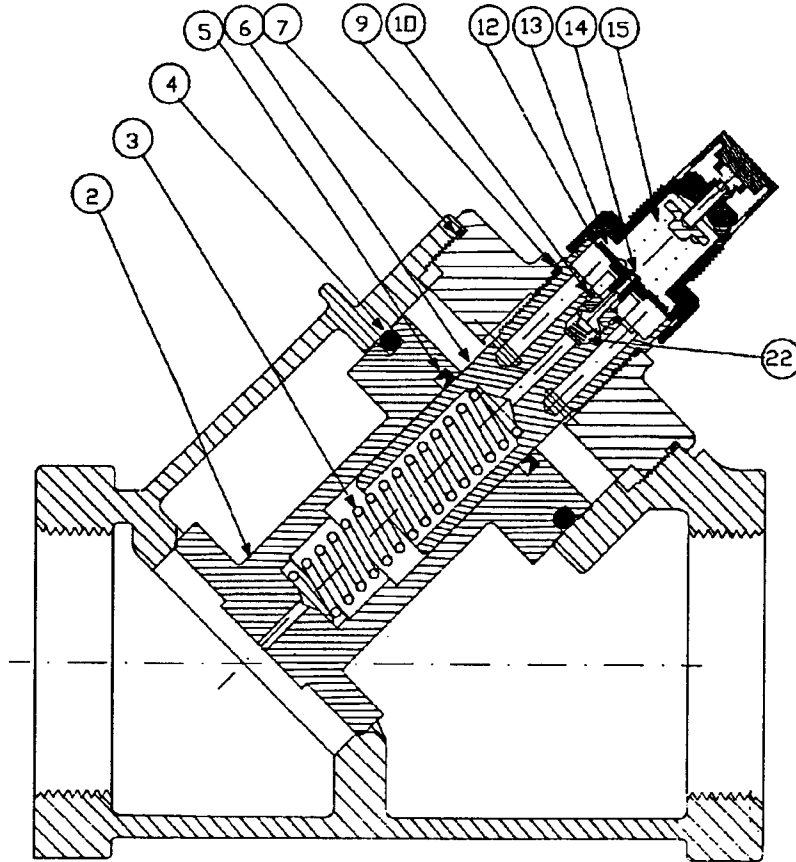

MINIMUM PRESSURE VALVE - 201ECM257

Det. No.	Description	Qty.	G-D Vendor Repair No.
2	VALVE	1	2116606
3	MAIN SPRING.....	1	2116607
4	O-RING	1	2116608
5	U-CUP 1-3/8 x 1-3/4 x 3/16.....	1	2116609
6	REGULATOR HOUSING	1	2116610
7	O-RING	1	2116611
8	O-RING	1	2116612
9	O-RING	1	2116613
12, 13 & 14	DIAPHRAGM-ASSY	1	2116614
	INCLUDES (1) EACH DIAPHRAGM, SUPPORT & RETAINER		
15	MAIN SPRING.....	1	2116615
22	VALVE SPRING.....	1	2116616

COUPLING & MISC. TUBE FITTINGS

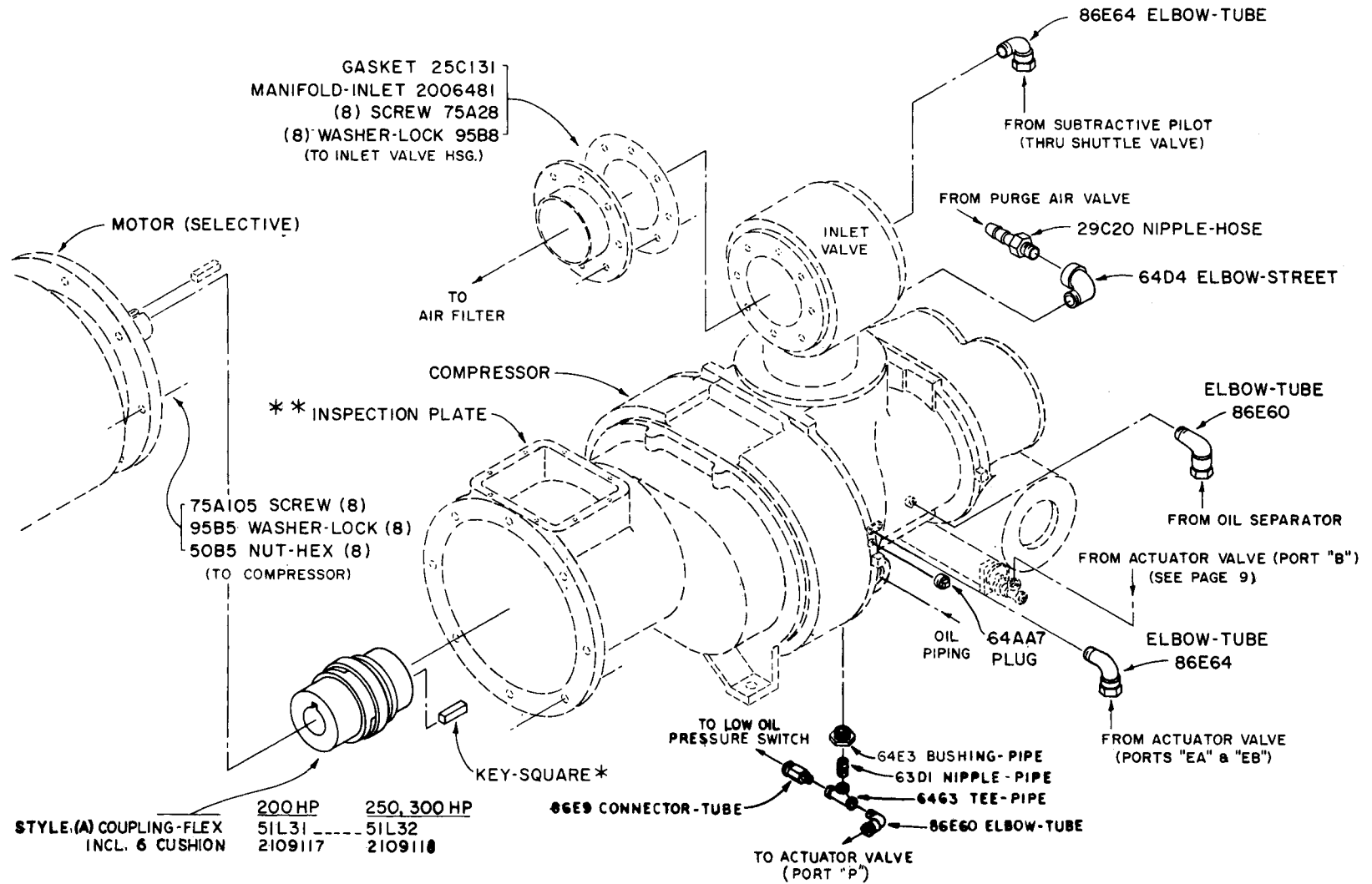

* KEY, TO COMP 35L27 ---- 35L27

* * INSPECTION PLATE WITH VIBRATION SWITCH -- 204SSW247
 INSPECTION PLATE WITHOUT VIBRATION SWITCH -- 201SSW247

BASE & MOUNTING GROUPS*

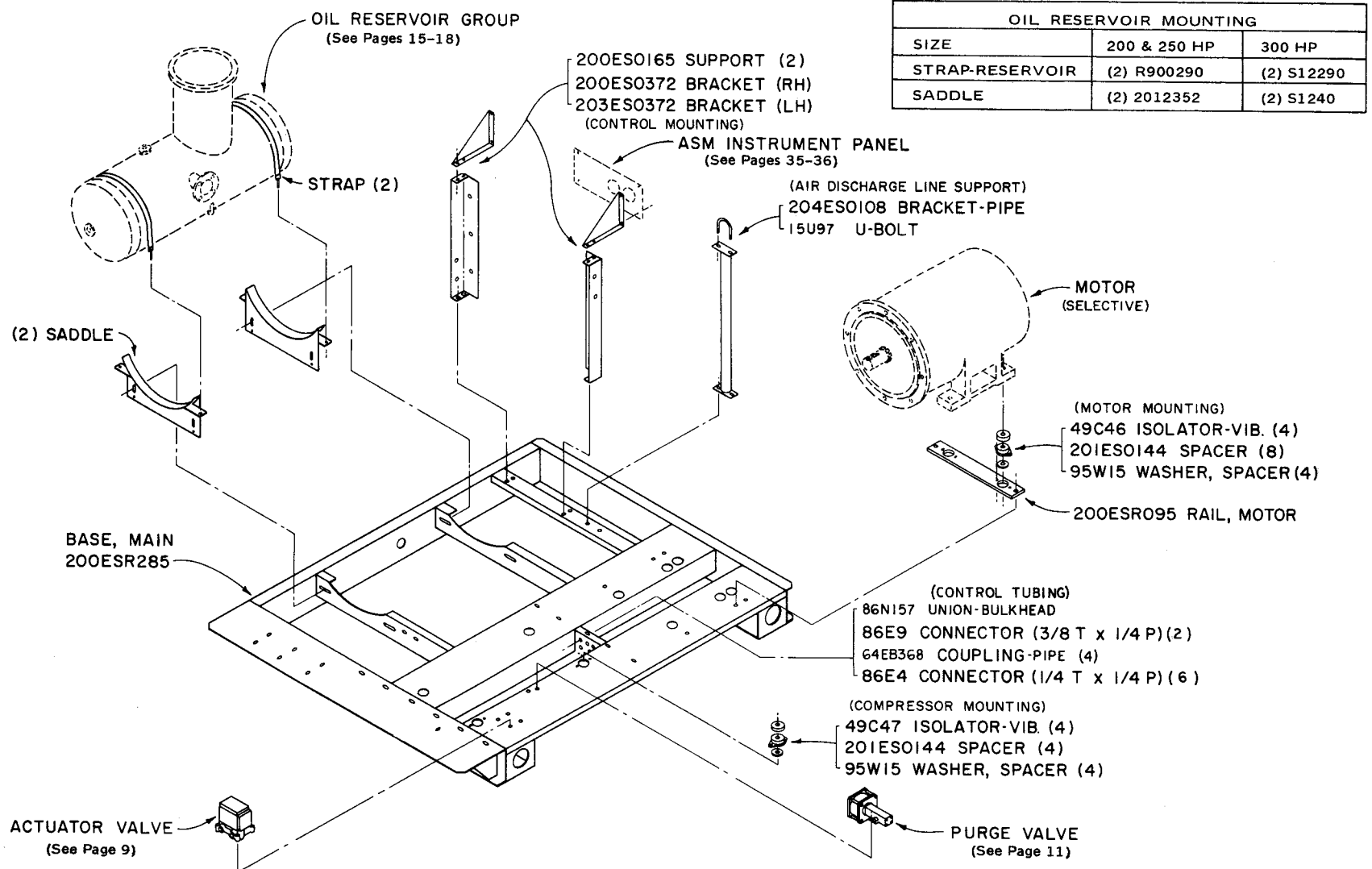

13-10-503 Page 22

* FASTENERS (SCREWS, NUTS, ETC) ARE NOT SHOWN. REFER TO ORDERING INSTRUCTION PAGE.

PART NAME & DESCRIPTION	200 HP	250 HP	300 HP
** Effective with Serial Number	770468	769762	769765
WITHOUT AFTERCOOLER			
ASM MODULE (Complete)	213EAU204	215EAU204	217EAU204
Includes:			
ASM OIL COOLER	2109560	2109561	2109561
FAN	200ESP701	200ESP701	2109563
GUARD-FAN	2109564	2109564	2109565
HUB-BUSHING	22G6 (1-5/8 Bore)	22G6 (1-5/8 Bore)	22G7 (1-5/8 Bore)
WITH AFTERCOOLER (OPTIONAL)			
ASM MODULE (Complete)	212EAU204	214EAU204	216EAU204
Includes:			
ASM OIL COOLER	2109560	2109561	2109561
ASM AFTERCOOLER	2109562	2109562	2109562
FAN	200ESP701	200ESP701	2109563
GUARD-FAN	2109564	2109564	2109565
HUB-BUSHING	22G6 (1-5/8 Bore)	22G6 (1-5/8 Bore)	22G7 (1-7/8 Bore)

* Only major components are shown. For information or repair consult Quincy Sales and Service Office.
 ** Serial Numbers shown are for models built with Aftercoolers.

CONTROL COMPONENTS & TUBING

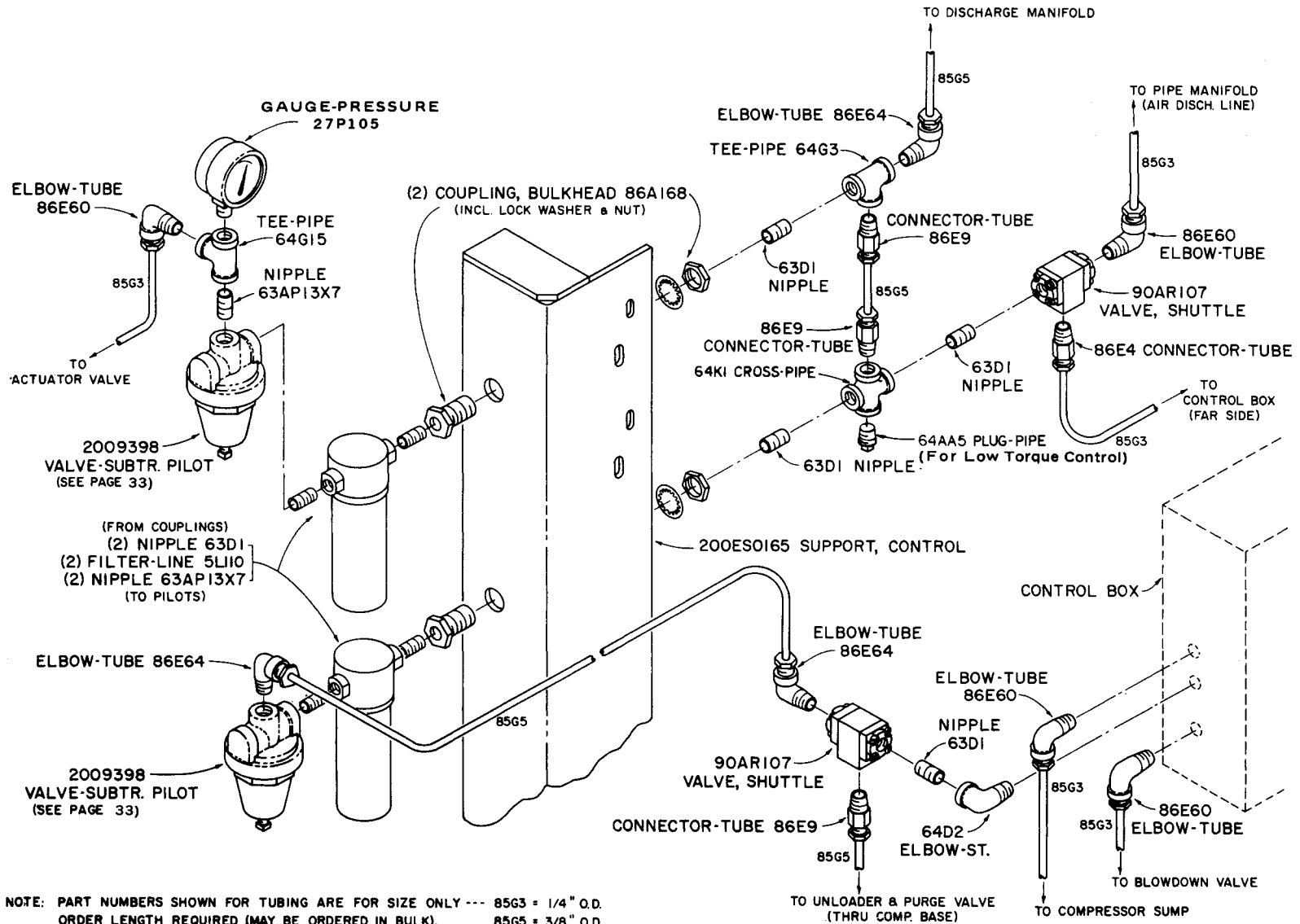

NOTE: PART NUMBERS SHOWN FOR TUBING ARE FOR SIZE ONLY --- 85G3 = 1/4" O.D.
 ORDER LENGTH REQUIRED (MAY BE ORDERED IN BULK). 85G5 = 3/8" O.D.
 * For repair order 2109620 Element Kit and 2116000 O-Ring/Gasket Kit.

REMOTE MOUNTED OIL COOLER FITTINGS

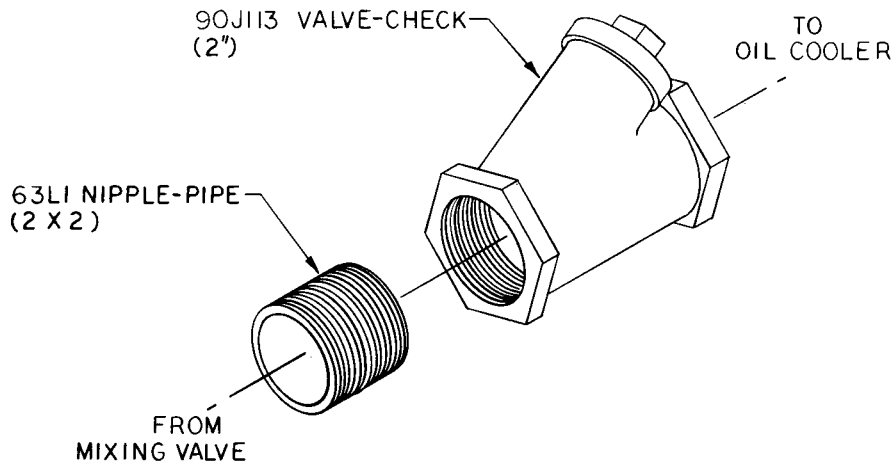
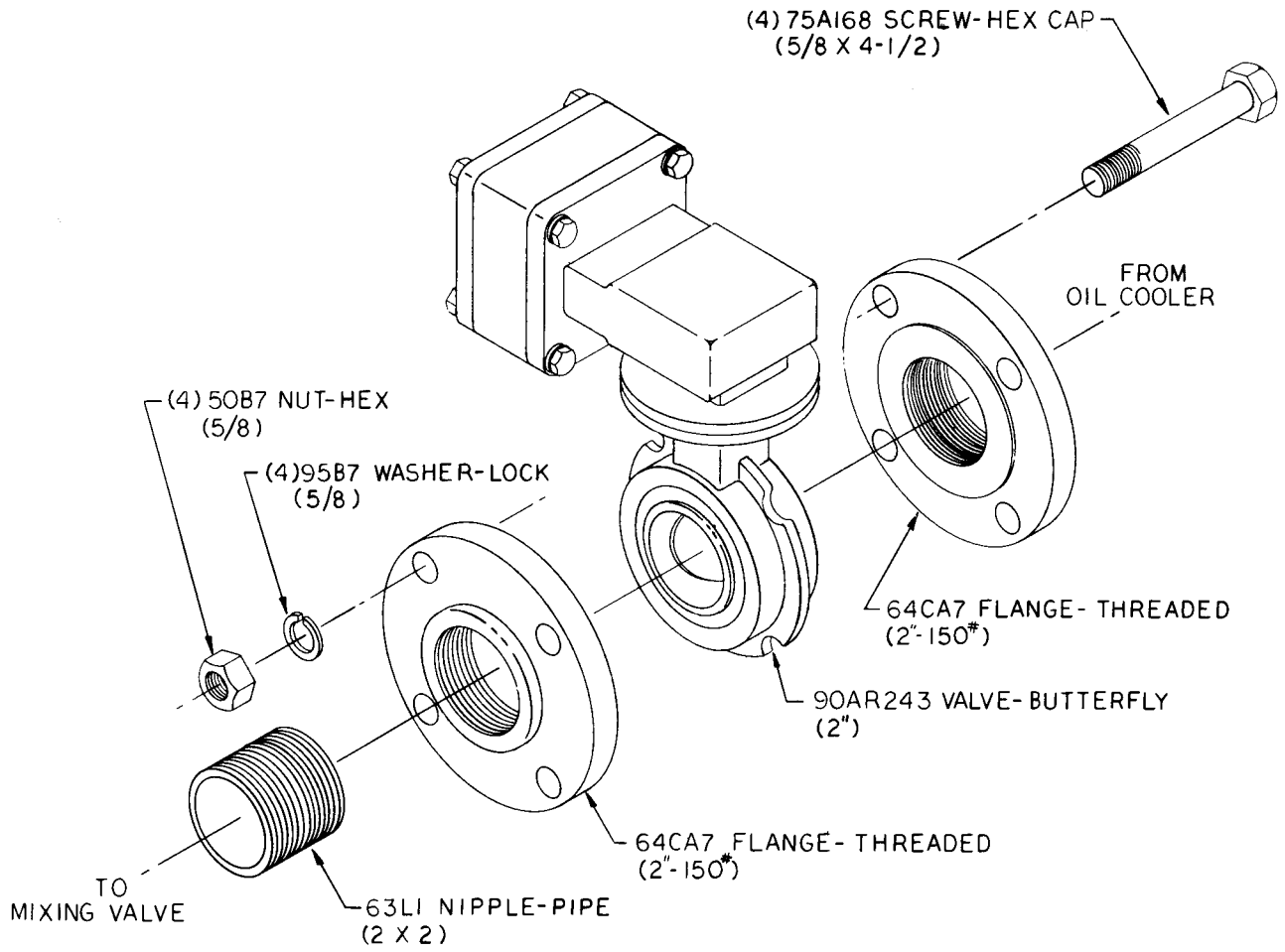

229EAU810

SUBTRACTIVE PILOT VALVE - 2009398

(SEE NOTE)

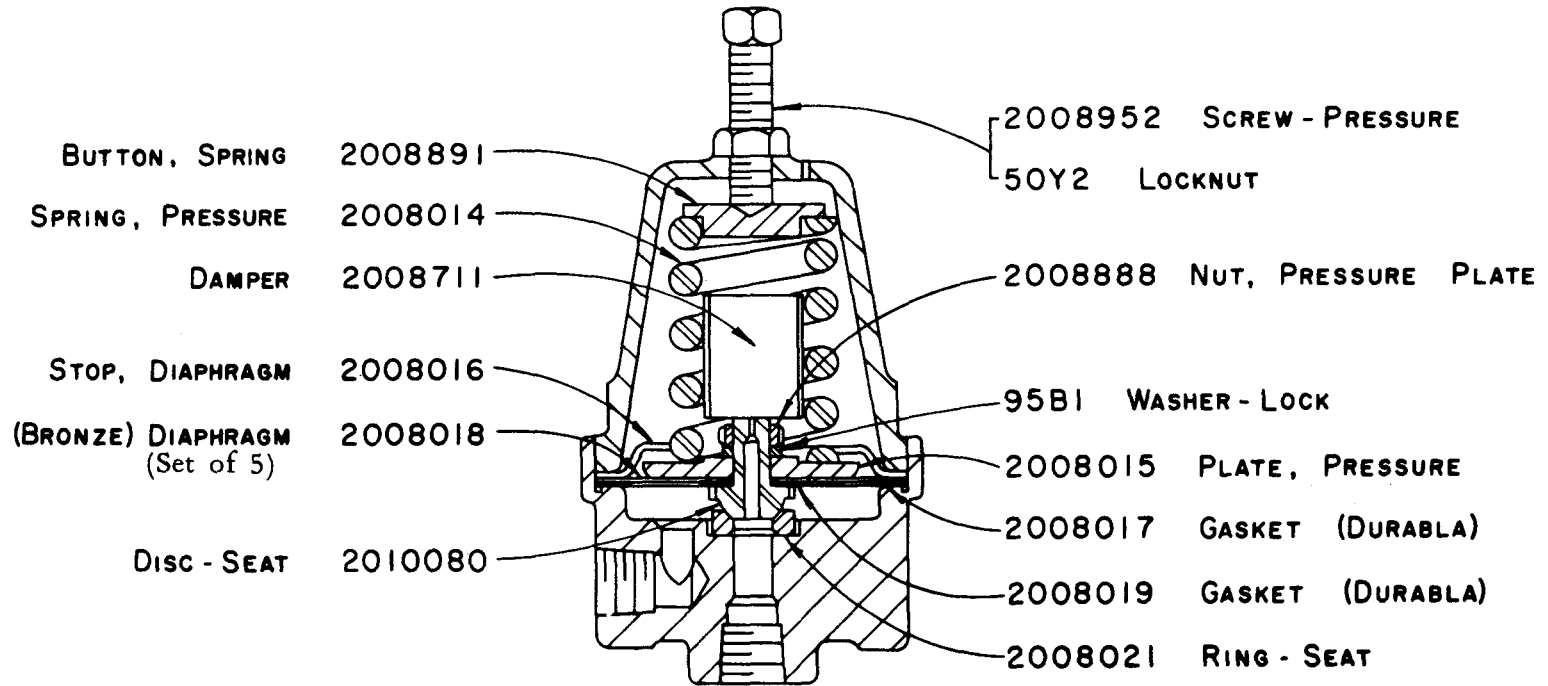

13-10-503 Page 26

B74408X

NOTE: IT IS NECESSARY TO REPLACE SOME PARTS IN GROUPS TO INSURE SATISFACTORY REPAIR. WHEN REPLACING DIAPHRAGM ALSO REPLACE BOTH DIAPHRAGM & SEAT GASKETS. WHEN REPLACING SEAT DISC OR SEAT RING REPLACE ALSO THE MATING SEAT RING OR DISC AND THE SEAT DISC GASKET.

OIL RESERVOIR PRESSURE SWITCH

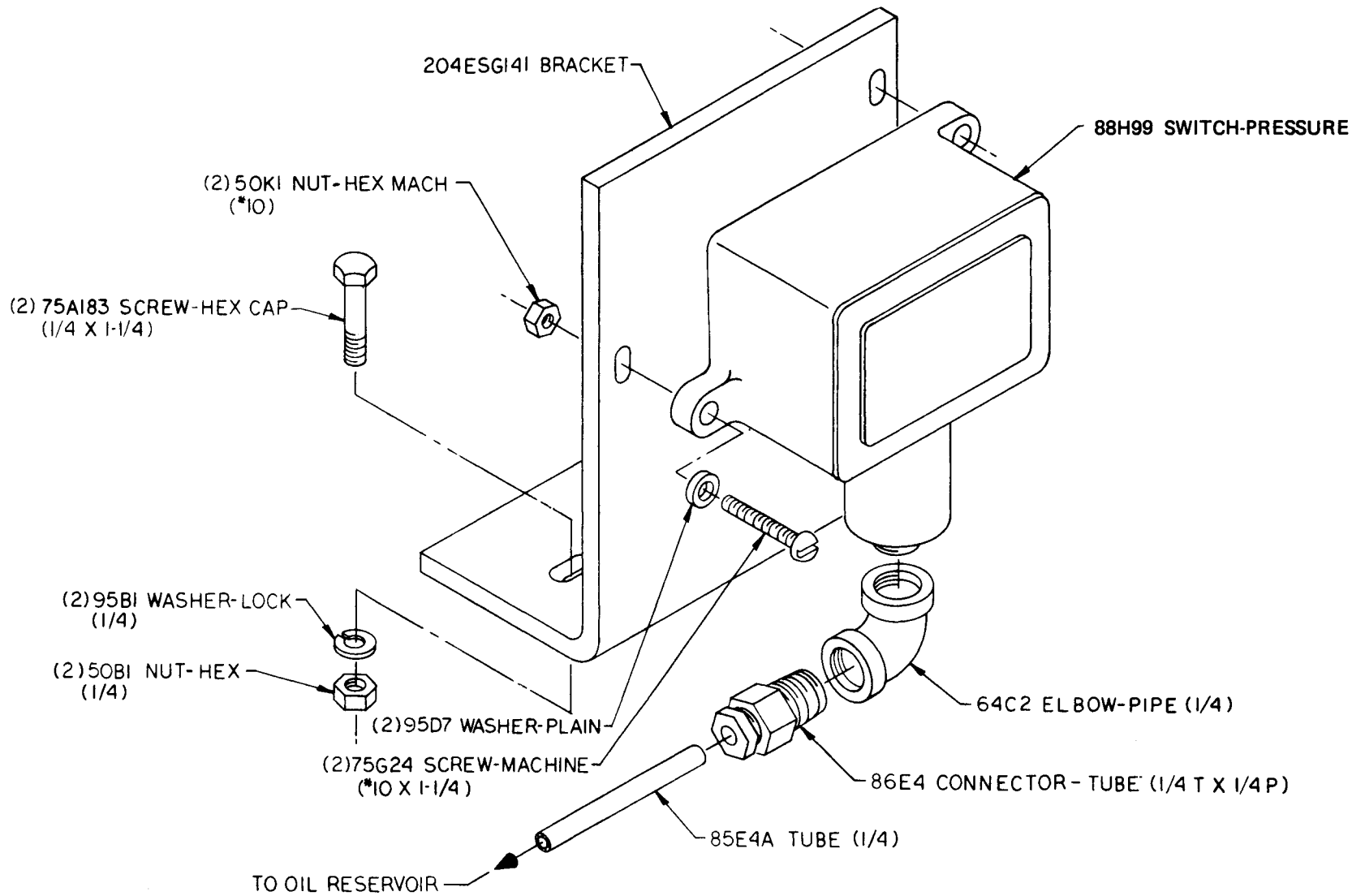

CONTROL ITEMS
(Selective)

Part Name & Description	Constant Speed		Automatic Start-Timed Stop	
	Nema 1	Nema 4	Nema 1	Nema 4
BOX-CONTROL	200ESO179	201ESO179	203EAQ179	204EAQ179
PANEL, Electrical	207ESO216	208ESO216	207ESO216	208ESO216
BOOT, Transparent (PB)	-----	24CA281	-----	24CA281
O-RING, Bulkhead (4)	-----	24A383	-----	24A383
SEAL-PLUG (2)	-----	24A509	-----	24A509
SWITCH, Start/Stop-Reset (Momentary) *	24CA1793	24CA1793	-----	-----
SWITCH, On/Off/Reset (Maintained) **	-----	-----	24CA1817	24CA1817
LAMP, Indicator	24CA40	24CA40	24CA40	24CA40
PILOT LIGHT, Dual Indicating	24CA552	24CA552	24CA552	24CA552
BOX-CONTROL, Timer	-----	-----	-----	200ESK179
GASKET, Control Box	-----	-----	-----	202ESK715
COVER, Timer	-----	-----	-----	202ESK225
GASKET, Timer Cover	-----	-----	-----	203ESK715
TIMER	-----	-----	24A482	24A482
RELAY	24CA541	24CA541	24CA541	24CA541
HOURMETER (50 Hz)	24CA1995	24CA1995	24CA1995	24CA1995
HOURMETER (60 Hz)	24CA1994	24CA1994	24CA1994	24CA1994
TRANSFORMER, 50 Hz (380/400/415V) 250VA	24CA1460	24CA1460	24CA1460	24CA1460
TRANSFORMER, 60 Hz (208/277/380V) 250VA	24CA160	24CA160	24CA160	24CA160
TRANSFORMER, 60 Hz (230/460/575V) 250VA	24CA159	24CA159	24CA159	24CA159
FUSETRON	24CA1026	24CA1026	24CA1026	24CA1026

† Low Torque Control

ASSEMBLY (Complete)	202EAQ564
(Major Components)	
VALVE, Air Control	90AR127
VALVE, Flow Control	90J110
VALVE, Shuttle	90AR107

* Units equipped with Manual Starter use Stop-Reset Switch 24CA1478 with 24CA217 and 24CA1297 Contact Blocks.

** 24CA1817 Switch is "Maintained" ON, and "Momentary" RESET.

† Used only when specified on Order Ticket (Optional Equipment). May be used with either Nema 1 or Nema 4 Controls.

CONTROL SCHEMATIC
(See Footnote)

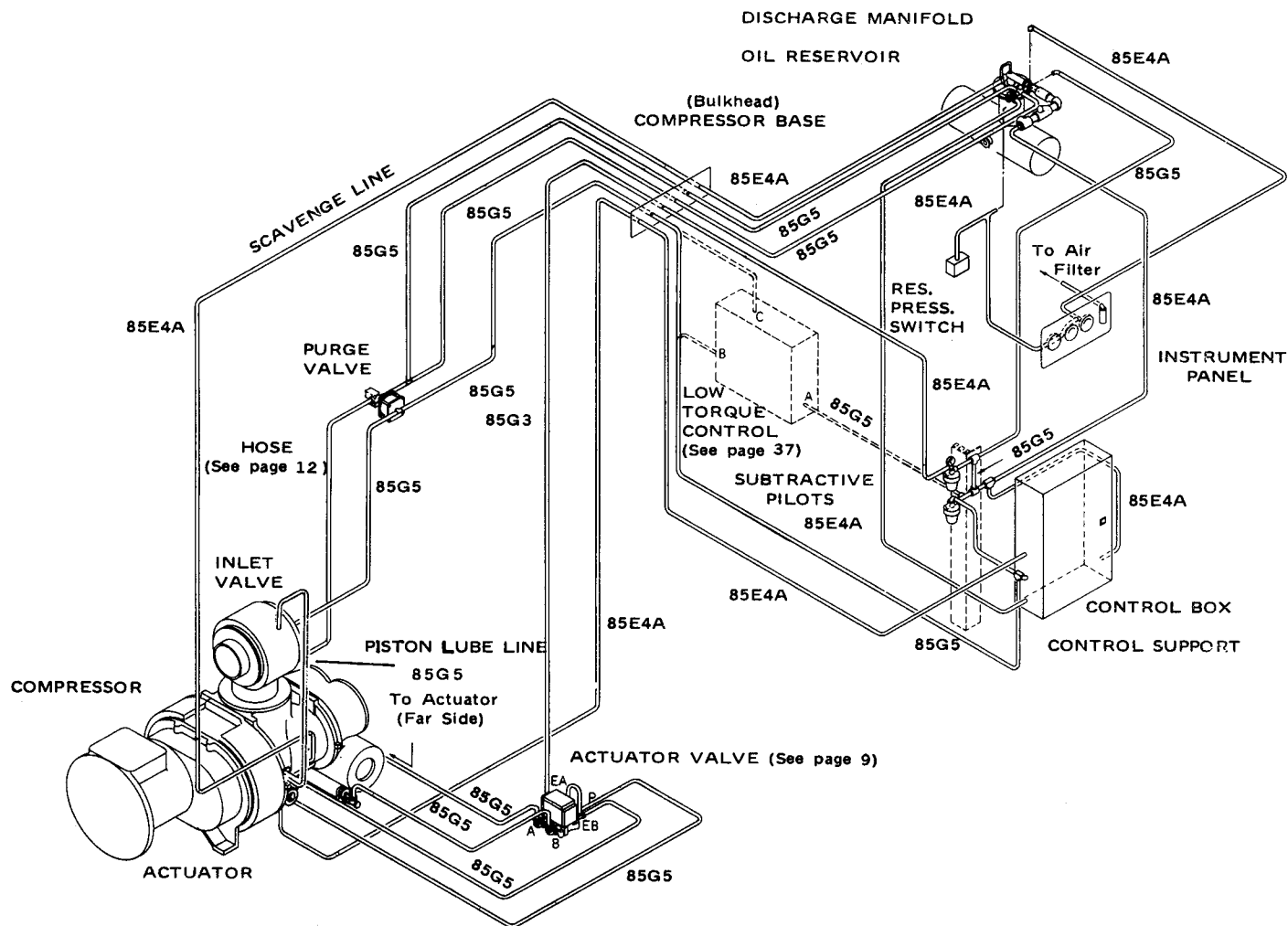

NOTE: Part numbers shown for tubing are for size only — Order length required (may be ordered in bulk).

- 85E4A (Steel) = 1/4" O.D.
- 85G3 (Nylon) = 1/4" O.D.
- 85G5 (Nylon) = 3/8" O.D.

ENCLOSURE GROUP

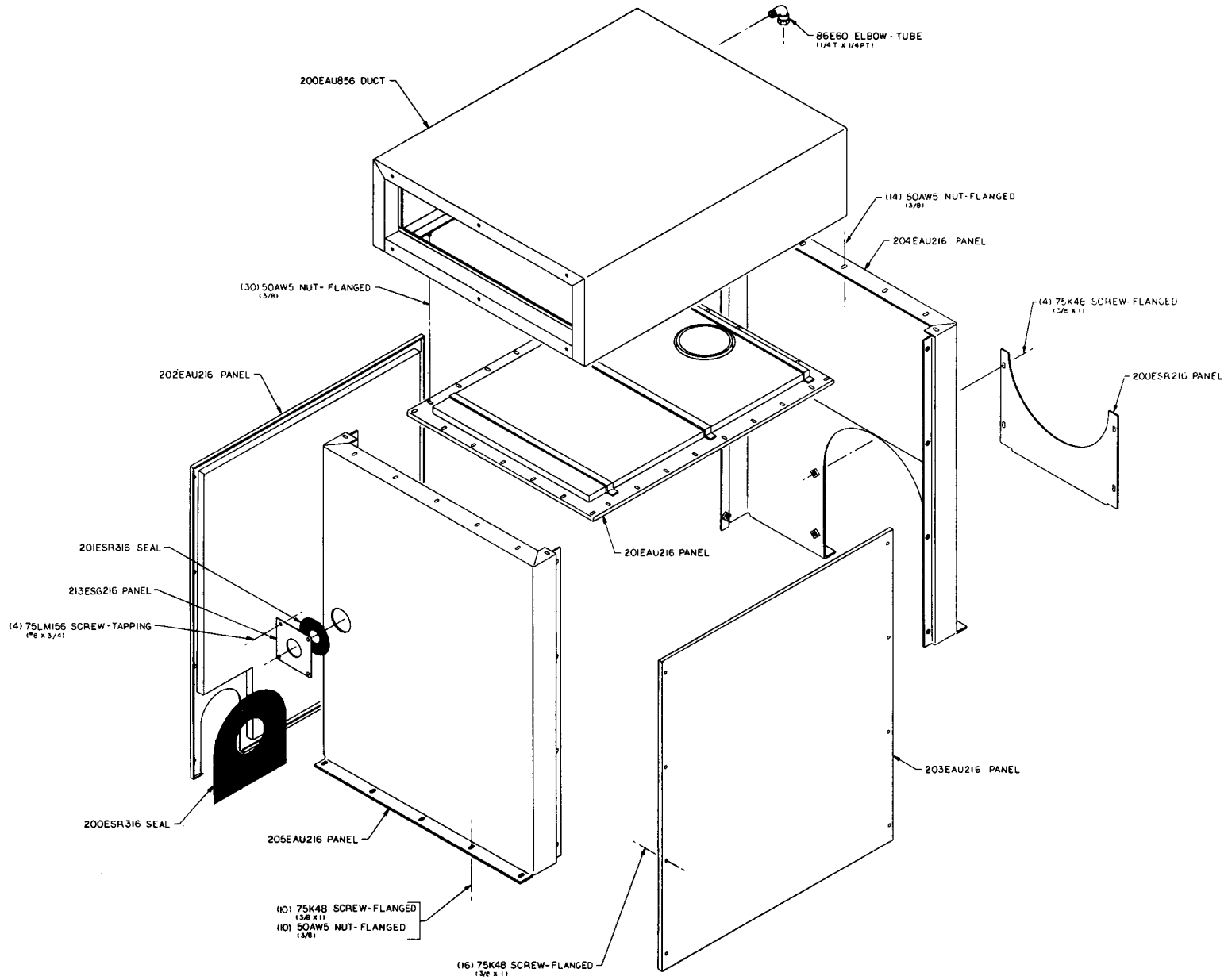

REPAIR KITS

Name of Part	Qty.	200 HP	250 HP	300 HP
ROUTINE MAINTENANCE KIT (3000 Hrs.), Standard Filter, Includes following items.....				
ELEMENT-FILTER.....	3	EAU67715 2109086	EAU67715 2109086	EAU67715 2109086
INDICATOR-ASM.....	1	2109125	2109125	2109125
FILTER-AIR.....	2	5L34	5L34	5L34
ROUTINE MAINTENANCE KIT (3000 Hrs.), Heavy Duty Filter, Includes following items.....				
ELEMENT.....	2	EAU68132 2010485	EAU67714 2010509	EAU67714 2010509
ELEMENT-FILTER.....	3	2109086	2109086	2109086
INDICATOR-ASM.....	1	2109125	2109125	2109125
PERIODIC MAINTENANCE KIT Includes following items				
ELEMENT.....	1	EAU68805 2109365	EAU68805 2109365	EAU68805 2109365
O-RING.....	1	25BC164	25BC164	25BC164
O-RING.....	1	25BC175	25BC175	25BC175
SPRING.....	1	78A365	78A365	78A365
SPRING.....	1	78A366	78A366	78A366
DISC-VALVE.....	1	200SSW067	200SSW067	200SSW067
PERIODIC OVERHAUL KIT, Includes following items				
GASKET KIT.....	1	EAU77788 SSU67269	EAU77788 SSU67269	EAU77788 SSU67269
BEARING-ROLLER.....	2	12BA53	12BA53	12BA53
BEARING-ROLLER.....	1	12BA78	12BA78	12BA78
BEARING-ROLLER.....	1	12BA79	12BA79	12BA79
BEARING-ROLLER.....	1	12BA52	12BA52	12BA52
BEARING-ROLLER.....	1	12W34	12W34	12W34
BEARING-ROLLER.....	2	12C60	12C60	12C60
SEAL-SHAFT.....	1	60DD54	60DD54	60DD54
SCREW-HEX CAP.....	9	75A20N	75A20N	75A20N
SCREW-12 PT CAP.....	1	75LM121	75LM121	75LM121
SEPARATOR KIT, Two Stage, Includes following items				
SEPARATOR KIT, 2nd Stage.....	1	EAU73990 EAU68019	EAU73990 EAU68019	EAU73991 EAU68020
SEPARATOR KIT, 1st Stage.....	1	2014833	2014833	2014834
TUBE.....	1	205ESR857	205ESR857	201ESR857
TEE-TUBE.....	1	86E133	86E133	86E133
CONNECTOR.....	1	86N15	86N15	86N15
SEPARATOR KIT, Pleated, Includes following items				
SEPARATOR-OIL.....	1	EAU80110 55B28	EAU80110 55B28	EAU80127 55B29
TUBE.....	2.5 Ft.	85K3	85K3	85K3
CONNECTOR.....	1	86N15	86N15	86N15
ELBOW-TUBE.....	1	86E95	86E95	86E95
PLUG-SQHD PIPE.....	1	64AA6	64AA6	64AA6
GASKET (ELIMINATOR).....	1	25BC222	25BC222	25BC222

REPAIR KITS

Name of Part	Qty.	200 HP	250 HP	300 HP
PNEUMATIC CONTROL & GAUGES KIT, Includes following items.....		EAU73992	EAU73992	EAU73992
ELEMENT	2	2109620	2109620	2109620
O-RING	2	2116000	2116000	2116000
GAUGE	1	2009562	2009562	2009562
GAUGE-PRESSURE.....	1	27P105	27P105	27P105
REGULATOR-PRESSURE.....	1	88H26	88H26	88H26
VALVE	1	90AR107	90AR107	90AR107
VALVE-AIR CONTROL	1	90AR427	90AR427	90AR427
VALVE-AIR CONTROL	1	90AR114	90AR114	90AR114
VALVE-AIR CONTROL	1	90AR51	90AR51	90AR51
THERMOMETER	1	93F1	93F1	93F1
VALVE-SUBTRACTIVE PILOT.....	2	2009398	2009398	2009398
ELECTRICAL CONTROL KIT, Single Probe, Includes following items.....		EAQ73988	EAQ73988	EAQ73988
SWITCH-PRESSURE.....	1	88A299	88A299	88A299
RELAY	1	24CA285	24CA285	24CA285
SWITCH-PRESSURE.....	1	88A301	88A301	88A301
VALVE-SOLENOID	1	91B34	91B34	91B34
SWITCH-TEMPERATURE	1	21D234	21D234	21D234
SWITCH-PRESSURE.....	1	88H99	88H99	88H99
SWITCH-TEMPERATURE	1	21D235	21D235	21D235
ELECTRICAL CONTROL KIT, Dual Probe, Includes following items.....		EAQ73721	EAQ73721	EAQ73721
SWITCH-PRESSURE.....	1	88A299	88A299	88A299
SWITCH-PRESSURE.....	1	88A301	88A301	88A301
SWITCH-TEMPERATURE	1	21D234	21D234	21D234
SWITCH-TEMPERATURE	1	21D235	21D235	21D235
RELAY	1	24CA285	24CA285	24CA285
VALVE-SOLENOID	1	91B34	91B34	91B34
SWITCH-PRESSURE.....	1	88H99	88H99	88H99



**Gardner-Denver
Industrial Machinery**

For additional information, contact Gardner-Denver Industrial Machinery
Division, 1800 Gardner Expressway, Quincy, Illinois 62305-4024
Telephone (217) 224-8800 FAX 217-224-7814 Telex 404332.

Specifications subject to change without notice.
COPYRIGHT © 1991 Cooper Industries, Inc.

Litho in USA. 25C-8-91