

**ELECTRA-SCREW** <sup>®</sup>

**STATIONARY  
COMPRESSOR**

(BASE MT'D & TANK MT'D)

**MODELS: EBEQH** } **40 HP**  
**EBERH** }

SERIAL NO. \_\_\_\_\_

**Parts List**

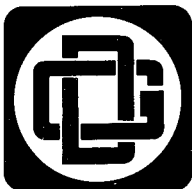

**GARDNER-DENVER**

ELECTRA-SCREW<sup>®</sup> STATIONARY COMPRESSOR

40 HP

THIRTEEN DIGIT MODEL DESIGNATIONS

NOTICE TO CUSTOMER - To find the construction options for your compressor unit, FILL IN THE BALANCE OF LETTERS FROM YOUR COMPRESSOR NAME PLATE . . . . .

	E	B	E	H										
	1	2	3	4	5	6	7	8	9	10	11	12	13	
FOLLOW THE LINE DOWN AND OVER FROM EACH LETTER THUS FILLED IN TO FIND THE APPROPRIATE CONSTRUCTION OPTION WITH WHICH YOUR MACHINE IS EQUIPPED. THE NUMBER "9" IN ANY COLUMN SPACE INDICATES "NOT APPLICABLE." THE NUMBER "8" IN ANY COLUMN SPACE INDICATES SPECIAL DESIGN - REFER TO FACTORY OR ORDER TICKET.														
COLUMNS 1, 2 & 3 - COMPRESSOR TYPE & SIZE (see Pg. 1-3-B1-1 & 1-3-A1-2)														
COLUMN 4 - TYPE OF CONSTRUCTION														
Q - Air Cooled Base Mounted (see Pg. 1-3-B2-3(A))														
R - Air Cooled Tank Mounted (see Pg. 1-3-B2-3(B))														
COLUMN 5 - HORSEPOWER														
H - 40														
COLUMN 6 - ENGINEERING SPEC.														
COLUMN 7 - MOUNTING, AFTERCOOLER & CONDENSATE DRAIN - Letter varies with Tank Size & Options														
A thru G - No Mounted Aftercooler														
H thru N - With Mounted Air Cooled Aftercooler														
COLUMN 8 - PRESSURE (see Pg. 1-3-A2-6a)														
E - 100 PSIG														
H - 125 PSIG														
M - 150 PSIG														
P - 175 PSIG														
COLUMN 9 - ELECTRICAL CONTROL - Letter varies with Voltage & Hz														
A thru I - NEMA I - If Starter is furnished														
J thru R - NEMA IV - If Starter is furnished														
U - NEMA I - No Starter furnished														
V - NEMA IV - No Starter furnished														
COLUMN 10 - CONTROL - Letter varies with Starter														
A - B - C - Dual Control/Air or Water Cooled without Shutoff Valve														
D - E - F - Modulating Control/Air or Water Cooled without Shutoff Valve														
COLUMN 11 - COMPRESSOR DRIVE MOTOR														
MOTORS NOT LISTED IN THIS BOOK - When ordering replacement motor for your unit it is MOST IMPORTANT THAT THE COMPLETE thirteen digit model number is given in order to obtain correct drive motor.														
COLUMN 12 - ENCLOSURE, AIR FILTER & MIXING VALVE														
A - No sound Enclosure / Standard Air Filter / No Mixing Valve														
B - No Sound Enclosure / Heavy Duty Air Filter / No Mixing Valve														
E - No Sound Enclosure / Standard Air Filter / with Mixing Valve (see Pg. 1-3-A2-4 & 1-3-A2-5)														
F - No Sound Enclosure / Heavy Duty Air Filter / with Mixing Valve (see Pg. 1-3-A2-4 & 1-3-A2-5)														
COLUMN 13 - PRESSURE SWITCH & GAUGE (see Pg. 1-3-A2-6)														
A - NEMA I - Base Mounted														
B - NEMA I - Tank Mounted														
C - NEMA IV - Base Mounted														
D - NEMA IV - Tank Mounted														

ELECTRA-SCREW® STATIONARY COMPRESSOR

40 HP

THIRTEEN DIGIT MODEL DESIGNATIONS

NOTICE TO CUSTOMER – To find the construction options for your compressor unit, FILL IN THE BALANCE OF LETTERS FROM YOUR COMPRESSOR NAME PLATE . . . . .

E B E H

COLUMN NUMBER: 1 2 3 4 5 6 7 8 9 10 11 12 13

FOLLOW THE LINE DOWN AND OVER FROM EACH LETTER THUS FILLED IN TO FIND THE APPROPRIATE CONSTRUCTION OPTION WITH WHICH YOUR MACHINE IS EQUIPPED. THE NUMBER "9" IN ANY COLUMN SPACE INDICATES "NOT APPLICABLE." THE NUMBER "8" IN ANY COLUMN SPACE INDICATES SPECIAL DESIGN – REFER TO FACTORY OR ORDER TICKET.

COLUMNS 1, 2 & 3 – COMPRESSOR TYPE & SIZE (see Pg. 1-3-B1-1 & 1-3-A1-2)

COLUMN 4 – TYPE OF CONSTRUCTION  
Q – Air Cooled Base Mounted (see Pg. 1-3-B2-3(A))  
R – Air Cooled Tank Mounted (see Pg. 1-3-B2-3(B))

COLUMN 5 – HORSEPOWER  
H – 40

COLUMN 6 – ENGINEERING SPEC.

COLUMN 7 – MOUNTING, AFTERCOOLER & CONDENSATE DRAIN – Letter varies with Tank Size & Options  
A thru G – No Mounted Aftercooler  
H thru N – With Mounted Air Cooled Aftercooler

COLUMN 8 – PRESSURE (see Pg. 1-3-A2-6a)  
E – 100 PSIG                      M – 150 PSIG  
H – 125 PSIG                      P – 175 PSIG

COLUMN 9 – ELECTRICAL CONTROL – Letter varies with Voltage & Hz  
A thru I – NEMA I – If Starter is furnished  
J thru R – NEMA IV – If Starter is furnished  
U – NEMA I – No Starter furnished  
V – NEMA IV – No Starter furnished

COLUMN 10 – CONTROL – Letter varies with Starter  
A – B – C – Dual Control/Air or Water Cooled without Shutoff Valve  
D – E – F – Modulating Control/Air or Water Cooled without Shutoff Valve

COLUMN 11 – COMPRESSOR DRIVE MOTOR  
MOTORS NOT LISTED IN THIS BOOK - When ordering replacement motor for your unit it is MOST IMPORTANT THAT THE COMPLETE thirteen digit model number is given in order to obtain correct drive motor.

COLUMN 12 – ENCLOSURE, AIR FILTER & MIXING VALVE  
A – No sound Enclosure / Standard Air Filter / No Mixing Valve  
B – No Sound Enclosure / Heavy Duty Air Filter / No Mixing Valve  
E – No Sound Enclosure / Standard Air Filter / with Mixing Valve (see Pg. 1-3-A2-4 & 1-3-A2-5)  
F – No Sound Enclosure / Heavy Duty Air Filter / with Mixing Valve (see Pg. 1-3-A2-4 & 1-3-A2-5)

COLUMN 13 – PRESSURE SWITCH & GAUGE (see Pg. 1-3-A2-6)  
A – NEMA I – Base Mounted  
B – NEMA I – Tank Mounted  
C – NEMA IV – Base Mounted  
D – NEMA IV – Tank Mounted

TABLE OF CONTENTS

BASE MOUNTED                      TANK MOUNTED

40 HP MODELS . . . . . EBEQH . . . . . EBERH

GROUP NAME	PAGE NO.
Ordering Instructions	1-3-A1-0
Compressor (Complete) Oil Filter Oil Seal Bearings Compressor Replacement & Gasket Kits	1-3-B1-1
Inlet Valve (Unloader) & Air Filter	1-3-A1-2
Oil Reservoir Group (Base-Mounted Units)	1-3-B2-3 (A)
Oil Reservoir Group (Tank-Mounted Units) Oil Separator & Return Line Oil Level Gauge Service & Check Valves Discharge Air Piping Oil Piping	1-3-B2-3 (B)
Radiator Group Oil Cooler	1-3-A2-4
Mixing Valve (Component Parts)	1-3-A2-5
Control Items (Selective & Optional) Valves, Switches, Tubing, etc.	1-3-A2-6
Drive Components (Selective) Sheaves, V-Belts, etc.	1-3-A2-6a
Modulating Control Group (Optional) (w/Subtractive Pilot)	1-3-A2-7
Recommended Spares (Kits)	1-3-B2-8

### INSTRUCTIONS FOR ORDERING REPAIR PARTS

When ordering parts, specify Compressor **MODEL, OPERATING PRESSURE, RPM, HORSEPOWER** and **SERIAL NUMBER** (see nameplate on unit). Serial Number is also stamped on top of the cylinder flange.

**All orders for Parts should be placed with the nearest Sales and Service Office**

**DO NOT ORDER BY SETS OR GROUPS.** Where **NOT** specified, quantity of parts required per compressor or unit is one (1); where more than one is required per unit, quantity is indicated in parenthesis. **SPECIFY EXACTLY THE NUMBER OF PARTS REQUIRED.**

**PARTS NOT SHOWN OR LISTED:** Special parts such as Solenoid and Safety Valves, Motors, Sheaves, Transformers, etc. that require ordering according to voltage, pressure or speed, must be referred to the **FACTORY** and **MUST BE ORDERED** by **MODEL** and **SERIAL NUMBER**.

Piping, hardware and electrical connections may be purchased locally. However, **IT IS THE RESPONSIBILITY OF THE CUSTOMER** when making repairs to purchase parts of **EQUAL** or **BETTER** quality as those used in the original construction.

### PARTS RETURNED

All claims must be made within five days after receipt of goods. If order has been filled correctly, we cannot allow the return of the goods without our consent and then only on a basis of a charge for service and rehandling plus transportation charges.

Transportation charges must be prepaid. If it is necessary to return a part to the factory for duplication or inspection, do not fail to do the following:

1. Write the nearest Sales and Service Office a letter advising what material you wish to return and why.
2. After receiving permission to return the item or items, obtain from the Sales and Service Office the correct forms filled out by that office for the proper return of material.
3. Place a tag in the package showing your name and address.
4. Tag each article in the box or package stating what and how many are returned.
5. Always give the serial number of the machine from which the parts were removed or the invoice number on which the parts were originally shipped.

All parts returned for credit should be handled in the same manner as that for duplication or inspection.

ASM EBEB†

# COMPRESSOR

GARDNER-DENVER COMPRESSOR

1-3-B1-1

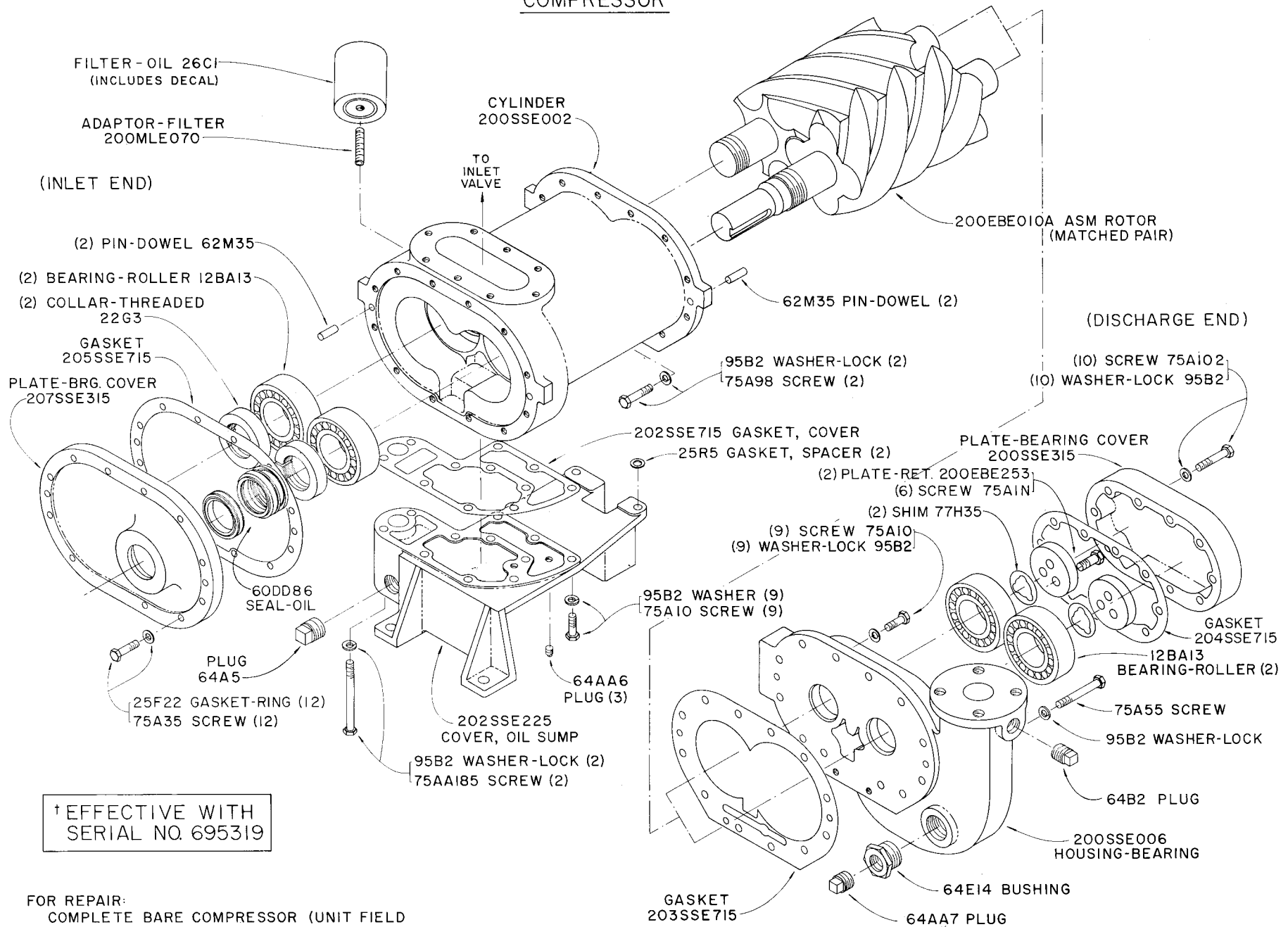

†EFFECTIVE WITH SERIAL NO. 695319

FOR REPAIR:  
COMPLETE BARE COMPRESSOR (UNIT FIELD REPLACEMENT)-- ORDER PART NO. EBE68234;  
GASKET KIT-- ORDER PART NO. SSE65855.

E76119

REVISED FEB, 1981

1-3-B1-1

INLET VALVE & AIR FILTER

(COMPLETE)  
ASM INLET HSG. & VALVE  
200SSE041A

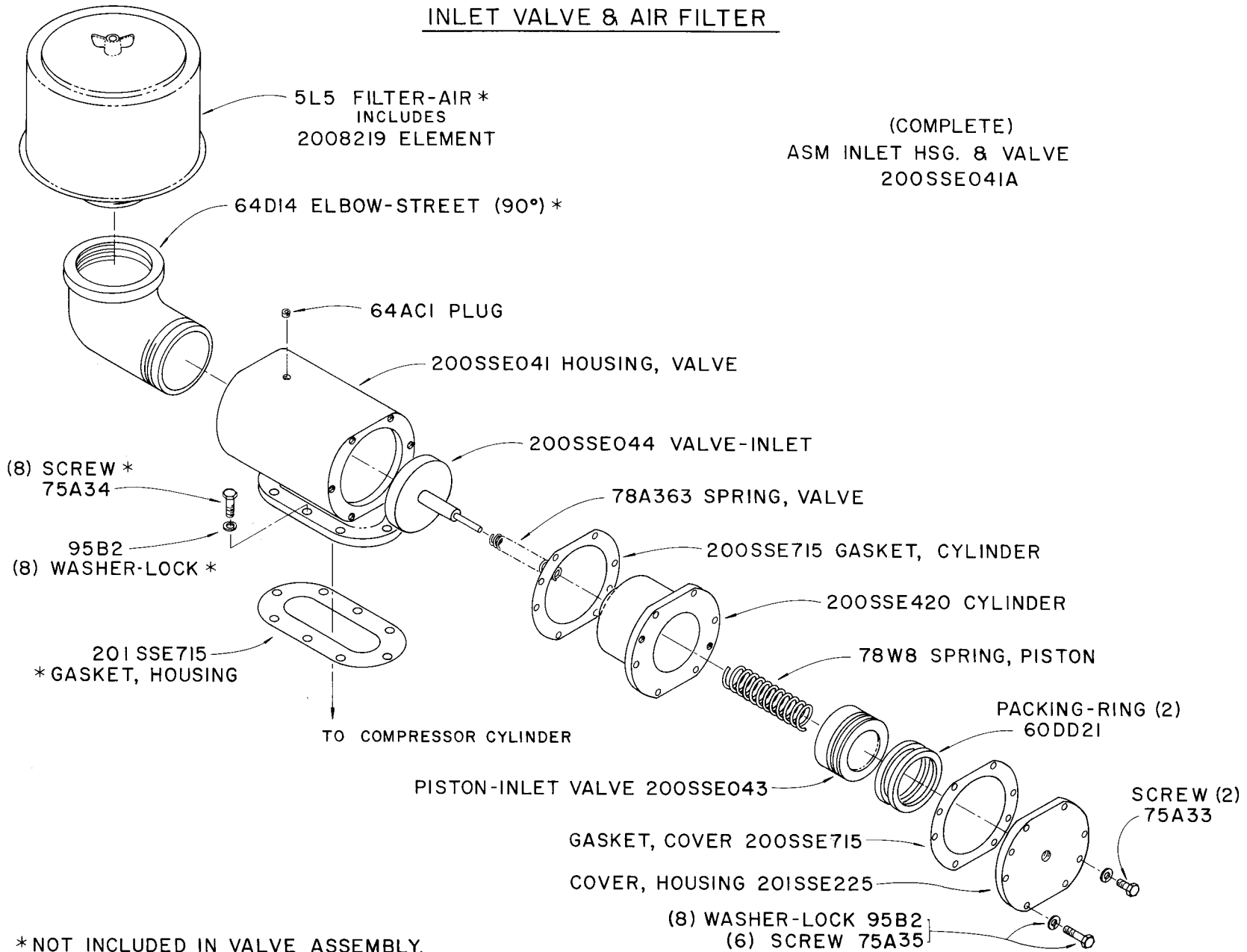

\* NOT INCLUDED IN VALVE ASSEMBLY.

D75235

E76117

OIL RESERVOIR GROUP  
(BASE MOUNTED UNITS)

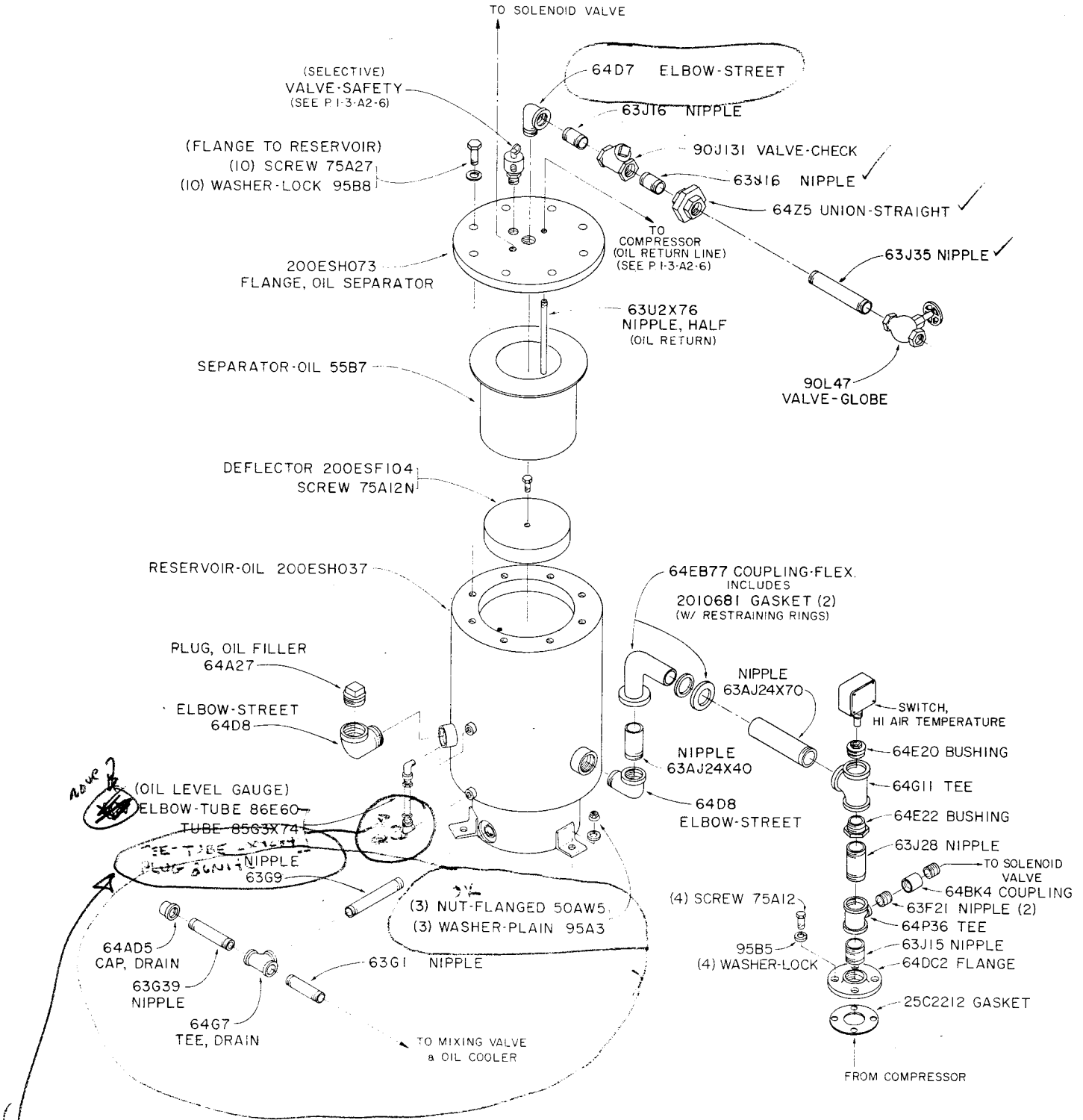

Tee = 2009284  
Plug = 86N142

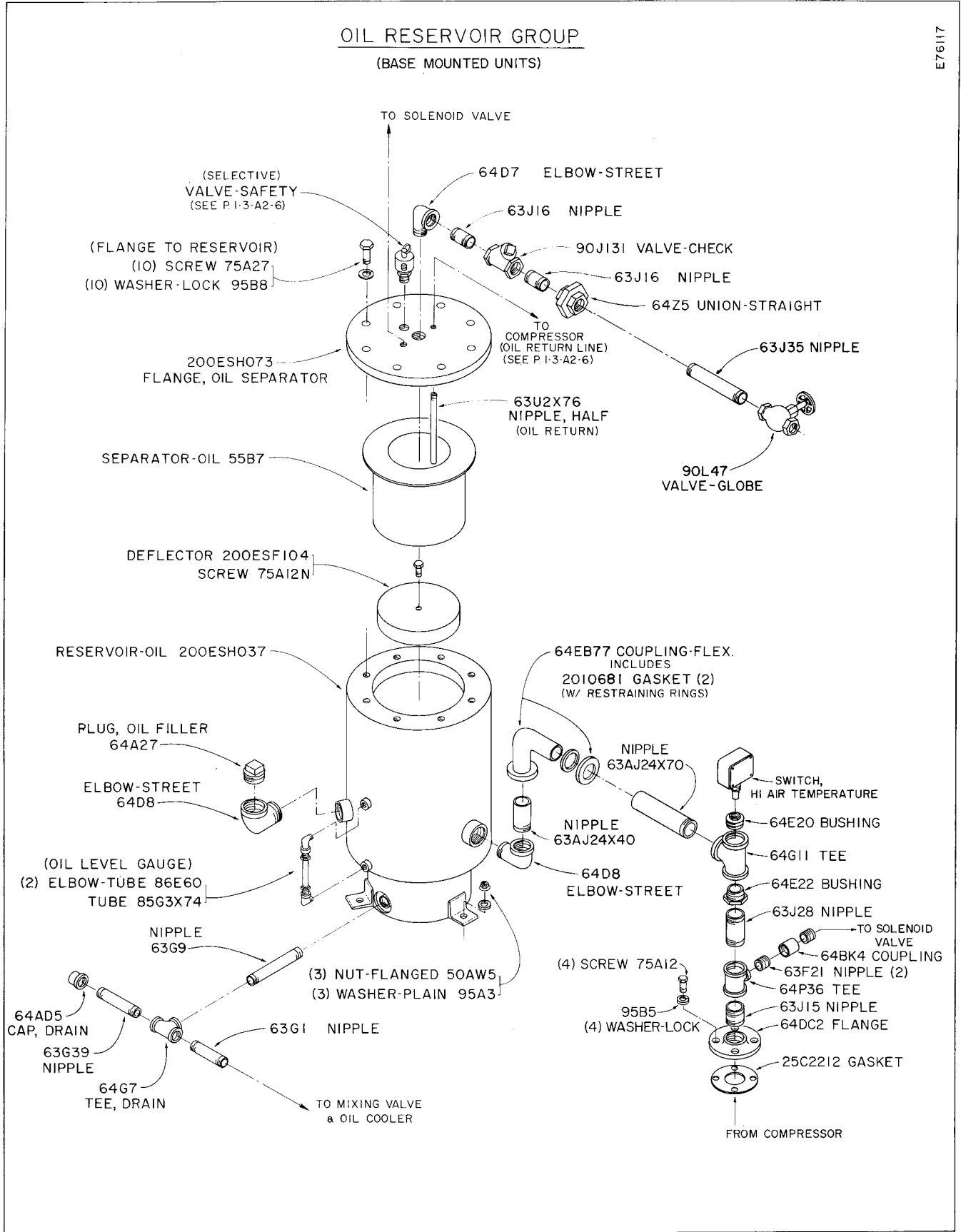

E76117

**OIL RESERVOIR GROUP**  
(TANK MOUNTED UNITS)

ET6118

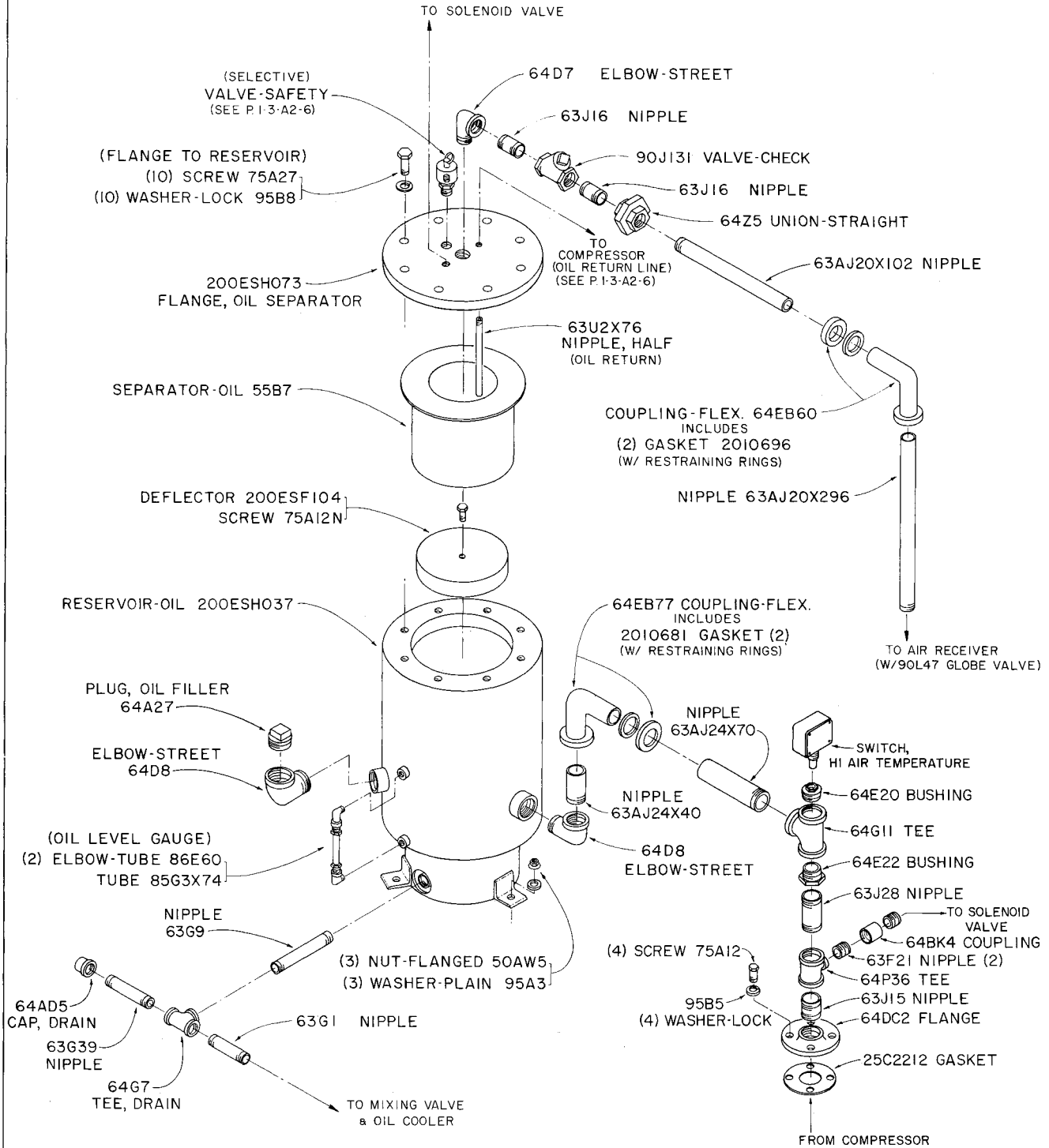

RADIATOR GROUP

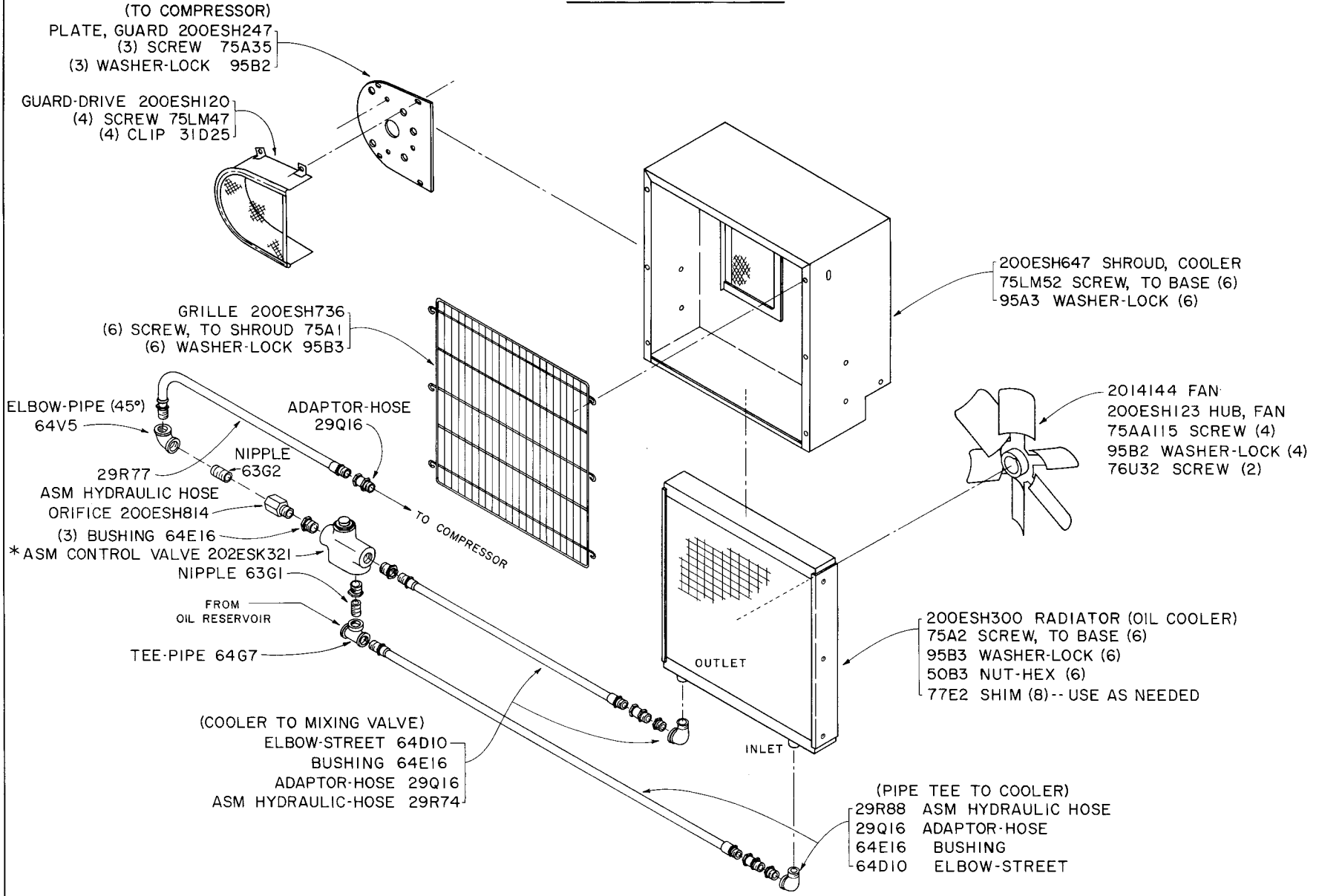

I-3-A2-4

\* FOR COMPONENT PARTS OF (MIXING) VALVE SEE PAGE 5.

D75592

ASM CONTROL VALVE - 202ESK321

(THERMOSTATIC MIXING)

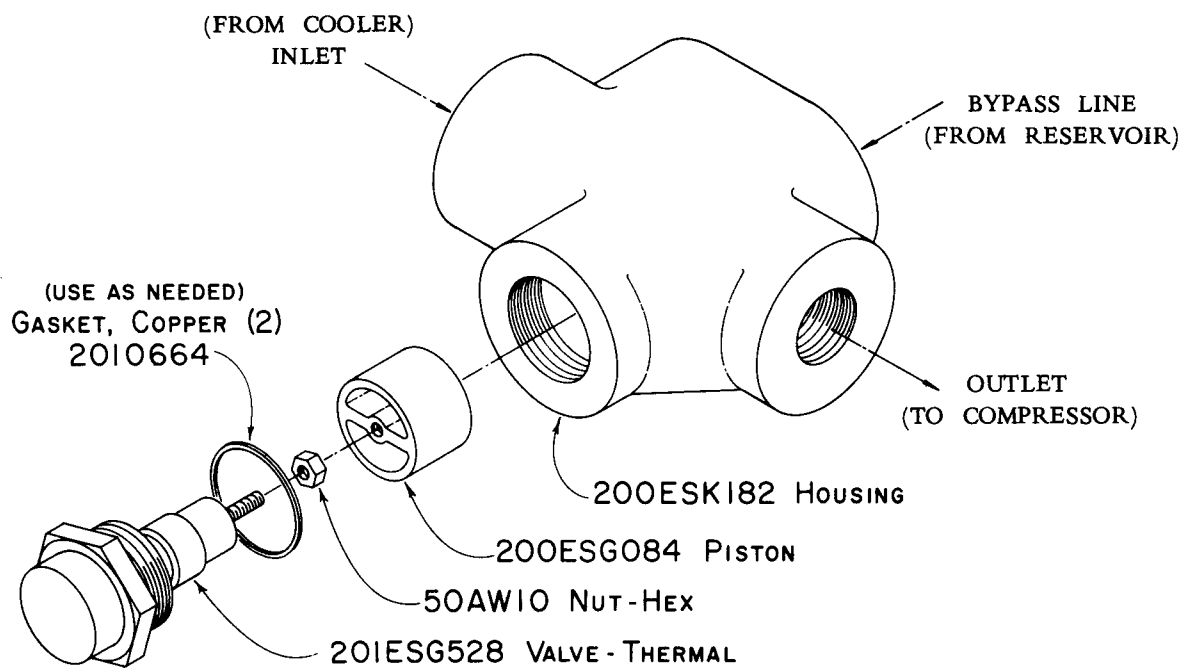

## CONTROL ITEMS (SELECTIVE)

PART NAME & DESCRIPTION	PART NO.
<b>CONTROL COMPONENTS</b>	
VALVE-SOLENOID (Unloader/Blowdown & Purge Air):	
NEMA 1 (60 Hz, 175 PSI Max.):	120 Volt 208 Volt 230/460 Volt 575 Volt
	90AC162 90AR1 90AC161 90AC177
NEMA 4 (60 Hz, 175 PSI Max.):	120 Volt 208 Volt 230/460 Volt 575 Volt
	90AC163 91B26 90AC164 91B27
SWITCH, Pressure (NEMA 1)	88A305
SWITCH, Pressure (NEMA 4)	88A294
SWITCH, Hi Temperature Shutdown (NEMA 1)	21D5
SWITCH, Hi Temperature Shutdown (NEMA 4)	21D9
GAUGE, Air Pressure (0-300 Max.)	27A114
ASM CONTROL VALVE (Mixing)	See Page 5
VALVE, Safety (Tank-Mounted Units Only) (In Receiver)	90G222
VALVE, Automatic Drain (OPTIONAL)	90K84
SAFETY VALVE (Top of Reservoir):	
100 PSI	90AR65
125 PSI	90AR66
150 PSI (w/64R12 Bushing)	90G252
175 PSI (w/64R12 Bushing) (w/O.D.P. Motor)	90G264
175 PSI (w/64R12 Bushing) (w/T.E.F.C. Motor)	90G222
<b>CONTROL PIPING &amp; TUBING</b>	
(Reservoir to Compressor)	
ELBOW-TUBE (1/8 P x 1/4 T)	86E59
TUBE, Oil Return (1/4)	85G3X600
STRAINER (1/8)	82E1
ORIFICE (.047)	200ESF814
TEE-PIPE, to Solenoid Valve (1/8)	64G2
NIPPLE-PIPE (1/8 x 2)	63C5
(Pipe Tee to Solenoid Valve)	
ELBOW-TUBE (1/8 P x 3/8 T)	86E63
TUBE (3/8)	85G5X300
ELBOW-TUBE (3/8 T x 1/2 P)	86M18
VALVE, Purge Air	Selective
NIPPLE-PIPE, to Discharge Manifold (1/2 x 1-1/2)	63F1
(Unloader to Solenoid Control Valve)	
ORIFICE (.020)	95AUX113
NIPPLE-PIPE (1/4 x 2)	63U4X20
TEE-PIPE (1/4)	64G3
NIPPLE-PIPE (1/4 x 7/8)	63D1
BUSHING-PIPE (1/4 to 1/2) (In Valve)	64E2
(Unloader Bypass)	
CONNECTOR-TUBE (1/4 P x 3/8 T)	86E9
TUBE (3/8)	85G5X120
ELBOW-TUBE (3/8 T x 1/8 P)	86E63
(Solenoid Valve to Oil Reservoir)	
ELBOW-TUBE (1/2 P x 3/8 T)	86E199
TUBE (3/8)	85G5X600
ELBOW-TUBE (3/8 T x 1/4 P)	86E64
MODULATING CONTROL GROUP (Optional) (w/Subtractive Pilot)	See Page 7

**DRIVE COMPONENTS**

(SELECTIVE)

PART NAME & DESCRIPTION	PART NO.
<b>OPEN DRIP-PROOF (ODP) MOTOR</b>	
(100 PSI): Compressor Sheave Motor Sheave V-Belts (Matched Set)	73M53V56 200ESH099 13N7505
(125 PSI): Compressor Sheave Motor Sheave V-Belts (Matched Set)	73M53V60 200ESH099 13N7505
(150 PSI): Compressor Sheave Motor Sheave V-Belts (Matched Set)	73M53V69 200ESH099 13N7505
(175 PSI): Compressor Sheave Motor Sheave V-Belts (Matched Set)	73M53V80 200ESH099 13N7505
Key, Compressor	35B139
<b>TOTALLY ENCLOSED FAN-COOLED (TEFC) MOTOR</b>	
(100 PSI): Compressor Sheave Motor Sheave V-Belts (Matched Set)	73M53V56 200ESH099 13N7505
(125 PSI): Compressor Sheave Motor Sheave V-Belts (Matched Set)	73M53V60 200ESH099 13N7505
(150 PSI): Compressor Sheave Motor Sheave V-Belts (Matched Set)	73M53V69 200ESH099 13N7505
(175 PSI): Compressor Sheave Motor Sheave V-Belts (Matched Set)	73M53V80 200ESH099 13N7505
Key, Compressor	35B139

**CONSTANT SPEED CONTROL GROUP  
(OPTIONAL)**

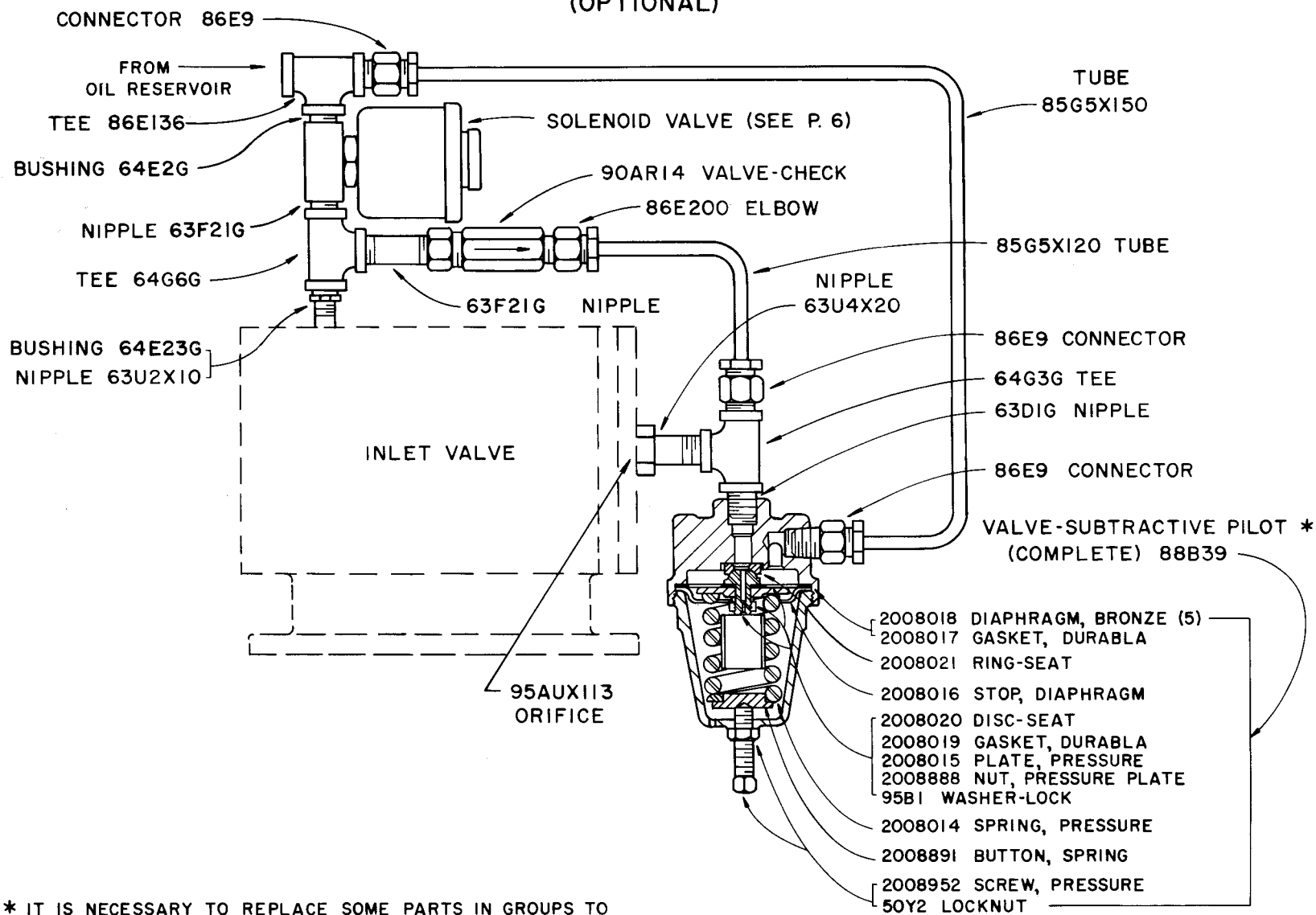

\* IT IS NECESSARY TO REPLACE SOME PARTS IN GROUPS TO INSURE SATISFACTORY REPAIR. WHEN ORDERING DIAPHRAGM, ORDER DIAPHRAGM GASKET AND SEAT DISC GASKET. WHEN ORDERING A SEAT DISC OR A SEAT RING, ALSO ORDER THE MATING SEAT RING OR SEAT DISC AND A SEAT DISC GASKET.

B75598

I-3-A2-7

MAY, 1975

I-3-A2-7

**RECOMMENDED SPARES - EBEQHA, EBERHA**

(See Footnote)

The following kits are separated according to service and locations. These are made available to aid the customer in stocking parts to allow on-site maintenance and/or repair. Quantities shown are for one unit only. It is the responsibility of the Owner-Operator to apply a multiplier for multiple units, operating conditions and/or for hours of operation. Refer to Instruction Manual for recommended replacement time for critical parts. \*

**Ordering Instructions**

**KIT NO. 1 - Routine Maintenance:** These are suggested as the minimum quantity of parts a customer should stock. They are usually the first items which require renewal. Order quantities of this kit to suit your requirements or particular service. One kit contains two (2) oil filters which require changing at least every 1000 hours under normal conditions.

**KIT NO. 2 - Domestic Service:** These are suggested as the minimum spares a customer should stock for continuous operation for up to two (2) years. When ordering for this service, order Kits No. 1 and 2.

**KIT NO. 3 - Isolated Domestic or Export Service:** These are suggested as the minimum spares a customer should stock for continuous operation. These parts include those which possibly would need renewal in an overhaul. When ordering for this service, order Kits No. 1, 2 and 3.

APPLY THE PROPER MULTIPLIER BASED ON NUMBER OF UNITS AND HOURS OF OPERATION;  
Example: For four (4) units, Four (4) of Kit No. 1 and only One (1) each of Kits 2 and 3 may be sufficient.

COMPRESSOR MODEL . . . . .		EBEQHA, EBERHA	EBEQHA, EBERHA	EBEQHA, EBERHA
HOURS OF OPERATION . . . . .		2000	18,000	(Stand-By Items)
PART NO. (Complete Kit) . . . . .		ESF66743	EBE68235	ESF66908
		<b>KIT NO. 1</b>	<b>KIT NO. 2</b>	<b>KIT NO. 3</b>
Description	Page No.	Qty. Per Kit	Qty. Per Kit	Qty. Per Kit
<b>KIT NO. 1 ROUTINE MAINTENANCE</b>				
Air Filter Element	2	1		
Oil Filter (w/Decal)	1	2		
<b>* KIT NO. 2 DOMESTIC SERVICE</b>				
Compressor Shaft Oil Seal	1		1	
Cover Plate Gasket	1		1	
Pressure Switch (NEMA 1)	6		1	
<b>KIT NO. 3 ISOLATED DOMESTIC OR EXPORT SERVICE</b>				
Inlet Valve Ring Packing	2			2
Rotor Roller Bearings	1			4
Gasket Kit	1			1

\* Kits do NOT include Oil Separator, Control Valve or Drive Belts. These items are SELECTIVE according to Pressure, Voltage, Motor Style, etc. and it is recommended they be ordered and stocked along with KIT NO. 2. Refer Ordering Instruction Page in front of book.

# **Gardner** --- **Denver**

For additional information, contact Gardner Denver Machinery Inc.  
1800 Gardner Expressway, Quincy, Illinois 62305-4024  
Telephone (217) 224-8800 • FAX 217-224-7814 • Telex 404332.

Specifications *subject to change without notice.*

COPYRIGHT<sup>®</sup> 1994 Gardner Denver Machinery Inc.

Litho in USA.